

Legend

- Water Well
- Hydrology (NHD)
- Existing Pipelines
- Proposed Pipeline
- Fence
- Access Road
- Electric Lines
- Structure Footprints

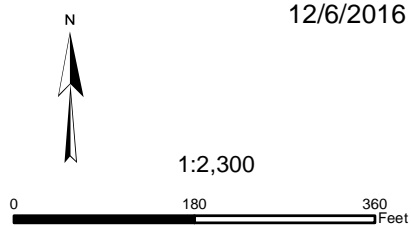

YANKEE FEDERAL A1 HST

LAT: 37.267628
LONG: -107.511704

EAST SAULS CREEK 26 2-1

LAT: 37.26773682
LONG: -107.51175565

EAST SAULS CREEK 26 2-2

LAT: 37.26758677
LONG: -107.51184087

Location Drawing

BP AMERICA PROD. CO. - DURANGO, CO

SE¼ SECTION 27 T35N R06W
LA PLATA COUNTY COLORADO