



Lat40°, Inc. 6250 W. 10th Street, Unit 2, Greeley, CO 970-515-5294

ACCESS ROAD MAP

JOHNSON 6N64W16D PAD

SECTION: 16
TOWNSHIP: 6N
RANGE: 64W
6TH. P.M.
WELD COUNTY, CO

DRIVING DIRECTIONS TO JOHNSON 6N64W16D PAD

FROM THE INTERSECTION OF COUNTY ROAD 55 AND HIGHWAY 392, DRIVE NORTH ON COUNTY ROAD 55 FOR 0.4 MILES TO AN ACCESS TO THE WEST, DRIVE WEST ON THE ACCESS ROAD 0.1 MILES TO THE PROPOSED PAD LOCATION.

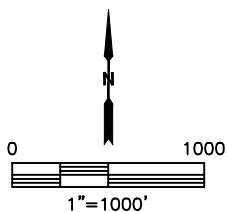
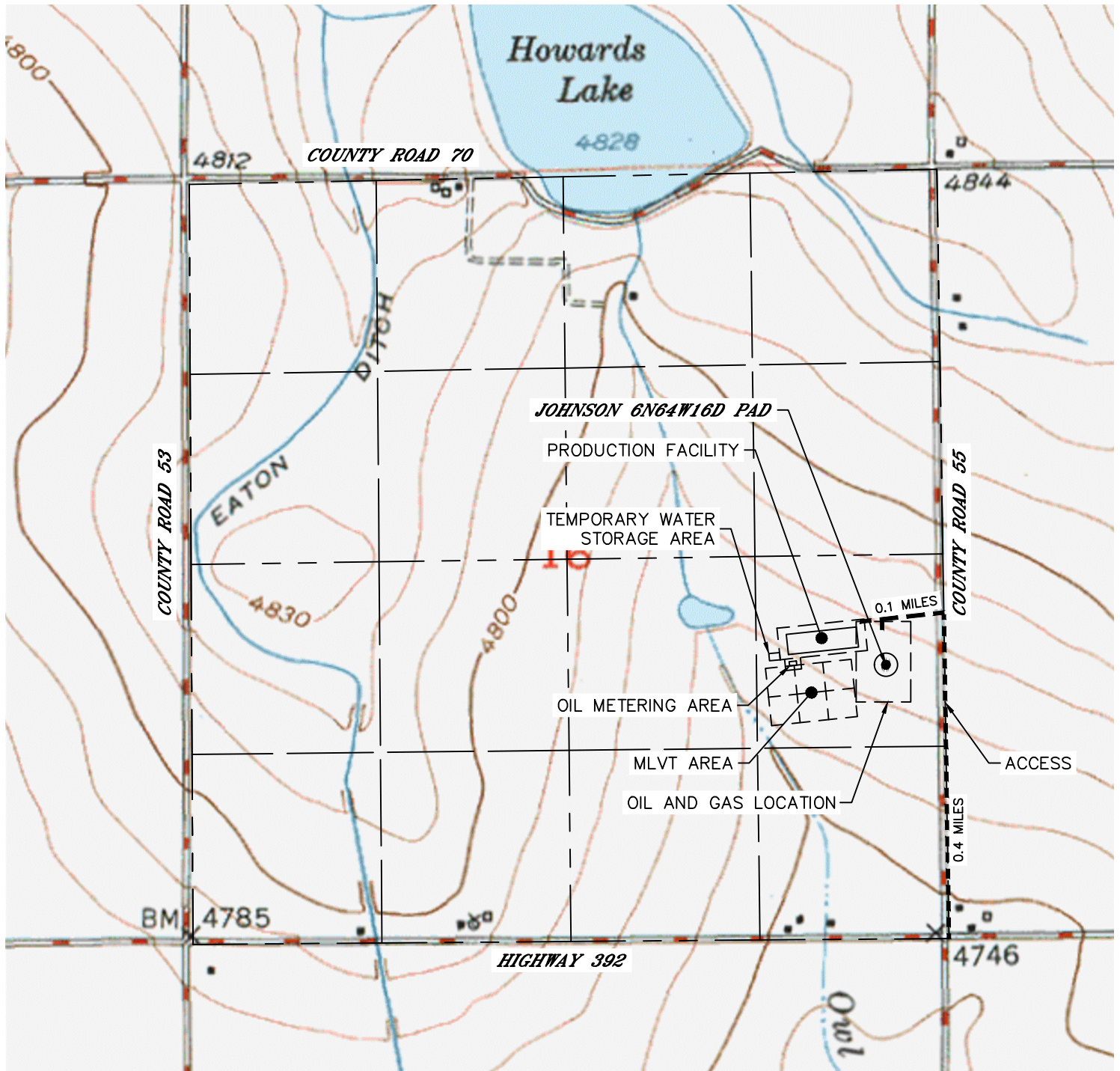



Lat40°, Inc. 6250 W. 10th Street, Unit 2, Greeley, CO 970-515-5294

ACCESS ROAD MAP

JOHNSON 6N64W16D PAD

SECTION: 16
TOWNSHIP: 6N
RANGE: 64W
6TH. P.M.
WELD COUNTY, CO

