

LEGEND:

- EXISTING DRAINAGE
- 1000' OFFSET BOUNDARY
- EDGE OF DISTURBANCE
- FLOOD PLAINS



UELS, LLC
Corporate Office * 85 South 200 East
Vernal, UT 84078 * (435) 789-1017



SandRidge Exploration & Production, LLC

HEBRON 12 PAD
NE 1/4 NE 1/4, SECTION 12, T7N, R81W, 6th P.M. &
NW 1/4 NW 1/4, SECTION 7, T7N, R80W, 6th P.M.
JACKSON COUNTY, COLORADO

SURVEYED BY	C.M., D.S.	09-01-16	SCALE
DRAWN BY	C.D.L.	09-20-16	1 : 12,000

HYDROLOGY MAP

TOPO W

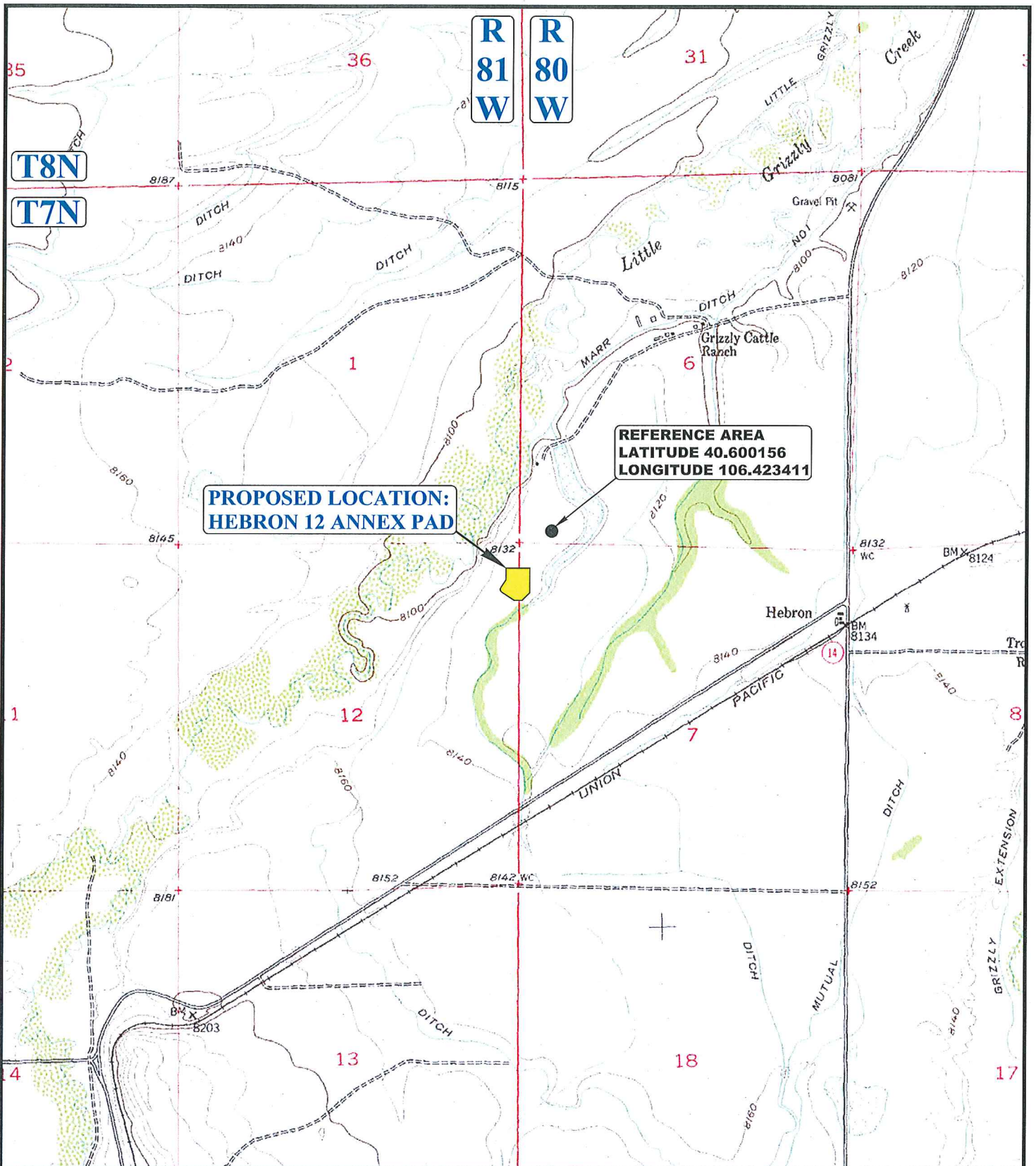

LEGEND:



UELS, LLC
Corporate Office * 85 South 200 East
Vernal, UT 84078 * (435) 789-1017



SandRidge Exploration & Production, LLC

HEBRON 12 PAD
NE 1/4 NE 1/4, SECTION 12, T7N, R81W, 6th P.M. &
NW 1/4 NW 1/4, SECTION 7, T7N, R80W, 6th P.M.
JACKSON COUNTY, COLORADO

SURVEYED BY	C.M., D.S.	09-01-16	SCALE
DRAWN BY	C.D.L.	09-20-16	1" = 24,000'
REFERENCE AREA MAP			REF TOPO