

PHOTO: VIEW FROM CORNER #5 TO LOCATION STAKES

CAMERA ANGLE: SOUTHERLY



PHOTO: VIEW FROM BEGINNING OF EXISTING ACCESS

CAMERA ANGLE: NORTHERLY

SandRidge Exploration & Production, LLC

HEBRON 12 PAD
NE 1/4 NE 1/4, SECTION 12, T7N, R81W, 6th P.M. &
NW 1/4 NW 1/4, SECTION 7, T7N, R80W, 6th P.M.
JACKSON COUNTY, COLORADO

TAKEN BY	C.M., D.S.	09-01-16	
DRAWN BY	C.D.L.	09-20-16	
LOCATION PHOTOS		PHOTO	



UELS, LLC
Corporate Office * 85 South 200 East
Vernal, UT 84078 * (435) 789-1017

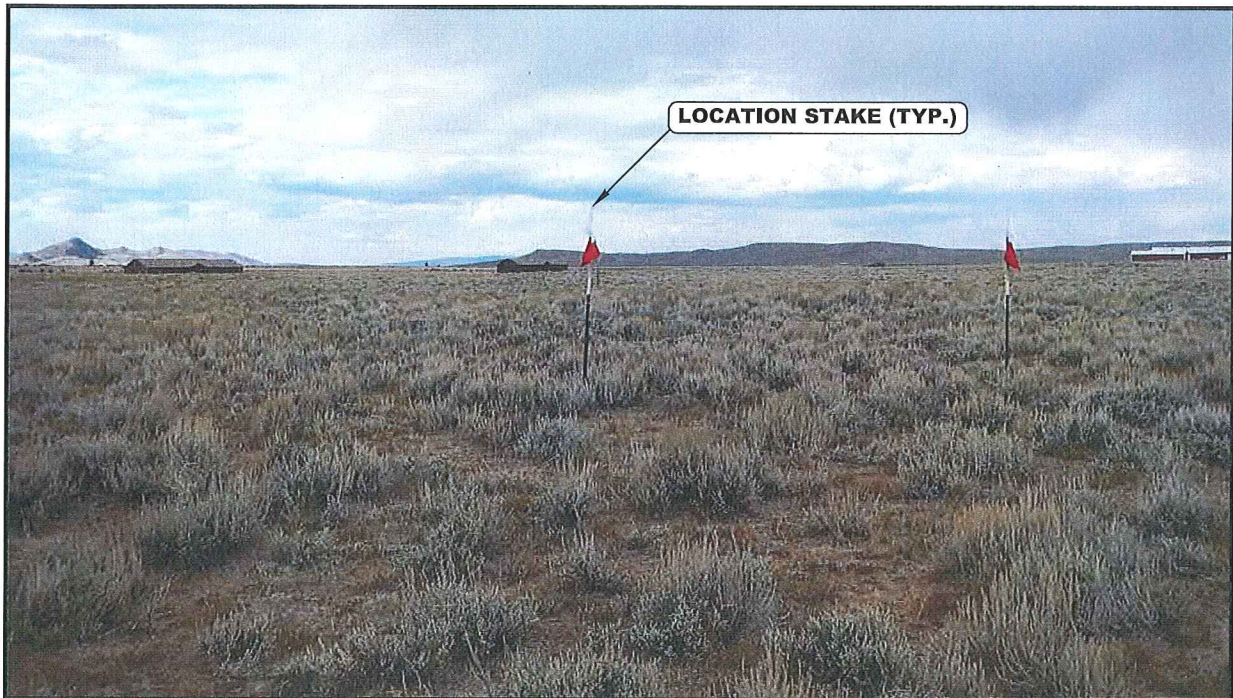

PHOTO: VIEW OF LOCATION STAKES

CAMERA ANGLE: NORTHERLY

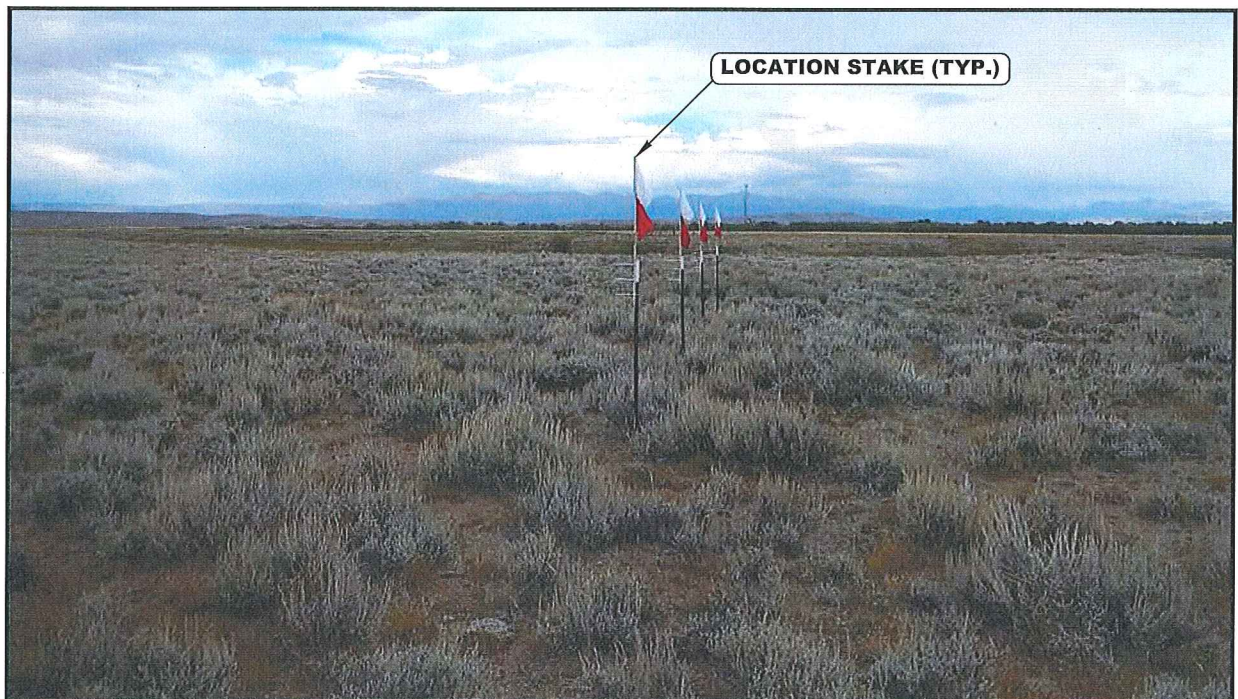

PHOTO: VIEW OF LOCATION STAKES

CAMERA ANGLE: EASTERLY

SandRidge Exploration & Production, LLC

HEBRON 12 PAD
NE 1/4 NE 1/4, SECTION 12, T7N, R81W, 6th P.M. &
NW 1/4 NW 1/4, SECTION 7, T7N, R80W, 6th P.M.
JACKSON COUNTY, COLORADO

TAKEN BY	C.M., D.S.	09-01-16	
DRAWN BY	C.D.L.	09-20-16	
LOCATION PHOTOS		PHOTO 2	



UELS, LLC
Corporate Office * 85 South 200 East
Vernal, UT 84078 * (435) 789-1017



PHOTO: VIEW OF LOCATION STAKES

CAMERA ANGLE: SOUTHERLY

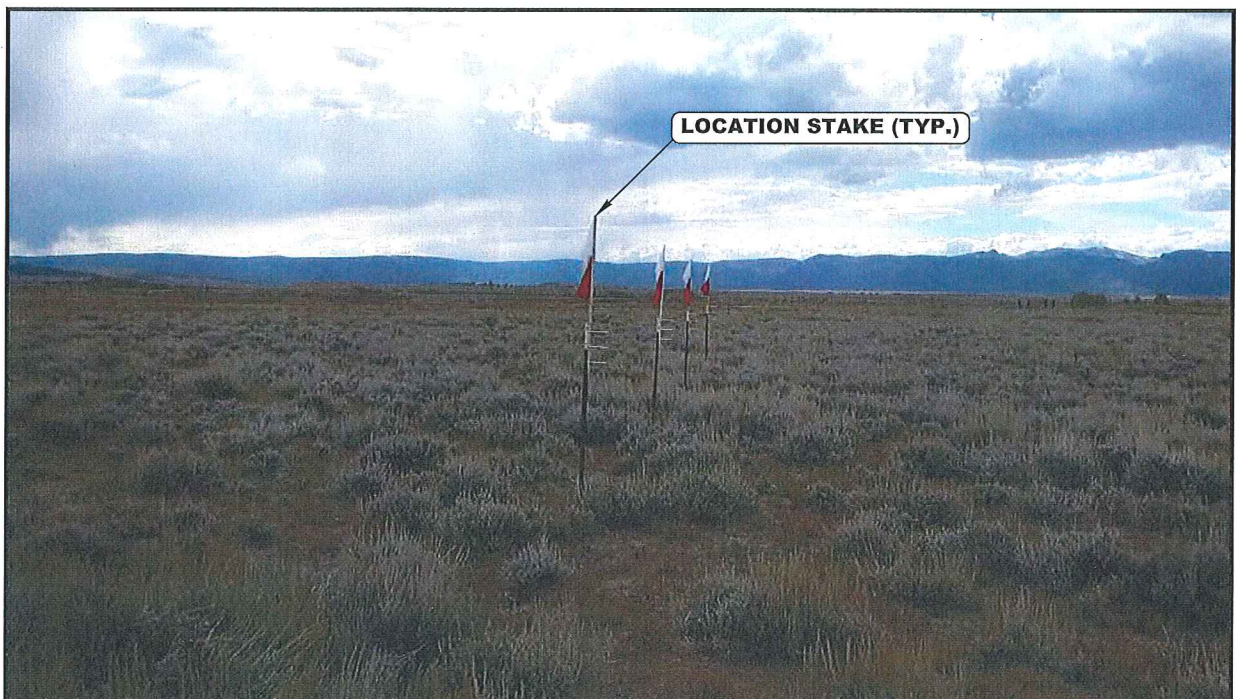

PHOTO: VIEW OF LOCATION STAKES

CAMERA ANGLE: WESTERLY

SandRidge Exploration & Production, LLC

HEBRON 12 PAD
NE 1/4 NE 1/4, SECTION 12, T7N, R81W, 6th P.M. &
NW 1/4 NW 1/4, SECTION 7, T7N, R80W, 6th P.M.
JACKSON COUNTY, COLORADO

TAKEN BY	C.M., D.S.	09-01-16	
DRAWN BY	C.D.L.	09-20-16	

LOCATION PHOTOS

PHOTO 3



UELS, LLC
Corporate Office * 85 South 200 East
Vernal, UT 84078 * (435) 789-1017