

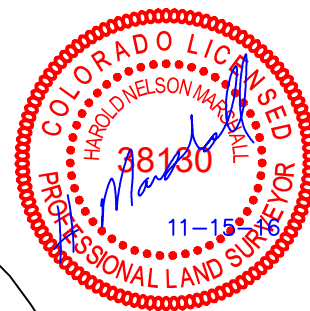

500' Offset  
from Edge of  
Disturbance

RONALD W. JENSEN  
REVOC TRUST

JERRY  
GUNDERSON



Existing  
Creek

Topsoil  
Stockpile

Existing  
Drainage

N61°W 345'  
N69°W 678'

Well Heads  
Separators

Proposed  
Access Road

VOC  
Combustor

Tanks

PROPOSED GUNDERSON 20-08E  
Reference Point

REBECCA  
GOODWIN

1/16 Section Line

Existing  
2-Track

Existing  
Fence

KAREN M.  
HEALY

1/4 Section Line

### LINE TABLE

LINE	DIRECTION	LENGTH
L1	S35°W	215'
L2	S20°W	232'
L3	S03°W	205'



REV: 1 11-07-16 S.S. (WELL MOVE)

### Reference Point

(NAD 83)  
Lat: 39.266756°  
Long: 107.795281°  
Footage: 1032' FNL 1985' FWL  
Ground Elevation: 7165.5'  
PDOP: 1.4 Date: 08-19-15  
Instrument Operator: Braden Box

### PLANT COMMUNITY

- ☐ DISTURBED GRASSLAND
- ☐ NATIVE GRASSLAND
- ☐ SHRUB LAND
- ☐ PLAINS RIPARIAN
- ☐ MOUNTAIN RIPARIAN
- ☐ FOREST LAND
- ☐ WETLANDS AQUATIC
- ☐ ALPINE
- ☐ OTHER (Describe):

### CURRENT LAND USE

- CROP LAND: ☐ IRRIGATED ☐ DRY LAND ☐ IMPROVED PASTURE ☐ HAY MEADOW ☐ CRP
- NON-CROP LAND: ☐ RANGELAND ☐ TIMBER ☐ RECREATIONAL ☐ OTHER (Describe)
- SUBDIVIDED: ☐ INDUSTRIAL ☐ COMMERCIAL ☐ RESIDENTIAL

### FUTURE LAND USE

- CROP LAND: ☐ IRRIGATED ☐ DRY LAND ☐ IMPROVED PASTURE ☐ HAY MEADOW ☐ CRP
- NON-CROP LAND: ☐ RANGELAND ☐ TIMBER ☐ RECREATIONAL ☐ OTHER (Describe)
- SUBDIVIDED: ☐ INDUSTRIAL ☐ COMMERCIAL ☐ RESIDENTIAL

## LARAMIE ENERGY, LLC

GUNDERSON 20-03 PAD  
NE 1/4 NW 1/4, SECTION 20, T9S, R93W, 6th P.M.  
MESA COUNTY, COLORADO

SURVEYED BY: BRADEN BOX	SURVEY DATE: 08-19-15
DRAWN BY: S.S.	DATE DRAWN: 10-20-16
SCALE: 1" = 300'	

LOCATION DRAWING

FIGURE #5



UELS, LLC  
Corporate Office \* 85 South 200 East  
Vernal, UT 84078 \* (435) 789-1017