

UNGRADED ELEVATION: 6781.3'
 FINAL ELEVATION: 6777.2'
 PROPOSED AREA OF DISTURBANCE: 6.8± ACRES
 DRAINS TO POWDER WASH

STORMWATER BMP's

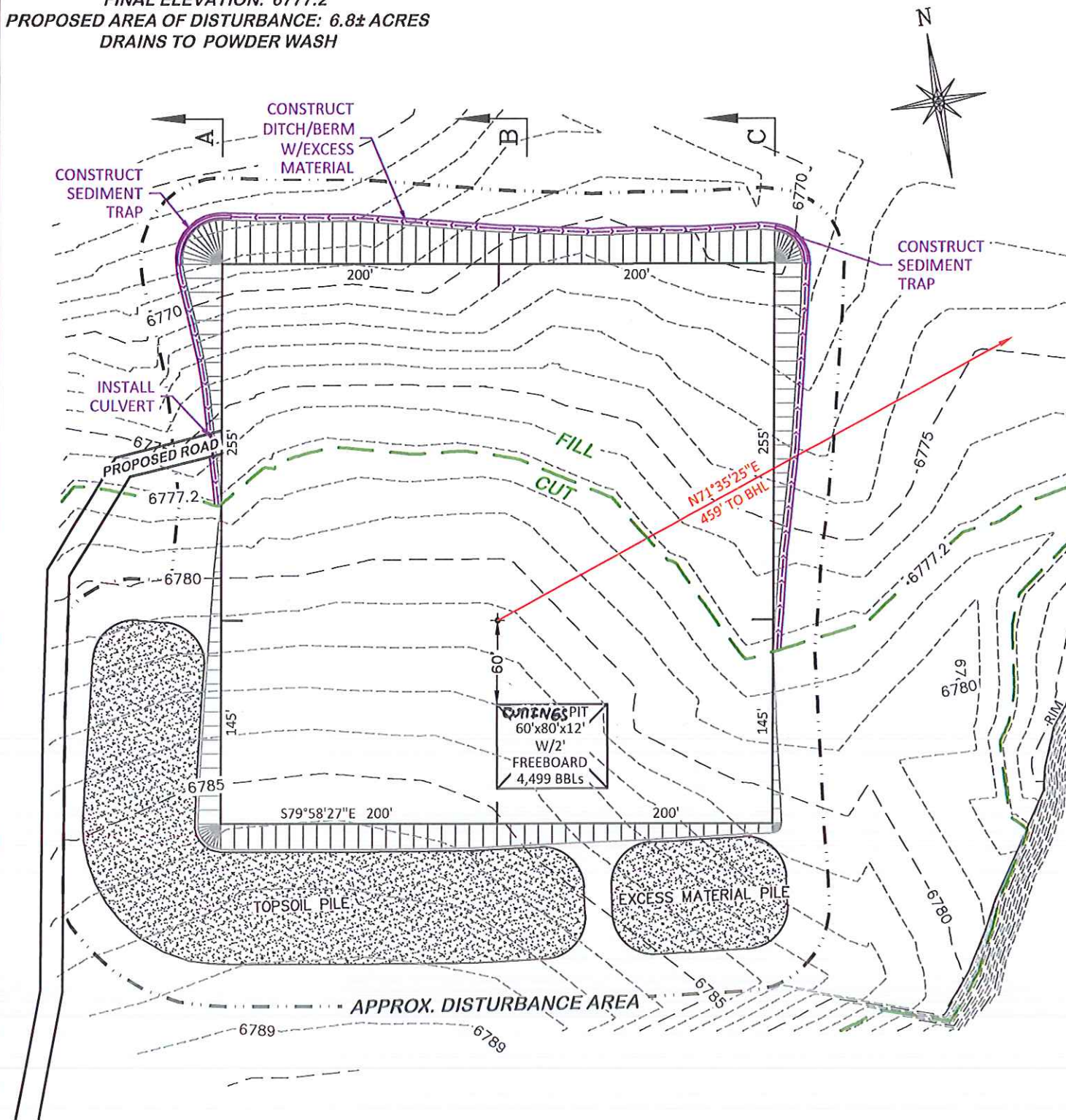

BEFORE DIGGING
 CALL FOR
 UTILITY LINE LOCATION

POWDER WASH 19-1

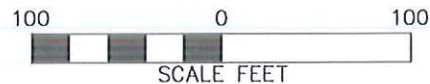

DRIFIN & ASSOCIATES, INC.
 1414 ELK ST., ROCK SPRINGS, WY 82901

(307) 362-5028

DRAWN: 10/30/2015 - TCM

SCALE: 1" = 100'

REVISED: 5/9/2016 - TCM

DRG JOB No. 20958

ONSITE REVISIONS

EXHIBIT 2E

STORMWATER BMP's

QEP ENERGY COMPANY
POWDER WASH 19-1
SESE, SECTION 19, T. 12 N., R. 97 W., 6th P.M.,
MOFFAT COUNTY, COLORADO