

Project: Wattenberg Field  
Site: LC (Sec.12-T09N-R59W) Weld County, CO  
Well: Benelli Federal LC22-765  
Wellbore: Original Drilling  
Design: APD - Rev 1

# Northern Region Drilling - Working

Geodetic System: US State Plane 1983  
Datum: North American Datum 1983  
Ellipsoid: GRS 1980  
Zone: Colorado Northern Zone  
System Datum: Mean Sea Level

## SECTION DETAILS

Sec	MD	Inc	Azi	TVD	+N/-S	+E/-W	Dleg	TFace	VSect	Target
1	0.0	0.00	0.00	0.0	0.0	0.0	0.00	0.00	0.0	
2	2300.0	0.00	0.00	2300.0	0.0	0.0	0.00	0.00	0.0	
3	2862.5	11.25	22.00	2858.9	51.0	20.6	2.00	22.00	-48.8	
4	5407.5	11.25	22.00	5355.0	511.4	206.6	0.00	0.00	-489.3	
5	5425.1	12.47	27.22	5372.2	514.7	208.1	9.24	43.82	-492.5	
6	6520.6	90.30	178.31	6105.5	-95.0	305.0	9.24	150.47	123.7	
7	10978.5	90.30	178.32	6082.1	-4550.9	436.2	0.00	76.43	4571.8	Benelli Federal LC22-765 BHL 330'FSL, 1920'FWL

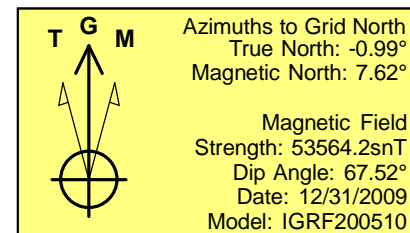
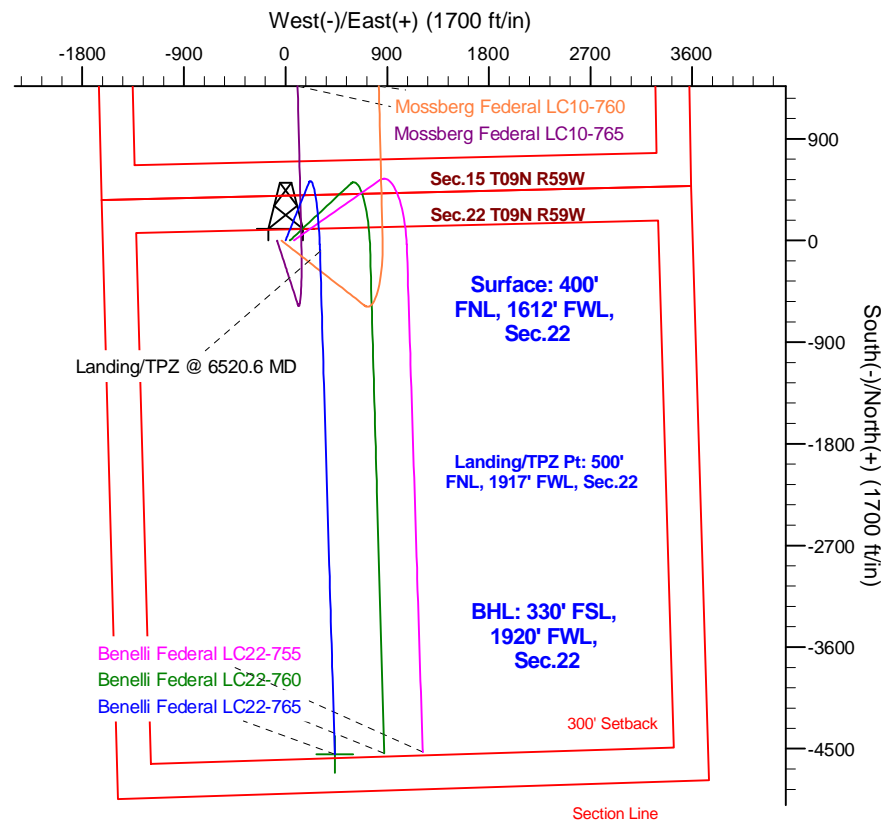
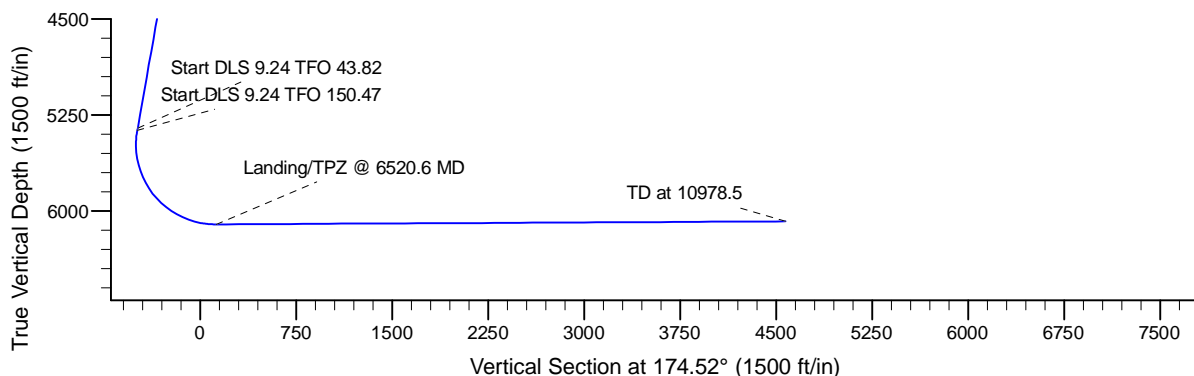
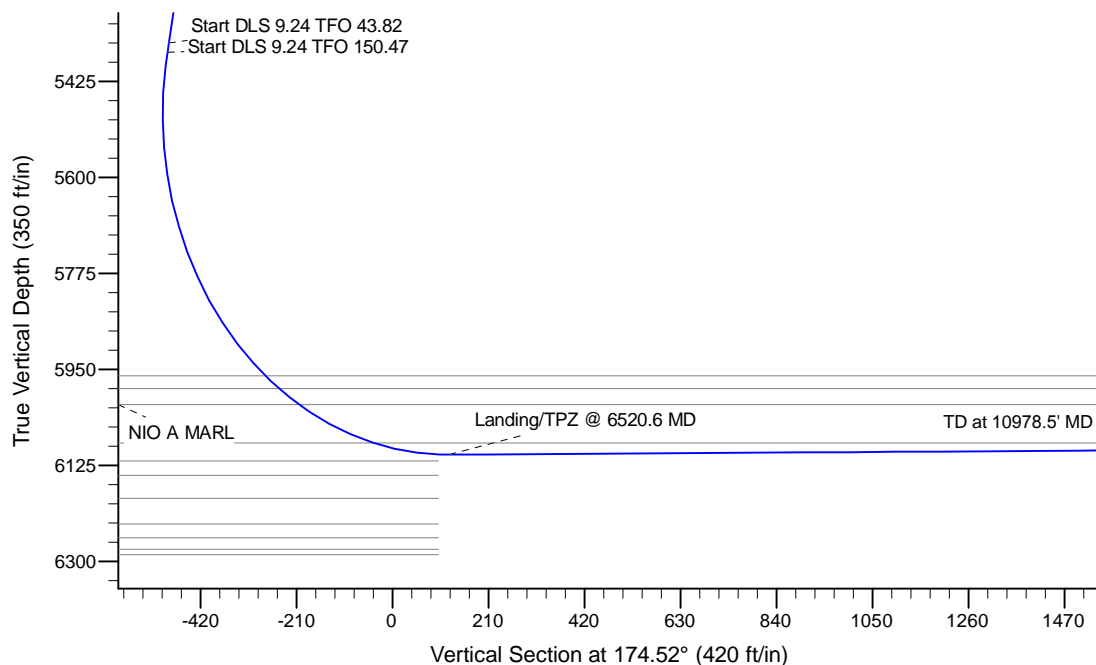

## WELL DETAILS: Benelli Federal LC22-765

Ground Level#916.0			
0.0	0.0	1516947.13	3424551.90
Northing		Latitude	
0.0		40.742340	
Easting		Longitude	
0.0		-103.967820	

Plan: APD - Rev 1 (Benelli Federal LC22-765/Original Drilling)

Created By: Shailey Jewell Date: 12:11, September 12 2016

Checked: \_\_\_\_\_ Date: \_\_\_\_\_

Reviewed: \_\_\_\_\_ Date: \_\_\_\_\_

Approved: \_\_\_\_\_ Date: \_\_\_\_\_