

Great Western Operating Company, LLC

Location Colorado
Field Wattenburg
Installation Ocho
Slot Slot W06 - Ocho LD 17-378HN
Well Ocho LD 17-378HN
Wellbore Ocho LD 17-378HN (PWB)

Created by admin
Date plotted 2-Sep-2016

Plot reference is Ocho LD 17-378HN (PWB).
Ref wellpath is Ocho LD 17-378HN (PWP#1).
Coordinates are in Feet reference Slot W06 - Ocho LD 17-378HN.
True Vertical Depths are reference Rig Datum.
Measured Depths are reference Rig Datum.
Rig Datum: Planned Datum #1
Rig Datum to Mean Sea Level: 20.00 ft.
Plot North is aligned to TRUE North.

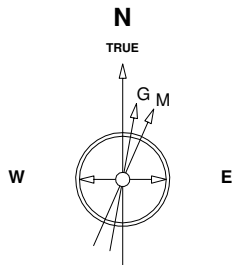

Scale 1 cm = 400 ft

East (Feet) ->

-6400 -5600 -4800 -4000 -3200 -2400 -1600 -800 0 800 1600 2400 3200 4000

31-Aug-2016
IGRF Model [1900.0-2020.0] Dip: 66.52 deg Field: 52289.7 nT
Lat: N39 59 4.9488 Long: W104 54 50.5188 Elev: 0.00 ft
Magnetic North is 8.34 deg East of TRUE North
To correct azimuth from Magnetic to TRUE add 8.34 deg

Scale 1 c

<- True Vertical Depth (Feet)

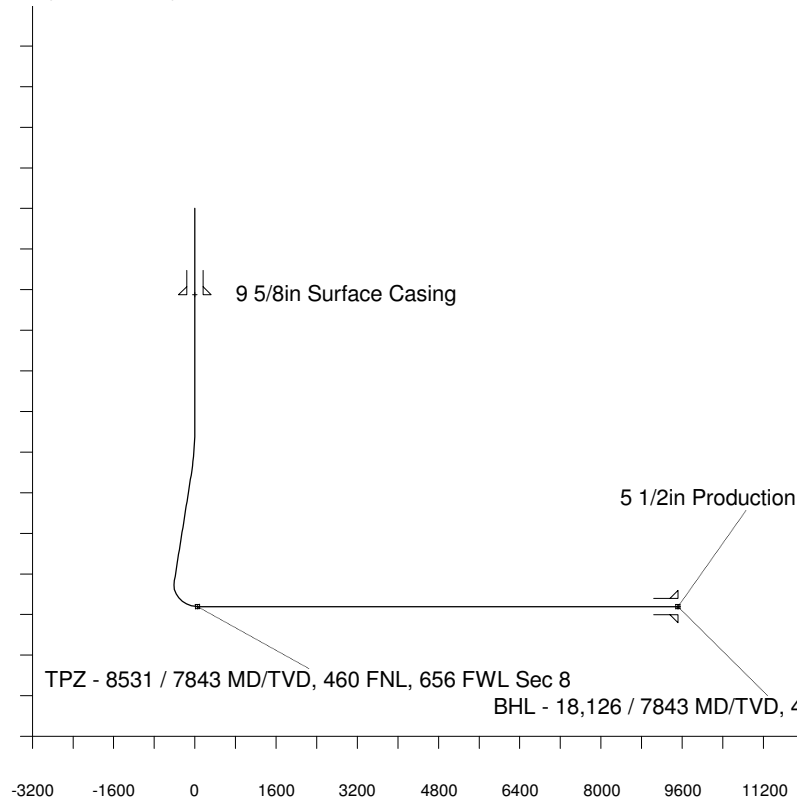

Scale 1 cm = 800 ft

Vertical Section (Feet) ->

Azimuth 189.64 with reference 0.00 N, 0.00 E from Slot W06 - Ocho LD 17-378HN

WELL PROFILE DATA

Point	MD	Inc	Azi	TVD	North	East	deg/100ft	V. Sect
Tie on	0.00	0.00	0.00	0.00	S 0.00	W 0.00		-0.00
KOP	4280.00	0.00	295.56	4280.00	S 0.00	W 0.00	0.00	-0.00
End of Build	5279.96	30.00	295.56	5234.90	N 110.38	W 230.82	9.84	-70.18
End of Hold	7742.89	30.00	295.56	7367.88	N 641.62	W 1341.76	0.00	-407.98
Target TPZ - ... Sec 8	8530.94	90.00	180.02	7843.00	N 211.34	W 1589.43	42.65	57.69
T.D. & Target BHL...	18125.85	90.00	180.02	7843.00	S 9383.58	W 1593.13	0.00	9517.86

TPZ - 8531 / 7843 MD/TVD, 460 FNL, 656 FWL Sec 8

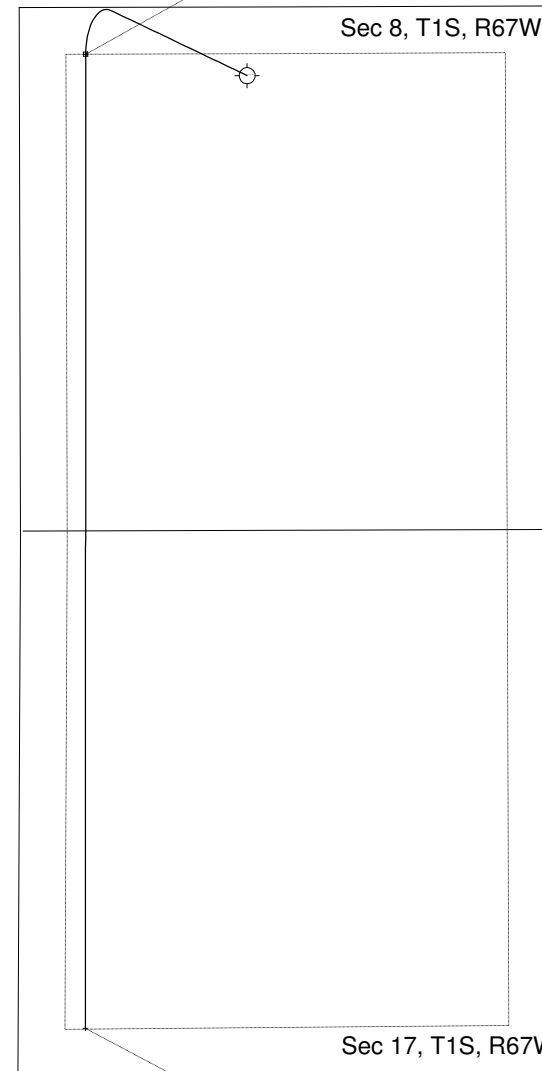

BHL - 18,126 / 7843 MD/TVD, 470 FSL, 662 FWL Sec 17

<- North(Feet)

Scale 1 cm = 400 ft