

SECTION 23 & 26, T. 4 N., R. 66 W., 6TH P.M., WELD COUNTY, STATE OF COLORADO

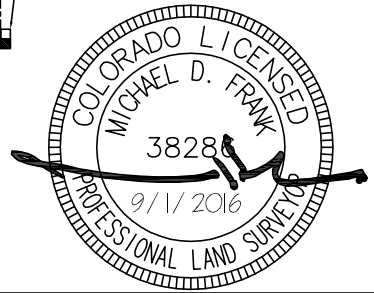

1. Bearings and Distances shown are Grid Bearing of the Colorado State Plane Coordinate System (North Zone), North American Datum 1983. Lineal dimensions as contained herein are based on the "U.S. Survey Foot."
2. Data was collected 08/25/2016 by instrument operator: Dane Courville
3. Bearings contained herein are based upon GPS observation between the found and described monuments and or physical evidence shown hereon.
4. Distances contained herein are based upon the U.S. Bureau of Standards:
One Survey Foot = 1200/3937 meter.
5. Ground elevations are based on GPS observation of NGS monument "LL0998"
6. Section line information was gathered from public records.
7. This exhibit is not a land survey plat and does not represent a boundary survey; it is not to be relied upon for the establishment of fence, building, or other improvements. Prepared for Petrotek Engineering Corporation and in accordance with a request from Jeremiah Demuth.



DRAWN BY: DANE COURVILLE 8-29-16			PARCEL INFORMATION			EXPEDITION WATER SOLUTIONS 1023 39TH AVE, SUITE E GREELEY, COLORADO 80634 (970) 515-6950			
CHECKED BY: MICHAEL FRANK 8-29-16						OWNER: EXPEDITION WATER SOLUTIONS (EWS) SITE 3A			WELL LOCATION WELD COUNTY, COLORADO
<div><div><div></div><div></div><div></div><div></div><div></div><div></div><div></div><div></div><div></div><div></div></div><div>TAMARACK CONSULTING, LLC</div></div> <div>TAMARACK CONSULTING, LLC 8840 W. COLFAX AVENUE, LAKEWOOD, COLORADO 80215 (303) 233-3265</div>									SCALE: 1" = 1000'