



STATE OF
COLORADO

Allison - DNR, Rick <rick.allison@state.co.us>

USA 21-6 existing site plan and google earth photos

Gregory Dillon <gregory_dillon@yahoo.com>

Thu, Jul 21, 2016 at 8:35 AM

Reply-To: Gregory Dillon <gregory_dillon@yahoo.com>

To: Rick Allison <rick.allison@state.co.us>, Joe Culek <jculek@charter.net>

Mr. Allison,

Attached is the facility site plan and areal photos, via Google Earth, of the entire site, the a battery and process facility, and the well site. Please call me when you get this I want to discuss a plan that will allow us to quickly and economically address the immediate concerns and progress with the remainder of the deficiencies.

Greg,

Gregory P. Dillon
Fortitude Exploration Company
P.O. Box 5417, Navarre, FL 32566
Phone (850) 496-5363
Fax (850) 344-9725

5 attachments

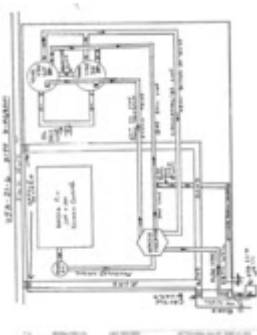

SITE PLAN.tif
305K



USA 21-6 Well site and Tanks Google Earth.jpg
166K

USA 21-6 Well Google Earth.jpg



166K



USA 21-6 Tank Battery Google Earth.jpg
200K



USA 21-6 Screenshot.pdf
286K

USA-21-6 SITE DIAGRAM

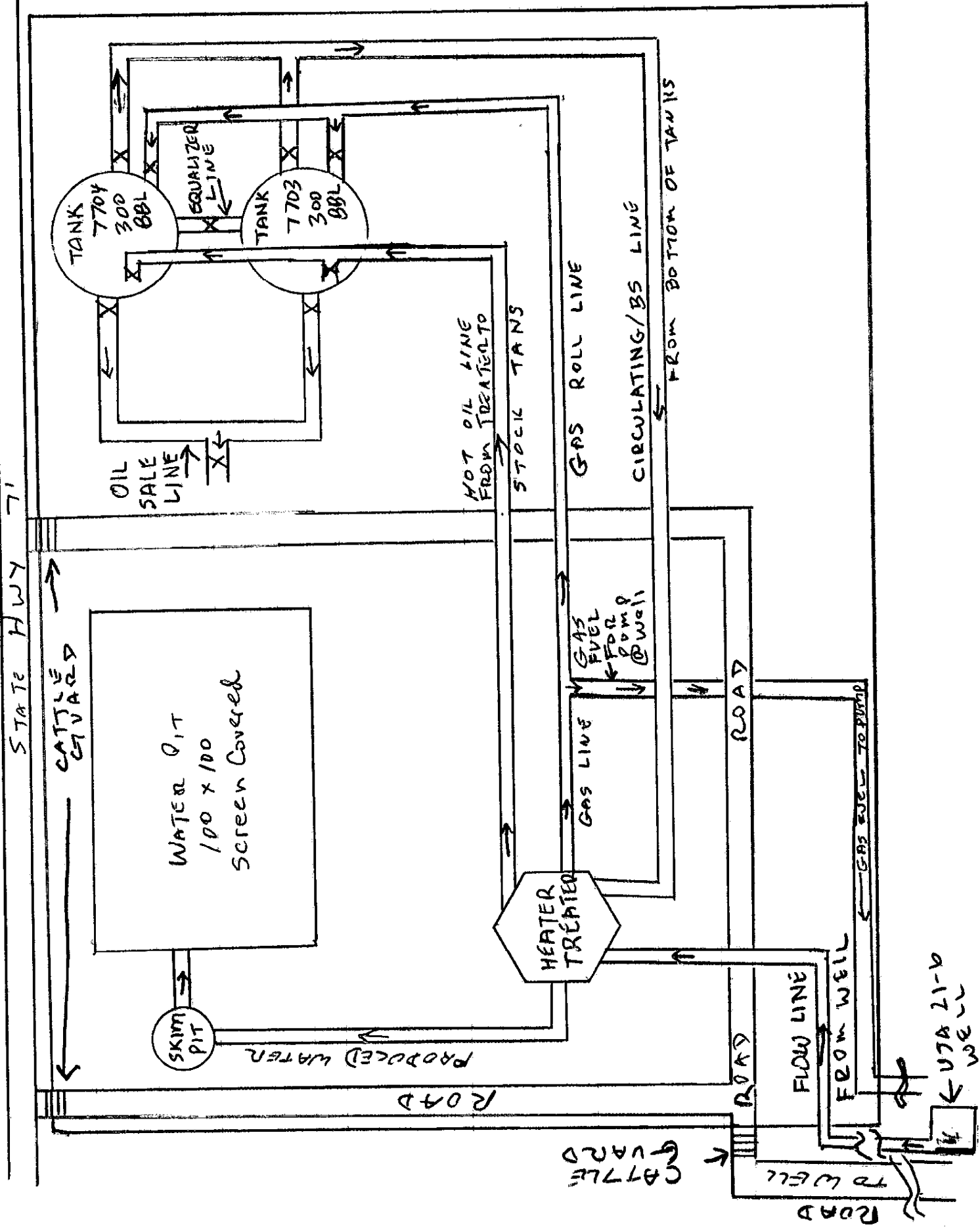



PAWNEE NATIONAL GRASSLAND
EXHIBIT A
FORTITUDE EXPLORATION COMPANY
PRODUCTION FACILITY AND ROAD



Google earth

1999

Imagery Date: 10/15/2015 40°57'40.78" N 103°40'58.49" W elev 4982 ft eye alt 7733 ft



Google earth

1999

Imagery Date: 10/15/2015 40°57'39.24" N 103°40'48.06" W elev 4996 ft eye alt 5161 ft



Google earth

1998

Imagery Date: 10/15/2015 40°57'43.38" N 103°41'12.90" W elev 5001 ft eye alt 5269 ft



Google earth

feet 100
meters 40

