



August 24, 2016

Mr. Matt Lepore, Director
Colorado Oil and Gas Conservation Commission
1120 Lincoln Street
Suite 801
Denver, CO 80203

RE: COGCC Rule 318A.e.: Proposed Wellbore Spacing Unit

Kawata 32N-17B-M
PSU: S2N2 & N2S2 Section 17; S2/NW4 & N2/SW4 Section 16 - T4N-66W
480 Acres
Weld County, Colorado

Dear Mr. Lepore,

Synergy Resources Corporation (SRC) is planning to drill the above referenced well in accordance with the provisions set out in COGCC Rule 318A.e. Synergy's proposed wellbore spacing unit consists of:

Kawata 32N-17B-M
PSU: S2N2 & N2S2 Section 17; S2/NW4 & N2/SW4 Section 16 - T4N-66W
480 Acres

Synergy is not the only owner within the proposed wellbore spacing unit and has provided notice to the remaining owner(s) within this spacing unit, as required by COGCC Rule 318A.e. (6). Copies of the required notification letters are on file at Synergy's office. The required thirty (30) day notice period has elapsed absent the receipt by Synergy of any objection to their proposal by the owner(s) within the proposed spacing unit for the subject well.

Enclosed is the Proposed Spacing Unit Plat to assist in your review and approval of Synergy's proposed Application for Permit to Drill (APD) for Kawata 32N-17B-M well. Synergy respectfully requests the COGCC to review the enclosed information and approve the requested exception location waiver and APD for Kawata 32N-17B-M.

Thank you,

A handwritten signature in blue ink, appearing to read 'Erin Ekblad', is written over a faint, larger blue ink signature that is partially obscured.

Erin Ekblad
Manager of Regulatory Affairs
Synergy Resources Corporation

Attachment: Proposed Spacing Unit Plats

KAWATA 32N-17B-M WELL BORE SPACING UNIT

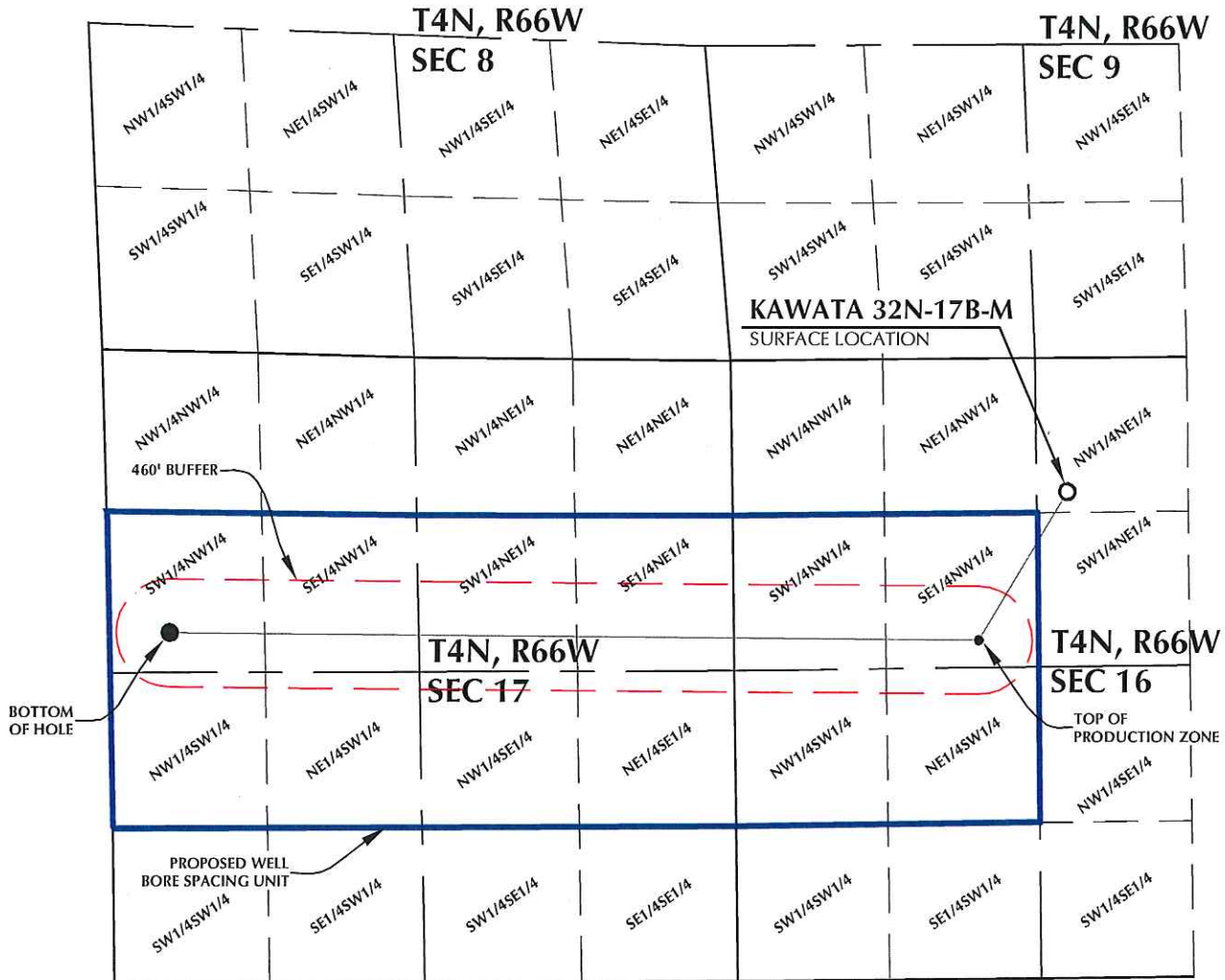

SURFACE LOCATION
GROUND ELEVATION= 4732.9'
LATITUDE= 40.315788°
LONGITUDE= -104.781648°
1/4 1/4: NW1/4 NE1/4

TOP OF PRODUCTION
LATITUDE= 40.312324°
LONGITUDE= -104.784407°
1/4 1/4: SE1/4 NW1/4

BOTTOM HOLE LOCATION
LATITUDE= 40.312640°
LONGITUDE= -104.809282°
1/4 1/4: SW1/4 NW1/4

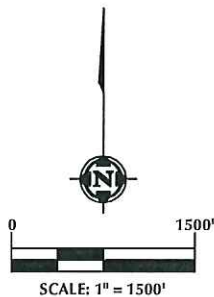

NOTES:

1. DRAWING LATITUDE AND LONGITUDE COORDINATES ARE NAD 83 (2011)(EPOCH:2010)
2. ELEVATION BASED ON NAVD88 (GEOID12B)
3. BASIS OF BEARING DERIVED FROM COLORADO COORDINATE SYSTEM OF 1983 NORTH ZONE.
6. ALL MEASURED DISTANCES ARE GRID. COMBINED SCALE FACTOR: .99973444 CALCULATED FROM THE N. 1/4 CORNER OF SECTION 16, T4N, R66W

WELL PAD - KAWATA 21-16

KAWATA 32N-17B-M
WELL BORE SPACING UNIT
1141' FNL & 2346' FEL NWNE (SURFACE)
2402' FNL & 2094' FWL SENW (TOP OF PRODUCTION)
LOCATED IN SECTION 16
2402' FNL & 510' FWL SWNW (BOTTOM)
LOCATED IN SECTION 17
T4N, R66W, 6TH P.M.
WELD COUNTY, COLORADO



1625 Broadway, Suite 300
Denver, Colorado 80202



CONSULTING, LLC

SHERIDAN OFFICE 1095 Saberton Avenue
Sheridan, Wyoming 82801
Phone 307-674-0609

LOVELAND OFFICE 1635 Foxtrail Drive, Suite 204
Loveland, Colorado 80538
Phone 970-776-4331

DRAFTED BY:	LMO	CHECKED BY:	JRS
DATE DRAFTED:	6/29/16	DATE SURVEYED:	6/3/16
REVISED:		FILE NAME:	16-45