



Lat40 , Inc. 6250 W. 10th Street, Unit 2 Greeley, CO 970-515-5294

## HYDROLOGY MAP

KLEIN 19MN-HZ PAD

SECTION: 19  
TOWNSHIP: 5N  
RANGE: 64W

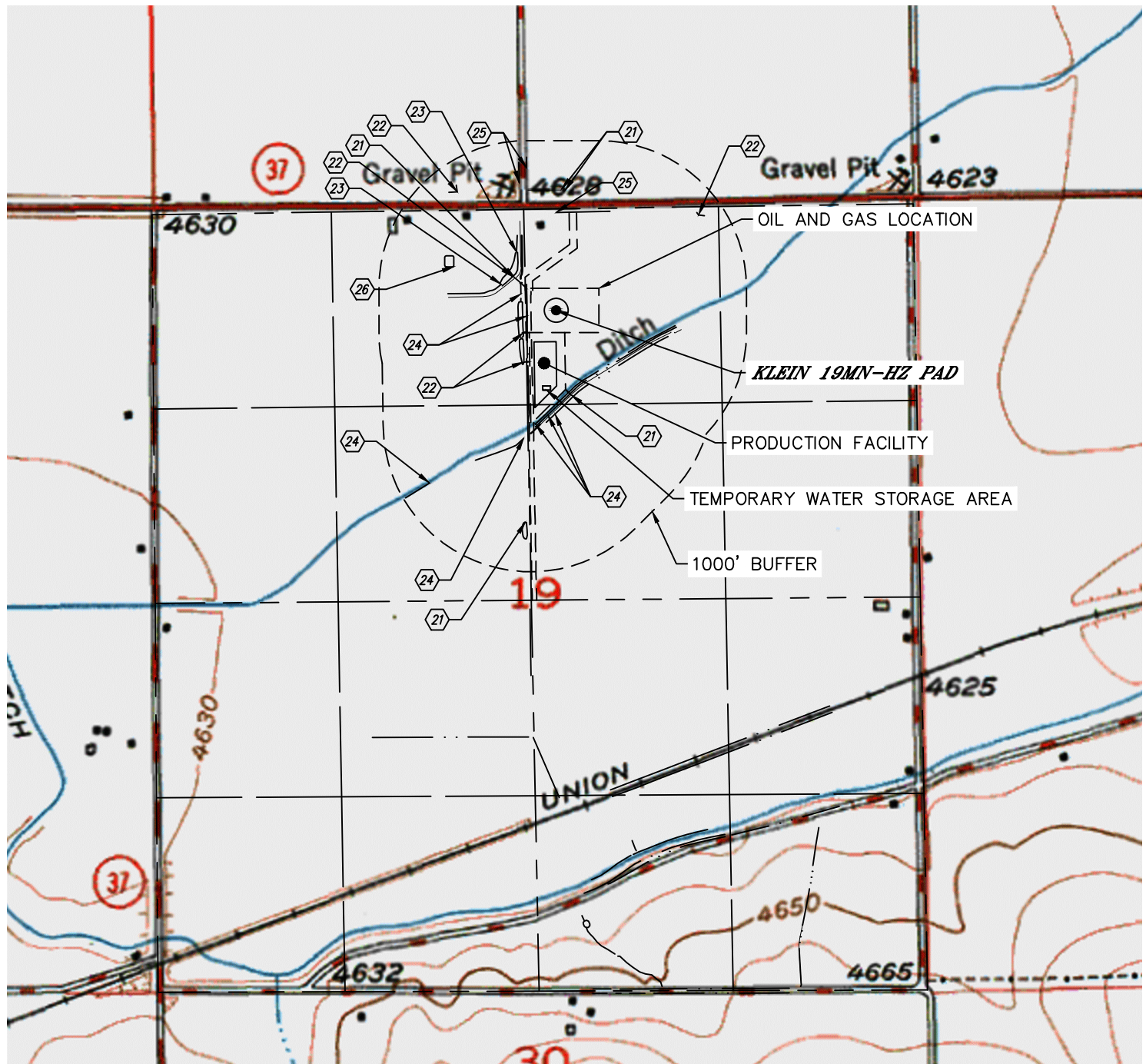

MEASURED FROM THE EDGE OF THE OIL AND GAS LOCATION.

- (21) CONCRETE DITCH 52' SE, 104' NW, 662' & 672' N
- (22) POND 22' & 40' W, 122' & 805' NW, 665' SW, 803' NE
- (23) LOW AREA 173' & 255' NW
- (24) DITCH (1) INSIDE LOCATION, 21', 38' & 67' SE, 39' W, 107' & 794' SW
- (25) BORROW DITCH 514' & 816' N, 717' NW
- (26) CONTAINMENT POND 517' NW

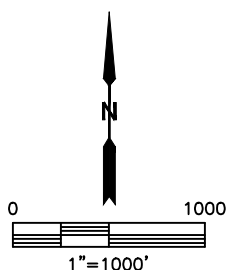

NEAREST DOWN GRADIENT SURFACE WATER: POND 22' W

DATE: 5/25/2016  
PROJECT#: 2013130