

BASIS OF ELEVATION

SPOT ELEVATION AT THE NE CORNER OF SECTION 21, T7N, R80W, 6TH PM, TAKEN FROM THE COAL MOUNT QUADRANGLE, USGS 7.5 MIN QUAD (TOPOGRAPHIC MAP) WITH SAID ELEVATION MARKED AS BEING 8223 FEET.

SandRidge Exploration & Production, LLC

CONSTRUCTION LAYOUT
RAY RANCH 0780 S16 PAD
NE1/4SW1/4 of SECTION 16, T7N, 80W, 6th PM

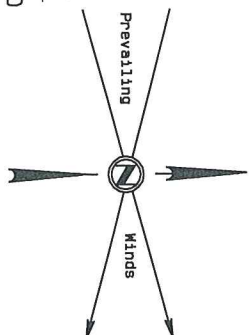
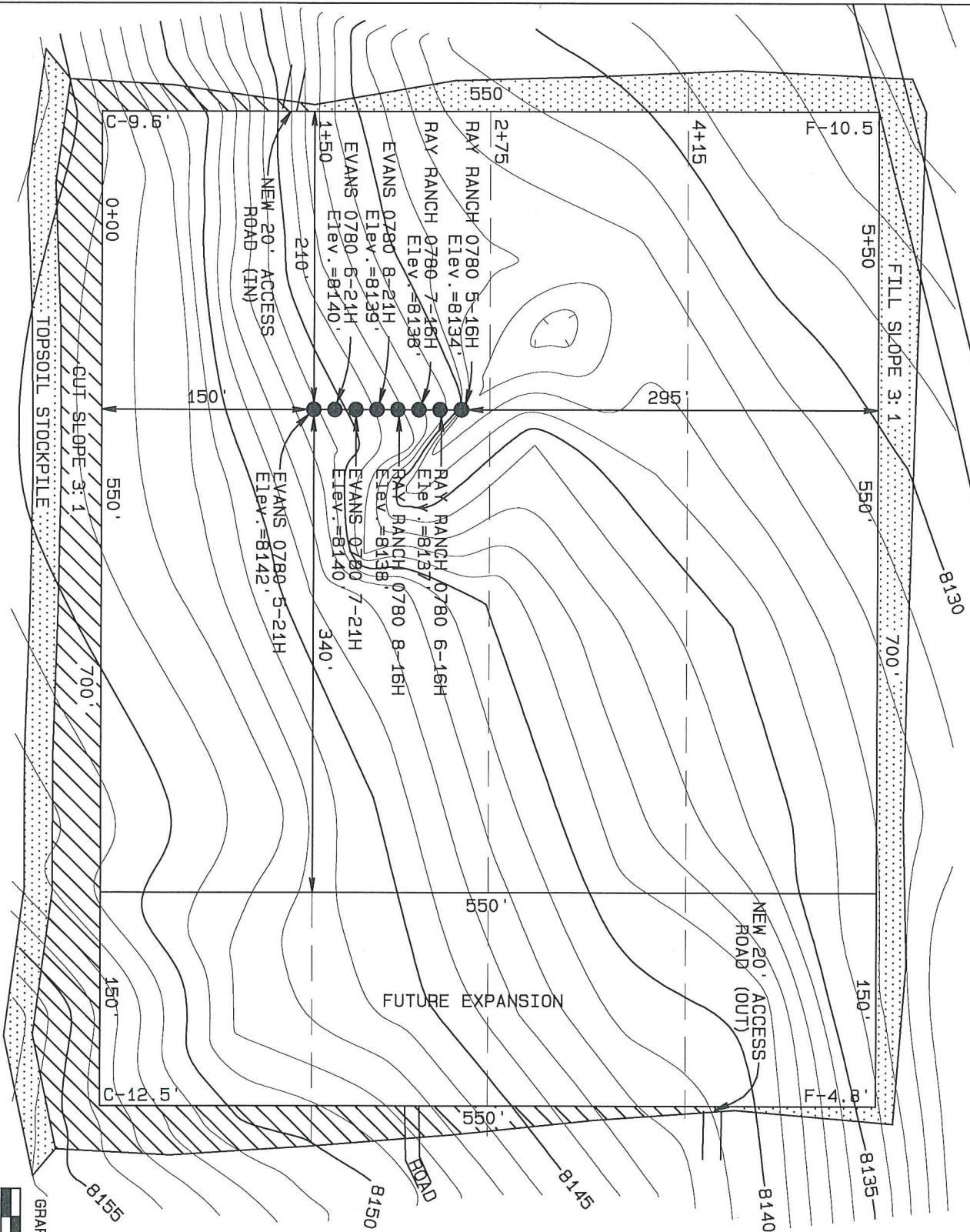

Final Pad Elevs.

NE 8139.3
SE 8141.0
SW 8139.3
NW 8137.7
Elev. for Surface
Locations are at
Ungraded Ground

Earthwork Estimate:

Total Excavation -
31285 Cu. Yd.

Pad Fill -

33978 Cu. Yd.

Topsoil Stockpile -
7130 Cu. Yd.

Pad Area - 8.84 acre

All fill shall be
compacted to 95%
Standard Proctor per
ASTM D698.



GRAPHIC SCALE 1"=100'



SandRidge Exploration & Production, LLC

CONSTRUCTION LAYOUT CROSS SECTION

RAY RANCH 0780 S16 PAD
NE1/4SW1/4 of SECTION 16, T7N, 80W, 6th PM

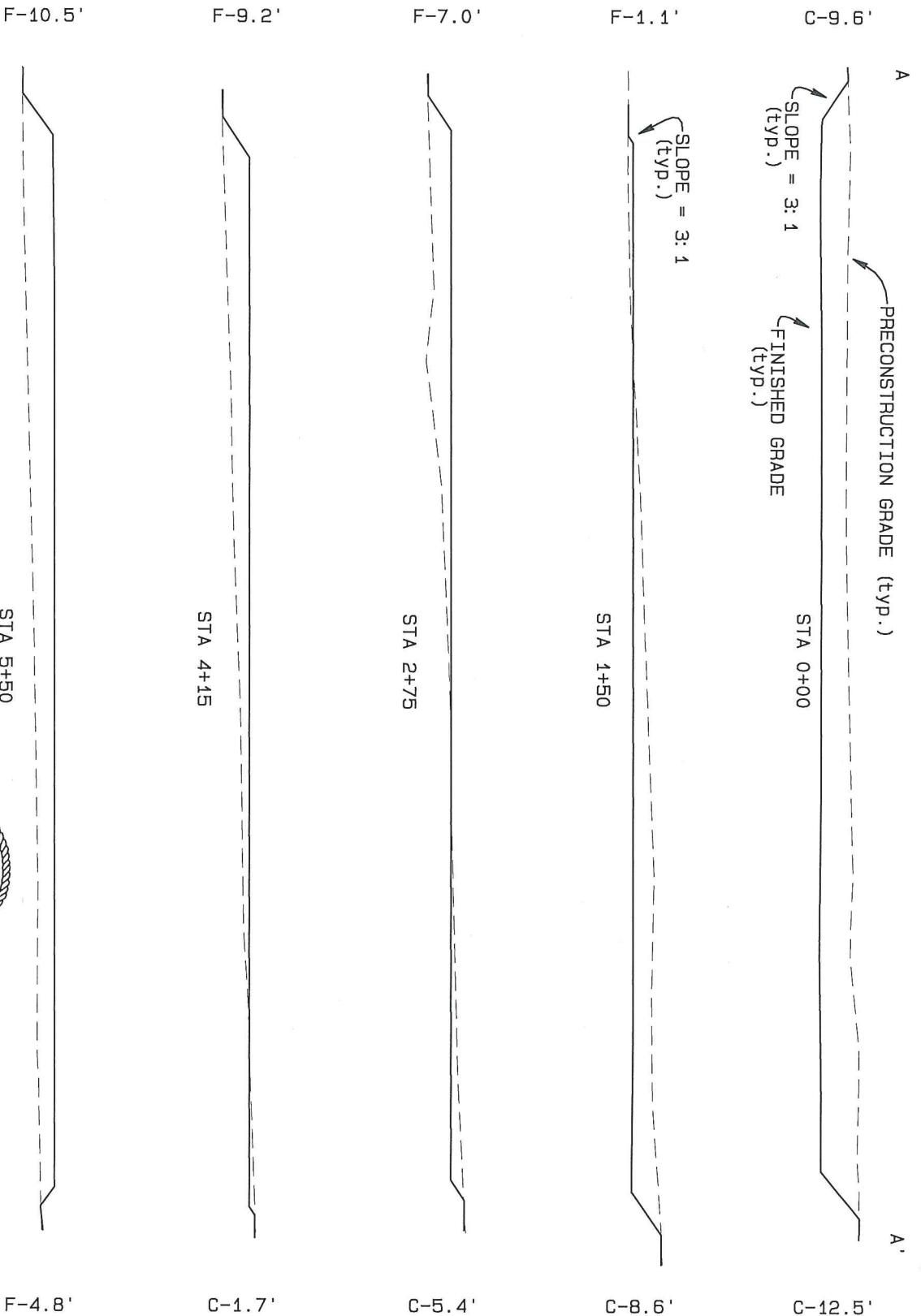

Vertical Exag = 2 Times
Final Pad Grade = Varies



GRAPHIC SCALE 1"=100'



NORTH PARK ENGINEERING & CONSULTING, INC.
PO Box 395
Walden, CO 80480
970-723-3725