

NARRATIVE ATTACHMENT

FORM 4 (SUNDRY NOTICE)

Culvert Pit Closure (Lower Horse Draw Unit 2108)

Document Date-10/10/2013

Introduction

Encana Oil & Gas (USA) Inc. (Encana) is submitting this Form 4 Sundry Notice to request final closure status for the culvert pit associated with the Lower Horse Draw Unit #2108 (COGCC facility #314308, COGCC remediation #7424). The site investigation was conducted by a third party contractor as authorized by Encana personnel and in accordance with the approved Form 27 previously submitted for this location. All samples were collected in accordance with Encana's Environmental Compliance Group's Sampling Procedures. The analytical results for the respective soil samples are provided in Table 1 and Attachment A of this submittal. The text below provides the details of the site investigation. For a visual description of the site please refer to Figures 1, 2, and 3 – Site Maps.

Assessment Activities

July 11, 2013 - The excavated soil surrounding the culvert pit was screened utilizing a photoionization detector (PID) prior to collecting soil samples for laboratory analysis. The culvert pit (steel ring, soil, no cement bottom) was carefully removed using a trackhoe and placed onsite for later recycling or disposal. It should be noted that there was no liquid/sludge associated with the bottom of the culvert pit during the time of removal. A grab sample was collected directly from the lowest point of the culvert pit after excavation. In addition, four (4) grab samples were collected, one from each excavated sidewall. Approximately 200 cubic yards of excavated material was removed from the pit and laid out in 1.5 foot tall (150' x 24') lift for evaluation of impacts. The excavated material was sampled by way of a nine (9) point composite sample. Four (4) background samples were collected from approximately six (6) inches beneath the grounds surface for analysis with regards to arsenic.

Analytical Review

Sample results indicate that soil within the culvert pit footprint on Encana's Lower Horse Draw Unit #2108 well pad, had organic constituent concentrations of the excavated area below or within COGCC Table 910-1 except for Total Petroleum Hydrocarbons (TPH) (862 ppm – east sidewall and 3,220 ppm – base). Analytical results indicated the excavated material exceeded COGCC Table 910-1 allowable concentrations for arsenic (3.9 ppm). Though the arsenic concentration in the soil is above the allowable concentration identified in Table 910-1, the concentration is below the range of arsenic background values (4.2 – 6.5 ppm) in this area. Based on these results and footnote 1 to COGCC Table 910-1, Encana requests that the COGCC consider the higher range of background arsenic value(s) as the allowable concentration for this constituent. Please see Table 1 and Attachment A for the analytical results.

Though the elevated arsenic level of the returned spoil material within the excavated footprint area is above the allowable levels identified in Table 910-1; it will be buried greater than three feet bgs of existing pad footprint material to assure that material with elevated level of arsenic will have no adverse effect on future re-vegetation efforts and receptors in the area. Please see Table 1 and Attachment A for analytical results.



NARRATIVE ATTACHMENT

FORM 4 (SUNDRY NOTICE)

Culvert Pit Closure (Lower Horse Draw Unit 2108)

Document Date-10/10/2013

The two samples (east sidewall and base) that exceeded COGCC Table 910-1 analytical value for TPH was resampled September 26, 2013 and analytical values indicated that they were below or within COGCC Table 910-1 allowable concentrations.

Conclusion

Based on the site investigation and analytical results, the culvert pit associated with the Lower Horse Draw Unit #2108 is in compliance with the standards specified within COGCC Table 910-1. Encana respectfully requests that final closure be granted for the respective pit, COGCC remediation #7424.

Notification of Completion

This Sundry Notice is also being submitted as the Notification of Completion for Remediation #7424. If the information provided here is satisfactory, please provide documentation of the closure of this remediation project.

Attachments

Topographic Location Map (Figure 1)
2108 Aerial map with sample locations (Figure 2)
2108 Site Diagram of Excavation and sample locations (Figure 3)
Laboratory Results Summary Table 1 – 2108 Site Investigation (Table 1)
Attachment A- Laboratory Reports





National Geographic, Esri,
DeLorme, NAVTEQ, UNEP-
WCMC, USGS, NASA, ESA,
METI, NRCAN, GEBCO,

Legend

- ★ 2108 Location

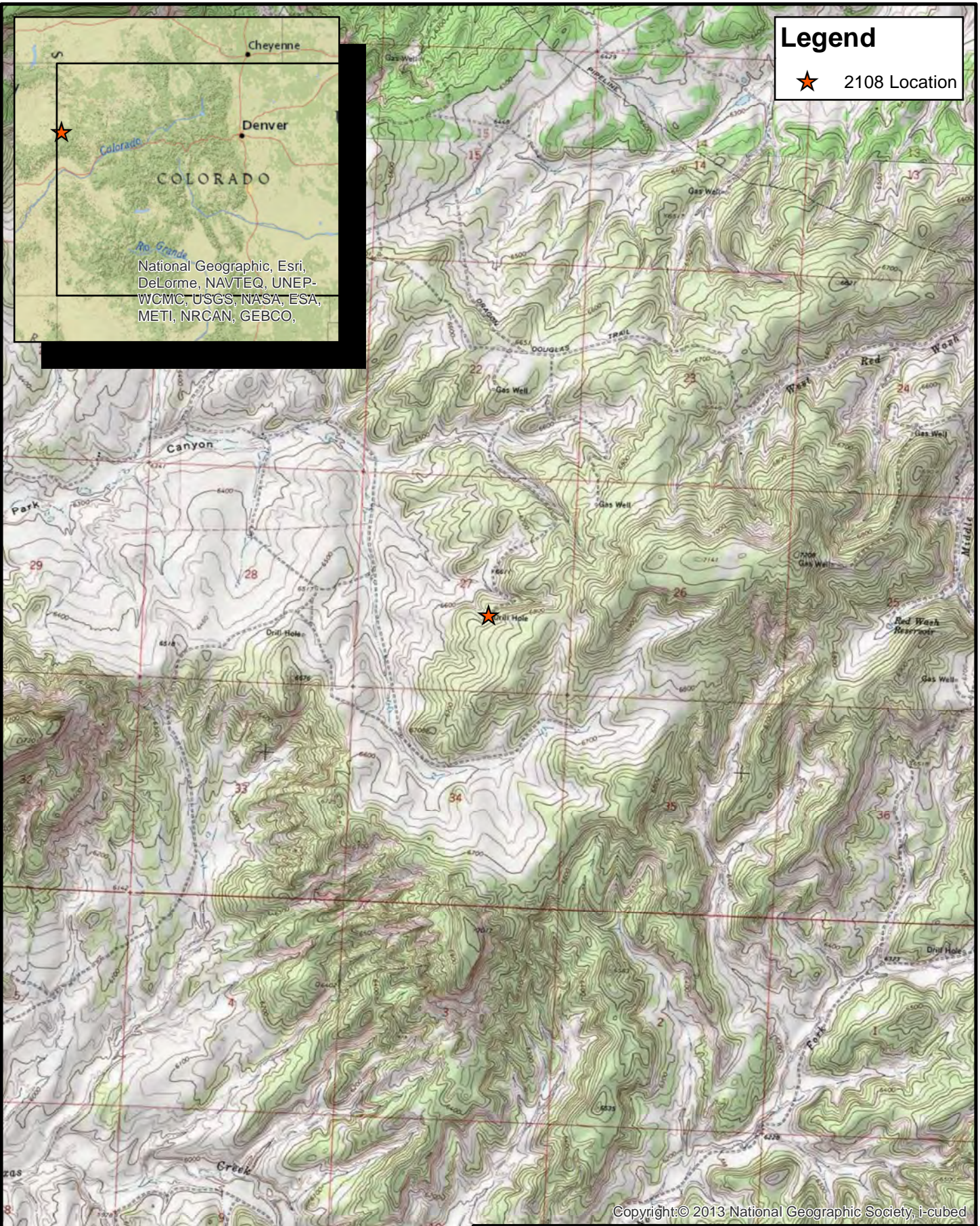

Copyright: © 2013 National Geographic Society, i-cubed

Rule Engineering, LLC
Solutions to Regulations for Industry

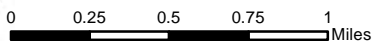

Location: 2108
QtrQtr, NWSE Sec, 27 Twp, 2S Rng, 103W
Site Map

Date: 10/7/2013

File: 2018 Site Location Map.pdf

Figure: 1



Legend

★ Soil Sample Location

0 37.5 75 150 225 Feet



Rule Engineering, LLC
Solutions to Regulations for Industry



**2108
Sample Location Map**

DATE: 10/7/2013 JG FILE: 2108 Sample Location Map.pdf

FIGURE: 2

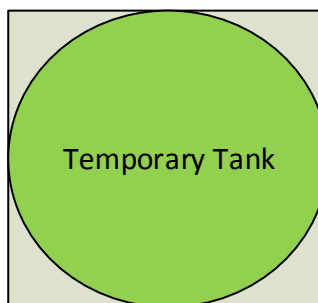
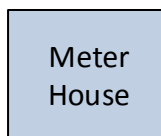
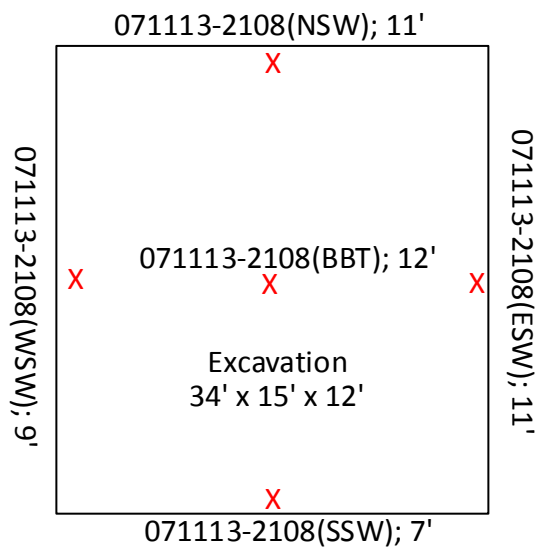

Direction of
Flow

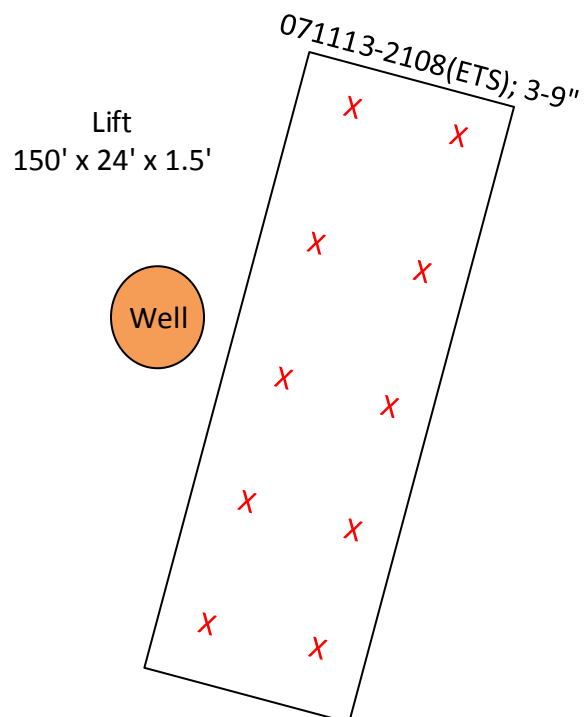

Legend
X-Sample



Well: Figure 3. 2108 Site Diagram

Area: Lower Horse Draw Unit

Legal: NWSE, Sec 27, 02S, 103W, 6th PM

Date: 07/31/13

Drawn By: Brad Ward

Revision Date:

Scale: None

Page 1 of 1

Appendix A



12065 Lebanon Rd.
Mt. Juliet, TN 37122
(615) 758-5858
1-800-767-5859
Fax (615) 758-5859

Tax I.D. 62-0814289

Est. 1970

Charles Jensen
EnCana Oil & Gas - Rangely, CO
1125 Escalante Drive
Rangely, CO 81648-3600

Report Summary

Monday July 22, 2013

Report Number: L646436

Samples Received: 07/13/13

Client Project: 2108

Description: 2108-Site Clearance

The analytical results in this report are based upon information supplied by you, the client, and are for your exclusive use. If you have any questions regarding this data package, please do not hesitate to call.

Entire Report Reviewed By:

T. Alan Harvill , ESC Representative

Laboratory Certification Numbers

A2LA - 1461-01, AIHA - 100789, AL - 40660, CA - 01157CA, CT - PH-0197,
FL - E87487, GA - 923, IN - C-TN-01, KY - 90010, KYUST - 0016,
NC - ENV375/DW21704/BIO041, ND - R-140, NJ - TN002, NJ NELAP - TN002,
SC - 84004, TN - 2006, VA - 460132, WV - 233, AZ - 0612,
MN - 047-999-395, NY - 11742, WI - 998093910, NV - TN000032011-1,
TX - T104704245-11-3, OK - 9915, PA - 68-02979, IA Lab #364

Accreditation is only applicable to the test methods specified on each scope of accreditation held by ESC Lab Sciences.

Note: The use of the preparatory EPA Method 3511 is not approved or endorsed by the CA ELAP.

This report may not be reproduced, except in full, without written approval from ESC Lab Sciences. Where applicable, sampling conducted by ESC is performed per guidance provided in laboratory standard operating procedures: 060302, 060303, and 060304.



12065 Lebanon Rd.
Mt. Juliet, TN 37122
(615) 758-5858
1-800-767-5859
Fax (615) 758-5859

Tax I.D. 62-0814289

Est. 1970

REPORT OF ANALYSIS

Charles Jensen
EnCana Oil & Gas - Rangely, CO
1125 Escalante Drive
Rangely, CO 81648-3600

July 22, 2013

Date Received : July 13, 2013
Description : 2108-Site Clearance
Sample ID : 071113-2108(NSW) 11 FT
Collected By : Brad Ward
Collection Date : 07/11/13 14:36

ESC Sample # : L646436-01

Site ID : 2108

Project # : 2108

| Parameter | Result | Det. Limit | Units | Method | Date | Dil. |
|-----------------------------|--------|------------|--------|-----------|----------|------|
| Benzene | BDL | 0.0025 | mg/kg | 8021/8015 | 07/14/13 | 5 |
| Toluene | BDL | 0.025 | mg/kg | 8021/8015 | 07/14/13 | 5 |
| Ethylbenzene | BDL | 0.0025 | mg/kg | 8021/8015 | 07/14/13 | 5 |
| Total Xylene | BDL | 0.0075 | mg/kg | 8021/8015 | 07/14/13 | 5 |
| TPH (GC/FID) Low Fraction | BDL | 0.50 | mg/kg | GRO | 07/14/13 | 5 |
| Surrogate Recovery-% | | | | | | |
| a,a,a-Trifluorotoluene(FID) | 101. | | % Rec. | 8021/8015 | 07/14/13 | 5 |
| a,a,a-Trifluorotoluene(PID) | 101. | | % Rec. | 8021/8015 | 07/14/13 | 5 |
| TPH (GC/FID) High Fraction | 22. | 4.0 | mg/kg | 3546/DRO | 07/19/13 | 1 |
| Surrogate recovery(%) | | | | | | |
| o-Terphenyl | 65.1 | | % Rec. | 3546/DRO | 07/19/13 | 1 |

BDL - Below Detection Limit

Det. Limit - Practical Quantitation Limit(PQL)

Note:

The reported analytical results relate only to the sample submitted.

This report shall not be reproduced, except in full, without the written approval from ESC.

Reported: 07/22/13 14:35 Printed: 07/22/13 14:35



12065 Lebanon Rd.
Mt. Juliet, TN 37122
(615) 758-5858
1-800-767-5859
Fax (615) 758-5859

Tax I.D. 62-0814289

Est. 1970

REPORT OF ANALYSIS

Charles Jensen
EnCana Oil & Gas - Rangely, CO
1125 Escalante Drive
Rangely, CO 81648-3600

July 22, 2013

Date Received : July 13, 2013
Description : 2108-Site Clearance
Sample ID : 071113-2108(ESW) 11 FT
Collected By : Brad Ward
Collection Date : 07/11/13 14:28

ESC Sample # : L646436-02

Site ID : 2108

Project # : 2108

| Parameter | Result | Det. Limit | Units | Method | Date | Dil. |
|-----------------------------|--------|------------|--------|-----------|----------|------|
| Benzene | 0.92 | 0.25 | mg/kg | 8021/8015 | 07/15/13 | 500 |
| Toluene | 5.2 | 2.5 | mg/kg | 8021/8015 | 07/15/13 | 500 |
| Ethylbenzene | 2.4 | 0.25 | mg/kg | 8021/8015 | 07/15/13 | 500 |
| Total Xylene | 24. | 0.75 | mg/kg | 8021/8015 | 07/15/13 | 500 |
| TPH (GC/FID) Low Fraction | 850 | 50. | mg/kg | GRO | 07/15/13 | 500 |
| Surrogate Recovery-% | | | | | | |
| a,a,a-Trifluorotoluene(FID) | 96.9 | | % Rec. | 8021/8015 | 07/15/13 | 500 |
| a,a,a-Trifluorotoluene(PID) | 102. | | % Rec. | 8021/8015 | 07/15/13 | 500 |
| TPH (GC/FID) High Fraction | 12. | 4.0 | mg/kg | 3546/DRO | 07/19/13 | 1 |
| Surrogate recovery(%) | | | | | | |
| o-Terphenyl | 60.2 | | % Rec. | 3546/DRO | 07/19/13 | 1 |

BDL - Below Detection Limit

Det. Limit - Practical Quantitation Limit(PQL)

Note:

The reported analytical results relate only to the sample submitted.

This report shall not be reproduced, except in full, without the written approval from ESC.

Reported: 07/22/13 14:35 Printed: 07/22/13 14:35



12065 Lebanon Rd.
Mt. Juliet, TN 37122
(615) 758-5858
1-800-767-5859
Fax (615) 758-5859

Tax I.D. 62-0814289

Est. 1970

REPORT OF ANALYSIS

Charles Jensen
EnCana Oil & Gas - Rangely, CO
1125 Escalante Drive
Rangely, CO 81648-3600

July 22, 2013

Date Received : July 13, 2013
Description : 2108-Site Clearance
Sample ID : 071113-2108(SSW) 7 FT
Collected By : Brad Ward
Collection Date : 07/11/13 14:44

ESC Sample # : L646436-03

Site ID : 2108

Project # : 2108

| Parameter | Result | Det. Limit | Units | Method | Date | Dil. |
|-----------------------------|--------|------------|--------|-----------|----------|------|
| Benzene | BDL | 0.0025 | mg/kg | 8021/8015 | 07/15/13 | 5 |
| Toluene | BDL | 0.025 | mg/kg | 8021/8015 | 07/15/13 | 5 |
| Ethylbenzene | BDL | 0.0025 | mg/kg | 8021/8015 | 07/15/13 | 5 |
| Total Xylene | BDL | 0.0075 | mg/kg | 8021/8015 | 07/15/13 | 5 |
| TPH (GC/FID) Low Fraction | BDL | 0.50 | mg/kg | GRO | 07/15/13 | 5 |
| Surrogate Recovery-% | | | | | | |
| a,a,a-Trifluorotoluene(FID) | 102. | | % Rec. | 8021/8015 | 07/15/13 | 5 |
| a,a,a-Trifluorotoluene(PID) | 98.6 | | % Rec. | 8021/8015 | 07/15/13 | 5 |
| TPH (GC/FID) High Fraction | BDL | 4.0 | mg/kg | 3546/DRO | 07/19/13 | 1 |
| Surrogate recovery(%) | | | | | | |
| o-Terphenyl | 65.2 | | % Rec. | 3546/DRO | 07/19/13 | 1 |

BDL - Below Detection Limit

Det. Limit - Practical Quantitation Limit(PQL)

Note:

The reported analytical results relate only to the sample submitted.

This report shall not be reproduced, except in full, without the written approval from ESC.

Reported: 07/22/13 14:35 Printed: 07/22/13 14:35



12065 Lebanon Rd.
Mt. Juliet, TN 37122
(615) 758-5858
1-800-767-5859
Fax (615) 758-5859

Tax I.D. 62-0814289

Est. 1970

REPORT OF ANALYSIS

Charles Jensen
EnCana Oil & Gas - Rangely, CO
1125 Escalante Drive
Rangely, CO 81648-3600

July 22, 2013

Date Received : July 13, 2013
Description : 2108-Site Clearance
Sample ID : 071113-2108(WSW) 9 FT
Collected By : Brad Ward
Collection Date : 07/11/13 14:53

ESC Sample # : L646436-04

Site ID : 2108

Project # : 2108

| Parameter | Result | Det. Limit | Units | Method | Date | Dil. |
|-----------------------------|--------|------------|--------|-----------|----------|------|
| Benzene | BDL | 0.0025 | mg/kg | 8021/8015 | 07/15/13 | 5 |
| Toluene | BDL | 0.025 | mg/kg | 8021/8015 | 07/15/13 | 5 |
| Ethylbenzene | BDL | 0.0025 | mg/kg | 8021/8015 | 07/15/13 | 5 |
| Total Xylene | BDL | 0.0075 | mg/kg | 8021/8015 | 07/15/13 | 5 |
| TPH (GC/FID) Low Fraction | BDL | 0.50 | mg/kg | GRO | 07/15/13 | 5 |
| Surrogate Recovery-% | | | | | | |
| a,a,a-Trifluorotoluene(FID) | 102. | | % Rec. | 8021/8015 | 07/15/13 | 5 |
| a,a,a-Trifluorotoluene(PID) | 100. | | % Rec. | 8021/8015 | 07/15/13 | 5 |
| TPH (GC/FID) High Fraction | 35. | 4.0 | mg/kg | 3546/DRO | 07/19/13 | 1 |
| Surrogate recovery(%) | | | | | | |
| o-Terphenyl | 64.7 | | % Rec. | 3546/DRO | 07/19/13 | 1 |

BDL - Below Detection Limit

Det. Limit - Practical Quantitation Limit(PQL)

Note:

The reported analytical results relate only to the sample submitted.

This report shall not be reproduced, except in full, without the written approval from ESC.

Reported: 07/22/13 14:35 Printed: 07/22/13 14:35



12065 Lebanon Rd.
Mt. Juliet, TN 37122
(615) 758-5858
1-800-767-5859
Fax (615) 758-5859

Tax I.D. 62-0814289

Est. 1970

REPORT OF ANALYSIS

July 22, 2013

Charles Jensen
EnCana Oil & Gas - Rangely, CO
1125 Escalante Drive
Rangely, CO 81648-3600

ESC Sample # : L646436-05

Date Received : July 13, 2013
Description : 2108-Site Clearance

Site ID : 2108

Sample ID : 071113-2108(BBT) 12 FT

Project # : 2108

Collected By : Brad Ward
Collection Date : 07/11/13 15:02

| Parameter | Result | Det. Limit | Units | Method | Date | Dil. |
|-----------------------------|--------|------------|--------|-----------|----------|------|
| Benzene | 4.2 | 0.50 | mg/kg | 8021/8015 | 07/15/13 | 1000 |
| Toluene | 9.6 | 5.0 | mg/kg | 8021/8015 | 07/15/13 | 1000 |
| Ethylbenzene | 5.1 | 0.50 | mg/kg | 8021/8015 | 07/15/13 | 1000 |
| Total Xylene | 66. | 1.5 | mg/kg | 8021/8015 | 07/15/13 | 1000 |
| TPH (GC/FID) Low Fraction | 2900 | 100 | mg/kg | GRO | 07/15/13 | 1000 |
| Surrogate Recovery-% | | | | | | |
| a,a,a-Trifluorotoluene(FID) | 94.5 | | % Rec. | 8021/8015 | 07/15/13 | 1000 |
| a,a,a-Trifluorotoluene(PID) | 102. | | % Rec. | 8021/8015 | 07/15/13 | 1000 |
| TPH (GC/FID) High Fraction | 320 | 4.0 | mg/kg | 3546/DRO | 07/19/13 | 1 |
| Surrogate recovery(%) | | | | | | |
| o-Terphenyl | 81.8 | | % Rec. | 3546/DRO | 07/19/13 | 1 |

BDL - Below Detection Limit

Det. Limit - Practical Quantitation Limit(PQL)

Note:

The reported analytical results relate only to the sample submitted.

This report shall not be reproduced, except in full, without the written approval from ESC.

Reported: 07/22/13 14:35 Printed: 07/22/13 14:35



12065 Lebanon Rd.
Mt. Juliet, TN 37122
(615) 758-5858
1-800-767-5859
Fax (615) 758-5859

Tax I.D. 62-0814289

Est. 1970

REPORT OF ANALYSIS

Charles Jensen
EnCana Oil & Gas - Rangely, CO
1125 Escalante Drive
Rangely, CO 81648-3600

July 22, 2013

Date Received : July 13, 2013
Description : 2108-Site Clearance
Sample ID : 071113-2108(ETS) 3-9 IN
Collected By : Brad Ward
Collection Date : 07/11/13 16:10

ESC Sample # : L646436-06

Site ID : 2108

Project # : 2108

| Parameter | Result | Det. Limit | Units | Method | Date | Dil. |
|-----------------------------------|--------|------------|----------|-------------|----------|------|
| Chromium, Hexavalent | BDL | 2.0 | mg/kg | 3060A/7196A | 07/18/13 | 1 |
| Chromium, Trivalent | 6.0 | 2.0 | mg/kg | Calc. | 07/20/13 | 1 |
| ORP | 240 | | mV | 2580 B-2011 | 07/19/13 | 1 |
| pH | 8.0 | | su | 9045D | 07/18/13 | 1 |
| Sodium Adsorption Ratio | 1.8 | | | Calc. | 07/22/13 | 1 |
| Specific Conductance | 800 | | umhos/cm | 9050AMod | 07/19/13 | 1 |
| Mercury | 0.020 | 0.020 | mg/kg | 7471 | 07/16/13 | 1 |
| Arsenic | 3.9 | 1.0 | mg/kg | 6010B | 07/20/13 | 1 |
| Barium | 62. | 0.25 | mg/kg | 6010B | 07/20/13 | 1 |
| Cadmium | BDL | 0.25 | mg/kg | 6010B | 07/20/13 | 1 |
| Chromium | 6.0 | 0.50 | mg/kg | 6010B | 07/20/13 | 1 |
| Copper | 7.9 | 1.0 | mg/kg | 6010B | 07/20/13 | 1 |
| Lead | 7.2 | 0.25 | mg/kg | 6010B | 07/20/13 | 1 |
| Nickel | 8.8 | 1.0 | mg/kg | 6010B | 07/20/13 | 1 |
| Selenium | BDL | 1.0 | mg/kg | 6010B | 07/20/13 | 1 |
| Silver | BDL | 0.50 | mg/kg | 6010B | 07/20/13 | 1 |
| Zinc | 65. | 1.5 | mg/kg | 6010B | 07/20/13 | 1 |
| Benzene | BDL | 0.0025 | mg/kg | 8021/8015 | 07/15/13 | 5 |
| Toluene | BDL | 0.025 | mg/kg | 8021/8015 | 07/15/13 | 5 |
| Ethylbenzene | BDL | 0.0025 | mg/kg | 8021/8015 | 07/15/13 | 5 |
| Total Xylene | 0.027 | 0.0075 | mg/kg | 8021/8015 | 07/15/13 | 5 |
| TPH (GC/FID) Low Fraction | 9.2 | 0.50 | mg/kg | GRO | 07/15/13 | 5 |
| Surrogate Recovery-% | | | | | | |
| a,a,a-Trifluorotoluene(FID) | 100. | | % Rec. | 8021/8015 | 07/15/13 | 5 |
| a,a,a-Trifluorotoluene(PID) | 101. | | % Rec. | 8021/8015 | 07/15/13 | 5 |
| TPH (GC/FID) High Fraction | 31. | 4.0 | mg/kg | 3546/DRO | 07/19/13 | 1 |
| Surrogate recovery(%) | | | | | | |
| o-Terphenyl | 60.6 | | % Rec. | 3546/DRO | 07/19/13 | 1 |
| Polynuclear Aromatic Hydrocarbons | | | | | | |
| Anthracene | BDL | 0.0060 | mg/kg | 8270C-SIM | 07/17/13 | 1 |
| Acenaphthene | 0.0064 | 0.0060 | mg/kg | 8270C-SIM | 07/17/13 | 1 |
| Acenaphthylene | BDL | 0.0060 | mg/kg | 8270C-SIM | 07/17/13 | 1 |
| Benzo(a)anthracene | BDL | 0.0060 | mg/kg | 8270C-SIM | 07/17/13 | 1 |
| Benzo(a)pyrene | BDL | 0.0060 | mg/kg | 8270C-SIM | 07/17/13 | 1 |

BDL - Below Detection Limit
Det. Limit - Practical Quantitation Limit(PQL)
L646436-06 (PH) - 8.0@23.0c



12065 Lebanon Rd.
Mt. Juliet, TN 37122
(615) 758-5858
1-800-767-5859
Fax (615) 758-5859

Tax I.D. 62-0814289

Est. 1970

REPORT OF ANALYSIS

Charles Jensen
EnCana Oil & Gas - Rangely, CO
1125 Escalante Drive
Rangely, CO 81648-3600

July 22, 2013

Date Received : July 13, 2013
Description : 2108-Site Clearance
Sample ID : 071113-2108(ETS) 3-9 IN
Collected By : Brad Ward
Collection Date : 07/11/13 16:10

ESC Sample # : L646436-06

Site ID : 2108

Project # : 2108

| Parameter | Result | Det. Limit | Units | Method | Date | Dil. |
|------------------------|--------|------------|--------|-----------|----------|------|
| Benzo(b)fluoranthene | BDL | 0.0060 | mg/kg | 8270C-SIM | 07/17/13 | 1 |
| Benzo(g,h,i)perylene | BDL | 0.0060 | mg/kg | 8270C-SIM | 07/17/13 | 1 |
| Benzo(k)fluoranthene | BDL | 0.0060 | mg/kg | 8270C-SIM | 07/17/13 | 1 |
| Chrysene | BDL | 0.0060 | mg/kg | 8270C-SIM | 07/17/13 | 1 |
| Dibenz(a,h)anthracene | BDL | 0.0060 | mg/kg | 8270C-SIM | 07/17/13 | 1 |
| Fluoranthene | BDL | 0.0060 | mg/kg | 8270C-SIM | 07/17/13 | 1 |
| Fluorene | BDL | 0.0060 | mg/kg | 8270C-SIM | 07/17/13 | 1 |
| Indeno(1,2,3-cd)pyrene | BDL | 0.0060 | mg/kg | 8270C-SIM | 07/17/13 | 1 |
| Naphthalene | 0.039 | 0.020 | mg/kg | 8270C-SIM | 07/17/13 | 1 |
| Phenanthrene | BDL | 0.0060 | mg/kg | 8270C-SIM | 07/17/13 | 1 |
| Pyrene | BDL | 0.0060 | mg/kg | 8270C-SIM | 07/17/13 | 1 |
| 1-Methylnaphthalene | 0.054 | 0.020 | mg/kg | 8270C-SIM | 07/17/13 | 1 |
| 2-Methylnaphthalene | 0.041 | 0.020 | mg/kg | 8270C-SIM | 07/17/13 | 1 |
| 2-Chloronaphthalene | BDL | 0.020 | mg/kg | 8270C-SIM | 07/17/13 | 1 |
| Surrogate Recovery | | | | | | |
| Nitrobenzene-d5 | 104. | | % Rec. | 8270C-SIM | 07/17/13 | 1 |
| 2-Fluorobiphenyl | 74.5 | | % Rec. | 8270C-SIM | 07/17/13 | 1 |
| p-Terphenyl-d14 | 85.1 | | % Rec. | 8270C-SIM | 07/17/13 | 1 |

BDL - Below Detection Limit

Det. Limit - Practical Quantitation Limit(PQL)

Note:

The reported analytical results relate only to the sample submitted.

This report shall not be reproduced, except in full, without the written approval from ESC.

Reported: 07/22/13 14:35 Printed: 07/22/13 14:35
L646436-06 (PH) - 8.0@23.0c

Summary of Remarks For Samples Printed
07/22/13 at 14:35:58

TSR Signing Reports: 358
R5 - Desired TAT

Sample: L646436-01 Account: ENCANRCO Received: 07/13/13 09:30 Due Date: 07/19/13 00:00 RPT Date: 07/22/13 14:35
Sample: L646436-02 Account: ENCANRCO Received: 07/13/13 09:30 Due Date: 07/19/13 00:00 RPT Date: 07/22/13 14:35
Sample: L646436-03 Account: ENCANRCO Received: 07/13/13 09:30 Due Date: 07/19/13 00:00 RPT Date: 07/22/13 14:35
Sample: L646436-04 Account: ENCANRCO Received: 07/13/13 09:30 Due Date: 07/19/13 00:00 RPT Date: 07/22/13 14:35
Sample: L646436-05 Account: ENCANRCO Received: 07/13/13 09:30 Due Date: 07/19/13 00:00 RPT Date: 07/22/13 14:35
Sample: L646436-06 Account: ENCANRCO Received: 07/13/13 09:30 Due Date: 07/19/13 00:00 RPT Date: 07/22/13 14:35

| Company Name/Address *ENCANRCO-RULEENG* Encana Oil & Gas 143 DIAMOND AVE PARACHUTE, CO 81635 *ENCANRCO-RULEENG* | | | | Billing Information Charlie Jensen 143 Diamond Ave Parachute, CO 81635 <hr/> Report to: Charlie Jensen <hr/> E-mail to: Charlie Jensen, Shad Johnson, Brad Ward | | | | Analysis/Container/Preservative | | | | | | | | Chain of Custody Page 1 of 1 Prepared by: G036 ENVIRONMENTAL SCIENCE CORP 12065 Lebanon Road Mt. Juliet TN 37122 Phone (615)758-5858 Phone (800) 767-5859 FAX (615)758-5859 | | | | | | | | | | | | | | | | | | | | | | | | | | | | | | | | | | | | | | | | | | | | | | | | | | | | | | | | | | | | | | | | | | | | | | | | | | | | | | | | | | | | | | | | | | | | | | | | | | | | | | | | | | | | | | | | | | | | | | | | | | | | | | | | | | | | | | | | | | | | | | | | | | | | | | | | | | | | | | | | | | | | | | | | | | | | | | | | | | | | | | | | | | | | | | | | | | | | | | | | | | | | | | | | | | | | | | | | | | | | | | | | | | | | | | | | | | | |
|---|------------------------|---|-------------|---|--------------------|----------------------------|---------------------------|---|------------------|-------------|---|--|-------------|-----------|---------------------|--|-------|---------------------------|------------------------|------------------|---------------------------|---|--------------------|-------------|---|--------------------|-------------|----|---------------------|---------------------|----------------------|------|----|-----|---------|------|---|---|--|--|--|--|--|--|--|--|-----------|----------------------|------|----|-----|--|------|---|---|--|--|--|--|--|--|--|--|----|---------------------|------|----|----|--|------|---|---|--|--|--|--|--|--|--|--|----|---------------------|------|----|----|--|------|---|---|--|--|--|--|--|--|--|--|----|----------------------|------|----|-----|--|------|---|---|--|--|--|--|--|--|--|--|----|-----------------------|------|----|------|---|-------|---|---|---|---|---|---|---|---|--|--|----|--|--|--|--|--|--|--|--|--|--|--|--|--|--|--|--|--|--|--|--|--|--|--|--|--|--|--|--|--|--|--|--|--|--|--|--|--|--|--|--|--|--|--|--|--|--|--|--|--|--|--|--|--|--|--|--|--|--|--|--|--|--|--|--|--|--|--|--|--|--|--|--|--|--|--|--|--|--|--|--|--|--|--|--|--|--|--|--|--|--|--|--|--|--|--|--|--|--|--|--|--|--|--|--|--|--|--|--|--|--|--|--|--|--|--|--|--|--|--|
| | | | | | | | | <table border="1" style="width:100%; border-collapse: collapse;"> <tr> <td style="width:15%;">BTEXGRO / DRO - 8260/8015</td> <td style="width:15%;">SV8270PAHSIM - 8270SIM</td> <td style="width:15%;">SPCON - 9050AMod</td> <td style="width:15%;">SAR - Calc.</td> <td style="width:15%;">RCRA8 Metals + Cu, Ni, and Zn - 6010/7470</td> <td style="width:15%;">CR6SS - 3060A/7196</td> <td style="width:15%;">CR3 - Calc.</td> <td style="width:15%;">AS</td> </tr> </table> | | | | | | | | | | BTEXGRO / DRO - 8260/8015 | SV8270PAHSIM - 8270SIM | SPCON - 9050AMod | SAR - Calc. | RCRA8 Metals + Cu, Ni, and Zn - 6010/7470 | CR6SS - 3060A/7196 | CR3 - Calc. | AS | | | | | | | | | | | | | | | | | | | | | | | | | | | | | | | | | | | | | | | | | | | | | | | | | | | | | | | | | | | | | | | | | | | | | | | | | | | | | | | | | | | | | | | | | | | | | | | | | | | | | | | | | | | | | | | | | | | | | | | | | | | | | | | | | | | | | | | | | | | | | | | | | | | | | | | | | | | | | | | | | | | | | | | | | | | | | | | | | | | | | | | | | | | | | | | | | | | | | | | | | | | | | | | | | | | | | | | | | | | | | | | | | | |
| BTEXGRO / DRO - 8260/8015 | SV8270PAHSIM - 8270SIM | SPCON - 9050AMod | SAR - Calc. | RCRA8 Metals + Cu, Ni, and Zn - 6010/7470 | CR6SS - 3060A/7196 | CR3 - Calc. | AS | | | | | | | | | | | | | | | | | | | | | | | | | | | | | | | | | | | | | | | | | | | | | | | | | | | | | | | | | | | | | | | | | | | | | | | | | | | | | | | | | | | | | | | | | | | | | | | | | | | | | | | | | | | | | | | | | | | | | | | | | | | | | | | | | | | | | | | | | | | | | | | | | | | | | | | | | | | | | | | | | | | | | | | | | | | | | | | | | | | | | | | | | | | | | | | | | | | | | | | | | | | | | | | | | | | | | | | | | | | | | | | | | | | | | | | | | | | | | | | | | | | | |
| Project Description: 2108 - SITE CLEARANCE | | | | Client Project No. 2108 | | | | ENCANRCO-RULEENG | | | | CoCode (lab use only) *ENCANRCO-RULEENG* Template/Prelogin Shipped Via: | | | | | | | | | | | | | | | | | | | | | | | | | | | | | | | | | | | | | | | | | | | | | | | | | | | | | | | | | | | | | | | | | | | | | | | | | | | | | | | | | | | | | | | | | | | | | | | | | | | | | | | | | | | | | | | | | | | | | | | | | | | | | | | | | | | | | | | | | | | | | | | | | | | | | | | | | | | | | | | | | | | | | | | | | | | | | | | | | | | | | | | | | | | | | | | | | | | | | | | | | | | | | | | | | | | | | | | | | | | | | | | | | | | | | | | | | | | | | | | |
| PHONE: 970-285-2735 FAX: | | Site/Facility ID# 2108 | | P.O.# | | Date Results Needed | | No | | | | | | | | | | | | | | | | | | | | | | | | | | | | | | | | | | | | | | | | | | | | | | | | | | | | | | | | | | | | | | | | | | | | | | | | | | | | | | | | | | | | | | | | | | | | | | | | | | | | | | | | | | | | | | | | | | | | | | | | | | | | | | | | | | | | | | | | | | | | | | | | | | | | | | | | | | | | | | | | | | | | | | | | | | | | | | | | | | | | | | | | | | | | | | | | | | | | | | | | | | | | | | | | | | | | | | | | | | | | | | | | | | | | | | | | | | | | | | | | | | | |
| Collected by: Brad Ward (Signature: BW WW) | | Rush? (Lab MUST be Notified) <input type="checkbox"/> Same Day.....200% <input type="checkbox"/> Next Day.....100% <input type="checkbox"/> Two Day.....50% | | Email? <input type="checkbox"/> No <input checked="" type="checkbox"/> Yes FAX? <input type="checkbox"/> No <input checked="" type="checkbox"/> Yes | | of | | Cntrs | | | | | | | | | | | | | | | | | | | | | | | | | | | | | | | | | | | | | | | | | | | | | | | | | | | | | | | | | | | | | | | | | | | | | | | | | | | | | | | | | | | | | | | | | | | | | | | | | | | | | | | | | | | | | | | | | | | | | | | | | | | | | | | | | | | | | | | | | | | | | | | | | | | | | | | | | | | | | | | | | | | | | | | | | | | | | | | | | | | | | | | | | | | | | | | | | | | | | | | | | | | | | | | | | | | | | | | | | | | | | | | | | | | | | | | | | | | | | | | | | | | |
| Immediately Packed on Ice N <input type="checkbox"/> Y <input checked="" type="checkbox"/> | | | | | | | | | | | | | | | | | | | | | | | | | | | | | | | | | | | | | | | | | | | | | | | | | | | | | | | | | | | | | | | | | | | | | | | | | | | | | | | | | | | | | | | | | | | | | | | | | | | | | | | | | | | | | | | | | | | | | | | | | | | | | | | | | | | | | | | | | | | | | | | | | | | | | | | | | | | | | | | | | | | | | | | | | | | | | | | | | | | | | | | | | | | | | | | | | | | | | | | | | | | | | | | | | | | | | | | | | | | | | | | | | | | | | | | | | | | | | | | | | | | | | | | | | | | |
| <table border="1" style="width:100%; border-collapse: collapse;"> <thead> <tr> <th>Sample ID</th> <th>Comp/Grab</th> <th>Matrix</th> <th>Depth</th> <th>Date</th> <th>Time</th> <th>Cntrs</th> <th>BTEXGRO / DRO - 8260/8015</th> <th>SV8270PAHSIM - 8270SIM</th> <th>SPCON - 9050AMod</th> <th>SAR - Calc.</th> <th>RCRA8 Metals + Cu, Ni, and Zn - 6010/7470</th> <th>CR6SS - 3060A/7196</th> <th>CR3 - Calc.</th> <th>AS</th> <th>Remarks/contaminant</th> <th>Sample # (lab only)</th> </tr> </thead> <tbody> <tr> <td>071113-2108(NSW) 11'</td> <td>GRAB</td> <td>SS</td> <td>11'</td> <td>7/11/13</td> <td>1436</td> <td>2</td> <td>X</td> <td></td> <td></td> <td></td> <td></td> <td></td> <td></td> <td></td> <td></td> <td>646436-01</td> </tr> <tr> <td>071113-2108(ESW) 11'</td> <td>GRAB</td> <td>SS</td> <td>11'</td> <td></td> <td>1428</td> <td>2</td> <td>X</td> <td></td> <td></td> <td></td> <td></td> <td></td> <td></td> <td></td> <td></td> <td>02</td> </tr> <tr> <td>071113-2108(SSW) 7'</td> <td>GRAB</td> <td>SS</td> <td>7'</td> <td></td> <td>1444</td> <td>2</td> <td>X</td> <td></td> <td></td> <td></td> <td></td> <td></td> <td></td> <td></td> <td></td> <td>03</td> </tr> <tr> <td>071113-2108(WSW) 9'</td> <td>GRAB</td> <td>SS</td> <td>9'</td> <td></td> <td>1453</td> <td>2</td> <td>X</td> <td></td> <td></td> <td></td> <td></td> <td></td> <td></td> <td></td> <td></td> <td>04</td> </tr> <tr> <td>071113-2108(BBT) 12'</td> <td>GRAB</td> <td>SS</td> <td>12'</td> <td></td> <td>1502</td> <td>2</td> <td>X</td> <td></td> <td></td> <td></td> <td></td> <td></td> <td></td> <td></td> <td></td> <td>05</td> </tr> <tr> <td>071113-2108(ETB) 3-9"</td> <td>COMP</td> <td>SS</td> <td>3-9"</td> <td>✓</td> <td>11010</td> <td>3</td> <td>X</td> <td>X</td> <td>X</td> <td>X</td> <td>X</td> <td>X</td> <td>X</td> <td></td> <td></td> <td>06</td> </tr> <tr><td> </td><td></td><td></td><td></td><td></td><td></td><td></td><td></td><td></td><td></td><td></td><td></td><td></td><td></td><td></td><td></td><td></td></tr> <tr><td> </td><td></td><td></td><td></td><td></td><td></td><td></td><td></td><td></td><td></td><td></td><td></td><td></td><td></td><td></td><td></td><td></td></tr> <tr><td> </td><td></td><td></td><td></td><td></td><td></td><td></td><td></td><td></td><td></td><td></td><td></td><td></td><td></td><td></td><td></td><td></td></tr> <tr><td> </td><td></td><td></td><td></td><td></td><td></td><td></td><td></td><td></td><td></td><td></td><td></td><td></td><td></td><td></td><td></td><td></td></tr> <tr><td> </td><td></td><td></td><td></td><td></td><td></td><td></td><td></td><td></td><td></td><td></td><td></td><td></td><td></td><td></td><td></td><td></td></tr> <tr><td> </td><td></td><td></td><td></td><td></td><td></td><td></td><td></td><td></td><td></td><td></td><td></td><td></td><td></td><td></td><td></td><td></td></tr> <tr><td> </td><td></td><td></td><td></td><td></td><td></td><td></td><td></td><td></td><td></td><td></td><td></td><td></td><td></td><td></td><td></td><td></td></tr> </tbody> </table> | | | | | | | | | | | | | | Sample ID | Comp/Grab | Matrix | Depth | Date | Time | Cntrs | BTEXGRO / DRO - 8260/8015 | SV8270PAHSIM - 8270SIM | SPCON - 9050AMod | SAR - Calc. | RCRA8 Metals + Cu, Ni, and Zn - 6010/7470 | CR6SS - 3060A/7196 | CR3 - Calc. | AS | Remarks/contaminant | Sample # (lab only) | 071113-2108(NSW) 11' | GRAB | SS | 11' | 7/11/13 | 1436 | 2 | X | | | | | | | | | 646436-01 | 071113-2108(ESW) 11' | GRAB | SS | 11' | | 1428 | 2 | X | | | | | | | | | 02 | 071113-2108(SSW) 7' | GRAB | SS | 7' | | 1444 | 2 | X | | | | | | | | | 03 | 071113-2108(WSW) 9' | GRAB | SS | 9' | | 1453 | 2 | X | | | | | | | | | 04 | 071113-2108(BBT) 12' | GRAB | SS | 12' | | 1502 | 2 | X | | | | | | | | | 05 | 071113-2108(ETB) 3-9" | COMP | SS | 3-9" | ✓ | 11010 | 3 | X | X | X | X | X | X | X | | | 06 | | | | | | | | | | | | | | | | | | | | | | | | | | | | | | | | | | | | | | | | | | | | | | | | | | | | | | | | | | | | | | | | | | | | | | | | | | | | | | | | | | | | | | | | | | | | | | | | | | | | | | | | | | | | | | | | | | | | | | | |
| Sample ID | Comp/Grab | Matrix | Depth | Date | Time | Cntrs | BTEXGRO / DRO - 8260/8015 | SV8270PAHSIM - 8270SIM | SPCON - 9050AMod | SAR - Calc. | RCRA8 Metals + Cu, Ni, and Zn - 6010/7470 | CR6SS - 3060A/7196 | CR3 - Calc. | AS | Remarks/contaminant | Sample # (lab only) | | | | | | | | | | | | | | | | | | | | | | | | | | | | | | | | | | | | | | | | | | | | | | | | | | | | | | | | | | | | | | | | | | | | | | | | | | | | | | | | | | | | | | | | | | | | | | | | | | | | | | | | | | | | | | | | | | | | | | | | | | | | | | | | | | | | | | | | | | | | | | | | | | | | | | | | | | | | | | | | | | | | | | | | | | | | | | | | | | | | | | | | | | | | | | | | | | | | | | | | | | | | | | | | | | | | | | | | | | | | | | | | | | | | | | | | | | | |
| 071113-2108(NSW) 11' | GRAB | SS | 11' | 7/11/13 | 1436 | 2 | X | | | | | | | | | 646436-01 | | | | | | | | | | | | | | | | | | | | | | | | | | | | | | | | | | | | | | | | | | | | | | | | | | | | | | | | | | | | | | | | | | | | | | | | | | | | | | | | | | | | | | | | | | | | | | | | | | | | | | | | | | | | | | | | | | | | | | | | | | | | | | | | | | | | | | | | | | | | | | | | | | | | | | | | | | | | | | | | | | | | | | | | | | | | | | | | | | | | | | | | | | | | | | | | | | | | | | | | | | | | | | | | | | | | | | | | | | | | | | | | | | | | | | | | | | | |
| 071113-2108(ESW) 11' | GRAB | SS | 11' | | 1428 | 2 | X | | | | | | | | | 02 | | | | | | | | | | | | | | | | | | | | | | | | | | | | | | | | | | | | | | | | | | | | | | | | | | | | | | | | | | | | | | | | | | | | | | | | | | | | | | | | | | | | | | | | | | | | | | | | | | | | | | | | | | | | | | | | | | | | | | | | | | | | | | | | | | | | | | | | | | | | | | | | | | | | | | | | | | | | | | | | | | | | | | | | | | | | | | | | | | | | | | | | | | | | | | | | | | | | | | | | | | | | | | | | | | | | | | | | | | | | | | | | | | | | | | | | | | | |
| 071113-2108(SSW) 7' | GRAB | SS | 7' | | 1444 | 2 | X | | | | | | | | | 03 | | | | | | | | | | | | | | | | | | | | | | | | | | | | | | | | | | | | | | | | | | | | | | | | | | | | | | | | | | | | | | | | | | | | | | | | | | | | | | | | | | | | | | | | | | | | | | | | | | | | | | | | | | | | | | | | | | | | | | | | | | | | | | | | | | | | | | | | | | | | | | | | | | | | | | | | | | | | | | | | | | | | | | | | | | | | | | | | | | | | | | | | | | | | | | | | | | | | | | | | | | | | | | | | | | | | | | | | | | | | | | | | | | | | | | | | | | | |
| 071113-2108(WSW) 9' | GRAB | SS | 9' | | 1453 | 2 | X | | | | | | | | | 04 | | | | | | | | | | | | | | | | | | | | | | | | | | | | | | | | | | | | | | | | | | | | | | | | | | | | | | | | | | | | | | | | | | | | | | | | | | | | | | | | | | | | | | | | | | | | | | | | | | | | | | | | | | | | | | | | | | | | | | | | | | | | | | | | | | | | | | | | | | | | | | | | | | | | | | | | | | | | | | | | | | | | | | | | | | | | | | | | | | | | | | | | | | | | | | | | | | | | | | | | | | | | | | | | | | | | | | | | | | | | | | | | | | | | | | | | | | | |
| 071113-2108(BBT) 12' | GRAB | SS | 12' | | 1502 | 2 | X | | | | | | | | | 05 | | | | | | | | | | | | | | | | | | | | | | | | | | | | | | | | | | | | | | | | | | | | | | | | | | | | | | | | | | | | | | | | | | | | | | | | | | | | | | | | | | | | | | | | | | | | | | | | | | | | | | | | | | | | | | | | | | | | | | | | | | | | | | | | | | | | | | | | | | | | | | | | | | | | | | | | | | | | | | | | | | | | | | | | | | | | | | | | | | | | | | | | | | | | | | | | | | | | | | | | | | | | | | | | | | | | | | | | | | | | | | | | | | | | | | | | | | | |
| 071113-2108(ETB) 3-9" | COMP | SS | 3-9" | ✓ | 11010 | 3 | X | X | X | X | X | X | X | | | 06 | | | | | | | | | | | | | | | | | | | | | | | | | | | | | | | | | | | | | | | | | | | | | | | | | | | | | | | | | | | | | | | | | | | | | | | | | | | | | | | | | | | | | | | | | | | | | | | | | | | | | | | | | | | | | | | | | | | | | | | | | | | | | | | | | | | | | | | | | | | | | | | | | | | | | | | | | | | | | | | | | | | | | | | | | | | | | | | | | | | | | | | | | | | | | | | | | | | | | | | | | | | | | | | | | | | | | | | | | | | | | | | | | | | | | | | | | | | |
| | | | | | | | | | | | | | | | | | | | | | | | | | | | | | | | | | | | | | | | | | | | | | | | | | | | | | | | | | | | | | | | | | | | | | | | | | | | | | | | | | | | | | | | | | | | | | | | | | | | | | | | | | | | | | | | | | | | | | | | | | | | | | | | | | | | | | | | | | | | | | | | | | | | | | | | | | | | | | | | | | | | | | | | | | | | | | | | | | | | | | | | | | | | | | | | | | | | | | | | | | | | | | | | | | | | | | | | | | | | | | | | | | | | | | | | | | | | | | | | | | | | | | | | | | | | |
| | | | | | | | | | | | | | | | | | | | | | | | | | | | | | | | | | | | | | | | | | | | | | | | | | | | | | | | | | | | | | | | | | | | | | | | | | | | | | | | | | | | | | | | | | | | | | | | | | | | | | | | | | | | | | | | | | | | | | | | | | | | | | | | | | | | | | | | | | | | | | | | | | | | | | | | | | | | | | | | | | | | | | | | | | | | | | | | | | | | | | | | | | | | | | | | | | | | | | | | | | | | | | | | | | | | | | | | | | | | | | | | | | | | | | | | | | | | | | | | | | | | | | | | | | | | |
| | | | | | | | | | | | | | | | | | | | | | | | | | | | | | | | | | | | | | | | | | | | | | | | | | | | | | | | | | | | | | | | | | | | | | | | | | | | | | | | | | | | | | | | | | | | | | | | | | | | | | | | | | | | | | | | | | | | | | | | | | | | | | | | | | | | | | | | | | | | | | | | | | | | | | | | | | | | | | | | | | | | | | | | | | | | | | | | | | | | | | | | | | | | | | | | | | | | | | | | | | | | | | | | | | | | | | | | | | | | | | | | | | | | | | | | | | | | | | | | | | | | | | | | | | | | |
| | | | | | | | | | | | | | | | | | | | | | | | | | | | | | | | | | | | | | | | | | | | | | | | | | | | | | | | | | | | | | | | | | | | | | | | | | | | | | | | | | | | | | | | | | | | | | | | | | | | | | | | | | | | | | | | | | | | | | | | | | | | | | | | | | | | | | | | | | | | | | | | | | | | | | | | | | | | | | | | | | | | | | | | | | | | | | | | | | | | | | | | | | | | | | | | | | | | | | | | | | | | | | | | | | | | | | | | | | | | | | | | | | | | | | | | | | | | | | | | | | | | | | | | | | | | |
| | | | | | | | | | | | | | | | | | | | | | | | | | | | | | | | | | | | | | | | | | | | | | | | | | | | | | | | | | | | | | | | | | | | | | | | | | | | | | | | | | | | | | | | | | | | | | | | | | | | | | | | | | | | | | | | | | | | | | | | | | | | | | | | | | | | | | | | | | | | | | | | | | | | | | | | | | | | | | | | | | | | | | | | | | | | | | | | | | | | | | | | | | | | | | | | | | | | | | | | | | | | | | | | | | | | | | | | | | | | | | | | | | | | | | | | | | | | | | | | | | | | | | | | | | | | |
| | | | | | | | | | | | | | | | | | | | | | | | | | | | | | | | | | | | | | | | | | | | | | | | | | | | | | | | | | | | | | | | | | | | | | | | | | | | | | | | | | | | | | | | | | | | | | | | | | | | | | | | | | | | | | | | | | | | | | | | | | | | | | | | | | | | | | | | | | | | | | | | | | | | | | | | | | | | | | | | | | | | | | | | | | | | | | | | | | | | | | | | | | | | | | | | | | | | | | | | | | | | | | | | | | | | | | | | | | | | | | | | | | | | | | | | | | | | | | | | | | | | | | | | | | | | |
| | | | | | | | | | | | | | | | | | | | | | | | | | | | | | | | | | | | | | | | | | | | | | | | | | | | | | | | | | | | | | | | | | | | | | | | | | | | | | | | | | | | | | | | | | | | | | | | | | | | | | | | | | | | | | | | | | | | | | | | | | | | | | | | | | | | | | | | | | | | | | | | | | | | | | | | | | | | | | | | | | | | | | | | | | | | | | | | | | | | | | | | | | | | | | | | | | | | | | | | | | | | | | | | | | | | | | | | | | | | | | | | | | | | | | | | | | | | | | | | | | | | | | | | | | | | |

*Matrix: SS-Soil/Solid GW-Groundwater WW-Wastewater DW-Drinking Water OT- Other _____

pH _____ Temp _____

Remarks:

| | | | | | | | | | |
|------------------------------------|--|--------------------------|--|----------------------------------|--|---|--|---|--|
| Relinquisher by: (Signature) | | Date: 7/12/13 Time: 7:15 | | Received by: (Signature) | | Samples returned via: FedEx UPS Other _____ | | Condition (lab use only) | |
| Relinquisher by: (Signature) | | Date: _____ Time: _____ | | Received by: (Signature) _____ | | Temp: 32 Bottles Received: 13 = 402 | | COC Seals Intact <input checked="" type="checkbox"/> Y <input type="checkbox"/> N <input type="checkbox"/> NA | |
| Relinquisher by: (Signature) _____ | | Date: _____ Time: _____ | | Received for lab by: (Signature) | | Date: 7-13-13 Time: 0930 | | pH Checked: _____ NCF: _____ | |

5086 5825 2271

Flow _____ Other _____



12065 Lebanon Rd.
Mt. Juliet, TN 37122
(615) 758-5858
1-800-767-5859
Fax (615) 758-5859

Tax I.D. 62-0814289

Est. 1970

Charles Jensen
EnCana Oil & Gas - Rangely, CO
1125 Escalante Drive
Rangely, CO 81648-3600

Report Summary

Wednesday July 24, 2013

Report Number: L646437

Samples Received: 07/13/13

Client Project: 2108

Description: 2108-Site Clearance

The analytical results in this report are based upon information supplied by you, the client, and are for your exclusive use. If you have any questions regarding this data package, please do not hesitate to call.

Entire Report Reviewed By:

Jarred Willis , ESC Representative

Laboratory Certification Numbers

A2LA - 1461-01, AIHA - 100789, AL - 40660, CA - 01157CA, CT - PH-0197,
FL - E87487, GA - 923, IN - C-IN-01, KY - 90010, KYUST - 0016,
NC - ENV375/DW21704/BIO041, ND - R-140, NJ - TN002, NJ NELAP - TN002,
SC - 84004, TN - 2006, VA - 460132, WV - 233, AZ - 0612,
MN - 047-999-395, NY - 11742, WI - 998093910, NV - TN000032011-1,
TX - T104704245-11-3, OK - 9915, PA - 68-02979, IA Lab #364

Accreditation is only applicable to the test methods specified on each scope of accreditation held by ESC Lab Sciences.

Note: The use of the preparatory EPA Method 3511 is not approved or endorsed by the CA ELAP.

This report may not be reproduced, except in full, without written approval from ESC Lab Sciences. Where applicable, sampling conducted by ESC is performed per guidance provided in laboratory standard operating procedures: 060302, 060303, and 060304.



12065 Lebanon Rd.
Mt. Juliet, TN 37122
(615) 758-5858
1-800-767-5859
Fax (615) 758-5859

Tax I.D. 62-0814289

Est. 1970

REPORT OF ANALYSIS

July 24, 2013

Charles Jensen
EnCana Oil & Gas - Rangely, CO
1125 Escalante Drive
Rangely, CO 81648-3600

Date Received : July 13, 2013
Description : 2108-Site Clearance
Sample ID : 071213-2108-(BG1N) 6IN
Collected By : Brad Ward
Collection Date : 07/11/13 12:13

ESC Sample # : L646437-01

Site ID : 2108

Project # : 2108

| Parameter | Result | Det. Limit | Units | Method | Date | Dil. |
|-----------|--------|------------|-------|--------|----------|------|
| Arsenic | 5.2 | 1.0 | mg/kg | 6010B | 07/24/13 | 1 |

BDL - Below Detection Limit

Det. Limit - Practical Quantitation Limit(PQL)

Note:

The reported analytical results relate only to the sample submitted.

This report shall not be reproduced, except in full, without the written approval from ESC.

Reported: 07/24/13 16:19 Printed: 07/24/13 16:19



12065 Lebanon Rd.
Mt. Juliet, TN 37122
(615) 758-5858
1-800-767-5859
Fax (615) 758-5859

Tax I.D. 62-0814289

Est. 1970

REPORT OF ANALYSIS

July 24, 2013

Charles Jensen
EnCana Oil & Gas - Rangely, CO
1125 Escalante Drive
Rangely, CO 81648-3600

Date Received : July 13, 2013
Description : 2108-Site Clearance
Sample ID : 071213-2108-(BG2E) 6IN
Collected By : Brad Ward
Collection Date : 07/11/13 12:20

ESC Sample # : L646437-02

Site ID : 2108

Project # : 2108

| Parameter | Result | Det. Limit | Units | Method | Date | Dil. |
|-----------|--------|------------|-------|--------|----------|------|
| Arsenic | 4.2 | 1.0 | mg/kg | 6010B | 07/24/13 | 1 |

BDL - Below Detection Limit

Det. Limit - Practical Quantitation Limit(PQL)

Note:

The reported analytical results relate only to the sample submitted.

This report shall not be reproduced, except in full, without the written approval from ESC.

Reported: 07/24/13 16:19 Printed: 07/24/13 16:19



12065 Lebanon Rd.
Mt. Juliet, TN 37122
(615) 758-5858
1-800-767-5859
Fax (615) 758-5859
Tax I.D. 62-0814289
Est. 1970

REPORT OF ANALYSIS

July 24, 2013

Charles Jensen
EnCana Oil & Gas - Rangely, CO
1125 Escalante Drive
Rangely, CO 81648-3600

Date Received : July 13, 2013
Description : 2108-Site Clearance
Sample ID : 071213-2108-(BG4W) 6IN
Collected By : Brad Ward
Collection Date : 07/11/13 12:37

ESC Sample # : L646437-03
Site ID : 2108
Project # : 2108

| Parameter | Result | Det. Limit | Units | Method | Date | Dil. |
|-----------|--------|------------|-------|--------|----------|------|
| Arsenic | 6.5 | 1.0 | mg/kg | 6010B | 07/24/13 | 1 |

BDL - Below Detection Limit
Det. Limit - Practical Quantitation Limit(PQL)
Note:
The reported analytical results relate only to the sample submitted.
This report shall not be reproduced, except in full, without the written approval from ESC.
Reported: 07/24/13 16:19 Printed: 07/24/13 16:19



12065 Lebanon Rd.
Mt. Juliet, TN 37122
(615) 758-5858
1-800-767-5859
Fax (615) 758-5859

Tax I.D. 62-0814289

Est. 1970

REPORT OF ANALYSIS

July 24, 2013

Charles Jensen
EnCana Oil & Gas - Rangely, CO
1125 Escalante Drive
Rangely, CO 81648-3600

Date Received : July 13, 2013
Description : 2108-Site Clearance
Sample ID : 071213-2108-(BG3S) 6IN
Collected By : Brad Ward
Collection Date : 07/11/13 12:29

ESC Sample # : L646437-04

Site ID : 2108

Project # : 2108

| Parameter | Result | Det. Limit | Units | Method | Date | Dil. |
|-----------|--------|------------|-------|--------|----------|------|
| Arsenic | 4.9 | 1.0 | mg/kg | 6010B | 07/24/13 | 1 |

BDL - Below Detection Limit

Det. Limit - Practical Quantitation Limit(PQL)

Note:

The reported analytical results relate only to the sample submitted.

This report shall not be reproduced, except in full, without the written approval from ESC.

Reported: 07/24/13 16:19 Printed: 07/24/13 16:19

Summary of Remarks For Samples Printed
07/24/13 at 16:19:28

TSR Signing Reports: 358
RX - Priority Rush

Sample: L646437-01 Account: ENCANRCO Received: 07/13/13 09:30 Due Date: 07/25/13 00:00 RPT Date: 07/24/13 16:19

Sample: L646437-02 Account: ENCANRCO Received: 07/13/13 09:30 Due Date: 07/25/13 00:00 RPT Date: 07/24/13 16:19

Sample: L646437-03 Account: ENCANRCO Received: 07/13/13 09:30 Due Date: 07/25/13 00:00 RPT Date: 07/24/13 16:19

Sample: L646437-04 Account: ENCANRCO Received: 07/13/13 09:30 Due Date: 07/25/13 00:00 RPT Date: 07/24/13 16:19

| | | | | | | | | | | | | | | | | | |
|---|--|--------------------------------|---------------|--|---------|--|--------------|---|------------------------|------------------|-------------|---|--------------------|-------------|--------------|---|---------------------|
| Company Name/Address *ENCANRCO-RULEENG* Encana Oil & Gas 143 DIAMOND AVE PARACHUTE, CO 81635 *ENCANRCO-RULEENG* | | | | Billing Information Charlie Jensen 143 Diamond Ave Parachute, CO 81635 Report to: Charlie Jensen E-mail to: Charlie Jensen, Shad Johnson, Brad Ward | | | | Analysis/Container/Preservative | | | | | | | | Chain of Custody Page 1 of 1 Prepared by: G035 ENVIRONMENTAL SCIENCE CORP 12065 Lebanon Road Mt. Juliet TN 37122 Phone (615)758-5858 Phone (800) 767-5859 FAX (615)758-5859 | |
| | | | | | | | | | | | | | | | | | |
| | | | | | | | | | | | | | | | | | |
| | | | | | | | | | | | | | | | | | |
| Project Description: 2108 - SITE CLEARANCE | | | | | | | | CoCode (lab use only) *ENCANRCO-RULEENG* Template/Prelogin Shipped Via: | | | | | | | | | |
| PHONE: 970-285-2735 | | Client Project No. 2108 | | ENCANRCO-RULEENG | | | | | | | | | | | | | |
| FAX: | | Site/Facility ID# 2108 | | P.O.# | | | | | | | | | | | | | |
| Collected by: Brad Ward | | Collected by (signature): | | Rush? (Lab MUST be Notified) <input type="checkbox"/> Same Day.....200% <input type="checkbox"/> Next Day.....100% <input type="checkbox"/> Two Day.....50% | | Date Results Needed Email? <input type="checkbox"/> No <input checked="" type="checkbox"/> Yes FAX? <input type="checkbox"/> No <input type="checkbox"/> Yes | | | | | | | | | | | |
| Immediately Packed on Ice N <input type="checkbox"/> Y <input checked="" type="checkbox"/> | | | | | | | | | | | | | | | | | |
| Sample ID | | Comp/Grab | Matrix | Depth | Date | Time | Cntrs | BTEXGRO / DRO - 8260/8015 | SV8270PAHSIM - 8270SIM | SPCON - 9050AMod | SAR - Calc. | RCRA8 Metals + Cu, Ni, and Zn - 6010/7470 | CR6SS - 3060A/7196 | CR3 - Calc. | As | Remarks/contaminant | Sample # (lab only) |
| 071213-2108 -(BG1N)-6" | | GRAB | SS | 6" | 7/11/13 | 1213 | 1 | | | | | | | | X | | 1646437-01 |
| 071213-2108 -(BG2E)-6" | | GRAB | SS | 6" | 7/11/13 | 1220 | 1 | | | | | | | | X | | 02 |
| 071213-2108 -(BG3N)-6" | | GRAB | SS | 6" | | | 1 | | | | | | | | X | | |
| 071213-2108 -(BG4W)-6" | | GRAB | SS | 6" | 7/11/13 | 1237 | 1 | | | | | | | | X | | 03 |
| 071213-2108 -(B635)-6" | | Grab | SS | 6" | 7/11/13 | 1229 | 1 | | | | | | | | X | | 04 |
| | | | | | | | | | | | | | | | | | |
| | | | | | | | | | | | | | | | | | |
| | | | | | | | | | | | | | | | | | |
| | | | | | | | | | | | | | | | | | |
| | | | | | | | | | | | | | | | | | |
| | | | | | | | | | | | | | | | | | |
| | | | | | | | | | | | | | | | | | |
| | | | | | | | | | | | | | | | | | |

Matrix: SS-Soil/Solid GW-Groundwater WW-Wastewater DW-Drinking Water OT- Other _____ pH _____ Temp _____

Remarks:

| | | | | | | | | | |
|------------------------------|--|---------------|------------|----------------------------------|--|---|--|------------------------------------|--|
| Relinquisher by: (Signature) | | Date: 7/12/13 | Time: 7:15 | Received by: (Signature) | | Samples returned via: FedEx <input checked="" type="checkbox"/> UPS <input type="checkbox"/> Other _____ | | Condition (lab use only) NO | |
| Relinquisher by: (Signature) | | Date: | Time: | Received by: (Signature) | | Temp: 72 | | Bottles Received: 4 = 402 | |
| Relinquisher by: (Signature) | | Date: | Time: | Received for lab by: (Signature) | | Date: 7-13-13 | | Time: 0930 | |
| | | | | | | COC Seals Intact <input checked="" type="checkbox"/> Y <input type="checkbox"/> N <input type="checkbox"/> NA | | pH Checked: NCF: | |



12065 Lebanon Rd.
Mt. Juliet, TN 37122
(615) 758-5858
1-800-767-5859
Fax (615) 758-5859

Tax I.D. 62-0814289

Est. 1970

Charles Jensen
EnCana Oil & Gas - Rangely, CO
1125 Escalante Drive
Rangely, CO 81648-3600

Report Summary

Tuesday October 08, 2013

Report Number: L660204

Samples Received: 09/27/13

Client Project: 2108

Description: 2108-Site Clearance

The analytical results in this report are based upon information supplied by you, the client, and are for your exclusive use. If you have any questions regarding this data package, please do not hesitate to call.

Entire Report Reviewed By:

Jarred Willis, ESC Representative

Laboratory Certification Numbers

A2LA - 1461-01, AIHA - 100789, AL - 40660, CA - 01157CA, CT - PH-0197,
FL - E87487, GA - 923, IN - C-IN-01, KY - 90010, KYUST - 0016,
NC - ENV375/DW21704/BIO041, ND - R-140, NJ - TN002, NJ NELAP - TN002,
SC - 84004, TN - 2006, VA - 460132, WV - 233, AZ - 0612,
MN - 047-999-395, NY - 11742, WI - 998093910, NV - TN000032011-1,
TX - T104704245-11-3, OK - 9915, PA - 68-02979, IA Lab #364

Accreditation is only applicable to the test methods specified on each scope of accreditation held by ESC Lab Sciences.

Note: The use of the preparatory EPA Method 3511 is not approved or endorsed by the CA ELAP.

This report may not be reproduced, except in full, without written approval from ESC Lab Sciences. Where applicable, sampling conducted by ESC is performed per guidance provided in laboratory standard operating procedures: 060302, 060303, and 060304.



12065 Lebanon Rd.
Mt. Juliet, TN 37122
(615) 758-5858
1-800-767-5859
Fax (615) 758-5859

Tax I.D. 62-0814289

Est. 1970

REPORT OF ANALYSIS

October 08, 2013

Charles Jensen
EnCana Oil & Gas - Rangely, CO
1125 Escalante Drive
Rangely, CO 81648-3600

Date Received : September 27, 2013
Description : 2108-Site Clearance
Sample ID : 092613-2108 ESW-11 FT
Collected By : Shad Johnson
Collection Date : 09/26/13 11:55

ESC Sample # : L660204-01

Site ID : 2108

Project # : 2108

| Parameter | Result | Det. Limit | Units | Method | Date | Dil. |
|-----------------------------|--------|------------|--------|-----------|----------|------|
| Benzene | BDL | 0.0025 | mg/kg | 8021/8015 | 10/02/13 | 5 |
| Toluene | BDL | 0.025 | mg/kg | 8021/8015 | 10/02/13 | 5 |
| Ethylbenzene | BDL | 0.0025 | mg/kg | 8021/8015 | 10/02/13 | 5 |
| Total Xylene | BDL | 0.0075 | mg/kg | 8021/8015 | 10/02/13 | 5 |
| TPH (GC/FID) Low Fraction | BDL | 0.50 | mg/kg | GRO | 10/02/13 | 5 |
| Surrogate Recovery-% | | | | | | |
| a,a,a-Trifluorotoluene(FID) | 99.2 | | % Rec. | 8021/8015 | 10/02/13 | 5 |
| a,a,a-Trifluorotoluene(PID) | 102. | | % Rec. | 8021/8015 | 10/02/13 | 5 |
| TPH (GC/FID) High Fraction | 17. | 4.0 | mg/kg | 3546/DRO | 10/04/13 | 1 |
| Surrogate recovery(%) | | | | | | |
| o-Terphenyl | 79.0 | | % Rec. | 3546/DRO | 10/04/13 | 1 |

BDL - Below Detection Limit

Det. Limit - Practical Quantitation Limit(PQL)

Note:

The reported analytical results relate only to the sample submitted.

This report shall not be reproduced, except in full, without the written approval from ESC.

Reported: 10/07/13 20:03 Revised: 10/08/13 09:05



12065 Lebanon Rd.
Mt. Juliet, TN 37122
(615) 758-5858
1-800-767-5859
Fax (615) 758-5859

Tax I.D. 62-0814289

Est. 1970

REPORT OF ANALYSIS

Charles Jensen
EnCana Oil & Gas - Rangely, CO
1125 Escalante Drive
Rangely, CO 81648-3600

October 08, 2013

Date Received : September 27, 2013
Description : 2108-Site Clearance
Sample ID : 092613-2108 BBT-12 FT
Collected By : Shad Johnson
Collection Date : 09/26/13 12:05

ESC Sample # : L660204-02

Site ID : 2108

Project # : 2108

| Parameter | Result | Det. Limit | Units | Method | Date | Dil. |
|-----------------------------|--------|------------|--------|-----------|----------|------|
| Benzene | BDL | 0.0025 | mg/kg | 8021/8015 | 10/02/13 | 5 |
| Toluene | BDL | 0.025 | mg/kg | 8021/8015 | 10/02/13 | 5 |
| Ethylbenzene | BDL | 0.0025 | mg/kg | 8021/8015 | 10/02/13 | 5 |
| Total Xylene | BDL | 0.0075 | mg/kg | 8021/8015 | 10/02/13 | 5 |
| TPH (GC/FID) Low Fraction | BDL | 0.50 | mg/kg | GRO | 10/02/13 | 5 |
| Surrogate Recovery-% | | | | | | |
| a,a,a-Trifluorotoluene(FID) | 98.8 | | % Rec. | 8021/8015 | 10/02/13 | 5 |
| a,a,a-Trifluorotoluene(PID) | 101. | | % Rec. | 8021/8015 | 10/02/13 | 5 |
| TPH (GC/FID) High Fraction | BDL | 4.0 | mg/kg | 3546/DRO | 10/04/13 | 1 |
| Surrogate recovery(%) | | | | | | |
| o-Terphenyl | 81.3 | | % Rec. | 3546/DRO | 10/04/13 | 1 |

BDL - Below Detection Limit

Det. Limit - Practical Quantitation Limit(PQL)

Note:

The reported analytical results relate only to the sample submitted.

This report shall not be reproduced, except in full, without the written approval from ESC.

Reported: 10/07/13 20:03 Revised: 10/08/13 09:05

Billing Information:

Charles Jensen
143 Diamond Ave
Parachute, CO 81635

Report to: Charles Jensen

Email to: Charles Jensen, Shad Johnson

Analysis/Container/Preservative

Chain of Custody
Page 1 of 1



12065 Lebanon Road
Mt. Juliet, TN 37122

Phone: (800) 767-5859
Phone: (615) 758-5858
Fax: (615) 758-5859

E150

CoCode ENCRCO (lab use only)

Template/Prelogin

Shipped Via:

Remarks/Contaminant

Sample # (lab only)







[illegible]

*Matrix: **SS** - Soil/Solid **GW** - Groundwater **WW** - WasteWater **DW** - Drinking Water **OT** - Other

pH _____ Temp _____

Remarks:

| Flow | Other |
|------|-------|
| 1 | 2 |
| 3 | 4 |
| 5 | 6 |
| 7 | 8 |
| 9 | 10 |
| 11 | 12 |
| 13 | 14 |
| 15 | 16 |
| 17 | 18 |
| 19 | 20 |
| 21 | 22 |
| 23 | 24 |
| 25 | 26 |
| 27 | 28 |
| 29 | 30 |
| 31 | 32 |
| 33 | 34 |
| 35 | 36 |
| 37 | 38 |
| 39 | 40 |
| 41 | 42 |
| 43 | 44 |
| 45 | 46 |
| 47 | 48 |
| 49 | 50 |
| 51 | 52 |
| 53 | 54 |
| 55 | 56 |
| 57 | 58 |
| 59 | 60 |
| 61 | 62 |
| 63 | 64 |
| 65 | 66 |
| 67 | 68 |
| 69 | 70 |
| 71 | 72 |
| 73 | 74 |
| 75 | 76 |
| 77 | 78 |
| 79 | 80 |
| 81 | 82 |
| 83 | 84 |
| 85 | 86 |
| 87 | 88 |
| 89 | 90 |
| 91 | 92 |
| 93 | 94 |
| 95 | 96 |
| 97 | 98 |
| 99 | 100 |

| | | | | | |
|--|-------------------------|----------------------|--|---|--|
| Relinquished by: (Signature)  | Date: 7-26-13 | Time: 1500 | Received by: (Signature)  | Samples returned via: <input type="checkbox"/> UPS <input checked="" type="checkbox"/> FedEx <input type="checkbox"/> Courier <input type="checkbox"/> _____ | Condition: (lab use only)  |
| Relinquished by: (Signature)  | Date: | Time: | Received by: (Signature)  | Temp: 3.9°C | Bottles Received: 4 |
| Relinquished by: (Signature)  | Date: | Time: | Received by: (Signature)  | Date: 9/27/13 | Time: 0930 |
| | | | | | CoC Seals Intact: <input checked="" type="checkbox"/> Y <input type="checkbox"/> N <input type="checkbox"/> NA |
| | | | | | pH Checked: <input type="checkbox"/> NCF: <input type="checkbox"/> |