



---

**Corporate Office**

1775 Sherman Street, #3000  
Denver, Colorado 80203  
303.860.5800  
www.pdce.com

June 7, 2016

State of Colorado, Oil & Gas Conservation Commission  
Attn: Matt Lepore  
1120 Lincoln Street, Suite 801  
Denver, CO 80203

Re: **Letter to the Director, Rule 318A.e.**  
Sharon 21N-234  
NESW, Section 21 T4N R67W  
Weld County, Colorado

Dear Director:

PDC Energy ("PDC") hereby certifies to the Director that PDC holds all minerals in the proposed 400 acre wellbore spacing unit consisting of the S2NW, NE of Section 20 and NW of Section 21 in T4N R67W; therefore, no 30-day notice is needed to owners in the proposed wellbore spacing unit. This horizontal well location crosses existing unit boundaries and requires the formation of the proposed unit. PDC hereby requests the Director to approve the well.

If you should have any questions or concerns regarding this permit, please contact the undersigned at (303) 831-3974 or Kelsi.Welch@pdce.com.

Sincerely,

A handwritten signature in black ink that reads "Kelsi Welch".

Kelsi Welch  
Regulatory Analyst  
PDC Energy, Inc.

## Sharon 21N-234

S2NW, NE of Section 20 and NW of Section 21 in T4N R67W

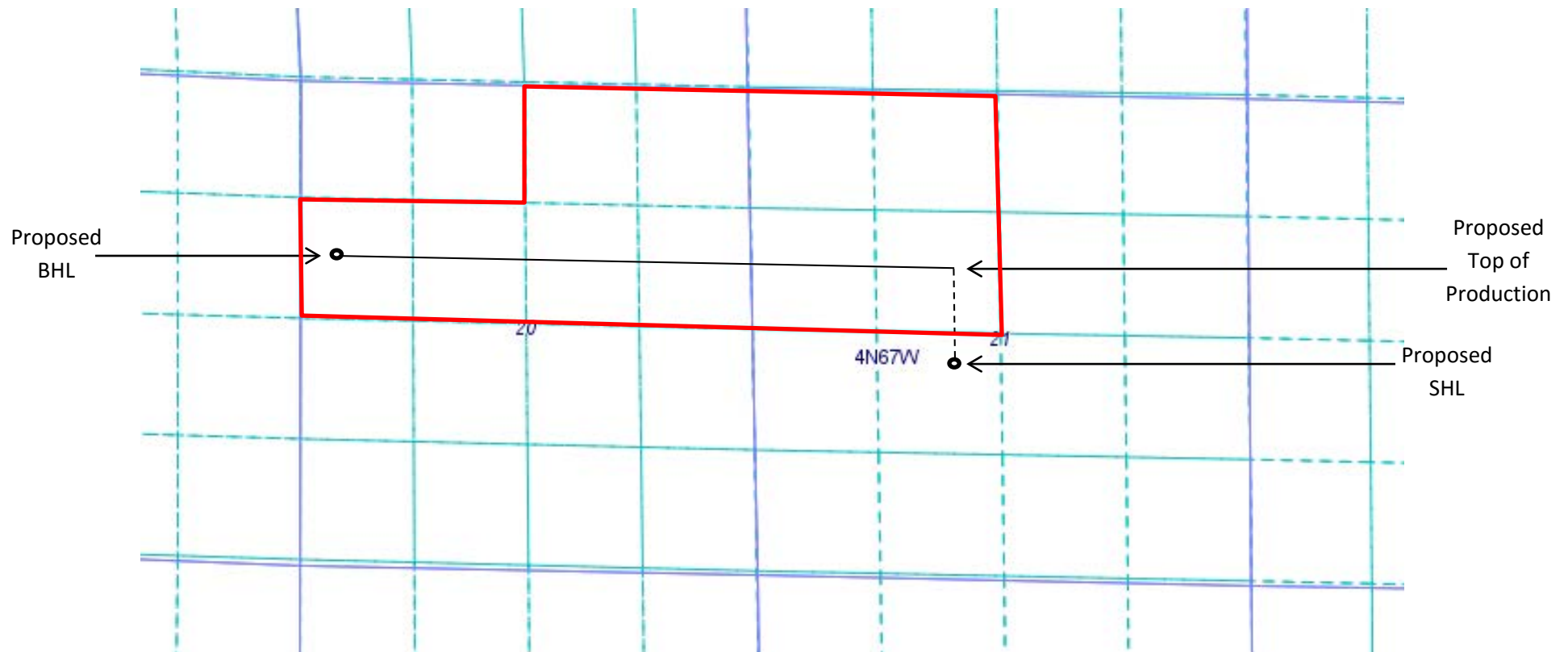

 = 400 Acre Proposed Spacing Unit