

<b>Borehole:</b>	<b>Well:</b>	<b>Field:</b>	<b>Structure:</b>
<b>Original Hole</b>	<b>Shull Fed-9-59-31-4441BE</b>	<b>CO, Weld County (NAD 83 NZ)</b>	<b>31-09N-59W (Anderson-Shull Pad 2)</b>

<b>Gravity &amp; Magnetic Parameters</b>			<b>Surface Location</b>			<b>Miscellaneous</b>		
Model:	HDGM 2015	Dip: 67.141°	Date:	13-Apr-2016		Lat: N 40 42 31.65	Northing:	1504470.88ftUS
MagDec:	8.033°	FS: 52766.976nT	Gravity FS:	999.082mgn (9.80665 Based)		Lon: W 104 1 19.99	Easting:	3409683.35ftUS
						Scale Fact: 0.99998875		
						Plan: Shull Fed-9-59-31-4441BE R0 mdv 13Apr16		

Northing: 1504470.878		Easting: 3409683.35		Surface Location		Longitude: W 104 1 19.99		VSec Azimuth: 99.946	
Target Description		Grid Coord		Local Coord					
Target Name	Latitude	Longitude	North	East	TVD	VSec	N(+)/S(-)	E(+)/W(-)	DLS
Anderson-Shull Pad Sec 31-32 - 460' Setback	N 40 42 41.43	W 104 1 22.06	1505457.62	3409507.95	4898.00	-343.20	986.75	-175.41	
Pad 2	N 40 42 41.43	W 104 1 22.06	1505457.62	3409507.95	4898.00	-343.20	986.75	-175.41	
Anderson-Shull Pad Sec 31-9N-59W	N 40 42 41.43	W 104 1 22.06	1505457.62	3409507.95	4898.00	-343.20	986.75	-175.41	
Anderson-Shull Pad Sec 32-9N-59W	N 40 42 41.43	W 104 1 22.06	1505457.62	3409507.95	4898.00	-343.20	986.75	-175.41	
Shull Fed-9-59-31-4441BE BHL	N 40 42 16.81	W 103 59 38.80	1503100.06	3417500.41	6113.00	7936.45	-1370.84	7817.16	
Shull Fed-9-59-31-4441BE LP	N 40 42 16.59	W 104 1 8.27	1502961.06	3410611.34	6143.00	1174.83	-1509.83	928.00	
Critical Points									
Critical Point	MD	INCL	AZIM	TVD	VSEC	N(+)/S(-)	E(+)/W(-)	DLS	
Surface	0.00	0.00	0.00	0.00	0.00	0.00	0.00	0.00	
KOP, Build 1.5 DLS	1500.00	0.00	175.39	1500.00	0.00	0.00	0.00	0.00	
Hold	2918.77	21.28	175.39	2886.37	65.48	-259.63	20.95	1.50	
KOP, Build/Turn 10 DLS	5728.96	21.28	175.39	5504.93	321.90	-1276.29	103.00	0.00	
Hold 275' Tangent @ 65° INC	6346.21	65.00	99.44	5968.68	663.45	-1451.08	419.10	10.00	
KOP, Build 10 DLS to Landing	6621.21	65.00	99.44	6084.90	912.67	-1491.98	664.96	0.00	
Landing Point, Hold to TD	6893.74	90.25	88.84	6143.00	1174.84	-1509.83	928.00	10.00	
7" Casing Point	6894.00	90.25	88.84	6143.00	1175.10	-1509.83	928.26	0.00	
Shull Fed-9-59-31-4441BE BHL	13784.37	90.25	88.84	6113.00	7936.45	-1370.84	7817.16	0.00	

**Proposal**  
**Rev 0**



Grid  
True  
Mag  
Grid North  
Tot Corr (M->G 7.078°)  
Mag Dec (8.033°)  
Grid Conv (0.955°)

EW (ft) Scale = 1:2000.00(ft)

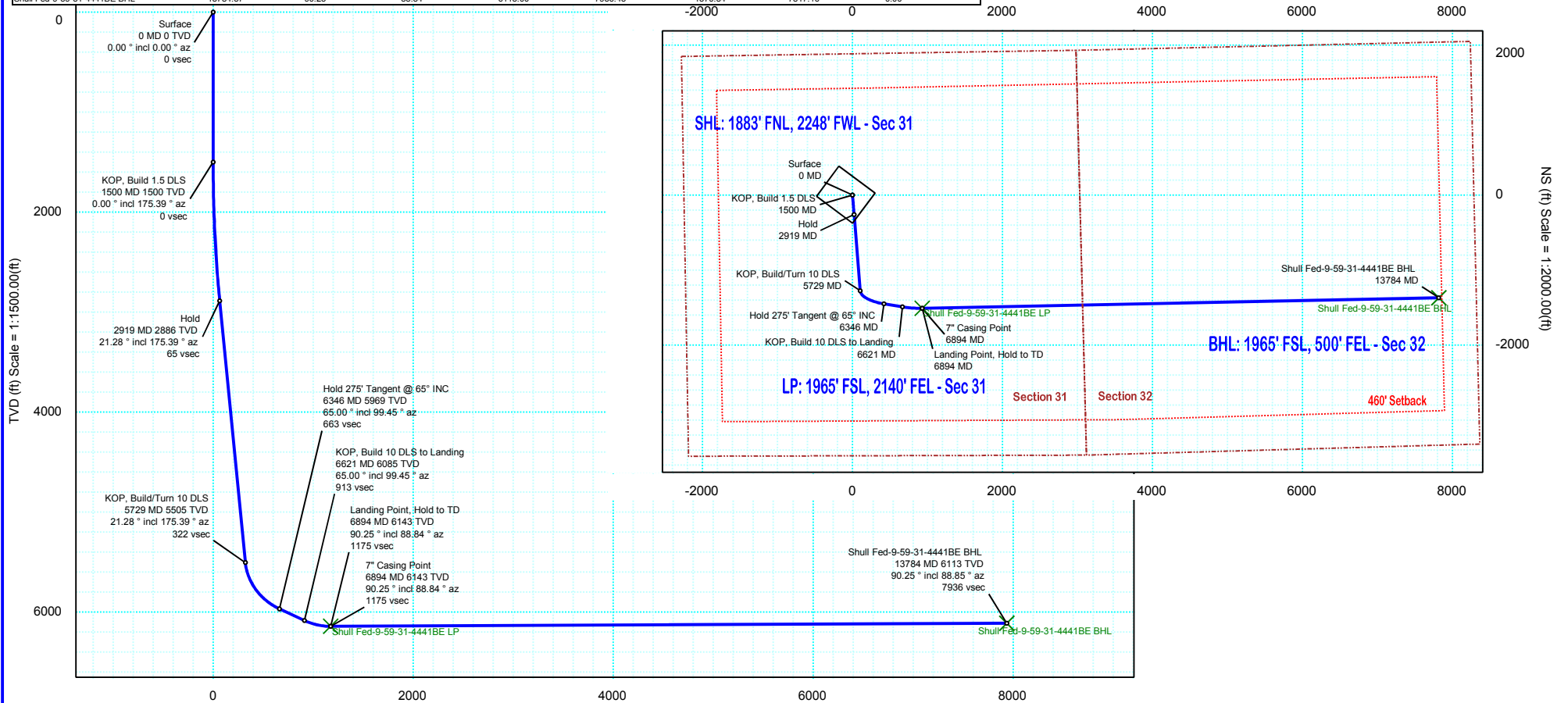

Vertical Section (ft) Azim = 99.946° Scale = 1:1500.00(ft) Origin = 0N/-S, 0E/-W