

- Layers
- ☒ Measure
 - ☐ DEM_10m
 - ☒ O&G Facilities
 - ☒ Wells
 - ☒ Well Operator
 - ☒ Well Name
 - ☒ Well API #
 - ☐ Misc Facilities
 - ☐ Pits
 - ☐ Active
 - ☐ Closed
 - ☐ Unknown
 - ☐ Permits
 - ☒ Pending Permits
 - ☐ PendingZAs (Diamond)
 - ☐ Well Status
 - ☐ Spud Notice
 - ☐ UIC Disposal Wells
 - ☐ UIC Enhanced Recovery Wells
 - ☐ SC Anomalies
 - ☐ Surface Casing
 - ☒ COGCC Data
 - ☒ COGCCAlert
 - ☒ COGCCOnsite
 - ☐ Samples
 - ☐ Remediation
 - ☐ O&G Locations
 - ☐ Directionals
 - ☐ COGCC Rules
 - ☐ COGCC Oil & Gas Fields
 - ☐ Field Insp Unit
 - ☐ SeismicPermits
 - ☒ Historic Wells
 - ☒ Roads & RRs
 - ☒ Water Resources
 - ☒ Floodplains
 - ☒ Environmental_Sites
 - ☒ SecTwpRng
 - ☒ LGDS
 - ☒ Wildlife CPW
 - ☒ State Lands
 - ☒ Indian Lands
 - ☒ BLM Lands
 - ☒ Surface Lands
 - ☐ Places
 - ☐ Counties_Zoom
 - ☒ CityPolygons

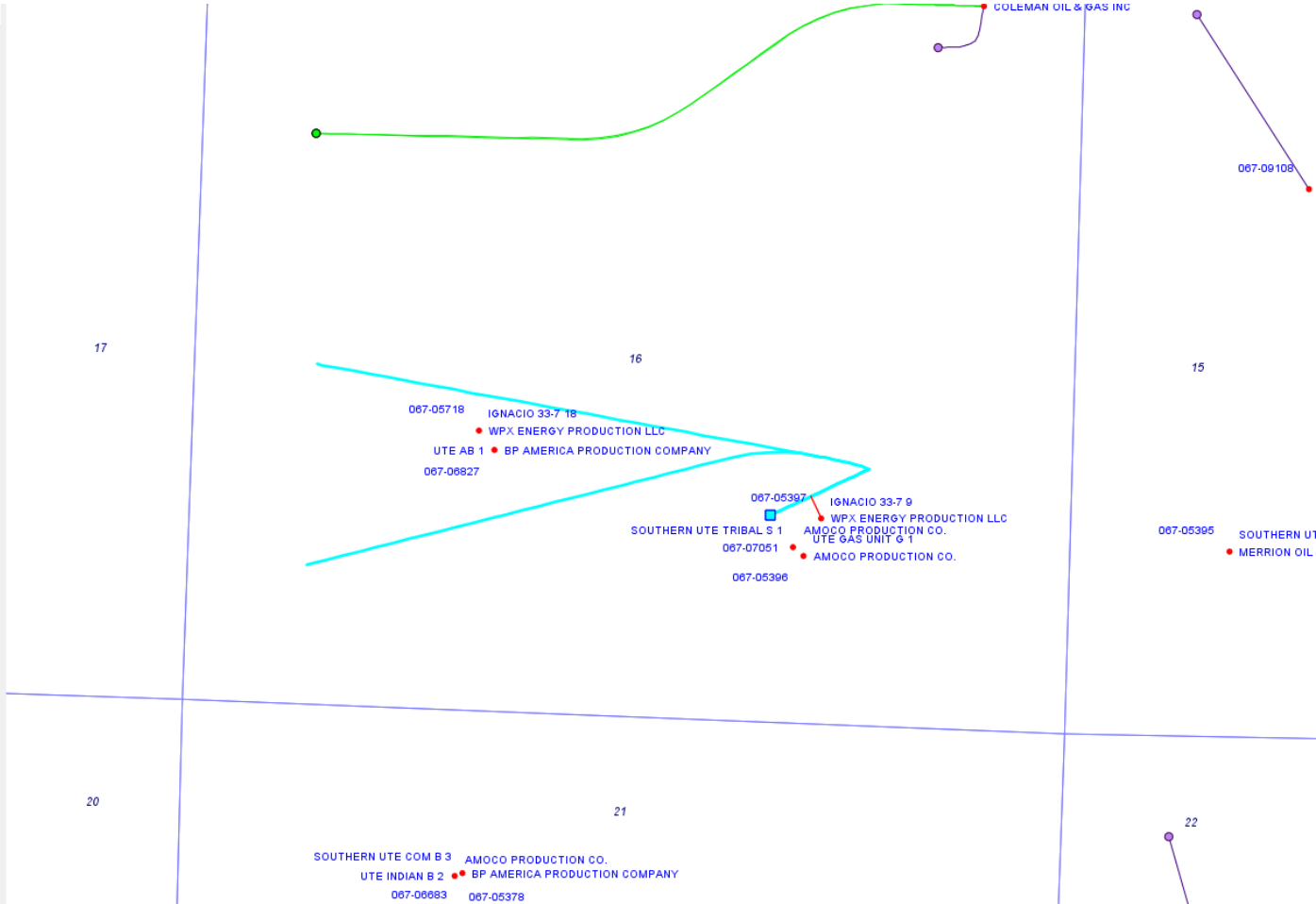

Measure Distance

Click a start and end point.

Segment:	143.91	(Feet)
Segment:	0.03	(Miles)
Total:	143.91	(Feet)
Total:	0.03	(Miles)

- To measure multiple distances, continue clicking new points.
- To finish, click "Stop".
- You can pan or zoom and continue measuring by clicking "Resume".
- To start over, click "Clear".