

UELS, LLC
Corporate Office * 85 South 200 East
Vernal, UT 84078 * (435) 789-1017

DRAWN BY: M.D.	DATE DRAWN: 10-07-15
SCALE: 1" = 300'	
MULTI-WELL PLAN	FIGURE #7

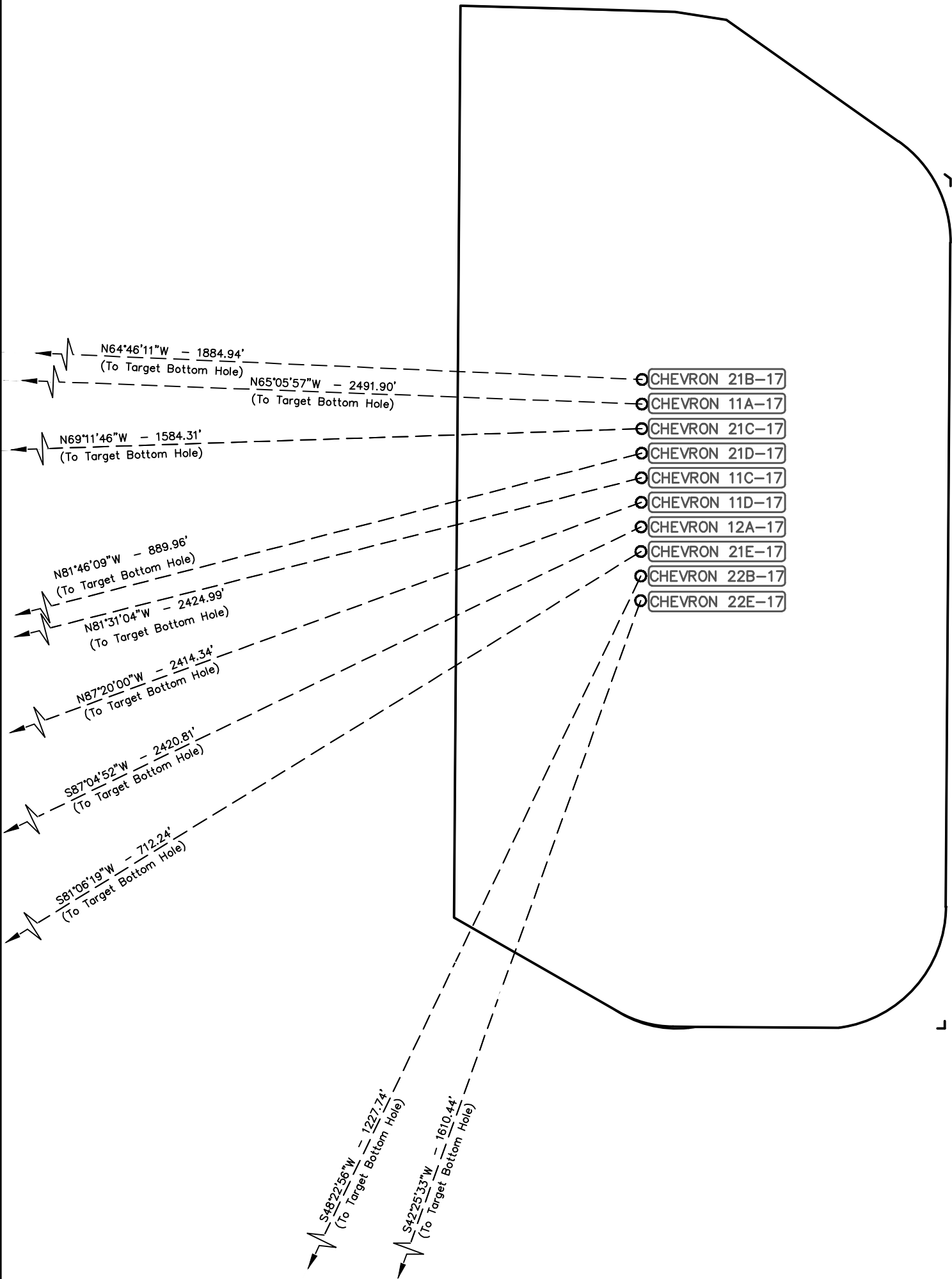
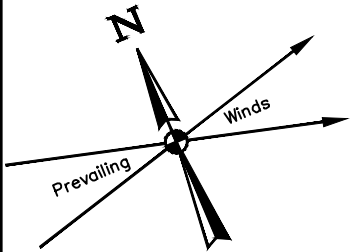

Caerus Oil & Gas LLC

PARACHUTE CREEK #5A
LOT 1, SECTION 17, T6S, R96W, 6th P.M.
GARFIELD COUNTY, COLORADO



UELS, LLC
Corporate Office * 85 South 200 East
Vernal, UT 84078 * (435) 789-1017

DRAWN BY: M.D.	DATE DRAWN: 10-07-15
SCALE: 1" = 50'	REVISED: 11-17-15 M.D.
TARGET BOTTOM HOLE DRAWING	FIGURE #6