



Lat40°, Inc. 6250 W. 10th Street, Unit 2, Greeley, CO 970-515-5294

CUT & FILL DIAGRAM

LATHAM 43-1 PAD

SECTION: 1
TOWNSHIP: 4N
RANGE: 63W
6TH. P.M.
WELD COUNTY, CO

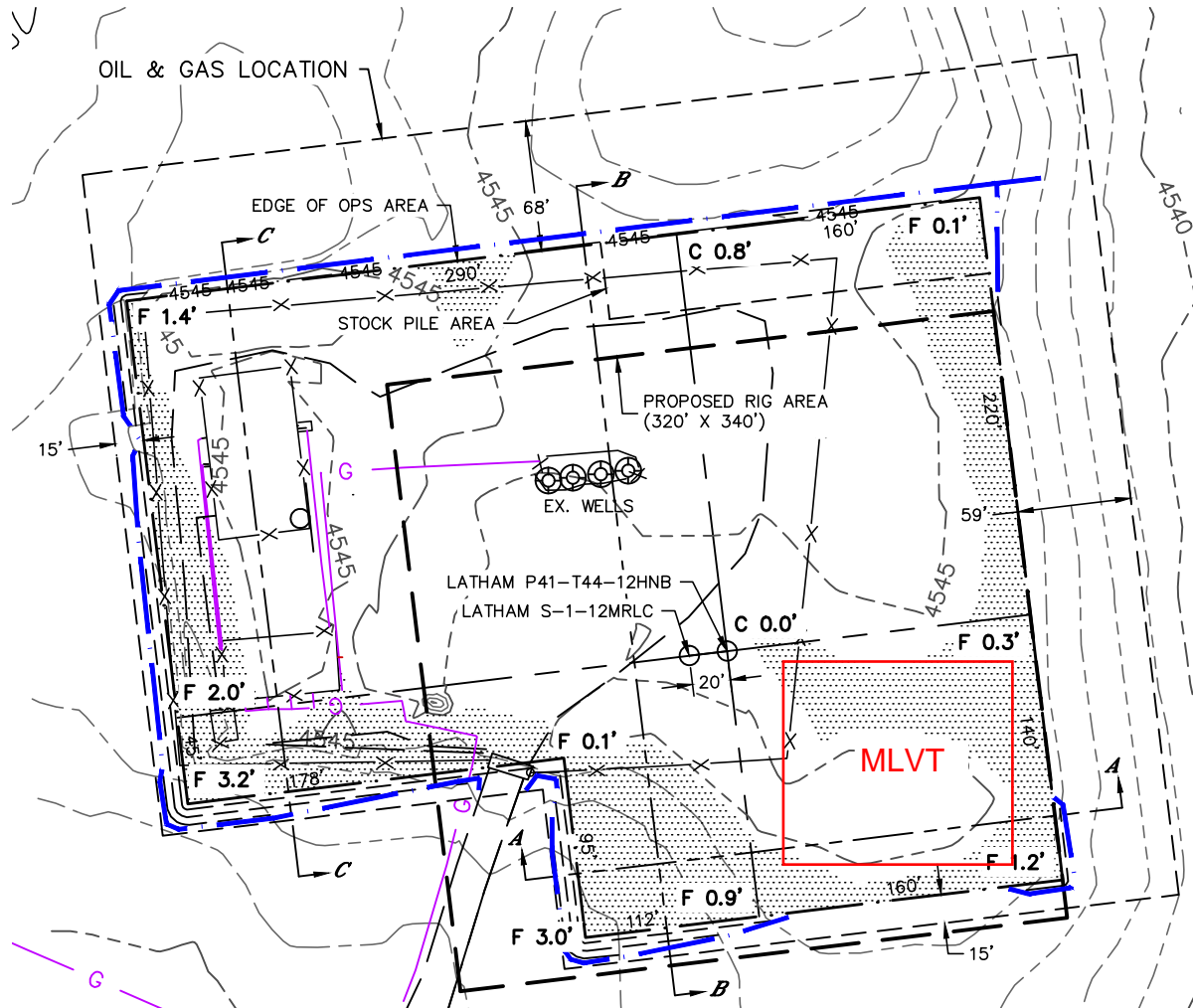

OPERATOR: BONANZA CREEK ENERGY
LOCATION: 1848' FSL, 750' FEL
EXISTING ELEV= 4545.0'
PROPOSED ELEV= 4544.8'
DISTURBANCE= 3.5 ACRES

ESTIMATED EARTHWORK:
TOPSOIL= 2,793 CY
CUT= 1,190 CY
FILL= 1,185 CY
STOCKPILE:
EXCESS= 5 CY

NOTE:

- 1) Ground elevations are based on an observed GPS elevation (NAVD 1988 DATUM).
- 2) A 10% swell factor has been assumed for in-situ cut material.
- 3) Proposed elevation does not account for top soil removal or plating material.
- 4) Top soil volume assumes 6" depth across entire location.
- 5) Entire pad shall be plated with 4-6" of course granular material.
- 6) Typical Fill slopes 4:1
- 7) Typical Cut slopes 3:1

LEGEND

EX. CONTOUR	---
PRO. CONTOUR	---
EROSION CONTROL	---
FILL AREA	---

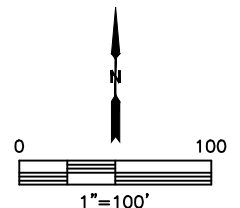

SHEET 1 OF 2

DATE: rev2/15/2016
PROJECT#: 2015071



Lat40°, Inc. 6250 W. 10th Street, Unit 2, Greeley, CO 970-515-5294

CROSS SECTION DIAGRAM

LATHAM 43-1 PAD

SECTION: 1
TOWNSHIP: 4N
RANGE: 63W
6TH. P.M.
WELD COUNTY, CO

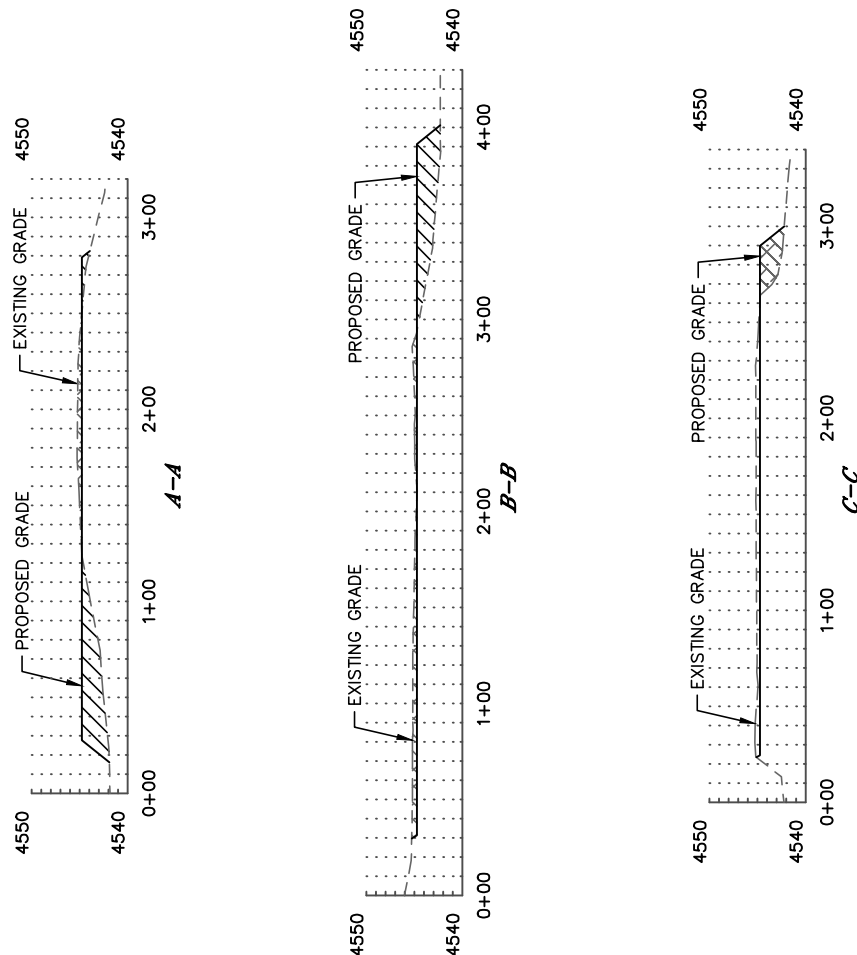

HORIZONTAL SCALE: 1"=100', VERTICAL SCALE: 1"=20'