

Project: Wattenberg Field
Site: AA (Sec.21-T06N-R63W) Weld County, CO
Well: Wells Ranch AA22-683
Wellbore: Original Drilling
Design: APD - Rev 3

Northern Region Drilling - Working

Geodetic System: US State Plane 1983
Datum: North American Datum 1983
Ellipsoid: GRS 1980
Zone: Colorado Northern Zone
System Datum: Mean Sea Level

SECTION DETAILS

Sec	MD	Inc	Azi	TVD	+N/-S	+E/-W	Dleg	TFace	VSec	Target
1	0.0	0.00	0.00	0.0	0.0	0.0	0.00	0.00	0.0	
2	1850.0	0.00	19.08	1850.0	0.0	0.0	0.00	19.08	0.0	
3	2100.0	0.00	19.08	2100.0	0.0	0.0	0.00	19.08	0.0	
4	2547.8	8.96	19.08	2546.0	33.0	11.4	2.00	19.08	14.9	
5	5879.9	8.96	19.08	5837.4	523.3	181.0	0.00	0.00	235.8	
6	6380.4	32.00	89.24	6307.7	562.8	329.8	6.00	84.77	387.9	
7	6630.4	52.00	89.24	6492.5	565.0	496.2	8.00	0.00	553.6	
8	7010.4	90.00	89.24	6614.0	569.7	848.9	10.00	0.00	904.8	
9	12097.1	90.00	89.25	6614.0	636.8	5935.1	0.00	91.74	5969.2	Wells Ranch AA22-683 BHL 473'FNL, 235'FWL

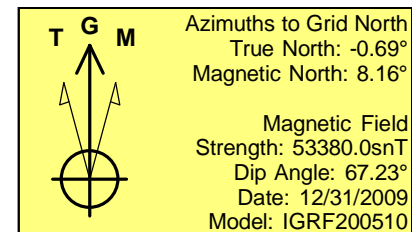
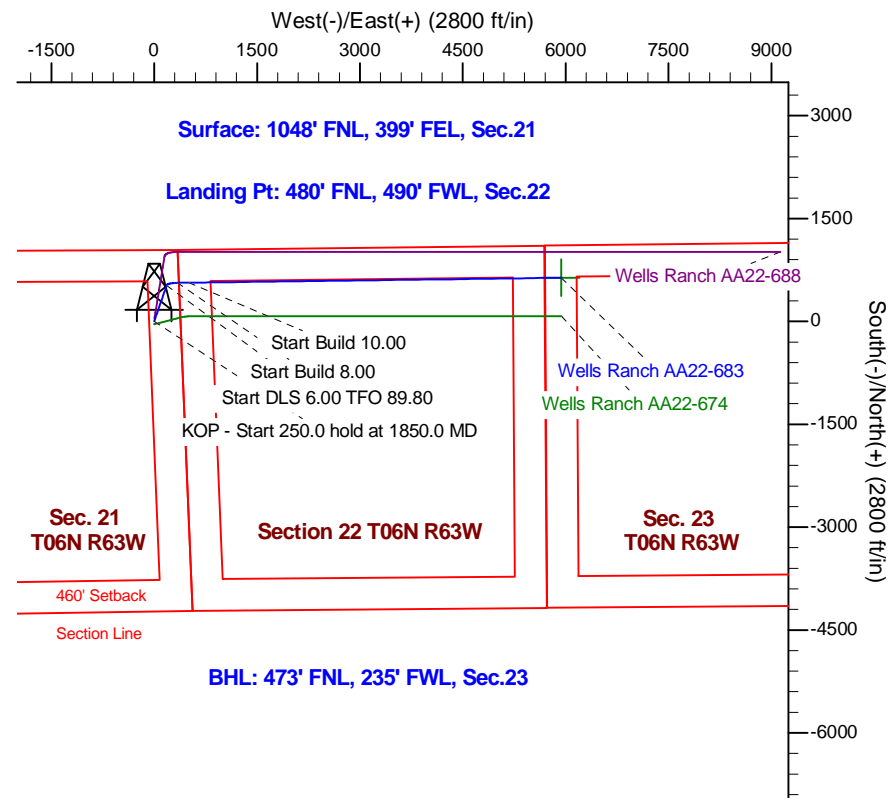
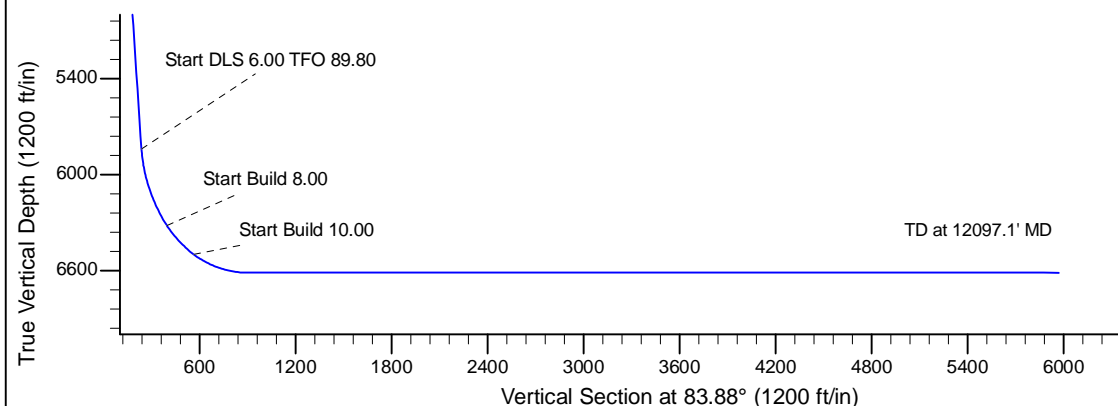
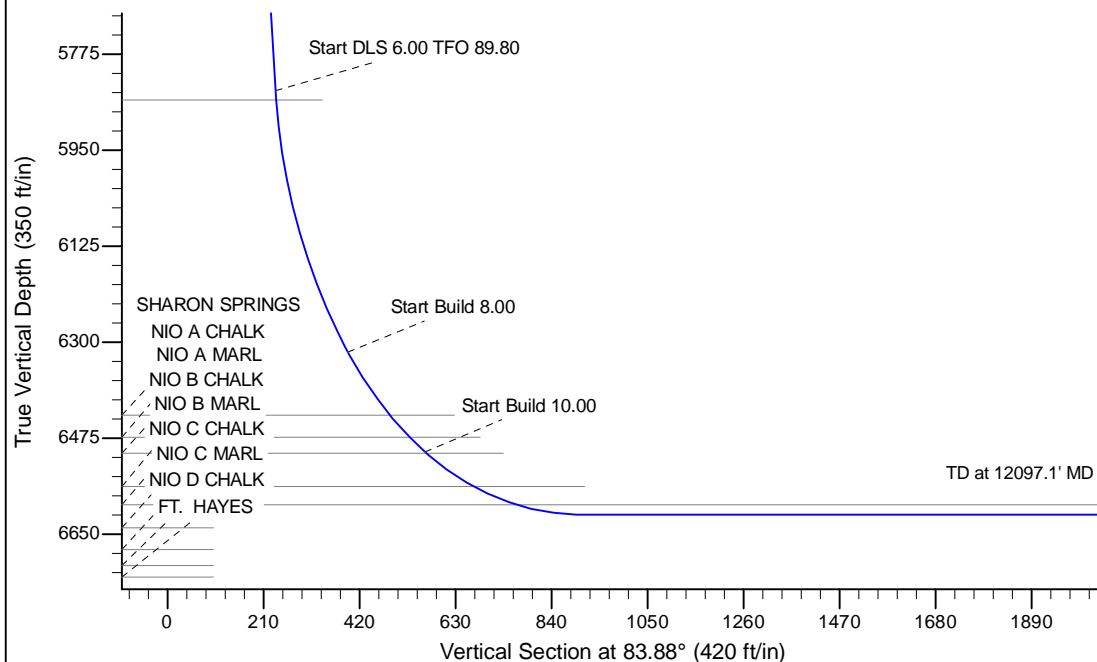

WELL DETAILS: Wells Ranch AA22-683

Ground Level: 4713.0				
	Northing	Easting	Latitude	Longitude
0.0	0.0	1418200.85	3296544.44	40.476470
				-104.434020

Plan: APD - Rev 3 (Wells Ranch AA22-683/Original Drilling)

Created By: Shailey Jewell Date: 10:44, April 22 2016

Checked: _____ Date: _____

Reviewed: _____ Date: _____

Approved: _____ Date: _____