



WHITING PETROLEUM CORP.

Project: Weld County, CO

Site: Sec 7-T10N-R57W

Well: Horsetail #07E-1804

Wellbore: Original Hole

Design: Original Hole



Precision
Directional Services

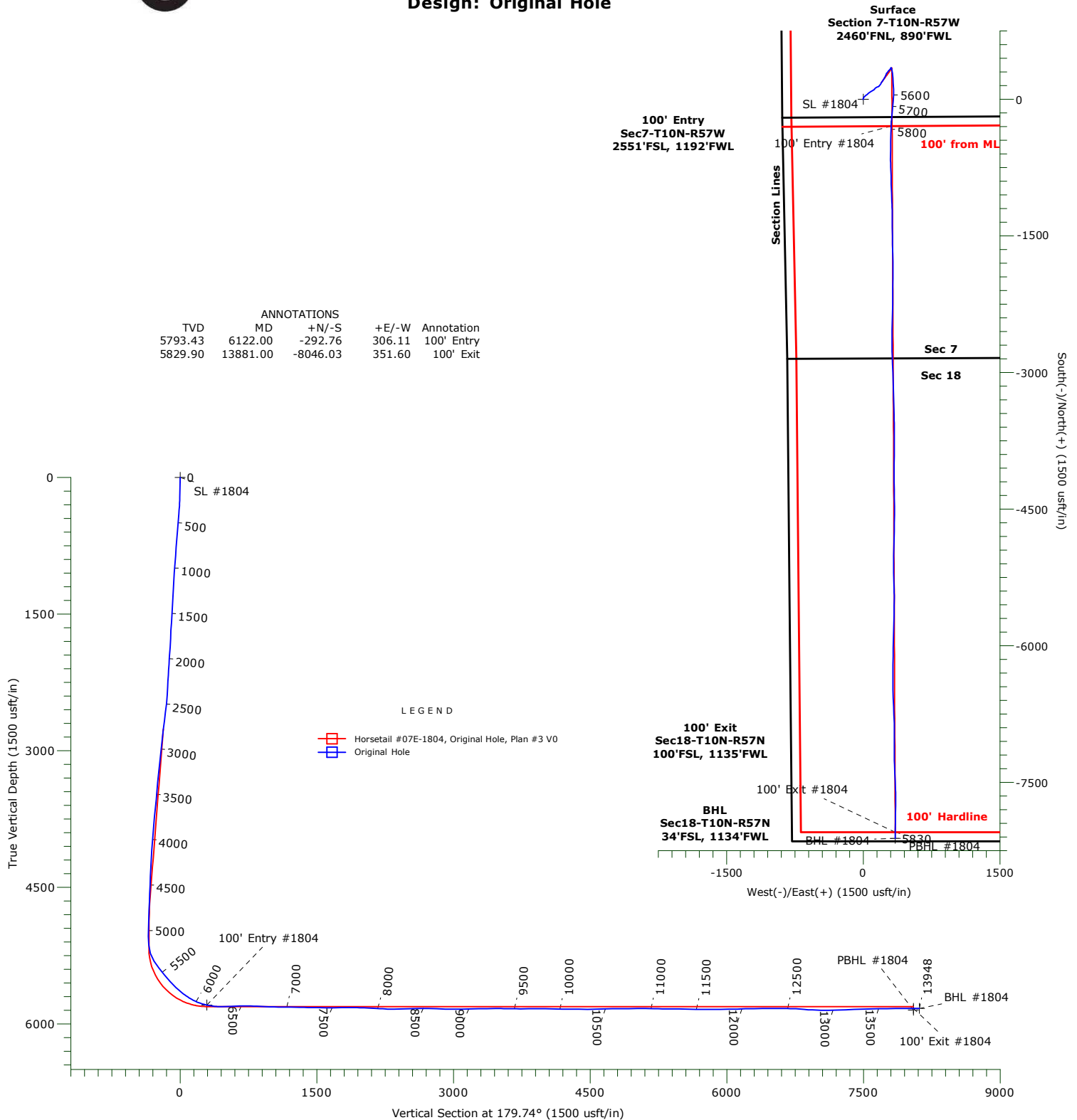

WELLBORE TARGET DETAILS

Name	TVD	+N/-S	+E/-W	Northing	Easting	Latitude	Longitude	Shape
SL #1804	0.00	0.00	0.00	1558451.53	3470040.09	40.853964°N	103.800824°W	Point
100' Entry #1804	5793.43	-292.76	306.11	1558164.69	3470351.75	40.853160°N	103.799718°W	Point
100' Exit #1804	5829.90	-8046.03	351.59	1550413.71	3470545.79	40.831880°N	103.799554°W	Point
BHL #1804	5830.14	-8113.03	350.70	1550346.71	3470546.17	40.831696°N	103.799557°W	Point
PBHL #1804	5848.00	-8046.91	351.00	1550412.82	3470545.21	40.831878°N	103.799556°W	Point

WHITING PETROLEUM CORP.

Weld County, CO

Sec 7-T10N-R57W

Horsetail #07E-1804

Original Hole

Design: Original Hole

Standard Survey Report

22 February, 2016

Precision Drilling Corporation

Survey Report

Company:	WHITING PETROLEUM CORP.	Local Co-ordinate Reference:	Well Horsetail #07E-1804
Project:	Weld County, CO	TVD Reference:	4925.6'GL+21'KB @ 4946.60usft (Unit 409)
Site:	Sec 7-T10N-R57W	MD Reference:	4925.6'GL+21'KB @ 4946.60usft (Unit 409)
Well:	Horsetail #07E-1804	North Reference:	True
Wellbore:	Original Hole	Survey Calculation Method:	Minimum Curvature
Design:	Original Hole	Database:	Compass_US

Project	Weld County, CO		
Map System:	US State Plane 1983	System Datum:	Mean Sea Level
Geo Datum:	North American Datum 1983		
Map Zone:	Colorado Northern Zone		

Site		Sec 7-T10N-R57W			
Site Position:		Northing:	1,558,398.04 usft	Latitude:	40.853825°N
From:	Lat/Long	Easting:	3,469,889.54 usft	Longitude:	103.801372°W
Position Uncertainty:	0.00 usft	Slot Radius:	13.20 in	Grid Convergence:	1.10 °

Well		Horsetail #07E-1804				
Well Position	+N-S	0.00 usft	Northing:	1,558,451.53 usft	Latitude:	40.853964°N
	+E-W	0.00 usft	Easting:	3,470,040.09 usft	Longitude:	103.800825°W
Position Uncertainty		0.00 usft	Wellhead Elevation:	0.00 usft	Ground Level:	4,925.60 usft

Wellbore	Original Hole				
Magnetics	Model Name	Sample Date	Declination (°)	Dip Angle (°)	Field Strength (nT)
	IGRF2015	03/07/16	7.86	67.40	52,870
	IGRF2015	02/19/16	7.86	67.40	52,875

Design	Original Hole				
Audit Notes:					
Version:	1.0	Phase:	ACTUAL	Tie On Depth:	0.00
Vertical Section:	Depth From (TVD) (usft)	+N-S (usft)	+E-W (usft)	Direction (°)	
	0.00	0.00	0.00		179.74

Survey									
Measured Depth (usft)	Inclination (°)	Azimuth (°)	Vertical Depth (usft)	+N-S (usft)	+E-W (usft)	Vertical Section (usft)	Dogleg Rate (°/100usft)	Build Rate (°/100usft)	Turn Rate (°/100usft)
0.00	0.00	0.00	0.00	0.00	0.00	0.00	0.00	0.00	0.00
SL #1804									
222.00	1.60	323.53	221.97	2.49	-1.84	-2.50	0.72	0.72	0.00
313.00	3.44	13.70	312.89	6.17	-1.95	-6.18	2.98	2.02	55.13
405.00	5.02	23.11	404.64	12.55	0.28	-12.55	1.87	1.72	10.23
496.00	6.57	39.44	495.17	20.23	5.15	-20.21	2.47	1.70	17.95
588.00	6.55	40.68	586.57	28.28	11.92	-28.22	0.16	-0.02	1.35
680.00	6.78	52.85	677.95	35.54	19.67	-35.45	1.55	0.25	13.23
771.00	6.84	51.82	768.31	42.13	28.21	-42.00	0.15	0.07	-1.13
863.00	6.50	51.33	859.69	48.77	36.58	-48.61	0.37	-0.37	-0.53
954.00	6.40	49.04	950.11	55.32	44.43	-55.11	0.30	-0.11	-2.52
1,046.00	6.00	50.28	1,041.58	61.75	52.00	-61.51	0.46	-0.43	1.35
1,137.00	6.05	50.41	1,132.07	67.84	59.36	-67.57	0.06	0.05	0.14
1,230.00	5.83	52.03	1,224.57	73.87	66.86	-73.57	0.30	-0.24	1.74
1,322.00	5.68	56.81	1,316.11	79.24	74.35	-78.90	0.55	-0.16	5.20

Precision Drilling Corporation

Survey Report

Company:	WHITING PETROLEUM CORP.	Local Co-ordinate Reference:	Well Horsetail #07E-1804
Project:	Weld County, CO	TVD Reference:	4925.6'GL+21'KB @ 4946.60usft (Unit 409)
Site:	Sec 7-T10N-R57W	MD Reference:	4925.6'GL+21'KB @ 4946.60usft (Unit 409)
Well:	Horsetail #07E-1804	North Reference:	True
Wellbore:	Original Hole	Survey Calculation Method:	Minimum Curvature
Design:	Original Hole	Database:	Compass_US

Survey										
Measured Depth (usft)	Inclination (°)	Azimuth (°)	Vertical Depth (usft)	+N/-S (usft)	+E/-W (usft)	Vertical Section (usft)	Dogleg Rate (°/100usft)	Build Rate (°/100usft)	Turn Rate (°/100usft)	
1,414.00	5.78	56.97	1,407.65	84.26	82.04	-83.89	0.11	0.11	0.17	
1,506.00	6.02	57.30	1,499.16	89.39	89.99	-88.98	0.26	0.26	0.36	
1,598.00	5.90	59.08	1,590.67	94.43	98.10	-93.98	0.24	-0.13	1.93	
1,689.00	6.37	58.04	1,681.14	99.50	106.40	-99.02	0.53	0.52	-1.14	
1,780.00	5.38	59.19	1,771.67	104.36	114.35	-103.84	1.10	-1.09	1.26	
1,872.00	4.93	41.23	1,863.30	109.54	120.66	-108.99	1.81	-0.49	-19.52	
1,963.00	4.77	41.83	1,953.97	115.30	125.76	-114.73	0.18	-0.18	0.66	
2,000.00	4.92	39.14	1,990.84	117.68	127.78	-117.10	0.74	0.41	-7.27	
2,308.00	7.90	66.39	2,296.95	136.41	155.53	-135.70	1.36	0.97	8.85	
2,402.00	7.86	64.58	2,390.06	141.75	167.25	-140.99	0.27	-0.04	-1.93	
2,497.00	8.23	35.99	2,484.16	150.05	177.12	-149.24	4.19	0.39	-30.09	
2,591.00	8.12	33.11	2,577.21	161.05	184.70	-160.21	0.45	-0.12	-3.06	
2,686.00	8.00	33.66	2,671.27	172.17	192.03	-171.30	0.15	-0.13	0.58	
2,780.00	8.02	33.11	2,764.35	183.11	199.24	-182.20	0.08	0.02	-0.59	
2,874.00	8.07	35.51	2,857.43	193.97	206.65	-193.03	0.36	0.05	2.55	
2,968.00	7.96	34.16	2,950.51	204.73	214.14	-203.76	0.23	-0.12	-1.44	
3,063.00	7.59	32.53	3,044.64	215.46	221.20	-214.46	0.45	-0.39	-1.72	
3,157.00	7.02	30.05	3,137.87	225.67	227.42	-224.64	0.69	-0.61	-2.64	
3,274.00	6.17	25.98	3,254.10	237.51	233.75	-236.45	0.83	-0.73	-3.48	
3,368.00	5.76	24.94	3,347.59	246.33	237.96	-245.25	0.45	-0.44	-1.11	
3,463.00	5.58	24.25	3,442.12	254.86	241.86	-253.76	0.20	-0.19	-0.73	
3,557.00	5.55	25.36	3,535.68	263.14	245.69	-262.02	0.12	-0.03	1.18	
3,652.00	5.83	23.97	3,630.21	271.70	249.61	-270.56	0.33	0.29	-1.46	
3,746.00	5.98	22.88	3,723.71	280.57	253.46	-279.42	0.20	0.16	-1.16	
3,840.00	6.43	42.46	3,817.17	288.97	258.92	-287.79	2.29	0.48	20.83	
3,934.00	5.90	40.33	3,910.63	296.53	265.60	-295.32	0.61	-0.56	-2.27	
4,028.00	5.75	35.79	4,004.15	304.04	271.48	-302.80	0.52	-0.16	-4.83	
4,123.00	5.14	35.69	4,098.72	311.35	276.74	-310.09	0.64	-0.64	-0.11	
4,216.00	3.96	46.44	4,191.42	316.95	281.50	-315.67	1.56	-1.27	11.56	
4,311.00	3.96	46.33	4,286.20	321.47	286.25	-320.17	0.01	0.00	-0.12	
4,405.00	3.81	46.95	4,379.98	325.85	290.88	-324.52	0.17	-0.16	0.66	
4,499.00	3.27	36.17	4,473.80	330.14	294.74	-328.80	0.91	-0.57	-11.47	
4,593.00	2.76	32.70	4,567.67	334.21	297.55	-332.86	0.58	-0.54	-3.69	
4,687.00	2.43	26.84	4,661.58	337.89	299.67	-336.53	0.45	-0.35	-6.23	
4,782.00	2.21	16.34	4,756.50	341.45	301.10	-340.08	0.50	-0.23	-11.05	
4,876.00	1.76	8.66	4,850.44	344.62	301.82	-343.24	0.56	-0.48	-8.17	
4,971.00	1.83	60.02	4,945.40	346.82	303.36	-345.44	1.64	0.07	54.06	
5,065.00	1.68	60.12	5,039.36	348.25	305.85	-346.86	0.16	-0.16	0.11	
5,159.00	5.05	155.89	5,133.23	345.16	308.74	-343.76	5.83	3.59	101.88	
5,253.00	19.50	168.59	5,224.84	325.90	313.56	-324.47	15.55	15.37	13.51	
5,348.00	30.34	172.27	5,310.88	286.46	319.94	-285.01	11.52	11.41	3.87	
5,443.00	37.87	175.75	5,389.49	233.53	325.34	-232.05	8.19	7.93	3.66	
5,537.00	41.13	177.14	5,462.01	173.86	329.02	-172.37	3.59	3.47	1.48	

Precision Drilling Corporation

Survey Report

Company:	WHITING PETROLEUM CORP.	Local Co-ordinate Reference:	Well Horsetail #07E-1804
Project:	Weld County, CO	TVD Reference:	4925.6'GL+21'KB @ 4946.60usft (Unit 409)
Site:	Sec 7-T10N-R57W	MD Reference:	4925.6'GL+21'KB @ 4946.60usft (Unit 409)
Well:	Horsetail #07E-1804	North Reference:	True
Wellbore:	Original Hole	Survey Calculation Method:	Minimum Curvature
Design:	Original Hole	Database:	Compass_US

Survey

Measured Depth (usft)	Inclination (°)	Azimuth (°)	Vertical Depth (usft)	+N/-S (usft)	+E/-W (usft)	Vertical Section (usft)	Dogleg Rate (°/100usft)	Build Rate (°/100usft)	Turn Rate (°/100usft)
5,632.00	41.15	177.66	5,533.56	111.42	331.86	-109.92	0.36	0.02	0.55
5,726.00	45.84	180.80	5,601.74	46.76	332.65	-45.25	5.49	4.99	3.34
5,820.00	52.89	186.39	5,662.94	-24.32	328.00	25.81	8.75	7.50	5.95
5,915.00	57.99	186.08	5,716.82	-102.07	319.51	103.52	5.38	5.37	-0.33
6,009.00	67.18	184.17	5,760.05	-185.09	312.12	186.50	9.94	9.78	-2.03
6,056.00	73.25	182.87	5,775.96	-229.21	309.42	230.61	13.17	12.91	-2.77
6,104.00	74.95	183.10	5,789.11	-275.31	307.01	276.70	3.57	3.54	0.48
6,122.00	77.24	182.86	5,793.43	-292.75	306.11	294.14	12.81	12.74	-1.36
100' Entry #1804									
6,151.00	80.94	182.47	5,798.92	-321.20	304.78	322.58	12.81	12.75	-1.33
6,198.00	82.64	182.93	5,805.63	-367.66	302.59	369.03	3.74	3.62	0.98
6,292.00	90.91	179.94	5,810.91	-461.39	300.25	462.75	9.35	8.80	-3.18
6,386.00	92.81	180.04	5,807.86	-555.34	300.27	556.69	2.02	2.02	0.11
6,481.00	91.74	180.45	5,804.09	-650.26	299.86	651.61	1.21	-1.13	0.43
6,575.00	89.17	177.70	5,803.34	-744.23	301.38	745.59	4.00	-2.73	-2.93
6,670.00	87.04	178.52	5,806.49	-839.12	304.51	840.49	2.40	-2.24	0.86
6,764.00	87.57	178.53	5,810.91	-932.98	306.93	934.37	0.56	0.56	0.01
6,858.00	88.98	177.62	5,813.74	-1,026.88	310.09	1,028.28	1.79	1.50	-0.97
6,953.00	90.01	177.61	5,814.57	-1,121.80	314.04	1,123.21	1.08	1.08	-0.01
7,047.00	88.20	179.27	5,816.04	-1,215.74	316.60	1,217.17	2.61	-1.93	1.77
7,140.00	88.45	179.34	5,818.76	-1,308.70	317.73	1,310.12	0.28	0.27	0.08
7,235.00	89.59	179.20	5,820.38	-1,403.67	318.94	1,405.11	1.21	1.20	-0.15
7,329.00	89.10	179.42	5,821.46	-1,497.66	320.07	1,499.10	0.57	-0.52	0.23
7,424.00	89.74	179.04	5,822.42	-1,592.65	321.35	1,594.09	0.78	0.67	-0.40
7,518.00	91.13	178.84	5,821.71	-1,686.62	323.08	1,688.07	1.49	1.48	-0.21
7,612.00	89.40	179.46	5,821.27	-1,780.61	324.48	1,782.06	1.96	-1.84	0.66
7,707.00	90.62	179.85	5,821.26	-1,875.61	325.05	1,877.06	1.35	1.28	0.41
7,801.00	88.87	180.82	5,821.67	-1,969.60	324.50	1,971.05	2.13	-1.86	1.03
7,895.00	87.21	180.44	5,824.89	-2,063.53	323.47	2,064.98	1.81	-1.77	-0.40
7,990.00	85.75	179.61	5,830.72	-2,158.35	323.43	2,159.80	1.77	-1.54	-0.87
8,083.00	87.39	180.90	5,836.29	-2,251.18	323.01	2,252.62	2.24	1.76	1.39
8,178.00	90.57	181.26	5,837.98	-2,346.13	321.22	2,347.57	3.37	3.35	0.38
8,272.00	91.35	181.71	5,836.40	-2,440.09	318.79	2,441.51	0.96	0.83	0.48
8,366.00	92.73	181.26	5,833.06	-2,534.00	316.35	2,535.40	1.54	1.47	-0.48
8,460.00	91.63	180.29	5,829.48	-2,627.92	315.08	2,629.32	1.56	-1.17	-1.03
8,555.00	88.07	179.41	5,829.73	-2,722.90	315.33	2,724.30	3.86	-3.75	-0.93
8,649.00	87.27	178.12	5,833.55	-2,816.80	317.35	2,818.21	1.61	-0.85	-1.37
8,742.00	88.55	177.73	5,836.94	-2,909.67	320.72	2,911.10	1.44	1.38	-0.42
8,834.00	89.95	177.86	5,838.15	-3,001.59	324.26	3,003.03	1.53	1.52	0.14
8,926.00	91.42	177.77	5,837.05	-3,093.52	327.77	3,094.97	1.60	1.60	-0.10
9,017.00	90.56	178.49	5,835.47	-3,184.45	330.73	3,185.92	1.23	-0.95	0.79
9,109.00	90.07	178.37	5,834.97	-3,276.42	333.26	3,277.90	0.55	-0.53	-0.13
9,200.00	91.80	178.85	5,833.48	-3,367.38	335.46	3,368.86	1.97	1.90	0.53
9,292.00	90.70	178.36	5,831.48	-3,459.32	337.70	3,460.82	1.31	-1.20	-0.53

Precision Drilling Corporation

Survey Report

Company:	WHITING PETROLEUM CORP.	Local Co-ordinate Reference:	Well Horsetail #07E-1804
Project:	Weld County, CO	TVD Reference:	4925.6'GL+21'KB @ 4946.60usft (Unit 409)
Site:	Sec 7-T10N-R57W	MD Reference:	4925.6'GL+21'KB @ 4946.60usft (Unit 409)
Well:	Horsetail #07E-1804	North Reference:	True
Wellbore:	Original Hole	Survey Calculation Method:	Minimum Curvature
Design:	Original Hole	Database:	Compass_US

Survey

Measured Depth (usft)	Inclination (°)	Azimuth (°)	Vertical Depth (usft)	+N/-S (usft)	+E/-W (usft)	Vertical Section (usft)	Dogleg Rate (°/100usft)	Build Rate (°/100usft)	Turn Rate (°/100usft)
9,384.00	88.51	180.02	5,832.11	-3,551.30	339.00	3,552.81	2.99	-2.38	1.80
9,475.00	88.74	179.75	5,834.29	-3,642.28	339.18	3,643.78	0.39	0.25	-0.30
9,566.00	90.31	180.04	5,835.05	-3,733.27	339.35	3,734.77	1.75	1.73	0.32
9,658.00	91.34	179.59	5,833.72	-3,825.26	339.65	3,826.76	1.22	1.12	-0.49
9,750.00	89.18	180.90	5,833.31	-3,917.25	339.26	3,918.75	2.75	-2.35	1.42
9,841.00	89.20	180.41	5,834.59	-4,008.24	338.22	4,009.73	0.54	0.02	-0.54
9,933.00	89.32	180.00	5,835.78	-4,100.23	337.89	4,101.72	0.46	0.13	-0.45
10,026.00	89.45	179.45	5,836.78	-4,193.22	338.33	4,194.71	0.61	0.14	-0.59
10,118.00	88.79	178.53	5,838.19	-4,285.19	339.95	4,286.69	1.23	-0.72	-1.00
10,210.00	89.59	179.79	5,839.49	-4,377.17	341.30	4,378.68	1.62	0.87	1.37
10,302.00	90.15	179.19	5,839.70	-4,469.17	342.12	4,470.67	0.89	0.61	-0.65
10,393.00	92.16	180.38	5,837.87	-4,560.14	342.46	4,561.65	2.57	2.21	1.31
10,484.00	91.41	180.45	5,835.03	-4,651.09	341.80	4,652.60	0.83	-0.82	0.08
10,576.00	89.98	181.49	5,833.92	-4,743.07	340.25	4,744.57	1.92	-1.55	1.13
10,667.00	90.24	181.63	5,833.74	-4,834.04	337.77	4,835.52	0.32	0.29	0.15
10,758.00	91.57	180.60	5,832.30	-4,925.01	336.00	4,926.48	1.85	1.46	-1.13
10,850.00	91.27	181.42	5,830.02	-5,016.96	334.38	5,018.43	0.95	-0.33	0.89
10,940.00	88.28	179.69	5,830.38	-5,106.94	333.51	5,108.40	3.84	-3.32	-1.92
11,032.00	88.04	179.53	5,833.33	-5,198.89	334.13	5,200.36	0.31	-0.26	-0.17
11,124.00	89.22	178.54	5,835.53	-5,290.85	335.68	5,292.32	1.67	1.28	-1.08
11,215.00	90.74	178.33	5,835.56	-5,381.81	338.17	5,383.29	1.69	1.67	-0.23
11,307.00	88.82	180.01	5,835.92	-5,473.80	339.50	5,475.28	2.77	-2.09	1.83
11,400.00	88.79	180.68	5,837.86	-5,566.77	338.94	5,568.26	0.72	-0.03	0.72
11,491.00	88.48	180.06	5,840.02	-5,657.75	338.35	5,659.22	0.76	-0.34	-0.68
11,582.00	89.88	181.91	5,841.33	-5,748.72	336.79	5,750.19	2.55	1.54	2.03
11,674.00	90.22	181.79	5,841.25	-5,840.67	333.82	5,842.12	0.39	0.37	-0.13
11,765.00	90.50	181.33	5,840.67	-5,931.63	331.34	5,933.08	0.59	0.31	-0.51
11,857.00	91.39	181.07	5,839.16	-6,023.60	329.41	6,025.03	1.01	0.97	-0.28
11,949.00	91.70	180.82	5,836.68	-6,115.55	327.90	6,116.98	0.43	0.34	-0.27
12,040.00	91.18	181.04	5,834.39	-6,206.51	326.42	6,207.93	0.62	-0.57	0.24
12,132.00	90.80	180.69	5,832.80	-6,298.49	325.03	6,299.90	0.56	-0.41	-0.38
12,224.00	91.16	180.33	5,831.23	-6,390.47	324.21	6,391.88	0.55	0.39	-0.39
12,315.00	90.09	178.14	5,830.23	-6,481.45	325.43	6,482.86	2.68	-1.18	-2.41
12,405.00	89.34	177.75	5,830.68	-6,571.39	328.65	6,572.81	0.94	-0.83	-0.43
12,498.00	89.33	177.45	5,831.76	-6,664.30	332.55	6,665.74	0.32	-0.01	-0.32
12,590.00	86.65	177.34	5,834.99	-6,756.14	336.73	6,757.60	2.92	-2.91	-0.12
12,682.00	85.78	179.08	5,841.06	-6,847.89	339.59	6,849.36	2.11	-0.95	1.89
12,773.00	87.14	179.48	5,846.68	-6,938.71	340.74	6,940.18	1.56	1.49	0.44
12,864.00	88.35	180.00	5,850.26	-7,029.64	341.15	7,031.11	1.45	1.33	0.57
12,956.00	90.99	180.16	5,850.79	-7,121.63	341.02	7,123.10	2.87	2.87	0.17
13,046.00	91.88	179.52	5,848.54	-7,211.60	341.27	7,213.07	1.22	0.99	-0.71
13,138.00	92.17	178.31	5,845.29	-7,303.52	343.01	7,305.00	1.35	0.32	-1.32
13,229.00	93.13	177.93	5,841.08	-7,394.37	345.99	7,395.87	1.13	1.05	-0.42

Precision Drilling Corporation

Survey Report

Company:	WHITING PETROLEUM CORP.	Local Co-ordinate Reference:	Well Horsetail #07E-1804
Project:	Weld County, CO	TVD Reference:	4925.6'GL+21'KB @ 4946.60usft (Unit 409)
Site:	Sec 7-T10N-R57W	MD Reference:	4925.6'GL+21'KB @ 4946.60usft (Unit 409)
Well:	Horsetail #07E-1804	North Reference:	True
Wellbore:	Original Hole	Survey Calculation Method:	Minimum Curvature
Design:	Original Hole	Database:	Compass_US

Survey										
Measured Depth (usft)	Inclination (°)	Azimuth (°)	Vertical Depth (usft)	+N/-S (usft)	+E/-W (usft)	Vertical Section (usft)	Dogleg Rate (°/100usft)	Build Rate (°/100usft)	Turn Rate (°/100usft)	
13,321.00	91.56	177.42	5,837.31	-7,486.22	349.72	7,487.73	1.79	-1.71	-0.55	
13,412.00	90.26	177.85	5,835.87	-7,577.13	353.48	7,578.65	1.50	-1.43	0.47	
13,503.00	91.51	180.33	5,834.46	-7,668.09	354.92	7,669.63	3.05	1.37	2.73	
13,594.00	91.34	180.58	5,832.20	-7,759.06	354.20	7,760.59	0.33	-0.19	0.27	
13,686.00	90.57	180.47	5,830.67	-7,851.05	353.36	7,852.57	0.85	-0.84	-0.12	
13,778.00	90.25	180.42	5,830.01	-7,943.04	352.64	7,944.56	0.35	-0.35	-0.05	
13,870.00	89.92	180.71	5,829.87	-8,035.04	351.74	8,036.55	0.48	-0.36	0.32	
13,881.00	89.82	180.76	5,829.90	-8,046.04	351.60	8,047.55	1.02	-0.93	0.43	
100' Exit #1804										
13,881.93	89.81	180.76	5,829.90	-8,046.96	351.58	8,048.48	1.02	-0.93	0.43	
PBHL #1804										
13,884.00	89.79	180.77	5,829.91	-8,049.03	351.56	8,050.55	1.02	-0.93	0.43	
13,948.00	89.79	180.77	5,830.14	-8,113.03	350.70	8,114.54	0.00	0.00	0.00	
BHL #1804										

Design Targets										
Target Name	Dip Angle (°)	Dip Dir. (°)	TVD (usft)	+N/-S (usft)	+E/-W (usft)	Northing (usft)	Easting (usft)	Latitude	Longitude	
SL #1804	0.00	0.00	0.00	0.00	0.00	1,558,451.53	3,470,040.09	40.853964°N	103.800825°W	
- actual wellpath hits target center										
- Point										
100' Entry #1804	0.00	0.00	5,793.43	-292.76	306.11	1,558,164.69	3,470,351.75	40.853160°N	103.799718°W	
- actual wellpath hits target center										
- Point										
100' Exit #1804	0.00	0.00	5,829.90	-8,046.04	351.60	1,550,413.71	3,470,545.78	40.831880°N	103.799554°W	
- actual wellpath hits target center										
- Point										
BHL #1804	0.00	0.00	5,830.14	-8,113.03	350.70	1,550,346.71	3,470,546.17	40.831696°N	103.799557°W	
- actual wellpath hits target center										
- Point										
PBHL #1804	0.00	0.00	5,848.00	-8,046.91	351.00	1,550,412.82	3,470,545.21	40.831878°N	103.799556°W	
- actual wellpath misses target center by 18.11usft at 13881.95usft MD (5829.90 TVD, -8046.98 N, 351.58 E)										
- Point										

Design Annotations					
Measured Depth (usft)	Vertical Depth (usft)	Local Coordinates			
		+N/-S (usft)	+E/-W (usft)	Comment	
6,122.00	5,793.43	-292.76	306.11	100' Entry	
13,881.00	5,829.90	-8,046.04	351.60	100' Exit	