

NOTES:

- Flare Stack is to be located a min. of 100' from the wellhead.
- Contours shown at 2' intervals.

SWMP LEGEND:

DP – DETENTION POND

SCE – STABILIZED CONSTRUCTION ENTRANCE

SedR – SEDIMENT RESERVOIR

Caerus Oil & Gas LLC

MESA 125-697 ON EXISTING PUCKETT 43C-25 PAD
NE 1/4 SE 1/4, SECTION 25, T6S, R97W, 6th P.M.
GARFIELD COUNTY, COLORADO

SURVEYED BY	DATE	REVISED BY	DATE
BRIAN BAKER, B.B.	12-08-15		
DRAWN BY	DATE		
C.D.L.	01-08-16		
SCALE	1" = 60'		

TYPICAL RIG LAYOUT **FIGURE #3**

U.EL.S, LLC
Corporate Office * 85 South 200 East
Vernal, UT 84078 * (435) 789-1017

UINTAH
ENGINEERING & LAND SURVEYING

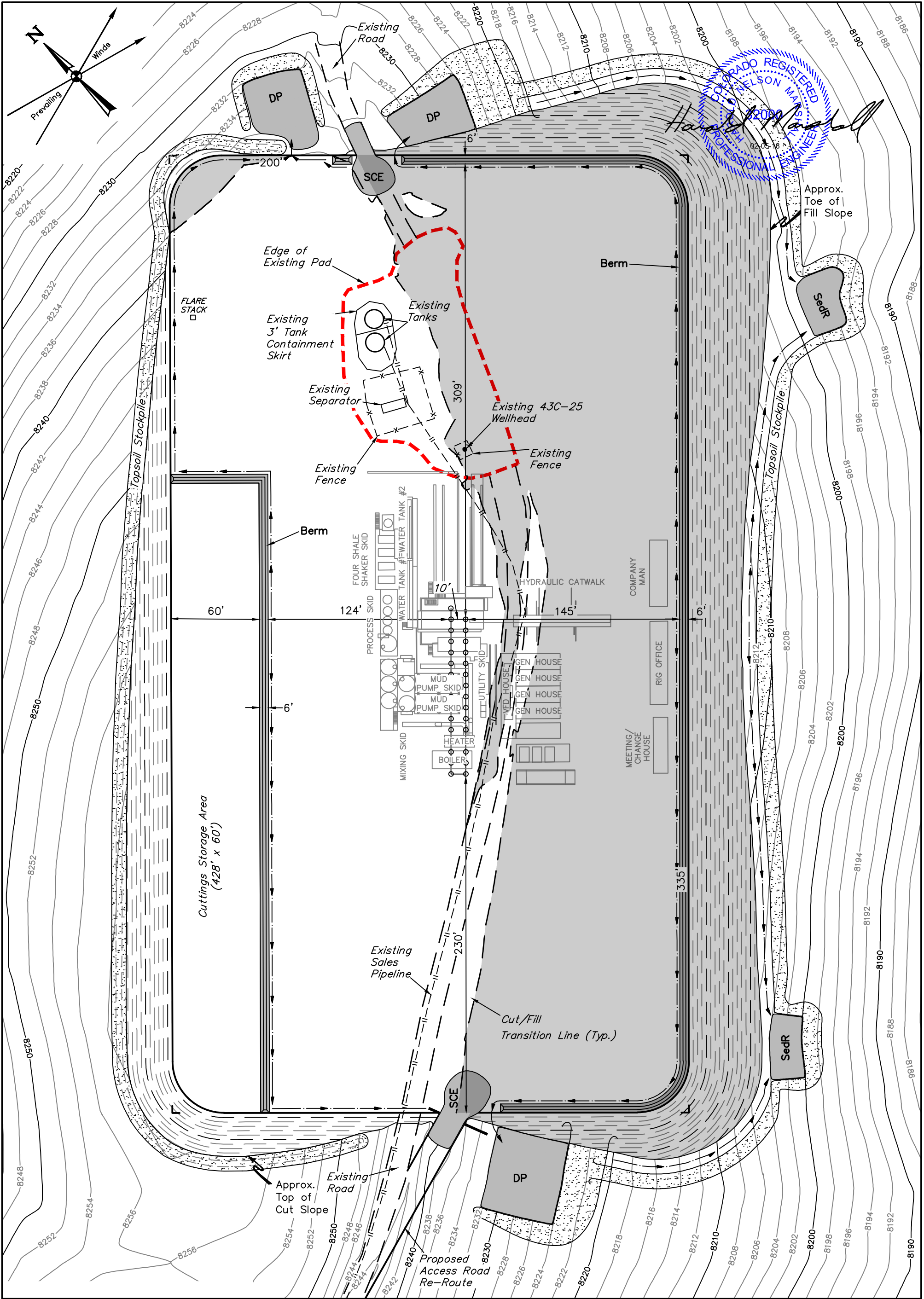

NOTES:

- Flare Stack is to be located a min. of 100' from the wellhead.
- Contours shown at 2' intervals.

SWMP LEGEND:

DP – DETENTION POND

SCE – STABILIZED CONSTRUCTION ENTRANCE

SedR – SEDIMENT RESERVOIR

Caerus Oil & Gas LLC

MESA 125-697 ON EXISTING PUCKETT 43C-25 PAD
NE 1/4 SE 1/4, SECTION 25, T6S, R97W, 6th P.M.
GARFIELD COUNTY, COLORADO

SURVEYED BY	DATE	REVISED BY	DATE
BRIAN BAKER, B.B.	12-08-15		
DRAWN BY	DATE		
C.D.L.	01-08-16		
SCALE	1" = 60'		

TYPICAL RIG LAYOUT **FIGURE #3A**

U.EL.S., LLC
Corporate Office * 85 South 200 East
Vernal, UT 84078 * (435) 789-1017

UINTAH
ENGINEERING & LAND SURVEYING

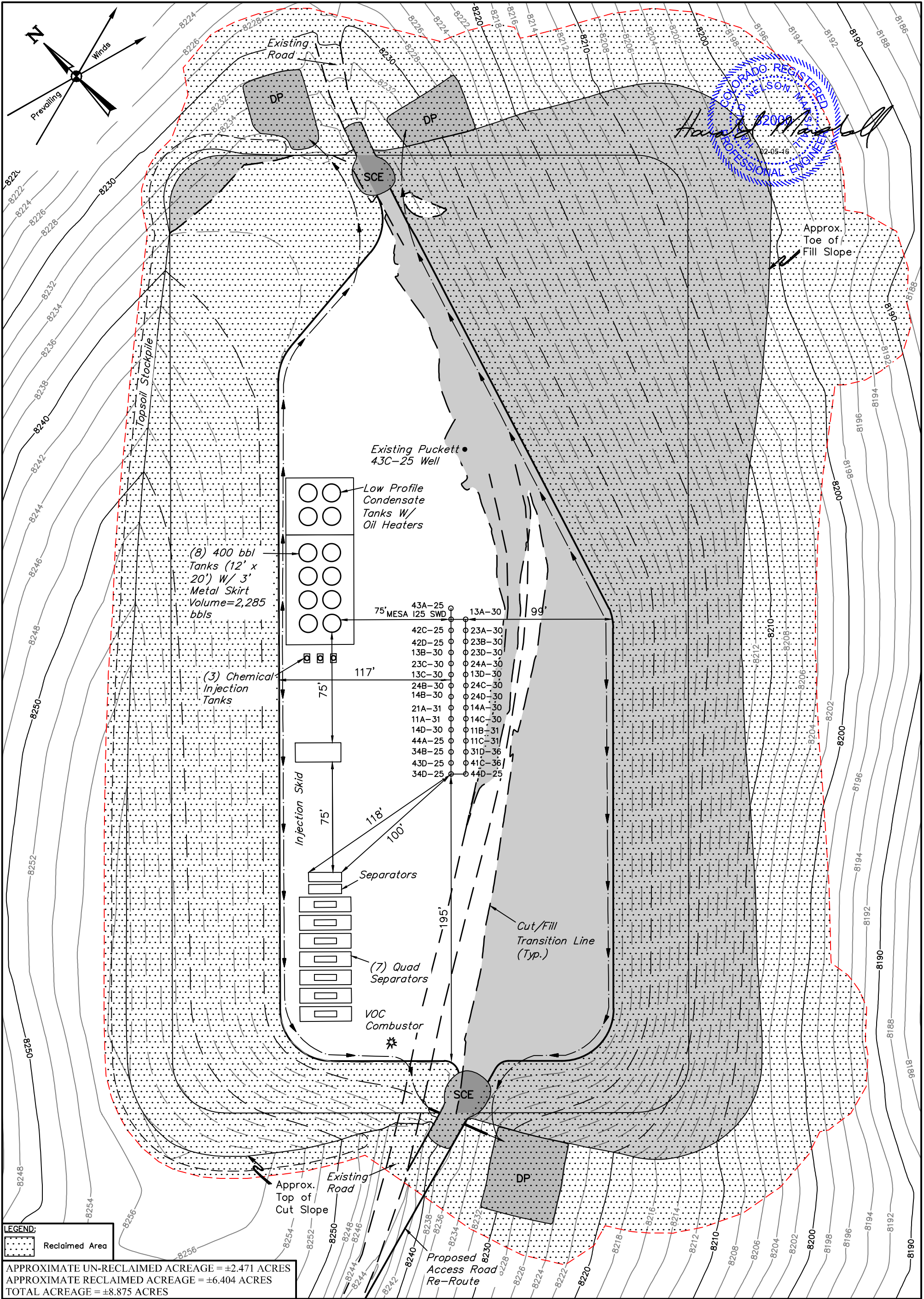

LEGEND:
Reclaimed Area

APPROXIMATE UN-RECLAIMED ACREAGE = ±2.471 ACRES
APPROXIMATE RECLAIMED ACREAGE = ±6.404 ACRES
TOTAL ACREAGE = ±8.875 ACRES

NOTES:
• Contours shown at 2' intervals.

SWMP LEGEND:
DP - DETENTION POND
SCE - STABILIZED CONSTRUCTION ENTRANCE

Caerus Oil & Gas LLC

**MESA 125-697 ON EXISTING PUCKETT 43C-25 PAD
NE 1/4 SE 1/4, SECTION 25, T6S, R97W, 6th P.M.
GARFIELD COUNTY, COLORADO**

SURVEYED BY	DATE	REVISED BY	DATE
BRIAN BAKER, B.B.	12-08-15		
DRAWN BY	DATE		
C.D.L.	01-08-16		
SCALE	1" = 60'		

INTERIM RECLAMATION PLAN

FIGURE #4



UELS, LLC
Corporate Office * 85 South 200 East
Vernal, UT 84078 * (435) 789-1017