

WELL DETAILS: Anschutz State 5-62-22-1724B2				PROJECT DETAILS: Weld County, CO NAD 83	
GL 4721' & KB 16' @ 4737.00ft (Cade 24) 4721.00				Geodetic System: US State Plane 1983	
Northing Easting Latitude Longitude				Datum: North American Datum 1983	
1386039.39 3329201.92 40° 23' 13.408 N 104° 19' 5.452 W				Ellipsoid: GRS 1980	
				Zone: Colorado Northern Zone	
				System Datum: Mean Sea Level	
				Local North: True	
				Plan: Plan 3 (Anschutz State 5-62-22-1724B2/OH)	
				Created By: Seth Burstad	
				Date: 7-26-15	

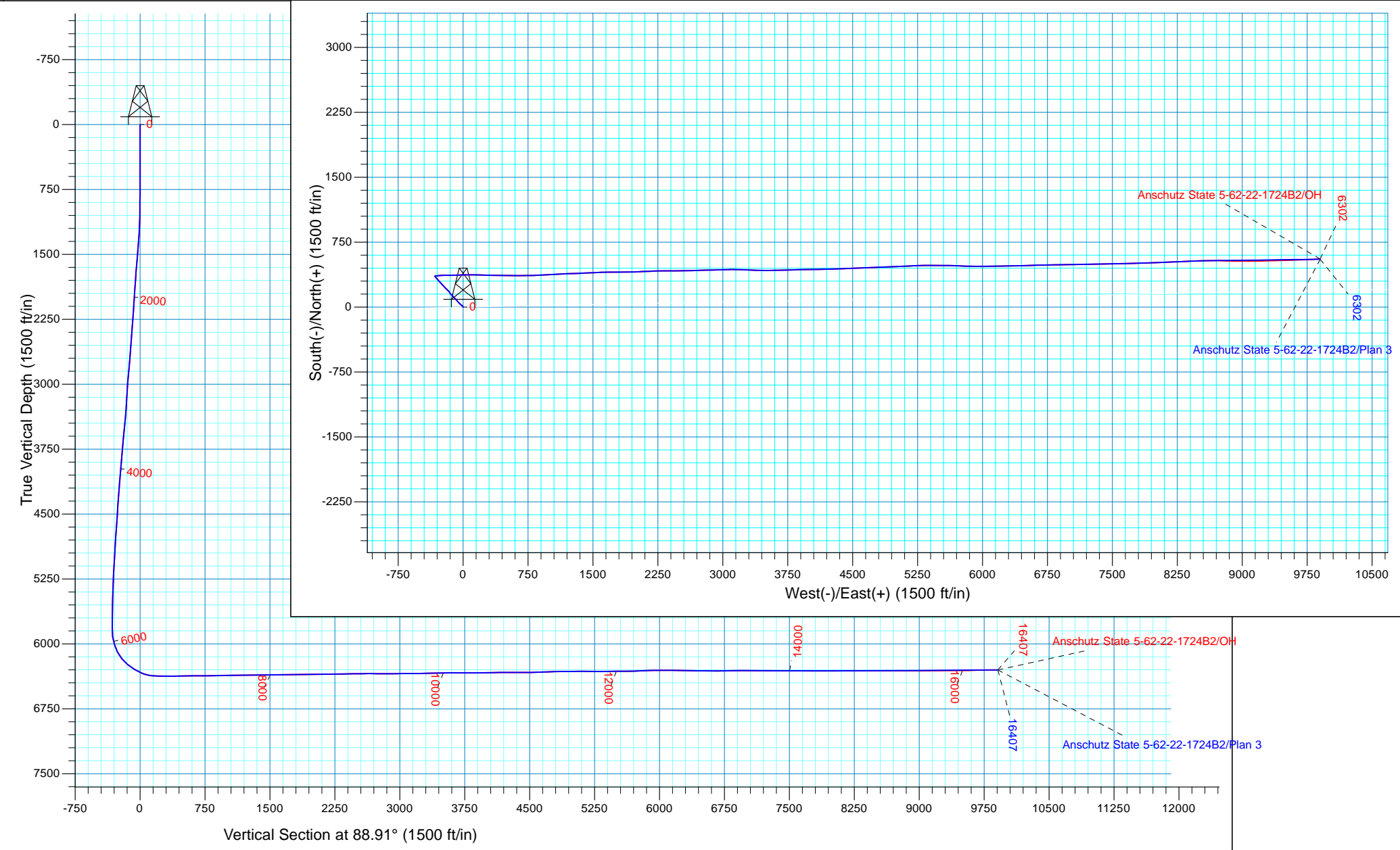



Bill Barrett Corporation

Bill Barrett Corp.

Weld County, CO NAD 83

Anschutz State 5-62-22_23 SWNW Pad

Anschutz State 5-62-22-1724B2

OH

Design: OH

Standard Survey Report

08 October, 2015



Scientific Drilling

www.scientificdrilling.com



Company:	Bill Barrett Corp.	Local Co-ordinate Reference:	Well Anschutz State 5-62-22-1724B2
Project:	Weld County, CO NAD 83	TVD Reference:	GL 4721' & KB 16' @ 4737.00ft (Cade 24)
Site:	Anschutz State 5-62-22_23 SWNW Pad	MD Reference:	GL 4721' & KB 16' @ 4737.00ft (Cade 24)
Well:	Anschutz State 5-62-22-1724B2	North Reference:	True
Wellbore:	OH	Survey Calculation Method:	Minimum Curvature
Design:	OH	Database:	Casper District

Project	Weld County, CO NAD 83		
Map System:	US State Plane 1983	System Datum:	Mean Sea Level
Geo Datum:	North American Datum 1983		
Map Zone:	Colorado Northern Zone		

Site		Anschutz State 5-62-22_23 SWNW Pad			
Site Position:		Northing:	1,386,054.73 usft	Latitude:	40° 23' 13.560 N
From:	Lat/Long	Easting:	3,329,201.72 usft	Longitude:	104° 19' 5.452 W
Position Uncertainty:	0.00 ft	Slot Radius:	13.200 in	Grid Convergence:	0.76 °

Well	Anschutz State 5-62-22-1724B2, 2015' FNL 350' FWL Sec 22 T5N R62W					
Well Position	+N/-S	0.00 ft	Northing:	1,386,039.40 usft	Latitude:	40° 23' 13.408 N
	+E/-W	0.00 ft	Easting:	3,329,201.93 usft	Longitude:	104° 19' 5.452 W
Position Uncertainty		0.00 ft	Wellhead Elevation:	0.00 ft	Ground Level:	4,721.00 ft

Wellbore	OH				
Magnetics	Model Name	Sample Date	Declination (°)	Dip Angle (°)	Field Strength (nT)
	BGGM2015	9/16/2015	8.28	67.03	52,655

Design	OH				
Audit Notes:					
Version:	1.0	Phase:	ACTUAL	Tie On Depth:	0.00
Vertical Section:	Depth From (TVD) (ft)	+N/-S (ft)	+E/-W (ft)	Direction (°)	
	0.00	0.00	0.00	88.91	

Survey Program	Date	10/8/2015			
From (ft)	To (ft)	Survey (Wellbore)	Tool Name	Description	
832.00	6,788.00	Survey #1 - Vertical / Curve (OH)	SDI MWD	SDI MWD - Standard ver 1.0.1	
6,883.00	16,407.00	Survey #2 - Lateral (OH)	SDI MWD	SDI MWD - Standard ver 1.0.1	

Survey										
Measured Depth (ft)	Inclination (°)	Azimuth (°)	Vertical Depth (ft)	+N/-S (ft)	+E/-W (ft)	Vertical Section (ft)	Dogleg Rate (°/100ft)	Build Rate (°/100ft)	Turn Rate (°/100ft)	
886.00	0.07	285.47	886.00	0.01	-0.03	-0.03	0.13	0.13	0.00	
First SDI MWD Survey										
978.00	1.00	316.87	978.00	0.61	-0.63	-0.62	1.02	1.01	34.13	
1,069.00	2.15	326.55	1,068.96	2.61	-2.12	-2.07	1.29	1.26	10.64	
1,161.00	3.54	322.92	1,160.84	6.32	-4.78	-4.66	1.52	1.51	-3.95	
1,252.00	4.91	315.31	1,251.59	11.33	-9.22	-9.00	1.62	1.51	-8.36	
1,344.00	5.60	309.49	1,343.21	16.98	-15.45	-15.12	0.95	0.75	-6.33	
1,435.00	6.65	310.84	1,433.69	23.25	-22.86	-22.42	1.16	1.15	1.48	
1,527.00	7.21	314.48	1,525.02	30.78	-31.01	-30.42	0.77	0.61	3.96	

Company:	Bill Barrett Corp.	Local Co-ordinate Reference:	Well Anschutz State 5-62-22-1724B2
Project:	Weld County, CO NAD 83	TVD Reference:	GL 4721' & KB 16' @ 4737.00ft (Cade 24)
Site:	Anschutz State 5-62-22_23 SWNW Pad	MD Reference:	GL 4721' & KB 16' @ 4737.00ft (Cade 24)
Well:	Anschutz State 5-62-22-1724B2	North Reference:	True
Wellbore:	OH	Survey Calculation Method:	Minimum Curvature
Design:	OH	Database:	Casper District

Survey										
Measured Depth (ft)	Inclination (°)	Azimuth (°)	Vertical Depth (ft)	+N/-S (ft)	+E/-W (ft)	Vertical Section (ft)	Dogleg Rate (°/100ft)	Build Rate (°/100ft)	Turn Rate (°/100ft)	
1,619.00	6.90	315.57	1,616.32	38.77	-39.00	-38.25	0.37	-0.34	1.18	
1,710.00	5.94	314.39	1,706.75	45.97	-46.19	-45.31	1.06	-1.05	-1.30	
1,802.00	6.26	316.98	1,798.23	52.97	-53.01	-52.00	0.46	0.35	2.82	
1,894.00	5.65	314.65	1,889.73	59.82	-59.66	-58.51	0.71	-0.66	-2.53	
1,985.00	5.95	319.39	1,980.26	66.55	-65.92	-64.64	0.62	0.33	5.21	
2,077.00	6.56	320.77	2,071.72	74.24	-72.34	-70.92	0.68	0.66	1.50	
2,168.00	5.84	324.45	2,162.18	82.03	-78.32	-76.75	0.90	-0.79	4.04	
2,260.00	6.30	319.44	2,253.67	89.67	-84.33	-82.60	0.76	0.50	-5.45	
2,352.00	5.55	315.42	2,345.18	96.68	-90.73	-88.88	0.93	-0.82	-4.37	
2,446.00	6.34	313.27	2,438.67	103.47	-97.70	-95.71	0.87	0.84	-2.29	
2,541.00	6.27	315.94	2,533.10	110.80	-105.13	-103.00	0.32	-0.07	2.81	
2,636.00	7.15	316.26	2,627.44	118.80	-112.82	-110.54	0.93	0.93	0.34	
2,730.00	7.94	315.96	2,720.63	127.69	-121.38	-118.93	0.84	0.84	-0.32	
2,824.00	7.73	314.51	2,813.75	136.79	-130.40	-127.78	0.31	-0.22	-1.54	
2,919.00	6.82	309.98	2,907.99	144.89	-139.28	-136.50	1.13	-0.96	-4.77	
3,014.00	6.66	324.60	3,002.34	153.01	-146.79	-143.86	1.81	-0.17	15.39	
3,108.00	6.54	326.42	3,095.71	161.91	-152.91	-149.81	0.26	-0.13	1.94	
3,202.00	5.69	331.25	3,189.18	170.46	-158.12	-154.84	1.06	-0.90	5.14	
3,297.00	6.62	319.95	3,283.63	178.78	-163.90	-160.47	1.60	0.98	-11.89	
3,392.00	6.99	314.03	3,377.97	186.99	-171.58	-168.00	0.83	0.39	-6.23	
3,486.00	7.39	314.94	3,471.23	195.23	-179.98	-176.23	0.44	0.43	0.97	
3,580.00	7.82	315.16	3,564.40	204.04	-188.76	-184.85	0.46	0.46	0.23	
3,674.00	8.00	315.02	3,657.51	213.20	-197.90	-193.81	0.19	0.19	-0.15	
3,769.00	7.78	314.44	3,751.61	222.38	-207.16	-202.89	0.25	-0.23	-0.61	
3,864.00	7.23	314.46	3,845.79	231.07	-216.02	-211.58	0.58	-0.58	0.02	
3,959.00	7.09	315.76	3,940.05	239.45	-224.38	-219.78	0.23	-0.15	1.37	
4,053.00	6.07	314.87	4,033.43	247.12	-231.95	-227.20	1.09	-1.09	-0.95	
4,148.00	6.19	318.92	4,127.89	254.52	-238.87	-233.99	0.47	0.13	4.26	
4,242.00	6.45	318.38	4,221.32	262.29	-245.71	-240.67	0.28	0.28	-0.57	
4,336.00	7.21	320.44	4,314.65	270.78	-252.97	-247.77	0.85	0.81	2.19	
4,431.00	6.88	320.01	4,408.93	279.74	-260.43	-255.06	0.35	-0.35	-0.45	
4,526.00	5.23	321.79	4,503.40	287.50	-266.76	-261.24	1.75	-1.74	1.87	
4,620.00	5.30	314.69	4,597.00	293.92	-272.50	-266.86	0.70	0.07	-7.55	
4,714.00	6.37	314.44	4,690.51	300.62	-279.31	-273.54	1.14	1.14	-0.27	
4,809.00	6.18	317.40	4,784.95	308.08	-286.53	-280.62	0.39	-0.20	3.12	
4,905.00	6.47	317.84	4,880.36	315.89	-293.66	-287.60	0.31	0.30	0.46	
4,999.00	5.58	318.75	4,973.84	323.25	-300.23	-294.02	0.95	-0.95	0.97	
5,094.00	4.89	320.77	5,068.44	329.86	-305.83	-299.50	0.75	-0.73	2.13	
5,188.00	4.24	320.78	5,162.15	335.66	-310.56	-304.12	0.69	-0.69	0.01	
5,282.00	3.34	318.02	5,255.94	340.39	-314.59	-308.06	0.98	-0.96	-2.94	
5,377.00	2.92	321.04	5,350.80	344.32	-317.97	-311.36	0.47	-0.44	3.18	
5,472.00	2.56	326.08	5,445.69	347.97	-320.67	-313.99	0.46	-0.38	5.31	
5,566.00	1.97	318.88	5,539.62	350.93	-322.90	-316.17	0.70	-0.63	-7.66	
5,660.00	1.78	318.54	5,633.56	353.24	-324.93	-318.16	0.20	-0.20	-0.36	

Company:	Bill Barrett Corp.	Local Co-ordinate Reference:	Well Anschutz State 5-62-22-1724B2
Project:	Weld County, CO NAD 83	TVD Reference:	GL 4721' & KB 16' @ 4737.00ft (Cade 24)
Site:	Anschutz State 5-62-22_23 SWNW Pad	MD Reference:	GL 4721' & KB 16' @ 4737.00ft (Cade 24)
Well:	Anschutz State 5-62-22-1724B2	North Reference:	True
Wellbore:	OH	Survey Calculation Method:	Minimum Curvature
Design:	OH	Database:	Casper District

Survey									
Measured Depth (ft)	Inclination (°)	Azimuth (°)	Vertical Depth (ft)	+N/-S (ft)	+E/-W (ft)	Vertical Section (ft)	Dogleg Rate (°/100ft)	Build Rate (°/100ft)	Turn Rate (°/100ft)
5,755.00	1.04	321.40	5,728.54	355.02	-326.45	-319.64	0.78	-0.78	3.01
5,849.00	1.07	307.71	5,822.52	356.22	-327.68	-320.84	0.27	0.03	-14.56
5,944.00	7.22	81.73	5,917.29	357.62	-322.46	-315.60	8.42	6.47	141.07
6,038.00	18.07	81.41	6,008.87	360.66	-302.14	-295.22	11.54	11.54	-0.34
6,132.00	25.44	85.72	6,096.12	364.35	-267.54	-260.56	8.02	7.84	4.59
6,227.00	41.75	88.81	6,174.99	366.54	-215.21	-208.20	17.26	17.17	3.25
6,321.00	49.61	90.27	6,240.62	367.03	-148.02	-141.01	8.43	8.36	1.55
6,415.00	59.24	88.36	6,295.24	368.02	-71.67	-64.65	10.38	10.24	-2.03
6,510.00	66.85	88.53	6,338.27	370.31	12.92	19.96	8.01	8.01	0.18
6,604.00	80.66	90.14	6,364.51	371.31	102.94	109.98	14.78	14.69	1.71
6,694.00	88.25	92.00	6,373.20	369.63	192.43	199.43	8.68	8.43	2.07
6,788.00	89.73	91.51	6,374.86	366.75	286.37	293.30	1.66	1.57	-0.52
Last SDI MWD Curve Survey									
6,883.00	90.60	90.38	6,374.58	365.18	381.36	388.23	1.50	0.92	-1.19
First SDI MWD Lateral Survey									
6,977.00	91.24	91.29	6,373.07	363.81	475.33	482.17	1.18	0.68	0.97
7,071.00	91.11	90.53	6,371.15	362.32	569.30	576.09	0.82	-0.14	-0.81
7,165.00	89.80	89.50	6,370.40	362.29	663.29	670.07	1.77	-1.39	-1.10
7,260.00	91.24	89.12	6,369.54	363.44	758.28	765.06	1.57	1.52	-0.40
7,354.00	90.40	87.48	6,368.19	366.23	852.22	859.04	1.96	-0.89	-1.74
7,449.00	91.14	86.99	6,366.91	370.81	947.10	953.99	0.93	0.78	-0.52
7,543.00	91.07	86.15	6,365.10	376.43	1,040.92	1,047.89	0.90	-0.07	-0.89
7,637.00	91.11	88.09	6,363.31	381.15	1,134.78	1,141.82	2.06	0.04	2.06
7,732.00	90.84	88.24	6,361.70	384.20	1,229.72	1,236.80	0.33	-0.28	0.16
7,826.00	90.60	87.63	6,360.52	387.58	1,323.65	1,330.78	0.70	-0.26	-0.65
7,920.00	90.57	87.03	6,359.56	391.96	1,417.54	1,424.74	0.64	-0.03	-0.64
8,016.00	90.30	87.18	6,358.83	396.81	1,513.41	1,520.69	0.32	-0.28	0.16
8,110.00	90.34	87.89	6,358.30	400.85	1,607.32	1,614.66	0.76	0.04	0.76
8,205.00	89.87	90.24	6,358.13	402.40	1,702.30	1,709.65	2.52	-0.49	2.47
8,300.00	91.31	89.53	6,357.15	402.59	1,797.30	1,804.63	1.69	1.52	-0.75
8,394.00	91.11	89.23	6,355.16	403.61	1,891.27	1,898.61	0.38	-0.21	-0.32
8,488.00	90.57	87.80	6,353.79	406.05	1,985.23	1,992.59	1.63	-0.57	-1.52
8,583.00	91.58	87.84	6,352.00	409.66	2,080.14	2,087.55	1.06	1.06	0.04
8,677.00	89.16	87.18	6,351.40	413.74	2,174.04	2,181.52	2.67	-2.57	-0.70
8,771.00	91.44	89.31	6,350.91	416.62	2,267.98	2,275.50	3.32	2.43	2.27
8,866.00	92.12	89.69	6,347.95	417.45	2,362.93	2,370.45	0.82	0.72	0.40
8,960.00	90.00	89.37	6,346.22	418.22	2,456.91	2,464.42	2.28	-2.26	-0.34
9,055.00	91.21	89.17	6,345.21	419.43	2,551.89	2,559.41	1.29	1.27	-0.21
9,149.00	89.63	88.88	6,344.52	421.03	2,645.87	2,653.40	1.71	-1.68	-0.31
9,244.00	89.43	88.15	6,345.30	423.49	2,740.84	2,748.40	0.80	-0.21	-0.77
9,338.00	89.43	88.08	6,346.24	426.58	2,834.78	2,842.38	0.07	0.00	-0.07
9,432.00	91.04	89.49	6,345.85	428.58	2,928.76	2,936.38	2.28	1.71	1.50
9,527.00	90.54	87.78	6,344.54	430.84	3,023.72	3,031.36	1.88	-0.53	-1.80

Company:	Bill Barrett Corp.	Local Co-ordinate Reference:	Well Anschutz State 5-62-22-1724B2
Project:	Weld County, CO NAD 83	TVD Reference:	GL 4721' & KB 16' @ 4737.00ft (Cade 24)
Site:	Anschutz State 5-62-22_23 SWNW Pad	MD Reference:	GL 4721' & KB 16' @ 4737.00ft (Cade 24)
Well:	Anschutz State 5-62-22-1724B2	North Reference:	True
Wellbore:	OH	Survey Calculation Method:	Minimum Curvature
Design:	OH	Database:	Casper District

Survey										
Measured Depth (ft)	Inclination (°)	Azimuth (°)	Vertical Depth (ft)	+N/-S (ft)	+E/-W (ft)	Vertical Section (ft)	Dogleg Rate (°/100ft)	Build Rate (°/100ft)	Turn Rate (°/100ft)	
9,622.00	90.37	90.36	6,343.79	432.38	3,118.69	3,126.35	2.72	-0.18	2.72	
9,717.00	90.00	91.74	6,343.48	430.64	3,213.67	3,221.28	1.50	-0.39	1.45	
9,812.00	92.08	93.50	6,341.76	426.30	3,308.55	3,316.06	2.87	2.19	1.85	
9,906.00	91.92	90.60	6,338.48	422.94	3,402.42	3,409.85	3.09	-0.17	-3.09	
10,001.00	90.10	90.39	6,336.80	422.12	3,497.40	3,504.80	1.93	-1.92	-0.22	
10,095.00	89.97	88.29	6,336.74	423.20	3,591.39	3,598.79	2.24	-0.14	-2.23	
10,189.00	90.44	88.41	6,336.41	425.91	3,685.35	3,692.78	0.52	0.50	0.13	
10,284.00	89.87	88.54	6,336.15	428.44	3,780.31	3,787.78	0.62	-0.60	0.14	
10,378.00	89.80	88.53	6,336.42	430.84	3,874.28	3,881.78	0.08	-0.07	-0.01	
10,470.00	90.94	89.21	6,335.83	432.65	3,966.26	3,973.77	1.44	1.24	0.74	
10,562.00	92.12	89.43	6,333.37	433.75	4,058.22	4,065.74	1.30	1.28	0.24	
10,653.00	90.37	88.19	6,331.39	435.64	4,149.17	4,156.71	2.36	-1.92	-1.36	
10,745.00	90.70	88.89	6,330.53	437.98	4,241.14	4,248.70	0.84	0.36	0.76	
10,836.00	89.76	87.44	6,330.17	440.89	4,332.09	4,339.69	1.90	-1.03	-1.59	
10,928.00	89.26	87.51	6,330.96	444.95	4,424.00	4,431.66	0.55	-0.54	0.08	
11,020.00	91.61	88.31	6,330.26	448.30	4,515.92	4,523.63	2.70	2.55	0.87	
11,111.00	92.02	88.18	6,327.37	451.09	4,606.84	4,614.58	0.47	0.45	-0.14	
11,202.00	91.61	87.40	6,324.49	454.59	4,697.72	4,705.52	0.97	-0.45	-0.86	
11,294.00	91.78	87.61	6,321.77	458.60	4,789.59	4,797.45	0.29	0.18	0.23	
11,386.00	90.10	87.47	6,320.26	462.55	4,881.49	4,889.41	1.83	-1.83	-0.15	
11,477.00	90.44	88.31	6,319.83	465.90	4,972.43	4,980.39	1.00	0.37	0.92	
11,569.00	90.37	87.73	6,319.18	469.07	5,064.37	5,072.38	0.63	-0.08	-0.63	
11,660.00	89.80	86.31	6,319.05	473.80	5,155.25	5,163.33	1.68	-0.63	-1.56	
11,752.00	89.40	88.09	6,319.69	478.30	5,247.13	5,255.28	1.98	-0.43	1.93	
11,844.00	90.60	89.67	6,319.69	480.10	5,339.11	5,347.27	2.16	1.30	1.72	
11,935.00	90.97	90.35	6,318.44	480.08	5,430.10	5,438.25	0.85	0.41	0.75	
12,027.00	90.54	89.85	6,317.23	479.92	5,522.09	5,530.22	0.72	-0.47	-0.54	
12,119.00	90.37	91.27	6,316.50	479.02	5,614.08	5,622.18	1.55	-0.18	1.54	
12,210.00	90.71	92.35	6,315.64	476.15	5,705.03	5,713.05	1.24	0.37	1.19	
12,302.00	92.99	92.34	6,312.67	472.39	5,796.90	5,804.84	2.48	2.48	-0.01	
12,393.00	92.79	91.02	6,308.08	469.72	5,887.74	5,895.61	1.47	-0.22	-1.45	
12,485.00	91.14	89.72	6,304.93	469.13	5,979.68	5,987.52	2.28	-1.79	-1.41	
12,576.00	88.92	89.33	6,304.88	469.88	6,070.67	6,078.51	2.48	-2.44	-0.43	
12,668.00	88.76	89.07	6,306.75	471.17	6,162.64	6,170.49	0.33	-0.17	-0.28	
12,759.00	88.02	88.76	6,309.30	472.89	6,253.59	6,261.45	0.88	-0.81	-0.34	
12,851.00	89.16	88.78	6,311.57	474.86	6,345.54	6,353.43	1.24	1.24	0.02	
12,943.00	88.99	88.75	6,313.05	476.85	6,437.51	6,445.41	0.19	-0.18	-0.03	
13,034.00	90.60	88.21	6,313.38	479.26	6,528.47	6,536.41	1.87	1.77	-0.59	
13,126.00	90.57	88.59	6,312.44	481.83	6,620.43	6,628.40	0.41	-0.03	0.41	
13,218.00	90.54	88.49	6,311.55	484.17	6,712.40	6,720.39	0.11	-0.03	-0.11	
13,310.00	90.71	88.43	6,310.54	486.64	6,804.36	6,812.38	0.20	0.18	-0.07	
13,401.00	91.04	88.87	6,309.15	488.79	6,895.32	6,903.37	0.60	0.36	0.48	
13,493.00	88.66	88.62	6,309.39	490.80	6,987.29	6,995.36	2.60	-2.59	-0.27	
13,585.00	89.80	88.93	6,310.63	492.77	7,079.26	7,087.35	1.28	1.24	0.34	

Company:	Bill Barrett Corp.	Local Co-ordinate Reference:	Well Anschutz State 5-62-22-1724B2
Project:	Weld County, CO NAD 83	TVD Reference:	GL 4721' & KB 16' @ 4737.00ft (Cade 24)
Site:	Anschutz State 5-62-22_23 SWNW Pad	MD Reference:	GL 4721' & KB 16' @ 4737.00ft (Cade 24)
Well:	Anschutz State 5-62-22-1724B2	North Reference:	True
Wellbore:	OH	Survey Calculation Method:	Minimum Curvature
Design:	OH	Database:	Casper District

Survey										
Measured Depth (ft)	Inclination (°)	Azimuth (°)	Vertical Depth (ft)	+N/-S (ft)	+E/-W (ft)	Vertical Section (ft)	Dogleg Rate (°/100ft)	Build Rate (°/100ft)	Turn Rate (°/100ft)	
13,676.00	90.20	89.36	6,310.63	494.13	7,170.25	7,178.35	0.65	0.44	0.47	
13,767.00	90.91	89.68	6,309.75	494.89	7,261.24	7,269.34	0.86	0.78	0.35	
13,859.00	89.13	89.69	6,309.72	495.40	7,353.24	7,361.33	1.93	-1.93	0.01	
13,951.00	89.16	89.42	6,311.09	496.11	7,445.22	7,453.31	0.30	0.03	-0.29	
14,043.00	88.39	88.88	6,313.06	497.47	7,537.19	7,545.29	1.02	-0.84	-0.59	
14,135.00	90.13	88.46	6,314.24	499.61	7,629.16	7,637.28	1.95	1.89	-0.46	
14,227.00	89.97	87.81	6,314.16	502.60	7,721.11	7,729.27	0.73	-0.17	-0.71	
14,318.00	89.97	87.38	6,314.21	506.42	7,812.03	7,820.25	0.47	0.00	-0.47	
14,410.00	90.44	87.71	6,313.88	510.36	7,903.94	7,912.22	0.62	0.51	0.36	
14,501.00	91.18	88.16	6,312.60	513.64	7,994.87	8,003.20	0.95	0.81	0.49	
14,592.00	89.83	88.06	6,311.79	516.64	8,085.82	8,094.18	1.49	-1.48	-0.11	
14,684.00	90.47	88.55	6,311.55	519.36	8,177.77	8,186.17	0.88	0.70	0.53	
14,775.00	90.23	87.45	6,311.00	522.54	8,268.72	8,277.16	1.24	-0.26	-1.21	
14,866.00	89.73	86.78	6,311.03	527.12	8,359.60	8,368.11	0.92	-0.55	-0.74	
14,958.00	89.23	87.69	6,311.86	531.56	8,451.49	8,460.07	1.13	-0.54	0.99	
15,049.00	90.30	88.26	6,312.24	534.77	8,542.43	8,551.06	1.33	1.18	0.63	
15,141.00	91.18	89.70	6,311.05	536.41	8,634.40	8,643.04	1.83	0.96	1.57	
15,233.00	89.77	92.01	6,310.29	535.04	8,726.38	8,734.98	2.94	-1.53	2.51	
15,325.00	89.30	91.68	6,311.03	532.08	8,818.33	8,826.86	0.62	-0.51	-0.36	
15,416.00	90.00	90.40	6,311.59	530.42	8,909.31	8,917.79	1.60	0.77	-1.41	
15,508.00	89.63	90.47	6,311.89	529.73	9,001.31	9,009.76	0.41	-0.40	0.08	
15,599.00	90.57	89.65	6,311.73	529.63	9,092.31	9,100.74	1.37	1.03	-0.90	
15,694.00	90.50	89.02	6,310.84	530.73	9,187.29	9,195.73	0.67	-0.07	-0.66	
15,788.00	89.97	88.23	6,310.45	532.99	9,281.27	9,289.73	1.01	-0.56	-0.84	
15,883.00	90.75	88.16	6,309.86	535.98	9,376.22	9,384.72	0.82	0.82	-0.07	
15,979.00	90.24	88.91	6,309.03	538.44	9,472.18	9,480.71	0.94	-0.53	0.78	
16,074.00	91.14	88.72	6,307.88	540.40	9,567.15	9,575.70	0.97	0.95	-0.20	
16,168.00	91.39	87.95	6,305.81	543.13	9,661.09	9,669.67	0.86	0.27	-0.82	
16,263.00	90.80	87.47	6,303.99	546.93	9,755.99	9,764.63	0.80	-0.62	-0.51	
16,347.00	90.70	86.43	6,302.89	551.39	9,839.87	9,848.58	1.24	-0.12	-1.24	
Last SDI MWD Survey										
16,407.00	90.70	86.43	6,302.16	555.13	9,899.75	9,908.52	0.00	0.00	0.00	
Projection to TD										

Company:	Bill Barrett Corp.	Local Co-ordinate Reference:	Well Anschutz State 5-62-22-1724B2
Project:	Weld County, CO NAD 83	TVD Reference:	GL 4721' & KB 16' @ 4737.00ft (Cade 24)
Site:	Anschutz State 5-62-22_23 SWNW Pad	MD Reference:	GL 4721' & KB 16' @ 4737.00ft (Cade 24)
Well:	Anschutz State 5-62-22-1724B2	North Reference:	True
Wellbore:	OH	Survey Calculation Method:	Minimum Curvature
Design:	OH	Database:	Casper District

Design Annotations				
Measured Depth (ft)	Vertical Depth (ft)	Local Coordinates		Comment
		+N/-S (ft)	+E/-W (ft)	
832.00	832.00	0.00	0.00	Casing Assumed Vertical
886.00	886.00	0.01	-0.03	First SDI MWD Survey
6,788.00	6,374.86	366.75	286.37	Last SDI MWD Curve Survey
6,883.00	6,374.58	365.18	381.36	First SDI MWD Lateral Survey
16,347.00	6,302.89	551.39	9,839.87	Last SDI MWD Survey
16,407.00	6,302.16	555.13	9,899.75	Projection to TD

Checked By: _____ Approved By: _____ Date: _____