

WELL DETAILS: Anschutz State 5-62-22-4956B2

PROJECT DETAILS: Weld County, CO NAD 83

Geodetic System: US State Plane 1983
Datum: North American Datum 1983
Ellipsoid: GRS 1980
Zone: Colorado Northern Zone

System Datum: Mean Sea Level
Local North: True

GL 4680' & KB 16' @ 4696.00ft (Cade 25) 4680.00
Northing Easting Latitude Longitude
1383293.75 3329198.39 40° 22' 46.279 N 104° 19' 5.970 W

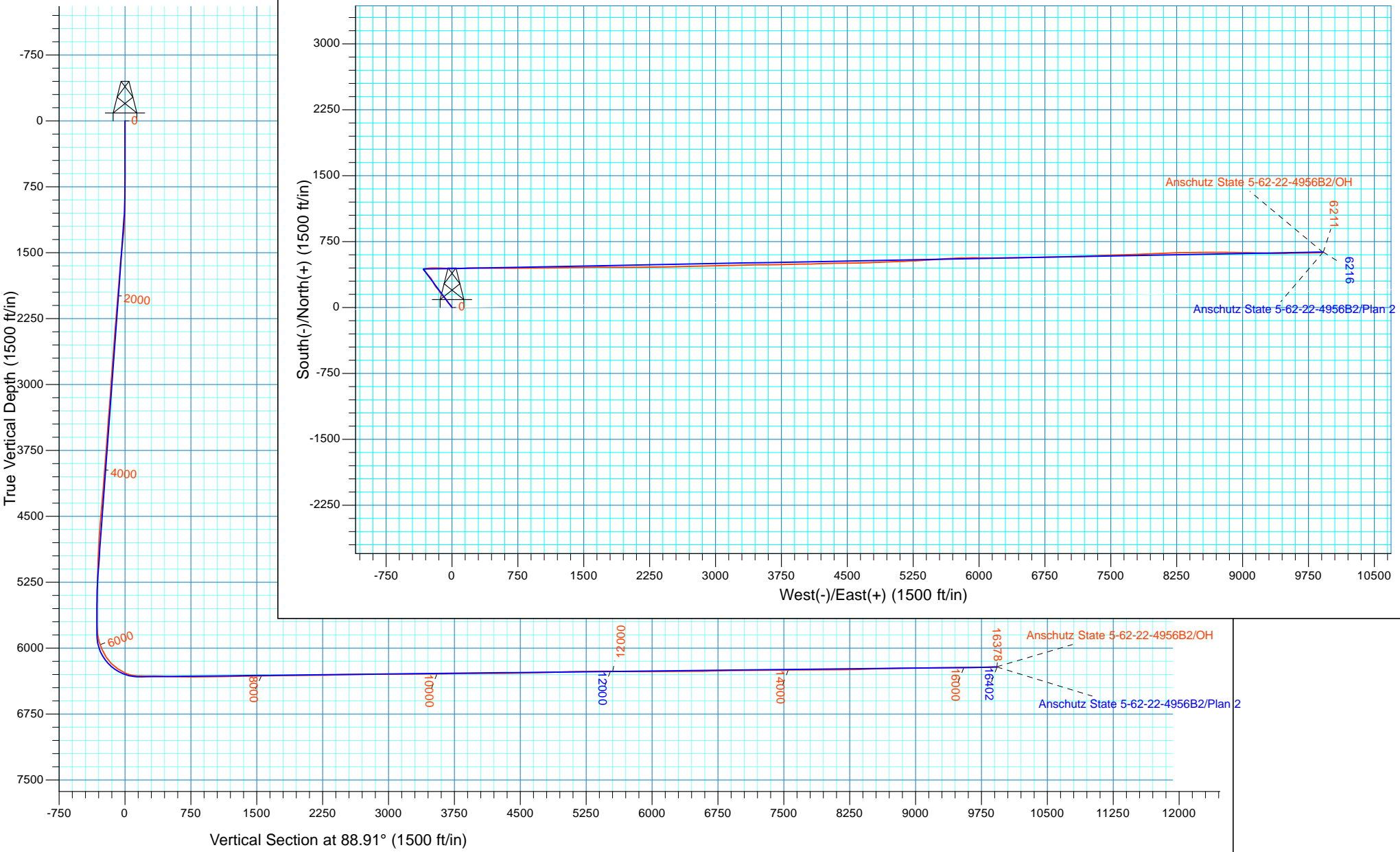



Bill Barrett Corporation

Bill Barrett Corp.

Weld County, CO NAD 83

Anschutz State 5-62-22_23 SWSW Pad

Anschutz State 5-62-22-4956B2

OH

Design: OH

Standard Survey Report

26 August, 2015



Scientific Drilling

www.scientificdrilling.com



Company:	Bill Barrett Corp.	Local Co-ordinate Reference:	Well Anschutz State 5-62-22-4956B2
Project:	Weld County, CO NAD 83	TVD Reference:	GL 4680' & KB 16' @ 4696.00ft (Cade 25)
Site:	Anschutz State 5-62-22_23 SWSW Pad	MD Reference:	GL 4680' & KB 16' @ 4696.00ft (Cade 25)
Well:	Anschutz State 5-62-22-4956B2	North Reference:	True
Wellbore:	OH	Survey Calculation Method:	Minimum Curvature
Design:	OH	Database:	Casper District

Project	Weld County, CO NAD 83		
Map System:	US State Plane 1983	System Datum:	Mean Sea Level
Geo Datum:	North American Datum 1983		
Map Zone:	Colorado Northern Zone		

Site	Anschutz State 5-62-22_23 SWSW Pad		
Site Position:		Northing:	1,383,248.26 usft
From:	Lat/Long	Easting:	3,329,198.17 usft
Position Uncertainty:	0.00 ft	Slot Radius:	13.200 in
		Latitude:	40° 22' 45.829 N
		Longitude:	104° 19' 5.981 W
		Grid Convergence:	0.76 °

Well	Anschutz State 5-62-22-4956B2, 545' FSL 500' FWL Sec 22 T5N R62W		
Well Position	+N/-S	0.00 ft	Northing: 1,383,293.75 usft
	+E/-W	0.00 ft	Easting: 3,329,198.40 usft
Position Uncertainty	0.00 ft	Wellhead Elevation:	0.00 ft
		Latitude:	40° 22' 46.279 N
		Longitude:	104° 19' 5.970 W
		Ground Level:	4,680.00 ft

Wellbore	OH				
Magnetics	Model Name	Sample Date	Declination (°)	Dip Angle (°)	Field Strength (nT)
	BGGM2014	8/5/2015	8.19	66.95	52,599

Design	OH				
Audit Notes:					
Version:	1.0	Phase:	ACTUAL	Tie On Depth:	0.00
Vertical Section:	Depth From (TVD) (ft)	+N/-S (ft)	+E/-W (ft)	Direction (°)	
	0.00	0.00	0.00	88.91	

Survey Program	Date	8/26/2015			
From (ft)	To (ft)	Survey (Wellbore)	Tool Name	Description	
800.00	6,550.00	Survey #1 - Vertical / Curve (OH)	SDI MWD	SDI MWD - Standard ver 1.0.1	
6,637.00	16,378.00	Survey #2 - Lateral (OH)	SDI MWD	SDI MWD - Standard ver 1.0.1	

Survey										
Measured Depth (ft)	Inclination (°)	Azimuth (°)	Vertical Depth (ft)	+N/-S (ft)	+E/-W (ft)	Vertical Section (ft)	Dogleg Rate (°/100ft)	Build Rate (°/100ft)	Turn Rate (°/100ft)	
0.00	0.00	0.00	0.00	0.00	0.00	0.00	0.00	0.00	0.00	
800.00	0.00	0.00	800.00	0.00	0.00	0.00	0.00	0.00	0.00	
889.00	0.54	32.97	889.00	0.35	0.23	0.23	0.61	0.61	0.00	
First SDI MWD Survey										
982.00	2.35	337.70	981.97	2.48	-0.26	-0.21	2.25	1.95	-59.43	
1,074.00	4.22	329.43	1,073.81	7.14	-2.69	-2.56	2.09	2.03	-8.99	
1,167.00	5.95	329.11	1,166.44	14.23	-6.91	-6.64	1.86	1.86	-0.34	
1,260.00	7.84	320.41	1,258.77	23.25	-13.43	-12.98	2.32	2.03	-9.35	
1,352.00	8.76	313.87	1,349.81	32.94	-22.48	-21.85	1.43	1.00	-7.11	
1,445.00	9.69	314.38	1,441.60	43.33	-33.18	-32.35	1.00	1.00	0.55	

Company:	Bill Barrett Corp.	Local Co-ordinate Reference:	Well Anschutz State 5-62-22-4956B2
Project:	Weld County, CO NAD 83	TVD Reference:	GL 4680' & KB 16' @ 4696.00ft (Cade 25)
Site:	Anschutz State 5-62-22_23 SWSW Pad	MD Reference:	GL 4680' & KB 16' @ 4696.00ft (Cade 25)
Well:	Anschutz State 5-62-22-4956B2	North Reference:	True
Wellbore:	OH	Survey Calculation Method:	Minimum Curvature
Design:	OH	Database:	Casper District

Survey										
Measured Depth (ft)	Inclination (°)	Azimuth (°)	Vertical Depth (ft)	+N/-S (ft)	+E/-W (ft)	Vertical Section (ft)	Dogleg Rate (°/100ft)	Build Rate (°/100ft)	Turn Rate (°/100ft)	
1,537.00	9.86	320.15	1,532.27	54.79	-43.76	-42.71	1.08	0.18	6.27	
1,629.00	8.71	326.90	1,623.07	66.67	-52.61	-51.33	1.72	-1.25	7.34	
1,722.00	8.75	332.36	1,714.99	78.84	-59.74	-58.23	0.89	0.04	5.87	
1,814.00	7.62	323.47	1,806.05	89.94	-66.61	-64.89	1.84	-1.23	-9.66	
1,907.00	7.00	319.95	1,898.30	99.23	-73.93	-72.03	0.82	-0.67	-3.78	
1,999.00	6.83	316.59	1,989.63	107.50	-81.30	-79.24	0.48	-0.18	-3.65	
2,091.00	6.98	313.82	2,080.96	115.34	-89.09	-86.88	0.40	0.16	-3.01	
2,182.00	6.72	311.55	2,171.31	122.70	-97.07	-94.71	0.41	-0.29	-2.49	
2,274.00	6.90	314.40	2,262.66	130.14	-105.04	-102.55	0.42	0.20	3.10	
2,366.00	7.19	316.21	2,353.97	138.16	-112.97	-110.33	0.40	0.32	1.97	
2,458.00	7.31	329.02	2,445.24	147.34	-119.97	-117.15	1.76	0.13	13.92	
2,551.00	7.51	329.82	2,537.46	157.66	-126.07	-123.05	0.24	0.22	0.86	
2,643.00	7.55	328.28	2,628.67	168.00	-132.27	-129.05	0.22	0.04	-1.67	
2,736.00	7.80	323.92	2,720.84	178.30	-139.20	-135.78	0.68	0.27	-4.69	
2,829.00	8.02	324.74	2,812.95	188.70	-146.66	-143.05	0.27	0.24	0.88	
2,925.00	7.59	322.92	2,908.06	199.22	-154.35	-150.53	0.52	-0.45	-1.90	
3,020.00	7.23	321.97	3,002.27	208.94	-161.82	-157.81	0.40	-0.38	-1.00	
3,115.00	7.32	322.63	3,096.51	218.46	-169.17	-164.99	0.13	0.09	0.69	
3,210.00	6.45	314.77	3,190.82	227.02	-176.64	-172.29	1.35	-0.92	-8.27	
3,305.00	7.33	323.46	3,285.14	235.65	-184.03	-179.52	1.43	0.93	9.15	
3,400.00	7.92	329.41	3,379.30	246.15	-190.97	-186.25	1.04	0.62	6.26	
3,495.00	8.43	331.26	3,473.33	257.89	-197.65	-192.71	0.60	0.54	1.95	
3,590.00	9.08	331.01	3,567.23	270.56	-204.63	-199.45	0.69	0.68	-0.26	
3,684.00	9.99	332.71	3,659.93	284.29	-211.97	-206.52	1.01	0.97	1.81	
3,780.00	8.93	331.64	3,754.62	298.25	-219.32	-213.61	1.12	-1.10	-1.11	
3,875.00	8.42	330.92	3,848.53	310.82	-226.21	-220.25	0.55	-0.54	-0.76	
3,970.00	7.87	324.09	3,942.58	322.16	-233.40	-227.23	1.17	-0.58	-7.19	
4,066.00	7.62	323.95	4,037.70	332.63	-241.00	-234.63	0.26	-0.26	-0.15	
4,161.00	7.05	318.84	4,131.92	342.11	-248.55	-241.99	0.91	-0.60	-5.38	
4,256.00	7.86	320.84	4,226.12	351.54	-256.48	-249.75	0.90	0.85	2.11	
4,352.00	8.37	320.18	4,321.16	362.00	-265.10	-258.17	0.54	0.53	-0.69	
4,447.00	8.08	321.43	4,415.18	372.53	-273.69	-266.56	0.36	-0.31	1.32	
4,543.00	7.84	318.11	4,510.26	382.68	-282.27	-274.94	0.54	-0.25	-3.46	
4,637.00	6.70	320.97	4,603.50	391.71	-290.01	-282.50	1.27	-1.21	3.04	
4,732.00	5.42	319.34	4,697.97	399.42	-296.42	-288.77	1.36	-1.35	-1.72	
4,827.00	5.19	322.46	4,792.56	406.23	-301.96	-294.18	0.39	-0.24	3.28	
4,923.00	4.85	322.00	4,888.19	412.87	-307.11	-299.20	0.36	-0.35	-0.48	
5,018.00	4.24	317.95	4,982.89	418.64	-311.93	-303.91	0.73	-0.64	-4.26	
5,114.00	3.92	313.60	5,078.65	423.54	-316.68	-308.57	0.46	-0.33	-4.53	
5,210.00	3.03	324.46	5,174.47	427.87	-320.54	-312.34	1.15	-0.93	11.31	
5,306.00	2.41	354.81	5,270.37	431.94	-322.19	-313.92	1.61	-0.65	31.61	
5,401.00	1.15	351.64	5,365.32	434.87	-322.51	-314.18	1.33	-1.33	-3.34	
5,497.00	0.29	235.72	5,461.31	435.69	-322.85	-314.51	1.36	-0.90	-120.75	

Company:	Bill Barrett Corp.	Local Co-ordinate Reference:	Well Anschutz State 5-62-22-4956B2
Project:	Weld County, CO NAD 83	TVD Reference:	GL 4680' & KB 16' @ 4696.00ft (Cade 25)
Site:	Anschutz State 5-62-22_23 SWSW Pad	MD Reference:	GL 4680' & KB 16' @ 4696.00ft (Cade 25)
Well:	Anschutz State 5-62-22-4956B2	North Reference:	True
Wellbore:	OH	Survey Calculation Method:	Minimum Curvature
Design:	OH	Database:	Casper District

Survey										
Measured Depth (ft)	Inclination (°)	Azimuth (°)	Vertical Depth (ft)	+N/-S (ft)	+E/-W (ft)	Vertical Section (ft)	Dogleg Rate (°/100ft)	Build Rate (°/100ft)	Turn Rate (°/100ft)	
5,592.00	0.41	317.97	5,556.31	435.81	-323.28	-314.93	0.49	0.13	86.58	
5,686.00	0.30	281.36	5,650.31	436.11	-323.75	-315.39	0.26	-0.12	-38.95	
5,781.00	0.12	29.51	5,745.31	436.24	-323.94	-315.58	0.37	-0.19	113.84	
5,875.00	5.49	72.54	5,839.17	437.68	-319.60	-311.22	5.75	5.71	45.78	
5,967.00	17.78	78.22	5,929.10	441.88	-301.58	-293.12	13.40	13.36	6.17	
6,062.00	25.77	84.85	6,017.27	446.71	-266.75	-258.21	8.79	8.41	6.98	
6,157.00	29.82	86.35	6,101.29	450.06	-222.59	-213.99	4.33	4.26	1.58	
6,251.00	47.14	93.40	6,174.63	449.50	-164.41	-155.83	18.98	18.43	7.50	
6,347.00	54.50	93.47	6,235.24	445.05	-90.18	-81.69	7.67	7.67	0.07	
6,442.00	65.98	90.62	6,282.32	442.23	-7.90	0.51	12.36	12.08	-3.00	
6,539.00	80.42	87.29	6,310.29	444.02	84.68	93.11	15.24	14.89	-3.43	
6,550.00	83.48	86.93	6,311.83	444.57	95.55	103.99	28.01	27.82	-3.27	
Last SDI MWD Curve Survey										
6,637.00	91.25	87.32	6,315.83	448.92	182.29	190.79	8.94	8.93	0.45	
First SDI MWD Lateral Survey										
6,731.00	88.28	90.67	6,316.21	450.57	276.25	284.77	4.76	-3.16	3.56	
6,827.00	88.25	90.47	6,319.12	449.62	372.20	380.68	0.21	-0.03	-0.21	
6,921.00	88.22	90.36	6,322.01	448.94	466.15	474.61	0.12	-0.03	-0.12	
7,016.00	88.92	90.58	6,324.39	448.16	561.12	569.54	0.77	0.74	0.23	
7,112.00	88.45	91.07	6,326.59	446.77	657.08	665.46	0.71	-0.49	0.51	
7,207.00	90.40	89.69	6,327.54	446.14	752.07	760.42	2.51	2.05	-1.45	
7,302.00	90.40	90.35	6,326.88	446.11	847.07	855.40	0.69	0.00	0.69	
7,396.00	90.91	89.42	6,325.80	446.30	941.06	949.38	1.13	0.54	-0.99	
7,491.00	91.28	88.28	6,323.99	448.21	1,036.02	1,044.36	1.26	0.39	-1.20	
7,587.00	91.61	88.25	6,321.57	451.11	1,131.95	1,140.32	0.35	0.34	-0.03	
7,682.00	90.03	89.35	6,320.21	453.10	1,226.91	1,235.31	2.03	-1.66	1.16	
7,778.00	90.54	89.11	6,319.73	454.39	1,322.90	1,331.30	0.59	0.53	-0.25	
7,873.00	90.94	89.56	6,318.50	455.49	1,417.89	1,426.29	0.63	0.42	0.47	
7,967.00	91.11	89.40	6,316.82	456.35	1,511.87	1,520.27	0.25	0.18	-0.17	
8,064.00	91.68	88.54	6,314.46	458.09	1,608.82	1,617.24	1.06	0.59	-0.89	
8,159.00	90.37	90.57	6,312.76	458.83	1,703.80	1,712.22	2.54	-1.38	2.14	
8,255.00	90.87	90.12	6,311.72	458.25	1,799.79	1,808.18	0.70	0.52	-0.47	
8,349.00	91.07	89.40	6,310.13	458.64	1,893.77	1,902.15	0.79	0.21	-0.77	
8,445.00	90.77	90.46	6,308.59	458.76	1,989.76	1,998.13	1.15	-0.31	1.10	
8,541.00	90.13	89.52	6,307.84	458.78	2,085.75	2,094.10	1.18	-0.67	-0.98	
8,635.00	90.64	90.21	6,307.20	459.00	2,179.75	2,188.09	0.91	0.54	0.73	
8,731.00	90.34	89.30	6,306.38	459.41	2,275.75	2,284.07	1.00	-0.31	-0.95	
8,826.00	91.04	88.90	6,305.24	460.90	2,370.73	2,379.06	0.85	0.74	-0.42	
8,921.00	91.41	89.22	6,303.21	462.46	2,465.69	2,474.04	0.51	0.39	0.34	
9,015.00	90.94	88.39	6,301.28	464.42	2,559.65	2,568.02	1.01	-0.50	-0.88	
9,110.00	91.58	88.90	6,299.19	466.66	2,654.60	2,663.00	0.86	0.67	0.54	
9,206.00	90.23	88.98	6,297.67	468.44	2,750.57	2,758.98	1.41	-1.41	0.08	
9,300.00	90.71	88.72	6,296.90	470.33	2,844.55	2,852.98	0.58	0.51	-0.28	
9,395.00	90.71	88.28	6,295.73	472.81	2,939.51	2,947.97	0.46	0.00	-0.46	

Company:	Bill Barrett Corp.	Local Co-ordinate Reference:	Well Anschutz State 5-62-22-4956B2
Project:	Weld County, CO NAD 83	TVD Reference:	GL 4680' & KB 16' @ 4696.00ft (Cade 25)
Site:	Anschutz State 5-62-22_23 SWSW Pad	MD Reference:	GL 4680' & KB 16' @ 4696.00ft (Cade 25)
Well:	Anschutz State 5-62-22-4956B2	North Reference:	True
Wellbore:	OH	Survey Calculation Method:	Minimum Curvature
Design:	OH	Database:	Casper District

Survey									
Measured Depth (ft)	Inclination (°)	Azimuth (°)	Vertical Depth (ft)	+N/-S (ft)	+E/-W (ft)	Vertical Section (ft)	Dogleg Rate (°/100ft)	Build Rate (°/100ft)	Turn Rate (°/100ft)
9,492.00	90.40	88.00	6,294.79	475.96	3,036.45	3,044.96	0.43	-0.32	-0.29
9,587.00	89.97	88.82	6,294.48	478.60	3,131.41	3,139.95	0.97	-0.45	0.86
9,682.00	89.70	88.55	6,294.75	480.78	3,226.39	3,234.95	0.40	-0.28	-0.28
9,778.00	89.33	89.35	6,295.57	482.54	3,322.37	3,330.94	0.92	-0.39	0.83
9,873.00	91.37	88.46	6,294.99	484.35	3,417.34	3,425.94	2.34	2.15	-0.94
9,968.00	91.11	89.68	6,292.93	485.89	3,512.30	3,520.91	1.31	-0.27	1.28
10,064.00	90.87	89.93	6,291.27	486.22	3,608.29	3,616.89	0.36	-0.25	0.26
10,159.00	90.91	88.03	6,289.80	487.91	3,703.26	3,711.87	2.00	0.04	-2.00
10,255.00	90.37	88.90	6,288.72	490.48	3,799.22	3,807.86	1.07	-0.56	0.91
10,349.00	90.67	88.81	6,287.87	492.36	3,893.19	3,901.86	0.33	0.32	-0.10
10,444.00	90.20	89.42	6,287.15	493.83	3,988.18	3,996.85	0.81	-0.49	0.64
10,536.00	90.30	88.26	6,286.75	495.69	4,080.16	4,088.85	1.27	0.11	-1.26
10,628.00	90.07	88.56	6,286.45	498.24	4,172.12	4,180.85	0.41	-0.25	0.33
10,721.00	90.60	87.86	6,285.91	501.15	4,265.07	4,273.84	0.94	0.57	-0.75
10,814.00	90.50	89.48	6,285.01	503.31	4,358.04	4,366.83	1.75	-0.11	1.74
10,906.00	91.28	89.37	6,283.59	504.23	4,450.03	4,458.81	0.86	0.85	-0.12
10,998.00	91.75	89.54	6,281.15	505.10	4,541.99	4,550.78	0.54	0.51	0.18
11,091.00	90.40	88.59	6,279.41	506.62	4,634.96	4,643.76	1.77	-1.45	-1.02
11,185.00	91.18	88.41	6,278.11	509.08	4,728.92	4,737.74	0.85	0.83	-0.19
11,278.00	91.78	87.64	6,275.71	512.29	4,821.83	4,830.70	1.05	0.65	-0.83
11,370.00	91.65	86.57	6,272.96	516.93	4,913.67	4,922.61	1.17	-0.14	-1.16
11,463.00	91.34	88.37	6,270.53	521.03	5,006.54	5,015.55	1.96	-0.33	1.94
11,556.00	91.48	88.21	6,268.24	523.81	5,099.47	5,108.51	0.23	0.15	-0.17
11,648.00	91.51	87.17	6,265.84	527.52	5,191.36	5,200.46	1.13	0.03	-1.13
11,741.00	91.04	88.05	6,263.77	531.39	5,284.26	5,293.41	1.07	-0.51	0.95
11,833.00	90.50	85.71	6,262.54	536.40	5,376.11	5,385.34	2.61	-0.59	-2.54
11,925.00	89.23	84.36	6,262.75	544.36	5,467.76	5,477.12	2.01	-1.38	-1.47
12,018.00	88.99	85.99	6,264.20	552.18	5,560.41	5,569.91	1.77	-0.26	1.75
12,110.00	90.07	88.72	6,264.95	556.43	5,652.30	5,661.87	3.19	1.17	2.97
12,203.00	88.32	86.70	6,266.26	560.14	5,745.21	5,754.83	2.87	-1.88	-2.17
12,295.00	89.19	88.43	6,268.26	564.05	5,837.10	5,846.78	2.10	0.95	1.88
12,387.00	90.67	90.60	6,268.37	564.83	5,929.09	5,938.76	2.86	1.61	2.36
12,478.00	91.35	90.55	6,266.77	563.92	6,020.07	6,029.71	0.75	0.75	-0.05
12,570.00	90.24	90.44	6,265.49	563.12	6,112.06	6,121.66	1.21	-1.21	-0.12
12,662.00	90.54	89.87	6,264.86	562.87	6,204.06	6,213.64	0.70	0.33	-0.62
12,754.00	90.67	89.20	6,263.89	563.62	6,296.05	6,305.63	0.74	0.14	-0.73
12,847.00	90.64	89.20	6,262.83	564.92	6,389.03	6,398.62	0.03	-0.03	0.00
12,939.00	90.17	88.38	6,262.18	566.86	6,481.01	6,490.62	1.03	-0.51	-0.89
13,032.00	90.70	89.39	6,261.47	568.67	6,573.99	6,583.61	1.23	0.57	1.09
13,125.00	91.47	89.02	6,259.71	569.96	6,666.96	6,676.60	0.92	0.83	-0.40
13,219.00	92.05	88.13	6,256.82	572.30	6,760.88	6,770.55	1.13	0.62	-0.95
13,312.00	90.17	88.58	6,255.02	574.96	6,853.82	6,863.52	2.08	-2.02	0.48
13,404.00	90.37	89.50	6,254.59	576.51	6,945.81	6,955.52	1.02	0.22	1.00

Company:	Bill Barrett Corp.	Local Co-ordinate Reference:	Well Anschutz State 5-62-22-4956B2
Project:	Weld County, CO NAD 83	TVD Reference:	GL 4680' & KB 16' @ 4696.00ft (Cade 25)
Site:	Anschutz State 5-62-22_23 SWSW Pad	MD Reference:	GL 4680' & KB 16' @ 4696.00ft (Cade 25)
Well:	Anschutz State 5-62-22-4956B2	North Reference:	True
Wellbore:	OH	Survey Calculation Method:	Minimum Curvature
Design:	OH	Database:	Casper District

Survey									
Measured Depth (ft)	Inclination (°)	Azimuth (°)	Vertical Depth (ft)	+N/-S (ft)	+E/-W (ft)	Vertical Section (ft)	Dogleg Rate (°/100ft)	Build Rate (°/100ft)	Turn Rate (°/100ft)
13,496.00	90.57	87.46	6,253.83	578.95	7,037.77	7,047.51	2.23	0.22	-2.22
13,589.00	91.34	89.52	6,252.28	581.40	7,130.72	7,140.49	2.36	0.83	2.22
13,682.00	90.54	87.54	6,250.76	583.78	7,223.67	7,233.47	2.30	-0.86	-2.13
13,774.00	90.30	86.89	6,250.08	588.25	7,315.56	7,325.42	0.75	-0.26	-0.71
13,867.00	89.80	88.82	6,250.00	591.73	7,408.49	7,418.40	2.14	-0.54	2.08
13,959.00	90.77	86.97	6,249.54	595.11	7,500.42	7,510.38	2.27	1.05	-2.01
14,052.00	91.01	89.06	6,248.10	598.33	7,593.35	7,603.36	2.26	0.26	2.25
14,145.00	89.76	88.94	6,247.48	599.96	7,686.33	7,696.35	1.35	-1.34	-0.13
14,238.00	90.20	88.05	6,247.51	602.40	7,779.30	7,789.35	1.07	0.47	-0.96
14,329.00	90.30	86.09	6,247.11	607.05	7,870.17	7,880.30	2.16	0.11	-2.15
14,422.00	90.91	88.69	6,246.13	611.28	7,963.06	7,973.25	2.87	0.66	2.80
14,515.00	89.60	87.62	6,245.71	614.28	8,056.01	8,066.24	1.82	-1.41	-1.15
14,608.00	90.60	87.48	6,245.55	618.25	8,148.92	8,159.21	1.09	1.08	-0.15
14,700.00	90.81	87.83	6,244.42	622.02	8,240.84	8,251.18	0.44	0.23	0.38
14,792.00	91.51	88.83	6,242.56	624.70	8,332.78	8,343.15	1.33	0.76	1.09
14,885.00	91.72	89.81	6,239.94	625.80	8,425.73	8,436.11	1.08	0.23	1.05
14,978.00	92.22	90.32	6,236.74	625.70	8,518.68	8,529.04	0.77	0.54	0.55
15,070.00	92.73	88.72	6,232.77	626.47	8,610.59	8,620.95	1.82	0.55	-1.74
15,163.00	91.31	89.76	6,229.49	627.70	8,703.52	8,713.88	1.89	-1.53	1.12
15,254.00	90.30	90.76	6,228.21	627.28	8,794.50	8,804.85	1.56	-1.11	1.10
15,347.00	90.40	91.30	6,227.64	625.61	8,887.49	8,897.78	0.59	0.11	0.58
15,439.00	90.64	90.65	6,226.81	624.05	8,979.47	8,989.72	0.75	0.26	-0.71
15,534.00	90.81	91.28	6,225.60	622.45	9,074.45	9,084.65	0.69	0.18	0.66
15,627.00	90.20	90.93	6,224.79	620.65	9,167.43	9,177.57	0.76	-0.66	-0.38
15,720.00	91.62	92.62	6,223.31	617.77	9,260.36	9,270.44	2.37	1.53	1.82
15,852.00	89.39	89.49	6,222.14	615.35	9,392.31	9,402.32	2.91	-1.69	-2.37
15,904.00	89.39	89.70	6,222.70	615.71	9,444.31	9,454.31	0.40	0.00	0.40
16,000.00	90.13	88.34	6,223.10	617.35	9,540.29	9,550.31	1.61	0.77	-1.42
16,096.00	91.61	88.82	6,221.64	619.73	9,636.25	9,646.29	1.62	1.54	0.50
16,190.00	91.95	89.35	6,218.72	621.23	9,730.19	9,740.25	0.67	0.36	0.56
16,287.00	92.15	88.48	6,215.25	623.07	9,827.11	9,837.18	0.92	0.21	-0.90
16,318.00	92.41	88.69	6,214.02	623.83	9,858.07	9,868.16	1.08	0.84	0.68
Last SDI MWD Survey									
16,378.00	92.41	88.69	6,211.50	625.20	9,918.01	9,928.10	0.00	0.00	0.00
Projection to TD									

Casing Points				
Measured Depth (ft)	Vertical Depth (ft)	Name	Casing Diameter (in)	Hole Diameter (in)
16,378.00	6,211.50	Case15	7.000	7.000

Company:	Bill Barrett Corp.	Local Co-ordinate Reference:	Well Anschutz State 5-62-22-4956B2
Project:	Weld County, CO NAD 83	TVD Reference:	GL 4680' & KB 16' @ 4696.00ft (Cade 25)
Site:	Anschutz State 5-62-22_23 SWSW Pad	MD Reference:	GL 4680' & KB 16' @ 4696.00ft (Cade 25)
Well:	Anschutz State 5-62-22-4956B2	North Reference:	True
Wellbore:	OH	Survey Calculation Method:	Minimum Curvature
Design:	OH	Database:	Casper District

Design Annotations				
Measured Depth (ft)	Vertical Depth (ft)	Local Coordinates		Comment
		+N/-S (ft)	+E/-W (ft)	
889.00	889.00	0.35	0.23	First SDI MWD Survey
6,550.00	6,311.83	444.57	95.55	Last SDI MWD Curve Survey
6,637.00	6,315.83	448.92	182.29	First SDI MWD Lateral Survey
16,318.00	6,214.02	623.83	9,858.07	Last SDI MWD Survey
16,378.00	6,211.50	625.20	9,918.01	Projection to TD

Checked By: _____	Approved By: _____	Date: _____
-------------------	--------------------	-------------