

KERR-MCGEE OIL & GAS ONSHORE LP (WA)

Location: COLORADO Slot: SLOT#07 CARTER 14C-33HZ (825'FNL & 1500'FWL, SEC.33)
Field: WELD COUNTY (UTM/TRUE NORTH) Well: CARTER 14C-33HZ
Facility: SEC.33-T2N-R66W Wellbore: CARTER 14C-33HZ PWB

Plot reference wellpath is CARTER 14C-33HZ (REV-B.0) PWP

True vertical depths are referenced to XTREME 23 (16'KB) (RKB)

Measured depths are referenced to XTREME 23 (16'KB) (RKB)

XTREME 23 (16'KB) (RKB) to Mean Sea Level: 4975 feet

Mean Sea Level to Mud line (At Slot: SLOT#07 CARTER 14C-33HZ (825'FNL & 1500'FWL, SEC.33)): 0 feet

Coordinates are in feet referenced to Slot

Grid System: NAD83 / UTM Zone 13 North, US feet

North Reference: True north

Scale: True distance

Depths are in feet

Created by: amarcar on 25/Sep/2015

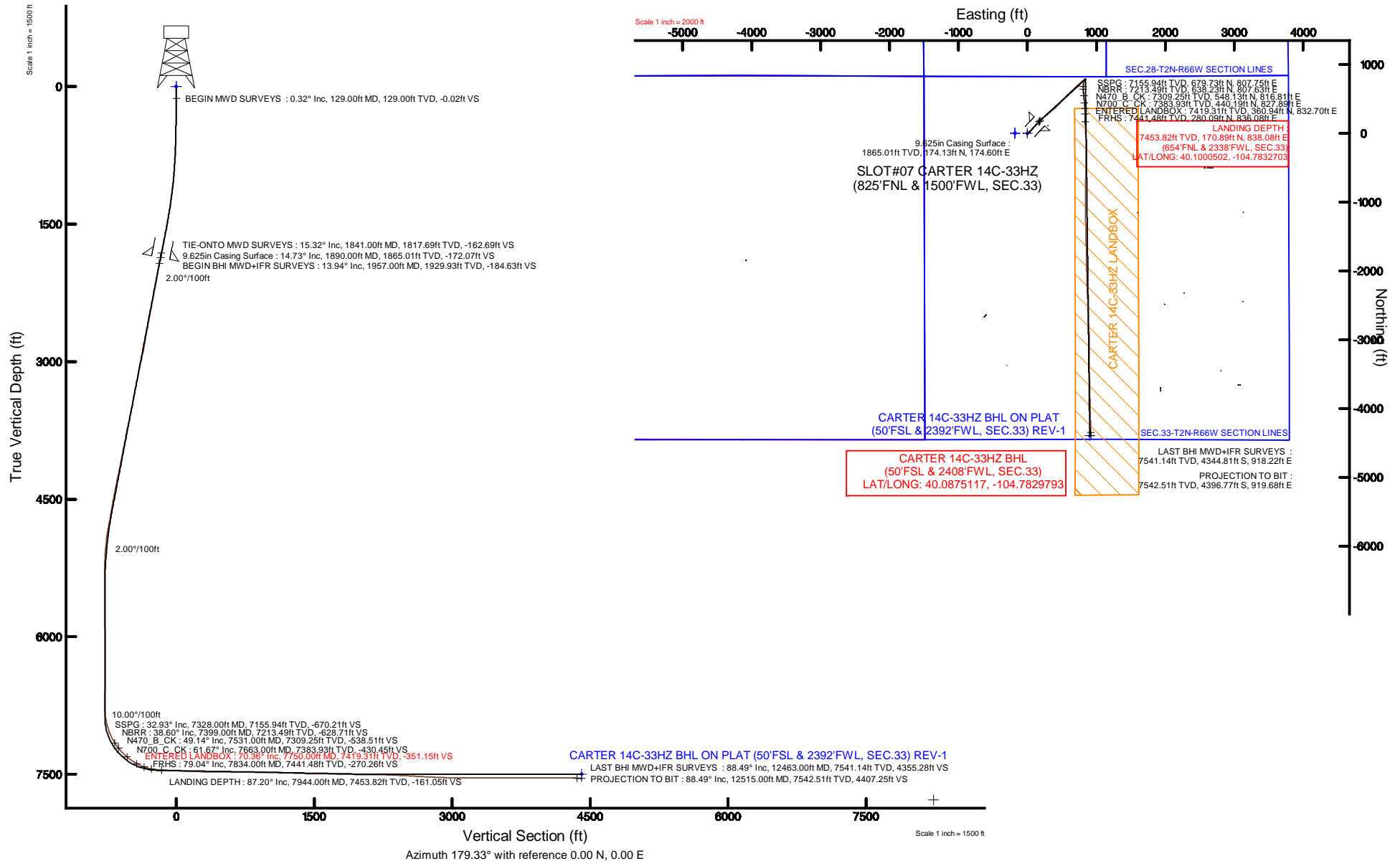



Actual Wellpath Report

CARTER 14C-33HZ AWP

Page 1 of 6



REFERENCE WELLPATH IDENTIFICATION

Operator	KERR-MCGEE OIL & GAS ONSHORE LP (WA)	Slot	SLOT#07 CARTER 14C-33HZ (825'FNL & 1500'FWL, SEC.33)
Area	COLORADO	Well	CARTER 14C-33HZ
Field	WELD COUNTY (UTM/TRUE NORTH)	Wellbore	CARTER 14C-33HZ AWB <12515>
Facility	SEC.33-T2N-R66W		

REPORT SETUP INFORMATION

Projection System	NAD83 / UTM Zone 13 North, US feet	Software System	WellArchitect® 4.0.0
North Reference	True	User	Amarcar
Scale	0.999604	Report Generated	25/Sep/2015 at 13:02
Convergence at slot	0.14° East	Database/Source file	KERR MCGEE UTM/CARTER_14C-33HZ_AWB__12515_.xml

WELLPATH LOCATION

	Local coordinates		Grid coordinates		Geographic coordinates	
	North[ft]	East[ft]	Easting[US ft]	Northing[US ft]	Latitude	Longitude
Slot Location	-373.69	835.31	1700186.03	14563067.10	40°05'58.492"N	104°47'10.558"W
Facility Reference Pt			1699350.17	14563438.66	40°06'02.185"N	104°47'21.307"W
Field Reference Pt			1698235.31	14552047.82	40°04'09.600"N	104°47'36.000"W

WELLPATH DATUM

Calculation method	Minimum curvature	XTREME 23 (16'KB) (RKB) to Facility Vertical Datum	4975.00ft
Horizontal Reference Pt	Slot	XTREME 23 (16'KB) (RKB) to Mean Sea Level	4975.00ft
Vertical Reference Pt	XTREME 23 (16'KB) (RKB)	XTREME 23 (16'KB) (RKB) to Mud Line at Slot (SLOT#07 CARTER 14C-33HZ (825'FNL & 1500'FWL, SEC.33))	4975.00ft
MD Reference Pt	XTREME 23 (16'KB) (RKB)	Section Origin	N 0.00, E 0.00 ft
Field Vertical Reference	Mean Sea Level	Section Azimuth	179.33°

REFERENCE WELLPATH IDENTIFICATION

Operator	KERR-MCGEE OIL & GAS ONSHORE LP (WA)	Slot	SLOT#07 CARTER 14C-33HZ (825'FNL & 1500'FWL, SEC.33)
Area	COLORADO	Well	CARTER 14C-33HZ
Field	WELD COUNTY (UTM/TRUE NORTH)	Wellbore	CARTER 14C-33HZ AWB <12515>
Facility	SEC.33-T2N-R66W		

WELLPATH DATA (137 stations) † = interpolated/extrapolated station

MD [ft]	Inclination [°]	Azimuth [°]	TVD [ft]	Vert Sect [ft]	North [ft]	East [ft]	Latitude	Longitude	DLS [°/100ft]	Comments
0.00†	0.000	272.330	0.00	0.00	0.00	0.00	40°05'58.492"N	104°47'10.558"W	0.00	
16.00	0.000	272.330	16.00	0.00	0.00	0.00	40°05'58.492"N	104°47'10.558"W	0.00	
129.00	0.320	272.330	129.00	-0.02	0.01	-0.32	40°05'58.492"N	104°47'10.562"W	0.28	BEGIN MWD SURVEYS
219.00	1.090	39.180	218.99	-0.69	0.69	-0.03	40°05'58.499"N	104°47'10.558"W	1.45	
310.00	2.020	45.980	309.96	-2.45	2.47	1.67	40°05'58.516"N	104°47'10.536"W	1.04	
407.00	1.950	66.630	406.90	-4.26	4.31	4.42	40°05'58.535"N	104°47'10.501"W	0.74	
502.00	2.380	65.400	501.84	-5.69	5.78	7.70	40°05'58.549"N	104°47'10.459"W	0.46	
597.00	3.310	57.850	596.72	-7.92	8.06	11.81	40°05'58.572"N	104°47'10.406"W	1.05	
692.00	4.110	51.100	691.52	-11.46	11.65	16.78	40°05'58.607"N	104°47'10.342"W	0.96	
786.00	4.820	53.870	785.23	-15.83	16.10	22.59	40°05'58.651"N	104°47'10.267"W	0.79	
881.00	6.640	51.350	879.75	-21.53	21.88	30.11	40°05'58.708"N	104°47'10.171"W	1.93	
977.00	7.060	46.220	975.07	-28.98	29.43	38.70	40°05'58.783"N	104°47'10.060"W	0.77	
1072.00	8.540	41.880	1069.19	-38.16	38.72	47.63	40°05'58.875"N	104°47'09.945"W	1.68	
1167.00	9.560	40.900	1163.00	-49.26	49.94	57.50	40°05'58.985"N	104°47'09.818"W	1.09	
1262.00	10.870	42.330	1256.50	-61.71	62.52	68.70	40°05'59.110"N	104°47'09.674"W	1.40	
1356.00	11.580	40.230	1348.70	-75.33	76.28	80.76	40°05'59.246"N	104°47'09.519"W	0.87	
1483.00	13.410	42.520	1472.69	-95.70	96.87	98.95	40°05'59.449"N	104°47'09.285"W	1.49	
1578.00	15.200	44.960	1564.74	-112.44	113.80	115.20	40°05'59.617"N	104°47'09.076"W	1.99	
1673.00	16.160	45.630	1656.20	-130.28	131.86	133.45	40°05'59.795"N	104°47'08.841"W	1.03	
1769.00	16.210	45.520	1748.40	-148.79	150.59	152.56	40°05'59.980"N	104°47'08.595"W	0.06	
1841.00	15.320	42.400	1817.69	-162.69	164.65	166.14	40°06'00.119"N	104°47'08.420"W	1.71	TIE-ONTO MWD SURVEYS
1957.00	13.940	39.120	1929.93	-184.63	186.81	185.29	40°06'00.338"N	104°47'08.174"W	1.39	BEGIN BHI MWD+IFR SURVEYS
2053.00	15.060	43.750	2022.87	-202.42	204.79	201.21	40°06'00.516"N	104°47'07.969"W	1.68	
2147.00	15.470	51.970	2113.56	-218.75	221.34	219.53	40°06'00.679"N	104°47'07.733"W	2.34	
2242.00	17.550	53.180	2204.64	-234.89	237.73	240.98	40°06'00.841"N	104°47'07.457"W	2.22	
2338.00	17.030	49.850	2296.31	-252.37	255.47	263.32	40°06'01.017"N	104°47'07.170"W	1.16	
2432.00	16.090	50.130	2386.41	-269.35	272.70	283.84	40°06'01.187"N	104°47'06.905"W	1.00	
2528.00	17.370	49.530	2478.34	-286.93	290.53	304.95	40°06'01.363"N	104°47'06.634"W	1.35	
2623.00	15.950	49.070	2569.35	-304.44	308.28	325.60	40°06'01.538"N	104°47'06.368"W	1.50	
2718.00	16.970	53.100	2660.46	-321.07	325.16	346.55	40°06'01.705"N	104°47'06.098"W	1.61	
2814.00	15.040	51.860	2752.73	-336.93	341.27	367.55	40°06'01.864"N	104°47'05.828"W	2.04	
2909.00	16.150	49.290	2844.24	-352.93	357.50	387.26	40°06'02.025"N	104°47'05.575"W	1.38	
3004.00	18.370	45.220	2934.96	-371.85	376.66	407.90	40°06'02.214"N	104°47'05.309"W	2.66	
3099.00	16.930	44.500	3025.48	-392.02	397.07	428.23	40°06'02.416"N	104°47'05.047"W	1.53	
3195.00	15.370	43.620	3117.69	-410.98	416.25	446.80	40°06'02.605"N	104°47'04.808"W	1.64	
3290.00	16.900	45.520	3208.95	-429.56	435.04	465.34	40°06'02.791"N	104°47'04.570"W	1.70	
3385.00	14.440	43.310	3300.41	-447.64	453.34	483.32	40°06'02.972"N	104°47'04.338"W	2.66	
3481.00	15.120	45.390	3393.23	-464.94	470.84	500.44	40°06'03.145"N	104°47'04.118"W	0.90	
3576.00	16.080	46.090	3484.73	-482.55	488.67	518.74	40°06'03.321"N	104°47'03.882"W	1.03	
3671.00	15.060	43.010	3576.25	-500.49	506.82	536.64	40°06'03.500"N	104°47'03.652"W	1.38	
3766.00	16.390	40.340	3667.69	-519.53	526.06	553.74	40°06'03.691"N	104°47'03.432"W	1.59	
3861.00	15.870	43.550	3758.95	-538.95	545.69	571.36	40°06'03.885"N	104°47'03.205"W	1.09	
3957.00	15.830	48.950	3851.31	-556.84	563.81	590.28	40°06'04.064"N	104°47'02.962"W	1.54	
4052.00	17.250	45.750	3942.38	-574.95	582.15	610.15	40°06'04.245"N	104°47'02.706"W	1.78	
4147.00	14.020	41.800	4033.85	-593.15	600.56	627.91	40°06'04.427"N	104°47'02.478"W	3.58	

REFERENCE WELLPATH IDENTIFICATION

Operator	KERR-MCGEE OIL & GAS ONSHORE LP (WA)	Slot	SLOT#07 CARTER 14C-33HZ (825'FNL & 1500'FWL, SEC.33)
Area	COLORADO	Well	CARTER 14C-33HZ
Field	WELD COUNTY (UTM/TRUE NORTH)	Wellbore	CARTER 14C-33HZ AWB <12515>
Facility	SEC.33-T2N-R66W		

WELLPATH DATA (137 stations) † = interpolated/extrapolated station

MD [ft]	Inclination [°]	Azimuth [°]	TVD [ft]	Vert Sect [ft]	North [ft]	East [ft]	Latitude	Longitude	DLS [°/100ft]	Comments
4242.00	15.750	47.480	4125.67	-610.24	617.85	645.09	40°06'04.598"N	104°47'02.257"W	2.38	
4337.00	17.580	47.460	4216.67	-628.42	636.27	665.16	40°06'04.780"N	104°47'01.998"W	1.93	
4527.00	15.040	41.290	4399.02	-665.91	674.20	702.58	40°06'05.154"N	104°47'01.517"W	1.62	
4623.00	15.570	49.020	4491.63	-683.51	692.01	720.53	40°06'05.330"N	104°47'01.286"W	2.19	
4718.00	16.120	50.760	4583.02	-699.98	708.71	740.37	40°06'05.496"N	104°47'01.030"W	0.76	
4813.00	15.860	52.400	4674.34	-716.00	724.98	760.87	40°06'05.656"N	104°47'00.767"W	0.55	
4909.00	16.310	47.170	4766.59	-732.93	742.15	781.15	40°06'05.826"N	104°47'00.506"W	1.58	
5004.00	13.260	48.070	4858.43	-749.08	758.50	799.04	40°06'05.987"N	104°47'00.275"W	3.22	
5099.00	9.750	50.760	4951.51	-761.28	770.87	813.38	40°06'06.110"N	104°47'00.091"W	3.74	
5194.00	7.600	45.520	5045.42	-770.64	780.36	824.09	40°06'06.204"N	104°46'59.953"W	2.41	
5289.00	5.520	62.540	5139.80	-777.05	786.87	832.63	40°06'06.268"N	104°46'59.843"W	2.97	
5385.00	3.580	69.950	5235.50	-780.13	790.03	839.54	40°06'06.299"N	104°46'59.754"W	2.11	
5480.00	0.900	95.300	5330.42	-781.04	790.98	843.07	40°06'06.308"N	104°46'59.709"W	2.94	
5575.00	0.760	60.440	5425.41	-781.26	791.22	844.37	40°06'06.311"N	104°46'59.692"W	0.54	
5671.00	1.230	252.480	5521.40	-781.27	791.22	843.94	40°06'06.311"N	104°46'59.698"W	2.06	
5766.00	0.940	252.940	5616.38	-780.76	790.69	842.22	40°06'06.306"N	104°46'59.720"W	0.31	
5861.00	1.400	245.700	5711.36	-780.07	789.98	840.42	40°06'06.299"N	104°46'59.743"W	0.51	
5957.00	1.320	254.830	5807.34	-779.32	789.21	838.28	40°06'06.291"N	104°46'59.770"W	0.24	
6052.00	1.110	229.020	5902.32	-778.46	788.32	836.53	40°06'06.282"N	104°46'59.793"W	0.61	
6148.00	1.270	167.380	5998.30	-776.81	786.67	836.06	40°06'06.266"N	104°46'59.799"W	1.28	
6243.00	0.860	141.410	6093.28	-775.22	785.09	836.73	40°06'06.250"N	104°46'59.790"W	0.66	
6338.00	0.270	103.790	6188.28	-774.60	784.48	837.40	40°06'06.244"N	104°46'59.782"W	0.70	
6529.00	0.720	347.820	6379.27	-775.67	785.54	837.58	40°06'06.255"N	104°46'59.779"W	0.46	
6624.00	0.660	346.690	6474.27	-776.78	786.66	837.33	40°06'06.266"N	104°46'59.783"W	0.06	
6814.00	0.960	5.690	6664.25	-779.43	789.31	837.23	40°06'06.292"N	104°46'59.784"W	0.21	
6910.00	0.690	327.660	6760.24	-780.73	790.60	837.01	40°06'06.305"N	104°46'59.787"W	0.62	
7005.00	7.080	185.710	6855.01	-775.39	785.25	836.12	40°06'06.252"N	104°46'59.798"W	8.04	
7100.00	15.090	196.910	6948.17	-757.75	767.56	831.93	40°06'06.077"N	104°46'59.852"W	8.69	
7196.00	22.200	203.780	7039.09	-729.29	738.97	820.97	40°06'05.794"N	104°46'59.993"W	7.74	
7291.00	30.080	189.080	7124.39	-689.38	698.93	809.94	40°06'05.399"N	104°47'00.135"W	10.68	
7328.00†	32.932	184.158	7155.94	-670.21	679.73	807.75	40°06'05.209"N	104°47'00.163"W	10.37	SSPG
7386.00	37.720	177.840	7203.26	-636.74	646.25	807.27	40°06'04.878"N	104°47'00.169"W	10.37	
7399.00†	38.600	177.101	7213.49	-628.71	638.23	807.63	40°06'04.799"N	104°47'00.165"W	7.62	NBRR
7481.00	44.240	173.020	7274.96	-574.67	584.23	812.40	40°06'04.265"N	104°47'00.103"W	7.62	
7531.00†	49.136	173.065	7309.25	-538.51	548.13	816.81	40°06'03.909"N	104°47'00.047"W	9.79	N470_B_CK
7577.00	53.640	173.100	7337.95	-502.79	512.46	821.14	40°06'03.556"N	104°46'59.991"W	9.79	
7663.00†	61.666	176.095	7383.93	-430.45	440.19	827.89	40°06'02.842"N	104°46'59.904"W	9.78	N700_C_CK
7672.00	62.510	176.380	7388.15	-422.51	432.25	828.41	40°06'02.763"N	104°46'59.898"W	9.78	
7750.00†	70.359	176.721	7419.31	-351.15	360.94	832.70	40°06'02.059"N	104°46'59.842"W	10.07	ENTERED LANDBOX
7767.00	72.070	176.790	7424.78	-335.08	344.88	833.61	40°06'01.900"N	104°46'59.831"W	10.07	
7834.00†	79.039	178.809	7441.48	-270.26	280.09	836.08	40°06'01.260"N	104°46'59.799"W	10.80	FRHS
7863.00	82.060	179.650	7446.25	-241.66	251.49	836.47	40°06'00.977"N	104°46'59.794"W	10.80	
7944.00†	87.201	178.062	7453.82	-161.05	170.89	838.08	40°06'00.181"N	104°46'59.773"W	6.64	LANDING DEPTH
7958.00	88.090	177.790	7454.40	-147.06	156.91	838.59	40°06'00.042"N	104°46'59.767"W	6.64	
8053.00	87.870	177.400	7457.75	-52.16	62.05	842.57	40°05'59.105"N	104°46'59.715"W	0.47	

REFERENCE WELLPATH IDENTIFICATION

Operator	KERR-MCGEE OIL & GAS ONSHORE LP (WA)	Slot	SLOT#07 CARTER 14C-33HZ (825'FNL & 1500'FWL, SEC.33)
Area	COLORADO	Well	CARTER 14C-33HZ
Field	WELD COUNTY (UTM/TRUE NORTH)	Wellbore	CARTER 14C-33HZ AWB <12515>
Facility	SEC.33-T2N-R66W		

WELLPATH DATA (137 stations)

MD [ft]	Inclination [°]	Azimuth [°]	TVD [ft]	Vert Sect [ft]	North [ft]	East [ft]	Latitude	Longitude	DLS [°/100ft]	Comments
8149.00	87.600	177.210	7461.54	43.70	-33.77	847.08	40°05'58.158"N	104°46'59.657"W	0.34	
8244.00	86.850	179.260	7466.14	138.57	-128.61	850.00	40°05'57.221"N	104°46'59.620"W	2.30	
8339.00	88.270	180.720	7470.19	233.47	-223.51	850.02	40°05'56.283"N	104°46'59.620"W	2.14	
8435.00	89.200	181.130	7472.31	329.41	-319.48	848.47	40°05'55.335"N	104°46'59.640"W	1.06	
8529.00	88.250	180.680	7474.40	423.35	-413.44	846.99	40°05'54.406"N	104°46'59.659"W	1.12	
8624.00	90.120	180.260	7475.75	518.31	-508.42	846.21	40°05'53.468"N	104°46'59.669"W	2.02	
8719.00	90.400	180.000	7475.32	613.30	-603.42	845.99	40°05'52.529"N	104°46'59.672"W	0.40	
8815.00	90.960	180.780	7474.18	709.28	-699.41	845.34	40°05'51.580"N	104°46'59.680"W	1.00	
8910.00	89.410	181.680	7473.87	804.22	-794.39	843.30	40°05'50.642"N	104°46'59.706"W	1.89	
9006.00	89.750	181.300	7474.57	900.15	-890.35	840.80	40°05'49.693"N	104°46'59.739"W	0.53	
9101.00	88.060	179.950	7476.39	995.10	-985.32	839.77	40°05'48.755"N	104°46'59.752"W	2.28	
9196.00	88.610	180.170	7479.15	1090.06	-1080.28	839.67	40°05'47.816"N	104°46'59.753"W	0.62	
9291.00	87.840	178.220	7482.09	1185.00	-1175.22	841.00	40°05'46.878"N	104°46'59.736"W	2.21	
9386.00	87.070	177.810	7486.31	1279.88	-1270.07	844.29	40°05'45.941"N	104°46'59.694"W	0.92	
9481.00	88.150	178.480	7490.27	1374.78	-1364.94	847.36	40°05'45.003"N	104°46'59.654"W	1.34	
9577.00	88.120	178.620	7493.40	1470.72	-1460.85	849.79	40°05'44.055"N	104°46'59.623"W	0.15	
9672.00	89.810	179.140	7495.11	1565.70	-1555.82	851.65	40°05'43.117"N	104°46'59.599"W	1.86	
9768.00	90.060	179.500	7495.22	1661.70	-1651.81	852.78	40°05'42.168"N	104°46'59.585"W	0.46	
9863.00	88.090	179.440	7496.76	1756.68	-1746.79	853.66	40°05'41.230"N	104°46'59.574"W	2.07	
9958.00	88.830	178.100	7499.31	1851.64	-1841.73	855.70	40°05'40.292"N	104°46'59.547"W	1.61	
10054.00	88.860	179.270	7501.24	1947.61	-1937.68	857.90	40°05'39.343"N	104°46'59.519"W	1.22	
10149.00	88.950	178.490	7503.06	2042.59	-2032.65	859.76	40°05'38.405"N	104°46'59.495"W	0.83	
10244.00	89.540	178.670	7504.31	2137.57	-2127.61	862.11	40°05'37.466"N	104°46'59.465"W	0.65	
10339.00	89.480	177.300	7505.12	2232.54	-2222.54	865.45	40°05'36.528"N	104°46'59.422"W	1.44	
10434.00	87.630	177.820	7507.52	2327.46	-2317.42	869.50	40°05'35.591"N	104°46'59.370"W	2.02	
10529.00	87.690	178.360	7511.40	2422.36	-2412.29	872.66	40°05'34.653"N	104°46'59.329"W	0.57	
10625.00	86.980	177.700	7515.86	2518.23	-2508.13	875.96	40°05'33.706"N	104°46'59.287"W	1.01	
10720.00	86.020	177.710	7521.66	2613.01	-2602.88	879.76	40°05'32.770"N	104°46'59.238"W	1.01	
10815.00	88.030	178.650	7526.59	2707.86	-2697.69	882.77	40°05'31.833"N	104°46'59.199"W	2.34	
10910.00	86.950	176.630	7530.75	2802.72	-2792.52	886.67	40°05'30.896"N	104°46'59.149"W	2.41	
11005.00	87.600	176.640	7535.27	2897.51	-2887.24	892.24	40°05'29.960"N	104°46'59.078"W	0.68	
11101.00	89.040	179.770	7538.08	2993.44	-2983.14	895.25	40°05'29.012"N	104°46'59.039"W	3.59	
11196.00	90.250	179.270	7538.67	3088.43	-3078.13	896.04	40°05'28.073"N	104°46'59.029"W	1.38	
11291.00	89.880	179.680	7538.57	3183.43	-3173.13	896.92	40°05'27.134"N	104°46'59.018"W	0.58	
11386.00	89.080	179.700	7539.43	3278.42	-3268.12	897.43	40°05'26.196"N	104°46'59.011"W	0.84	
11481.00	90.280	180.040	7539.96	3373.42	-3363.12	897.64	40°05'25.257"N	104°46'59.008"W	1.31	
11576.00	90.220	179.410	7539.54	3468.41	-3458.12	898.10	40°05'24.318"N	104°46'59.003"W	0.67	
11670.00	90.030	179.490	7539.34	3562.41	-3552.11	899.00	40°05'23.389"N	104°46'58.991"W	0.22	
11766.00	90.950	178.910	7538.52	3658.41	-3648.10	900.34	40°05'22.441"N	104°46'58.974"W	1.13	
11861.00	90.620	178.510	7537.22	3753.39	-3743.07	902.48	40°05'21.502"N	104°46'58.946"W	0.55	
11956.00	90.060	178.170	7536.65	3848.38	-3838.02	905.23	40°05'20.564"N	104°46'58.911"W	0.69	
12051.00	89.750	178.360	7536.81	3943.36	-3932.98	908.11	40°05'19.626"N	104°46'58.874"W	0.38	
12146.00	90.030	179.360	7536.99	4038.35	-4027.96	910.00	40°05'18.687"N	104°46'58.850"W	1.09	
12242.00	89.450	178.860	7537.43	4134.35	-4123.95	911.49	40°05'17.738"N	104°46'58.831"W	0.80	
12337.00	89.170	177.920	7538.57	4229.33	-4218.90	914.16	40°05'16.800"N	104°46'58.796"W	1.03	

REFERENCE WELLPATH IDENTIFICATION

Operator	KERR-MCGEE OIL & GAS ONSHORE LP (WA)	Slot	SLOT#07 CARTER 14C-33HZ (825'FNL & 1500'FWL, SEC.33)
Area	COLORADO	Well	CARTER 14C-33HZ
Field	WELD COUNTY (UTM/TRUE NORTH)	Wellbore	CARTER 14C-33HZ AWB <12515>
Facility	SEC.33-T2N-R66W		

WELLPATH DATA (137 stations)

MD [ft]	Inclination [°]	Azimuth [°]	TVD [ft]	Vert Sect [ft]	North [ft]	East [ft]	Latitude	Longitude	DLS [°/100ft]	Comments
12463.00	88.490	178.390	7541.14	4355.28	-4344.81	918.22	40°05'15.556"N	104°46'58.744"W	0.66	LAST BHI MWD+IFR SURVEYS
12515.00	88.490	178.390	7542.51	4407.25	-4396.77	919.68	40°05'15.042"N	104°46'58.725"W	0.00	PROJECTION TO BIT

HOLE & CASING SECTIONS - Ref Wellbore: CARTER 14C-33HZ AWB <12515> Ref Wellpath: CARTER 14C-33HZ AWP

String/Diameter	Start MD [ft]	End MD [ft]	Interval [ft]	Start TVD [ft]	End TVD [ft]	Start N/S [ft]	Start E/W [ft]	End N/S [ft]	End E/W [ft]
13.5in Open Hole	16.00	1900.00	1884.00	16.00	1874.69	0.00	0.00	176.04	176.26
9.625in Casing Surface	16.00	1890.00	1874.00	16.00	1865.01	0.00	0.00	174.13	174.60
7.875in Open Hole	1900.00	12515.00	10615.00	1874.69	7542.51	176.04	176.26	-4396.77	919.68

TARGETS

Name	TVD [ft]	North [ft]	East [ft]	Grid East [US ft]	Grid North [US ft]	Latitude	Longitude	Shape
SEC.28-T2N-R66W SECTION LINES	0.00	0.69	-179.85	1700006.25	14563067.36	40°05'58.499"N	104°47'12.872"W	polygon
SEC.32-T2N-R66W SECTION LINES	0.00	0.69	-179.85	1700006.25	14563067.36	40°05'58.499"N	104°47'12.872"W	polygon
SEC.33-T2N-R66W SECTION LINES	0.00	0.69	-179.85	1700006.25	14563067.36	40°05'58.499"N	104°47'12.872"W	polygon
CARTER 14C-33HZ BHL ON PLAT (50'FSL & 2392'FWL, SEC.33) REV-1	7497.00	-4397.00	903.21	1701099.44	14558674.03	40°05'15.040"N	104°46'58.937"W	point
CARTER 14C-33HZ LANDBOX	7497.00	0.00	0.00	1700186.03	14563067.10	40°05'58.492"N	104°47'10.558"W	polygon
SEC.29-T2N-R66W SECTION LINES	7524.00	5794.29	-3861.21	1696312.45	14568849.79	40°06'55.749"N	104°48'00.257"W	polygon

WELLPATH COMPOSITION - Ref Wellbore: CARTER 14C-33HZ AWB <12515> Ref Wellpath: CARTER 14C-33HZ AWP

Start MD [ft]	End MD [ft]	Positional Uncertainty Model	Log Name/Comment	Wellbore
16.00	1841.00	Custom APC_ISCWSA REV 2 MWD	SCIENTIFIC DRILLING MWD SURVEYS <129-1841>	CARTER 14C-33HZ AWB <12515>
1841.00	12463.00	Custom APC_ISCWSA REV 2 MWD+IFR1+SC (approximation)	BHI MWD+IFR SURVEYS 7.875" <1957-12463>	CARTER 14C-33HZ AWB <12515>
12463.00	12515.00	Blind Drilling (std)	Projection to bit	CARTER 14C-33HZ AWB <12515>



Actual Wellpath Report

CARTER 14C-33HZ AWP
Page 6 of 6



REFERENCE WELLPATH IDENTIFICATION

Operator	KERR-MCGEE OIL & GAS ONSHORE LP (WA)	Slot	SLOT#07 CARTER 14C-33HZ (825'FNL & 1500'FWL, SEC.33)
Area	COLORADO	Well	CARTER 14C-33HZ
Field	WELD COUNTY (UTM/TRUE NORTH)	Wellbore	CARTER 14C-33HZ AWB <12515>
Facility	SEC.33-T2N-R66W		

WELLPATH COMMENTS

MD [ft]	Inclination [°]	Azimuth [°]	TVD [ft]	Comment
129.00	0.320	272.330	129.00	BEGIN MWD SURVEYS
1841.00	15.320	42.400	1817.69	TIE-ONTO MWD SURVEYS
1957.00	13.940	39.120	1929.93	BEGIN BHI MWD+IFR SURVEYS
7328.00	32.932	184.158	7155.94	SSPG
7399.00	38.600	177.101	7213.49	NBRR
7531.00	49.136	173.065	7309.25	N470_B_CK
7663.00	61.666	176.095	7383.93	N700_C_CK
7750.00	70.359	176.721	7419.31	ENTERED LANDBOX
7834.00	79.039	178.809	7441.48	FRHS
7944.00	87.201	178.062	7453.82	LANDING DEPTH
12463.00	88.490	178.390	7541.14	LAST BHI MWD+IFR SURVEYS
12515.00	88.490	178.390	7542.51	PROJECTION TO BIT