

# EXTRACTION OIL & GAS

Location: COLORADO Slot: SLOT#03 TROUDT #3 (537'FSL & 1007'FEL, SEC.32)  
Field: WELD COUNTY (NAD83/TRUE NORTH) Well: TROUDT #3  
Facility: SEC.32-T02N-R67W Wellbore: TROUDT #3 PWB

Plot reference wellpath is TROUDT #3 PWP (REV-D.0)

True vertical depths are referenced to SAVANNA 802 (20'KB) (RKB)	Grid System: NAD83 / Lambert Colorado SP, Northern Zone (501), US feet
Measured depths are referenced to SAVANNA 802 (20'KB) (RKB)	North Reference: True north
SAVANNA 802 (20'KB) (RKB) to Mean Sea Level: 5097 feet	Scale: True distance
Mean Sea Level to Mud line (At Slot: SLOT#03 TROUDT #3 (537'FSL & 1007'FEL, SEC.32)): 0 feet	Depths are in feet
Coordinates are in feet referenced to Slot	Created by: ingmjamm on 9/18/2015



BGGM (1945.0 to 2017.0) Dip: 66.69° Field: 52424.7 nT  
Magnetic North is 8.61 degrees East of True North (at 8/27/2015)

To correct azimuth from Magnetic to True add 8.61 degrees

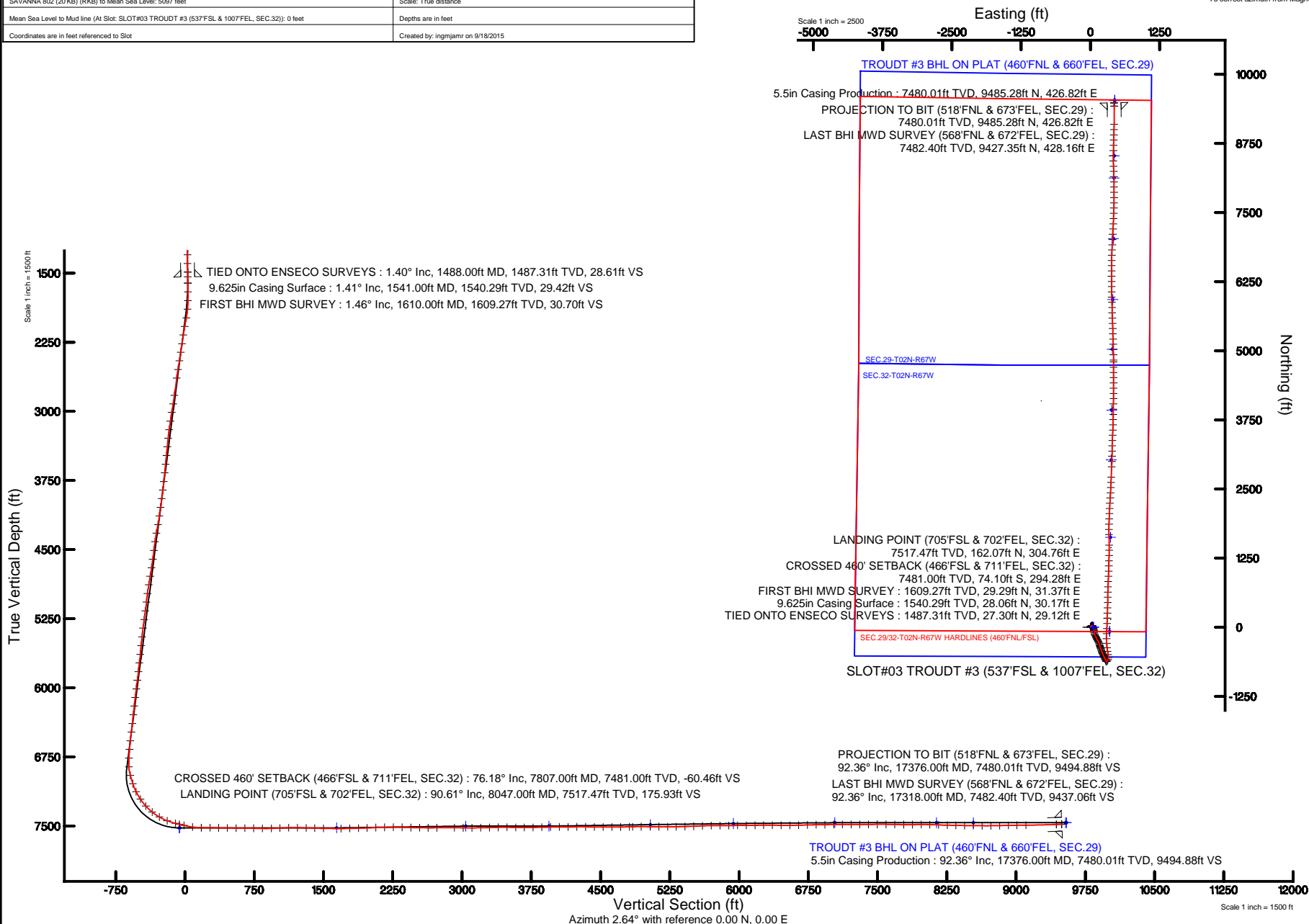



# Actual Wellpath Report

TROUDT #3 AWP

Page 1 of 10



## REFERENCE WELLPATH IDENTIFICATION

Operator	EXTRACTION OIL & GAS	Slot	SLOT#03 TROUDT #3 (537'FSL & 1007'FEL, SEC.32)
Area	COLORADO	Well	TROUDT #3
Field	WELD COUNTY (NAD83/TRUE NORTH)	Wellbore	TROUDT #3 AWB
Facility	SEC.32-T02N-R67W		

## REPORT SETUP INFORMATION

Projection System	NAD83 / Lambert Colorado SP, Northern Zone (501), US feet	Software System	WellArchitect® 4.1.1
North Reference	True	User	Ingmjmr
Scale	0.999961	Report Generated	9/18/2015 at 7:40:34 AM
Convergence at slot	0.38° East	Database/Source file	WA_DEN_Denver_Defn/TROUDT_#3_AWB.xml

## WELLPATH LOCATION

	Local coordinates		Grid coordinates		Geographic coordinates	
	North[ft]	East[ft]	Easting[US ft]	Northing[US ft]	Latitude	Longitude
Slot Location	0.40	-55.96	3165377.10	1275842.22	40°05'20.634"N	104°54'32.094"W
Facility Reference Pt			3165433.05	1275842.19	40°05'20.630"N	104°54'31.374"W
Field Reference Pt			3185481.27	1419166.81	40°28'55.560"N	104°49'59.556"W

## WELLPATH DATUM

Calculation method	Minimum curvature	SAVANNA 802 (20'KB) (RKB) to Facility Vertical Datum	5097.00ft
Horizontal Reference Pt	Slot	SAVANNA 802 (20'KB) (RKB) to Mean Sea Level	5097.00ft
Vertical Reference Pt	SAVANNA 802 (20'KB) (RKB)	SAVANNA 802 (20'KB) (RKB) to Mud Line at Slot (SLOT#03 TROUDT #3 (537'FSL & 1007'FEL, SEC.32))	5097.00ft
MD Reference Pt	SAVANNA 802 (20'KB) (RKB)	Section Origin	N 0.00, E 0.00 ft
Field Vertical Reference	Mean Sea Level	Section Azimuth	2.64°



# Actual Wellpath Report

TROUDT #3 AWP

Page 2 of 10



## REFERENCE WELLPATH IDENTIFICATION

Operator	EXTRACTION OIL & GAS	Slot	SLOT#03 TROUDT #3 (537'FSL & 1007'FEL, SEC.32)
Area	COLORADO	Well	TROUDT #3
Field	WELD COUNTY (NAD83/TRUE NORTH)	Wellbore	TROUDT #3 AWP
Facility	SEC.32-T02N-R67W		

## WELLPATH DATA (165 stations)

MD [ft]	Inclination [°]	Azimuth [°]	TVD [ft]	Vert Sect [ft]	North [ft]	East [ft]	DLS [°/100ft]	Comments
1488.00	1.400	58.500	1487.31	28.61	27.30	29.12	0.12	TIED ONTO ENSECO SURVEYS
1610.00	1.460	38.680	1609.27	30.70	29.29	31.37	0.41	FIRST BHI MWD SURVEY
1704.00	1.490	33.520	1703.24	32.72	31.24	32.79	0.14	
1799.00	2.160	139.420	1798.21	32.48	30.91	34.64	3.10	
1893.00	5.270	157.580	1892.00	27.27	25.58	37.44	3.50	
1988.00	11.250	162.180	1985.97	14.63	12.71	41.94	6.33	
2083.00	10.740	160.880	2079.23	-2.28	-4.48	47.68	0.60	
2177.00	10.030	161.720	2171.69	-18.06	-20.52	53.11	0.77	
2272.00	8.810	162.450	2265.41	-32.61	-35.32	57.90	1.29	
2366.00	7.490	168.430	2358.46	-45.31	-48.18	61.30	1.67	
2461.00	10.690	169.280	2452.25	-59.89	-62.91	64.18	3.37	
2555.00	9.360	172.940	2544.82	-75.91	-79.06	66.74	1.57	
2650.00	7.610	172.290	2638.77	-89.71	-92.96	68.54	1.84	
2839.00	8.050	165.560	2826.01	-114.67	-118.18	73.52	0.54	
2934.00	9.710	161.610	2919.87	-128.51	-132.23	77.70	1.86	
3028.00	11.550	150.640	3012.27	-143.89	-147.95	84.82	2.90	
3123.00	9.740	151.560	3105.63	-158.84	-163.31	93.31	1.91	
3217.00	8.210	153.240	3198.47	-171.50	-176.30	100.12	1.65	
3310.00	6.680	155.150	3290.69	-182.08	-187.13	105.38	1.67	
3405.00	5.720	158.640	3385.13	-191.31	-196.56	109.43	1.09	
3499.00	7.480	151.200	3478.51	-200.81	-206.28	114.08	2.08	
3594.00	5.800	153.630	3572.86	-210.28	-216.00	119.19	1.79	
3689.00	7.770	151.970	3667.19	-220.01	-225.97	124.34	2.08	
3784.00	5.950	153.330	3761.51	-229.82	-236.04	129.57	1.92	
3878.00	9.170	152.590	3854.68	-240.56	-247.05	135.21	3.43	
3972.00	7.150	158.030	3947.73	-252.36	-259.12	140.85	2.30	
4066.00	9.810	153.130	4040.69	-264.65	-271.69	146.66	2.93	
4161.00	8.120	159.550	4134.53	-277.87	-285.20	152.66	2.06	
4257.00	11.560	159.600	4229.10	-292.96	-300.57	158.38	3.58	
4352.00	10.310	159.790	4322.38	-309.55	-317.47	164.64	1.32	



# Actual Wellpath Report

TROUDT #3 AWP

Page 3 of 10



## REFERENCE WELLPATH IDENTIFICATION

Operator	EXTRACTION OIL & GAS	Slot	SLOT#03 TROUDT #3 (537'FSL & 1007'FEL, SEC.32)
Area	COLORADO	Well	TROUDT #3
Field	WELD COUNTY (NAD83/TRUE NORTH)	Wellbore	TROUDT #3 AWB
Facility	SEC.32-T02N-R67W		

## WELLPATH DATA (165 stations)

MD [ft]	Inclination [°]	Azimuth [°]	TVD [ft]	Vert Sect [ft]	North [ft]	East [ft]	DLS [°/100ft]	Comments
4446.00	9.060	164.180	4415.04	-324.33	-332.49	169.56	1.54	
4540.00	6.530	169.120	4508.16	-336.55	-344.86	172.59	2.78	
4636.00	8.920	161.140	4603.29	-348.78	-357.27	176.02	2.72	
4731.00	8.450	160.860	4697.20	-362.12	-370.83	180.69	0.50	
4825.00	10.910	157.680	4789.85	-376.60	-385.59	186.34	2.68	
4919.00	10.070	158.330	4882.28	-392.15	-401.45	192.75	0.90	
5014.00	8.270	160.960	4976.06	-406.07	-415.63	198.05	1.94	
5109.00	6.210	164.650	5070.30	-417.31	-427.05	201.64	2.22	
5205.00	9.250	160.500	5165.42	-429.39	-439.33	205.59	3.22	
5300.00	8.250	160.140	5259.31	-442.76	-452.94	210.45	1.05	
5395.00	7.040	161.770	5353.46	-454.50	-464.88	214.59	1.29	
5490.00	5.870	165.480	5447.86	-464.58	-475.11	217.63	1.31	
5584.00	8.250	148.860	5541.15	-474.78	-485.54	222.32	3.31	
5680.00	5.850	145.790	5636.42	-484.43	-495.48	228.64	2.53	
5774.00	8.580	157.520	5729.67	-494.61	-505.93	234.01	3.29	
5869.00	5.410	156.570	5823.95	-505.05	-516.59	238.50	3.34	
5964.00	9.290	160.210	5918.15	-516.17	-527.91	242.88	4.11	
6058.00	6.290	160.290	6011.28	-527.95	-539.90	247.19	3.19	
6153.00	8.490	158.510	6105.48	-539.16	-551.33	251.51	2.33	
6247.00	5.760	154.830	6198.75	-549.67	-562.06	256.06	2.94	
6342.00	8.780	148.460	6292.97	-559.88	-572.55	261.88	3.29	
6437.00	5.920	143.610	6387.18	-569.69	-582.68	268.58	3.08	
6531.00	9.340	156.090	6480.34	-580.28	-593.56	274.55	4.02	
6626.00	6.740	156.000	6574.40	-592.16	-605.70	279.95	2.74	
6720.00	4.770	162.930	6667.92	-600.77	-614.48	283.34	2.22	
6815.00	3.310	167.600	6762.69	-607.14	-620.93	285.09	1.57	
6910.00	8.480	67.380	6857.31	-606.80	-620.92	292.16	10.14	
7005.00	17.570	34.790	6949.88	-591.62	-606.40	306.85	11.95	
7099.00	18.330	16.510	7039.37	-565.24	-580.55	319.16	6.02	
7194.00	26.590	0.710	7127.17	-529.39	-544.88	323.68	10.70	



# Actual Wellpath Report

TROUDT #3 AWP

Page 4 of 10



## REFERENCE WELLPATH IDENTIFICATION

Operator	EXTRACTION OIL & GAS	Slot	SLOT#03 TROUDT #3 (537'FSL & 1007'FEL, SEC.32)
Area	COLORADO	Well	TROUDT #3
Field	WELD COUNTY (NAD83/TRUE NORTH)	Wellbore	TROUDT #3 AWP
Facility	SEC.32-T02N-R67W		

## WELLPATH DATA (165 stations) † = interpolated/extrapolated station

MD [ft]	Inclination [°]	Azimuth [°]	TVD [ft]	Vert Sect [ft]	North [ft]	East [ft]	DLS [°/100ft]	Comments
7289.00	34.750	350.080	7208.87	-481.60	-496.83	319.27	10.28	
7384.00	42.190	351.030	7283.20	-423.84	-438.57	309.62	7.86	
7479.00	51.840	353.890	7347.90	-355.51	-369.75	300.64	10.39	
7574.00	59.220	356.690	7401.64	-277.89	-291.76	294.30	8.14	
7668.00	69.170	357.210	7442.51	-193.79	-207.36	289.82	10.60	
7763.00	76.460	4.410	7470.59	-103.20	-116.74	291.22	10.55	
7807.00†	76.181	3.813	7481.00	-60.46	-74.10	294.28	1.46	CROSSED 460' SETBACK (466'FSL & 711'FEL, SEC.32)
7858.00	75.860	3.120	7493.32	-10.98	-24.70	297.27	1.46	
7952.00	82.000	2.260	7511.36	81.23	67.41	301.59	6.59	
8047.00	90.610	1.580	7517.47	175.93	162.07	304.76	9.09	LANDING POINT (705'FSL & 702'FEL, SEC.32)
8142.00	88.980	1.560	7517.81	270.91	257.03	307.37	1.72	
8236.00	88.980	1.400	7519.49	364.88	350.98	309.79	0.17	
8331.00	89.100	1.480	7521.08	459.84	445.94	312.18	0.15	
8426.00	89.440	0.740	7522.29	554.80	540.91	314.02	0.86	
8521.00	89.460	0.610	7523.20	649.74	635.90	315.14	0.14	
8615.00	89.070	2.880	7524.41	743.71	729.84	318.00	2.45	
8710.00	88.420	1.690	7526.49	838.69	824.74	321.79	1.43	
8806.00	92.060	2.540	7526.09	934.66	920.66	325.33	3.89	
8900.00	92.580	1.560	7522.28	1028.58	1014.52	328.69	1.18	
8995.00	91.510	1.890	7518.89	1123.51	1109.41	331.55	1.18	
9089.00	88.830	1.510	7518.61	1217.49	1203.36	334.34	2.88	
9183.00	88.670	1.290	7520.66	1311.44	1297.31	336.63	0.29	
9277.00	88.580	0.450	7522.92	1405.37	1391.27	338.06	0.90	
9372.00	88.640	359.250	7525.22	1500.23	1486.24	337.81	1.26	
9561.00	90.060	358.810	7527.37	1688.83	1675.20	334.61	0.79	
9656.00	91.410	0.960	7526.15	1783.71	1770.18	334.42	2.67	
9751.00	91.450	0.600	7523.78	1878.63	1865.14	335.71	0.38	
9845.00	91.660	2.840	7521.23	1972.58	1959.06	338.53	2.39	
9940.00	93.170	1.940	7517.22	2067.49	2053.89	342.49	1.85	
10034.00	90.240	2.970	7514.43	2161.43	2147.75	346.52	3.30	



# Actual Wellpath Report

TROUDT #3 AWP

Page 5 of 10



## REFERENCE WELLPATH IDENTIFICATION

Operator	EXTRACTION OIL & GAS	Slot	SLOT#03 TROUDT #3 (537'FSL & 1007'FEL, SEC.32)
Area	COLORADO	Well	TROUDT #3
Field	WELD COUNTY (NAD83/TRUE NORTH)	Wellbore	TROUDT #3 AWB
Facility	SEC.32-T02N-R67W		

## WELLPATH DATA (165 stations)

MD [ft]	Inclination [°]	Azimuth [°]	TVD [ft]	Vert Sect [ft]	North [ft]	East [ft]	DLS [°/100ft]	Comments
10129.00	90.740	2.810	7513.61	2256.43	2242.63	351.31	0.55	
10224.00	88.330	3.420	7514.38	2351.41	2337.48	356.47	2.62	
10318.00	88.770	3.350	7516.76	2445.38	2431.28	362.02	0.47	
10413.00	89.100	2.990	7518.53	2540.36	2526.12	367.27	0.51	
10507.00	89.780	2.560	7519.45	2634.35	2620.00	371.82	0.86	
10602.00	90.610	2.290	7519.12	2729.35	2714.92	375.84	0.92	
10791.00	89.530	2.600	7518.89	2918.34	2903.74	383.90	0.59	
10886.00	89.720	1.690	7519.52	3013.34	2998.67	387.46	0.98	
10981.00	90.090	1.340	7519.67	3108.32	3093.64	389.97	0.54	
11075.00	90.920	1.000	7518.84	3202.28	3187.62	391.89	0.95	
11170.00	91.540	0.760	7516.80	3297.22	3282.58	393.35	0.70	
11265.00	91.470	1.940	7514.31	3392.16	3377.52	395.59	1.24	
11360.00	88.950	2.970	7513.96	3487.15	3472.42	399.65	2.87	
11454.00	90.000	2.640	7514.82	3581.14	3566.31	404.25	1.17	
11548.00	89.900	1.670	7514.90	3675.14	3660.24	407.79	1.04	
11643.00	90.300	1.250	7514.74	3770.12	3755.21	410.21	0.61	
11738.00	91.110	0.820	7513.57	3865.07	3850.18	411.93	0.97	
11833.00	91.930	0.570	7511.05	3959.98	3945.14	413.08	0.90	
11927.00	89.350	1.210	7510.00	4053.92	4039.12	414.54	2.83	
12022.00	90.210	0.770	7510.37	4148.88	4134.10	416.18	1.02	
12117.00	91.040	0.600	7509.33	4243.82	4229.09	417.31	0.89	
12212.00	89.290	0.660	7509.06	4338.76	4324.08	418.36	1.84	
12307.00	89.440	0.070	7510.11	4433.68	4419.07	418.96	0.64	
12402.00	89.410	359.370	7511.06	4528.55	4514.06	418.50	0.74	
12497.00	90.150	0.010	7511.43	4623.42	4609.06	417.99	1.03	
12592.00	90.790	359.580	7510.65	4718.30	4704.05	417.65	0.81	
12687.00	91.600	359.300	7508.67	4813.13	4799.03	416.72	0.90	
12721.00	91.810	359.270	7507.65	4847.06	4833.01	416.29	0.62	
12815.00	89.530	359.550	7506.56	4940.89	4926.99	415.33	2.44	
12911.00	90.060	358.690	7506.90	5036.71	5022.98	413.85	1.05	



# Actual Wellpath Report

TROUDT #3 AWP

Page 6 of 10



## REFERENCE WELLPATH IDENTIFICATION

Operator	EXTRACTION OIL & GAS	Slot	SLOT#03 TROUDT #3 (537'FSL & 1007'FEL, SEC.32)
Area	COLORADO	Well	TROUDT #3
Field	WELD COUNTY (NAD83/TRUE NORTH)	Wellbore	TROUDT #3 AWP
Facility	SEC.32-T02N-R67W		

## WELLPATH DATA (165 stations)

MD [ft]	Inclination [°]	Azimuth [°]	TVD [ft]	Vert Sect [ft]	North [ft]	East [ft]	DLS [°/100ft]	Comments
13006.00	89.810	358.450	7507.01	5131.47	5117.95	411.48	0.36	
13101.00	89.250	357.760	7507.79	5226.17	5212.89	408.34	0.94	
13196.00	91.170	358.880	7507.44	5320.89	5307.85	405.55	2.34	
13291.00	91.720	358.110	7505.04	5415.61	5402.78	403.06	1.00	
13385.00	92.060	357.640	7501.94	5509.24	5496.67	399.58	0.62	
13480.00	92.400	357.460	7498.24	5603.79	5591.51	395.52	0.40	
13575.00	90.430	359.430	7495.90	5698.50	5686.43	392.94	2.93	
13670.00	90.240	358.380	7495.34	5793.29	5781.41	391.13	1.12	
13765.00	90.270	358.160	7494.92	5888.02	5876.37	388.26	0.23	
13860.00	90.950	357.470	7493.91	5982.67	5971.29	384.64	1.02	
13955.00	90.460	0.350	7492.74	6077.45	6066.26	382.83	3.07	
14050.00	90.460	359.930	7491.98	6172.36	6161.26	383.06	0.44	
14144.00	90.330	359.280	7491.33	6266.23	6255.25	382.41	0.71	
14239.00	89.500	0.570	7491.47	6361.12	6350.25	382.29	1.61	
14334.00	89.780	0.390	7492.07	6456.05	6445.24	383.09	0.35	
14428.00	89.900	359.760	7492.33	6549.95	6539.24	383.21	0.68	
14523.00	91.350	1.320	7491.29	6644.88	6634.23	384.10	2.24	
14618.00	91.750	0.670	7488.72	6739.80	6729.18	385.75	0.80	
14713.00	91.100	3.410	7486.36	6834.76	6824.08	389.13	2.96	
14807.00	90.730	2.790	7484.86	6928.74	6917.93	394.22	0.77	
14902.00	90.950	2.150	7483.47	7023.73	7012.83	398.31	0.71	
14997.00	89.630	2.920	7482.99	7118.73	7107.73	402.51	1.61	
15092.00	89.840	3.660	7483.43	7213.72	7202.57	407.96	0.81	
15186.00	90.400	2.530	7483.23	7307.71	7296.43	413.04	1.34	
15281.00	90.300	2.130	7482.65	7402.71	7391.35	416.90	0.43	
15376.00	90.950	1.920	7481.61	7497.70	7486.29	420.26	0.72	
15471.00	88.790	1.730	7481.83	7592.68	7581.23	423.28	2.28	
15566.00	89.160	1.340	7483.53	7687.65	7676.18	425.83	0.57	
15661.00	89.630	0.330	7484.53	7782.60	7771.17	427.21	1.17	
15756.00	90.240	359.950	7484.64	7877.51	7866.17	427.44	0.76	





# Actual Wellpath Report

TROUDT #3 AWP

Page 7 of 10



## REFERENCE WELLPATH IDENTIFICATION

Operator	EXTRACTION OIL & GAS	Slot	SLOT#03 TROUDT #3 (537'FSL & 1007'FEL, SEC.32)
Area	COLORADO	Well	TROUDT #3
Field	WELD COUNTY (NAD83/TRUE NORTH)	Wellbore	TROUDT #3 AWB
Facility	SEC.32-T02N-R67W		

## WELLPATH DATA (165 stations)

MD [ft]	Inclination [°]	Azimuth [°]	TVD [ft]	Vert Sect [ft]	North [ft]	East [ft]	DLS [°/100ft]	Comments
15851.00	90.730	359.120	7483.83	7972.36	7961.16	426.67	1.01	
15944.00	88.080	358.970	7484.80	8065.17	8054.13	425.12	2.85	
16039.00	87.930	358.730	7488.11	8159.90	8149.06	423.22	0.30	
16134.00	88.670	357.990	7490.92	8254.59	8243.97	420.50	1.10	
16229.00	89.100	357.680	7492.77	8349.24	8338.89	416.91	0.56	
16323.00	88.860	357.740	7494.45	8442.88	8432.80	413.16	0.26	
16418.00	89.530	1.550	7495.78	8537.72	8527.77	412.57	4.07	
16513.00	89.260	1.520	7496.79	8632.70	8622.73	415.11	0.29	
16608.00	90.950	1.810	7496.61	8727.68	8717.68	417.87	1.80	
16702.00	91.260	1.640	7494.80	8821.65	8811.62	420.70	0.38	
16797.00	90.950	1.410	7492.97	8916.61	8906.57	423.23	0.41	
16891.00	90.490	1.450	7491.79	9010.59	9000.54	425.58	0.49	
16987.00	90.580	1.390	7490.89	9106.56	9096.50	427.95	0.11	
17318.00	92.360	358.680	7482.40	9437.06	9427.35	428.16	0.98	LAST BHI MWD SURVEY (568'FNL & 672'FEL, SEC.29)
17376.00	92.360	358.680	7480.01	9494.88	9485.28	426.82	0.00	PROJECTION TO BIT (518'FNL & 673'FEL, SEC.29)

## HOLE & CASING SECTIONS - Ref Wellbore: TROUDT #3 AWB Ref Wellpath: TROUDT #3 AWP

String/Diameter	Start MD [ft]	End MD [ft]	Interval [ft]	Start TVD [ft]	End TVD [ft]	Start N/S [ft]	Start E/W [ft]	End N/S [ft]	End E/W [ft]
9.625in Casing Surface	20.00	1541.00	1521.00	20.00	1540.29	0.00	0.00	28.06	30.17
7.875in Open Hole	1541.00	17376.00	15835.00	1540.29	7480.01	28.06	30.17	9485.28	426.82
5.5in Casing Production	20.00	17376.00	17356.00	20.00	7480.01	0.00	0.00	9485.28	426.82





# Actual Wellpath Report

TROUDT #3 AWP

Page 8 of 10



## REFERENCE WELLPATH IDENTIFICATION

Operator	EXTRACTION OIL & GAS	Slot	SLOT#03 TROUDT #3 (537'FSL & 1007'FEL, SEC.32)
Area	COLORADO	Well	TROUDT #3
Field	WELD COUNTY (NAD83/TRUE NORTH)	Wellbore	TROUDT #3 AWB
Facility	SEC.32-T02N-R67W		

## TARGETS

Name	TVD [ft]	North [ft]	East [ft]	Grid East [US ft]	Grid North [US ft]	Latitude	Longitude	Shape
SEC.29-T02N-R67W	6.00	-0.40	55.96	3165433.05	1275842.19	40°05'20.630"N	104°54'31.374"W	polygon
SEC.32-T02N-R67W	6.00	-0.40	55.96	3165433.05	1275842.19	40°05'20.630"N	104°54'31.374"W	polygon
TROUDT #3 BHL ON PLAT (460'FNL & 660'FEL, SEC.29)	7464.00	9535.74	439.68	3165753.18	1285380.29	40°06'54.868"N	104°54'26.435"W	point
TROUDT #3 TARGET 10	7464.00	9526.68	439.59	3165753.16	1285371.23	40°06'54.778"N	104°54'26.436"W	point
TROUDT #3 TARGET 7	7464.00	7026.79	415.11	3165745.34	1282871.33	40°06'30.074"N	104°54'26.752"W	point
TROUDT #3 TARGET 8	7464.00	8126.74	425.88	3165748.78	1283971.28	40°06'40.944"N	104°54'26.613"W	point
TROUDT #3 TARGET 9	7464.00	8526.72	429.80	3165750.03	1284371.26	40°06'44.896"N	104°54'26.562"W	point
TROUDT #3 TARGET 6	7473.00	5926.85	404.34	3165741.90	1281771.39	40°06'19.204"N	104°54'26.890"W	point
TROUDT #3 TARGET 5	7485.00	5026.89	395.53	3165739.09	1280871.43	40°06'10.311"N	104°54'27.004"W	point
TROUDT #3 TARGET 3	7501.00	3026.99	375.95	3165732.85	1278871.52	40°05'50.547"N	104°54'27.256"W	point
TROUDT #3 TARGET 4	7501.00	3926.94	384.76	3165735.66	1279771.47	40°05'59.441"N	104°54'27.143"W	point
TROUDT #3 EP ON PLAT (460'FSL & 660'FEL, SEC.32)	7520.00	-77.96	345.55	3165723.14	1275766.57	40°05'19.864"N	104°54'27.648"W	point



# Actual Wellpath Report

TROUDT #3 AWP

Page 9 of 10



## REFERENCE WELLPATH IDENTIFICATION

Operator	EXTRACTION OIL & GAS	Slot	SLOT#03 TROUDT #3 (537'FSL & 1007'FEL, SEC.32)
Area	COLORADO	Well	TROUDT #3
Field	WELD COUNTY (NAD83/TRUE NORTH)	Wellbore	TROUDT #3 AWB
Facility	SEC.32-T02N-R67W		

## TARGETS

Name	TVD [ft]	North [ft]	East [ft]	Grid East [US ft]	Grid North [US ft]	Latitude	Longitude	Shape
TROUDT #3 TARGET 1	7520.00	-72.86	345.60	3165723.16	1275771.67	40°05'19.914"N	104°54'27.647"W	point
TROUDT #3 TARGET 2	7520.00	1627.05	362.24	3165728.47	1277471.58	40°05'36.713"N	104°54'27.433"W	point
SEC.29/32-T02N-R67W HARDLINES (460'FNL/FSL)	7716.00	-0.40	55.96	3165433.05	1275842.19	40°05'20.630"N	104°54'31.374"W	polygon
EMERSON #2-29 J TARGET (500'RADIUS)	8207.00	8433.38	-262.07	3165058.83	1284273.32	40°06'43.974"N	104°54'35.467"W	circle
GUMESON #1 TARGET (500'RADIUS)	8231.00	3759.91	-26.27	3165325.77	1279601.71	40°05'57.790"N	104°54'32.432"W	circle
EMERSON #3-29 J TARGET (500'RADIUS)	8254.00	6075.70	-263.26	3165073.36	1281915.78	40°06'20.675"N	104°54'35.482"W	circle
HELLEN RUSSELL PERRIN G.U. TRUE#1 TARGET (500'RADIUS)	8262.00	8730.45	-2899.10	3162419.99	1284552.79	40°06'46.908"N	104°55'09.408"W	circle
HELEN RUSSEL PERRIN GU #1 TARGET (500'RADIUS)	8269.00	5648.49	-2563.78	3162775.83	1281473.27	40°06'16.452"N	104°55'05.088"W	circle
HALEY-GUMESON #2 TARGET (500'RADIUS)	8353.00	758.84	-248.47	3165123.58	1276599.36	40°05'28.133"N	104°54'35.291"W	circle

## WELLPATH COMPOSITION - Ref Wellbore: TROUDT #3 AWB Ref Wellpath: TROUDT #3 AWP

Start MD [ft]	End MD [ft]	Positional Uncertainty Model	Log Name/Comment	Wellbore
20.00	1488.00	ISCWSA MWD, Rev. 3 (Standard)	ENSECO MWD SURVEYS <158-1488>	TROUDT #3 AWB
1488.00	17318.00	NaviTrak (MagCorr)	BHI MWD/NAVITRAK (MAGCORR) 7.875" HOLE <1610-17318>	TROUDT #3 AWB
17318.00	17376.00	Blind Drilling (std)	Projection to bit	TROUDT #3 AWB



# Actual Wellpath Report

TROUDT #3 AWP

Page 10 of 10



## REFERENCE WELLPATH IDENTIFICATION

Operator	EXTRACTION OIL & GAS	Slot	SLOT#03 TROUDT #3 (537'FSL & 1007'FEL, SEC.32)
Area	COLORADO	Well	TROUDT #3
Field	WELD COUNTY (NAD83/TRUE NORTH)	Wellbore	TROUDT #3 AWB
Facility	SEC.32-T02N-R67W		

## WELLPATH COMMENTS

MD [ft]	Inclination [°]	Azimuth [°]	TVD [ft]	Comment
1488.00	1.400	58.500	1487.31	TIED ONTO ENSECO SURVEYS
1610.00	1.460	38.680	1609.27	FIRST BHI MWD SURVEY
7807.00	76.181	3.813	7481.00	CROSSED 460' SETBACK (466'FSL & 711'FEL, SEC.32)
8047.00	90.610	1.580	7517.47	LANDING POINT (705'FSL & 702'FEL, SEC.32)
17318.00	92.360	358.680	7482.40	LAST BHI MWD SURVEY (568'FNL & 672'FEL, SEC.29)
17376.00	92.360	358.680	7480.01	PROJECTION TO BIT (518'FNL & 673'FEL, SEC.29)