

EXTRACTION OIL & GAS

Location: COLORADO Slot: SLOT#01 TROUDT #1 (537'FSL & 951'FEL, SEC.32)
Field: WELD COUNTY (NAD83/TRUE NORTH) Well: TROUDT #1
Facility: SEC.32-T02N-R67W Wellbore: TROUDT #1 PWB

Plot reference wellpath is TROUDT #1 PWB (REV-C.0)

True vertical depths are referenced to SAVANNA 802 (20'KB) (RKB)	Grid System: NAD83 / Lambert Colorado SP, Northern Zone (501), US feet
Measured depths are referenced to SAVANNA 802 (20'KB) (RKB)	North Reference: True north
SAVANNA 802 (20'KB) (RKB) to Mean Sea Level: 5096 feet	Scale: True distance
Mean Sea Level to Mud line (At Slot: SLOT#01 TROUDT #1 (537'FSL & 951'FEL, SEC.32)): 0 feet	Depths are in feet
Coordinates are in feet referenced to Slot	Created by: ingmjmr on 9/18/2015

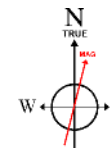

BGGM (1945.0 to 2017.0) Dip: 66.68° Field: 52420.7 nT
Magnetic North is 8.60 degrees East of True North (at 9/9/2015)

To correct azimuth from Magnetic to True add 8.60 degrees

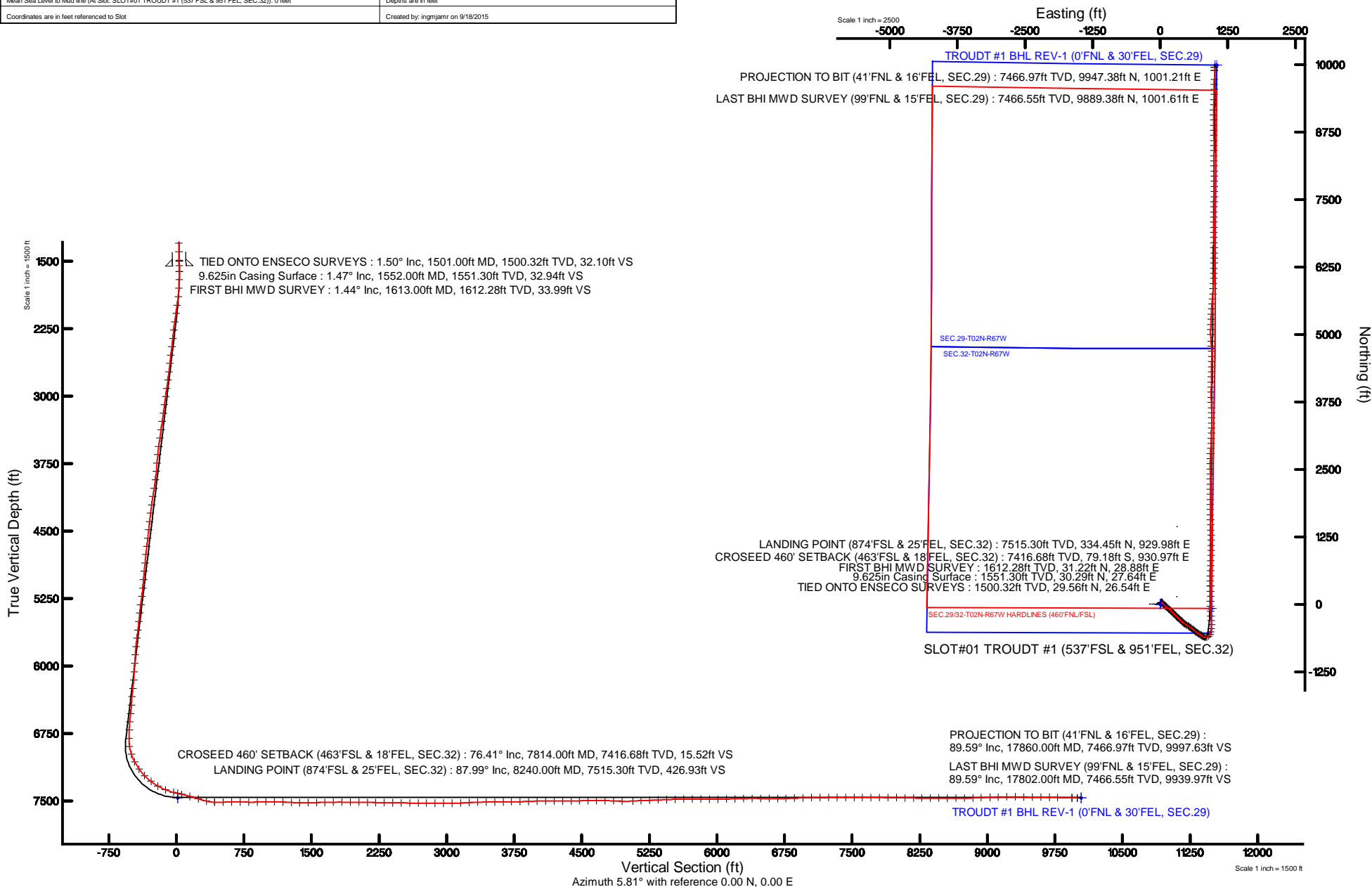



Actual Wellpath Report

TROUDT #1 AWP

Page 1 of 9



REFERENCE WELLPATH IDENTIFICATION

Operator	EXTRACTION OIL & GAS	Slot	SLOT#01 TROUDT #1 (537'FSL & 951'FEL, SEC.32)
Area	COLORADO	Well	TROUDT #1
Field	WELD COUNTY (NAD83/TRUE NORTH)	Wellbore	TROUDT #1 AWB
Facility	SEC.32-T02N-R67W		

REPORT SETUP INFORMATION

Projection System	NAD83 / Lambert Colorado SP, Northern Zone (501), US feet	Software System	WellArchitect® 4.1.1
North Reference	True	User	Ingmjmr
Scale	0.999961	Report Generated	9/18/2015 at 9:33:26 AM
Convergence at slot	0.38° East	Database/Source file	WA_DEN_Denver_Defn/TROUDT_#1_AWB.xml

WELLPATH LOCATION

	Local coordinates		Grid coordinates		Geographic coordinates	
	North[ft]	East[ft]	Easting[US ft]	Northing[US ft]	Latitude	Longitude
Slot Location	0.00	0.00	3165433.05	1275842.19	40°05'20.630"N	104°54'31.374"W
Facility Reference Pt			3165433.05	1275842.19	40°05'20.630"N	104°54'31.374"W
Field Reference Pt			3185481.27	1419166.81	40°28'55.560"N	104°49'59.556"W

WELLPATH DATUM

Calculation method	Minimum curvature	SAVANNA 802 (20'KB) (RKB) to Facility Vertical Datum	5096.00ft
Horizontal Reference Pt	Slot	SAVANNA 802 (20'KB) (RKB) to Mean Sea Level	5096.00ft
Vertical Reference Pt	SAVANNA 802 (20'KB) (RKB)	SAVANNA 802 (20'KB) (RKB) to Mud Line at Slot (SLOT#01 TROUDT #1 (537'FSL & 951'FEL, SEC.32))	5096.00ft
MD Reference Pt	SAVANNA 802 (20'KB) (RKB)	Section Origin	N 0.00, E 0.00 ft
Field Vertical Reference	Mean Sea Level	Section Azimuth	5.81°



Actual Wellpath Report

TROUDT #1 AWP

Page 2 of 9



REFERENCE WELLPATH IDENTIFICATION

Operator	EXTRACTION OIL & GAS	Slot	SLOT#01 TROUDT #1 (537'FSL & 951'FEL, SEC.32)
Area	COLORADO	Well	TROUDT #1
Field	WELD COUNTY (NAD83/TRUE NORTH)	Wellbore	TROUDT #1 AWP
Facility	SEC.32-T02N-R67W		

WELLPATH DATA (174 stations)

MD [ft]	Inclination [°]	Azimuth [°]	TVD [ft]	Vert Sect [ft]	North [ft]	East [ft]	DLS [°/100ft]	Comments
1501.00	1.500	58.000	1500.32	32.10	29.56	26.54	1.18	TIED ONTO ENSECO SURVEYS
1613.00	1.440	51.280	1612.28	33.99	31.22	28.88	0.16	FIRST BHI MWD SURVEY
1707.00	3.870	122.230	1706.19	33.40	30.27	32.49	3.90	
1801.00	7.300	122.520	1799.73	29.31	25.36	40.21	3.65	
1896.00	8.690	149.310	1893.84	20.82	15.94	48.96	4.14	
1991.00	12.130	137.560	1987.27	8.40	2.40	59.37	4.24	
2086.00	10.980	137.560	2080.34	-4.27	-11.64	72.21	1.21	
2180.00	13.600	132.120	2172.18	-16.77	-25.66	86.45	3.04	
2274.00	12.260	130.150	2263.80	-28.95	-39.51	102.28	1.50	
2369.00	10.360	127.160	2356.95	-39.08	-51.18	116.80	2.09	
2464.00	13.010	131.910	2449.98	-49.83	-63.48	131.56	2.97	
2558.00	11.440	128.850	2541.84	-61.14	-76.40	146.70	1.81	
2653.00	9.750	129.550	2635.22	-70.75	-87.43	160.24	1.78	
2748.00	12.380	136.130	2728.45	-81.81	-99.90	173.50	3.07	
2842.00	11.010	134.140	2820.50	-93.89	-113.41	186.93	1.52	
2937.00	13.620	133.730	2913.30	-106.40	-127.46	201.52	2.75	
3031.00	12.270	132.040	3004.91	-119.10	-141.80	216.94	1.49	
3125.00	10.660	133.230	3097.03	-130.29	-154.45	230.69	1.73	
3219.00	13.440	135.020	3188.95	-142.48	-168.13	244.75	2.98	
3313.00	12.110	136.590	3280.62	-155.82	-183.02	259.25	1.46	
3408.00	10.690	138.910	3373.75	-168.35	-196.90	271.89	1.57	
3502.00	14.030	134.170	3465.56	-181.38	-211.42	285.80	3.71	
3597.00	11.960	133.910	3558.12	-194.60	-226.27	301.15	2.18	
3692.00	9.370	135.180	3651.47	-205.58	-238.59	313.70	2.74	
3786.00	10.810	121.790	3744.03	-214.30	-248.66	326.58	2.92	
3880.00	9.270	124.690	3836.59	-221.82	-257.61	340.30	1.72	
3975.00	10.860	144.390	3930.15	-232.23	-269.25	351.81	3.97	
4070.00	14.220	133.710	4022.88	-246.11	-284.59	365.46	4.28	
4165.00	11.900	138.930	4115.42	-259.97	-300.04	380.33	2.74	
4260.00	13.220	132.310	4208.15	-273.13	-314.74	394.80	2.05	



Actual Wellpath Report

TROUDT #1 AWP

Page 3 of 9



REFERENCE WELLPATH IDENTIFICATION

Operator	EXTRACTION OIL & GAS	Slot	SLOT#01 TROUDT #1 (537'FSL & 951'FEL, SEC.32)
Area	COLORADO	Well	TROUDT #1
Field	WELD COUNTY (NAD83/TRUE NORTH)	Wellbore	TROUDT #1 AWP
Facility	SEC.32-T02N-R67W		

WELLPATH DATA (174 stations)

MD [ft]	Inclination [°]	Azimuth [°]	TVD [ft]	Vert Sect [ft]	North [ft]	East [ft]	DLS [°/100ft]	Comments
4354.00	11.450	132.390	4299.98	-285.08	-328.27	409.64	1.88	
4449.00	14.170	125.050	4392.61	-296.39	-341.30	426.13	3.33	
4544.00	11.150	124.750	4485.29	-306.51	-353.22	443.20	3.18	
4639.00	13.480	126.290	4578.10	-316.57	-365.01	459.68	2.48	
4734.00	11.670	126.800	4670.81	-327.14	-377.32	476.30	1.91	
4828.00	13.920	121.160	4762.48	-336.87	-388.87	493.59	2.74	
4922.00	13.460	121.340	4853.81	-346.43	-400.41	512.61	0.49	
5017.00	11.910	122.540	4946.49	-355.60	-411.43	530.31	1.65	
5113.00	9.790	124.340	5040.76	-363.96	-421.37	545.41	2.24	
5208.00	12.460	126.780	5133.97	-373.09	-432.06	560.29	2.85	
5303.00	11.250	125.650	5226.94	-382.97	-443.60	576.03	1.30	
5398.00	14.710	129.000	5319.50	-394.19	-456.60	592.93	3.73	
5493.00	12.430	128.110	5411.85	-406.25	-470.50	610.35	2.41	
5588.00	9.420	130.810	5505.11	-416.18	-481.89	624.29	3.21	
5683.00	11.620	131.530	5598.51	-426.22	-493.32	637.34	2.32	
5777.00	10.700	133.210	5690.73	-437.05	-505.57	650.78	1.04	
5872.00	12.290	123.780	5783.83	-447.15	-517.23	665.62	2.59	
5967.00	8.550	123.730	5877.25	-455.20	-526.78	679.90	3.94	
6061.00	9.260	116.520	5970.12	-461.15	-534.03	692.48	1.41	
6156.00	6.820	125.150	6064.18	-466.61	-540.70	703.93	2.86	
6250.00	10.260	124.100	6157.13	-473.32	-548.60	715.43	3.66	
6345.00	12.890	125.940	6250.19	-482.65	-559.57	731.02	2.80	
6440.00	10.140	121.340	6343.27	-491.57	-570.14	746.74	3.05	
6534.00	10.500	118.290	6435.75	-498.41	-578.50	761.35	0.70	
6629.00	12.620	125.440	6528.82	-506.85	-588.63	777.43	2.69	
6723.00	13.580	120.880	6620.37	-516.60	-600.24	795.27	1.50	
6818.00	10.340	110.390	6713.31	-523.48	-608.94	812.84	4.09	
6913.00	18.360	95.160	6805.30	-525.45	-613.27	835.78	9.26	
7007.00	21.730	75.820	6893.69	-519.33	-610.33	867.44	7.86	
7102.00	24.350	46.930	6981.38	-498.49	-592.59	898.90	12.10	



Actual Wellpath Report

TROUDT #1 AWP

Page 4 of 9



REFERENCE WELLPATH IDENTIFICATION

Operator	EXTRACTION OIL & GAS	Slot	SLOT#01 TROUDT #1 (537'FSL & 951'FEL, SEC.32)
Area	COLORADO	Well	TROUDT #1
Field	WELD COUNTY (NAD83/TRUE NORTH)	Wellbore	TROUDT #1 AWP
Facility	SEC.32-T02N-R67W		

WELLPATH DATA (174 stations) † = interpolated/extrapolated station

MD [ft]	Inclination [°]	Azimuth [°]	TVD [ft]	Vert Sect [ft]	North [ft]	East [ft]	DLS [°/100ft]	Comments
7197.00	29.180	24.670	7066.39	-461.71	-558.06	922.95	11.63	
7292.00	35.650	9.520	7146.68	-412.03	-509.58	937.23	10.89	
7387.00	43.400	5.600	7219.92	-351.66	-449.70	945.01	8.57	
7482.00	52.330	359.310	7283.62	-281.49	-379.44	947.75	10.60	
7576.00	59.800	356.220	7336.07	-204.35	-301.59	944.62	8.40	
7671.00	68.870	356.660	7377.17	-119.95	-216.21	939.32	9.56	
7766.00	76.490	355.880	7405.43	-30.59	-125.78	933.41	8.06	
7814.00†	76.410	358.113	7416.68	15.52	-79.18	930.97	4.52	CROSEED 460' SETBACK (463'FSL & 18'FEL, SEC.32)
7861.00	76.350	0.300	7427.75	60.89	-33.51	930.33	4.52	
7956.00	74.870	0.220	7451.36	152.48	58.50	930.75	1.56	
8050.00	73.470	0.290	7477.00	242.49	148.94	931.15	1.49	
8145.00	75.950	359.190	7502.05	333.60	240.56	930.73	2.84	
8240.00	87.990	359.880	7515.30	426.93	334.45	929.98	12.69	LANDING POINT (874'FSL & 25'FEL, SEC.32)
8334.00	92.800	359.670	7514.65	520.38	428.42	929.61	5.12	
8429.00	91.480	1.810	7511.10	614.94	523.34	930.84	2.65	
8524.00	87.750	0.970	7511.74	709.63	618.29	933.14	4.02	
8619.00	89.410	1.230	7514.09	804.28	713.24	934.96	1.77	
8713.00	91.200	1.450	7513.59	897.99	807.21	937.16	1.92	
8808.00	91.990	1.740	7510.95	992.69	902.14	939.80	0.89	
8903.00	88.510	0.950	7510.53	1087.39	997.10	942.03	3.76	
8998.00	87.780	0.170	7513.61	1181.94	1092.04	942.96	1.12	
9093.00	86.410	359.360	7518.42	1276.29	1186.91	942.57	1.67	
9186.00	89.900	358.520	7521.42	1368.55	1279.84	940.85	3.86	
9280.00	90.860	357.400	7520.79	1461.67	1373.77	937.51	1.57	
9375.00	91.160	356.930	7519.12	1555.57	1468.64	932.81	0.59	
9470.00	90.980	359.530	7517.35	1649.72	1563.57	929.88	2.74	
9564.00	91.970	358.700	7514.93	1743.04	1657.53	928.42	1.37	
9659.00	89.190	0.070	7513.96	1837.43	1752.50	927.41	3.26	
9754.00	90.210	359.160	7514.46	1931.87	1847.50	926.77	1.44	
9848.00	88.880	0.980	7515.21	2025.39	1941.49	926.88	2.40	



Actual Wellpath Report

TROUDT #1 AWP

Page 5 of 9



REFERENCE WELLPATH IDENTIFICATION

Operator	EXTRACTION OIL & GAS	Slot	SLOT#01 TROUDT #1 (537'FSL & 951'FEL, SEC.32)
Area	COLORADO	Well	TROUDT #1
Field	WELD COUNTY (NAD83/TRUE NORTH)	Wellbore	TROUDT #1 AWB
Facility	SEC.32-T02N-R67W		

WELLPATH DATA (174 stations)

MD [ft]	Inclination [°]	Azimuth [°]	TVD [ft]	Vert Sect [ft]	North [ft]	East [ft]	DLS [°/100ft]	Comments
9943.00	88.920	359.870	7517.03	2119.95	2036.47	927.59	1.17	
10037.00	88.200	359.410	7519.39	2213.37	2130.43	927.00	0.91	
10132.00	90.030	0.150	7520.86	2307.83	2225.42	926.63	2.08	
10227.00	89.470	0.250	7521.28	2402.38	2320.42	926.96	0.60	
10321.00	88.980	359.690	7522.55	2495.88	2414.41	926.91	0.79	
10416.00	88.240	358.820	7524.85	2590.23	2509.37	925.68	1.20	
10510.00	90.550	0.870	7525.84	2683.70	2603.35	925.43	3.29	
10605.00	89.530	0.830	7525.78	2778.34	2698.34	926.83	1.07	
10699.00	89.350	2.950	7526.70	2872.11	2792.28	929.93	2.26	
10794.00	90.770	3.270	7526.60	2967.00	2887.14	935.09	1.53	
10889.00	89.900	3.060	7526.04	3061.90	2981.99	940.33	0.94	
10983.00	92.610	2.500	7523.98	3155.74	3075.85	944.89	2.94	
11078.00	92.490	2.230	7519.76	3250.47	3170.67	948.81	0.31	
11173.00	92.240	1.500	7515.84	3345.16	3265.54	951.90	0.81	
11268.00	90.730	0.780	7513.37	3439.81	3360.49	953.79	1.76	
11363.00	90.400	0.350	7512.44	3534.41	3455.48	954.72	0.57	
11457.00	90.950	358.120	7511.33	3627.78	3549.46	953.47	2.44	
11551.00	89.960	356.900	7510.58	3720.79	3643.36	949.38	1.67	
11646.00	91.440	358.140	7509.42	3814.78	3738.26	945.27	2.03	
11741.00	92.150	358.060	7506.45	3908.88	3833.16	942.13	0.75	
11836.00	92.460	0.910	7502.63	4003.21	3928.07	941.27	3.02	
11930.00	89.230	1.510	7501.24	4096.88	4022.03	943.26	3.49	
12025.00	89.720	1.410	7502.11	4191.61	4116.99	945.68	0.53	
12120.00	89.960	0.790	7502.38	4286.28	4211.97	947.50	0.70	
12216.00	90.920	0.530	7501.64	4381.89	4307.96	948.61	1.04	
12310.00	91.720	359.960	7499.47	4475.42	4401.94	949.01	1.04	
12405.00	90.640	2.490	7497.52	4570.09	4496.88	951.04	2.90	
12500.00	89.900	0.690	7497.07	4664.82	4591.84	953.67	2.05	
12595.00	89.190	358.020	7497.82	4759.21	4686.82	952.61	2.91	
12690.00	87.840	355.610	7500.29	4853.00	4781.64	947.33	2.91	



Actual Wellpath Report

TROUDT #1 AWP

Page 6 of 9



REFERENCE WELLPATH IDENTIFICATION

Operator	EXTRACTION OIL & GAS	Slot	SLOT#01 TROUDT #1 (537'FSL & 951'FEL, SEC.32)
Area	COLORADO	Well	TROUDT #1
Field	WELD COUNTY (NAD83/TRUE NORTH)	Wellbore	TROUDT #1 AWP
Facility	SEC.32-T02N-R67W		

WELLPATH DATA (174 stations)

MD [ft]	Inclination [°]	Azimuth [°]	TVD [ft]	Vert Sect [ft]	North [ft]	East [ft]	DLS [°/100ft]	Comments
12784.00	87.710	355.680	7503.93	4945.45	4875.29	940.20	0.16	
12905.00	93.690	358.520	7502.46	5064.98	4996.06	934.08	5.47	
13000.00	92.180	1.910	7497.59	5159.39	5090.92	934.44	3.90	
13095.00	92.000	2.100	7494.13	5254.11	5185.80	937.76	0.28	
13190.00	92.300	1.950	7490.56	5348.84	5280.67	941.11	0.35	
13285.00	92.490	1.530	7486.59	5443.52	5375.55	943.99	0.48	
13380.00	91.840	5.010	7483.00	5538.34	5470.31	949.41	3.72	
13474.00	91.810	4.860	7480.01	5632.28	5563.91	957.49	0.16	
13569.00	89.160	5.030	7479.20	5727.26	5658.55	965.68	2.80	
13664.00	88.730	4.630	7480.95	5822.23	5753.19	973.68	0.62	
13759.00	89.750	3.440	7482.21	5917.17	5847.95	980.36	1.65	
13854.00	90.550	2.930	7481.97	6012.07	5942.80	985.64	1.00	
13949.00	91.570	2.240	7480.21	6106.90	6037.68	989.92	1.30	
14044.00	91.570	1.510	7477.61	6201.64	6132.60	993.03	0.77	
14138.00	91.750	1.050	7474.88	6295.31	6226.53	995.13	0.53	
14233.00	89.900	0.620	7473.51	6389.93	6321.51	996.51	2.00	
14328.00	89.410	0.330	7474.09	6484.52	6416.50	997.30	0.60	
14422.00	90.120	0.320	7474.47	6578.09	6510.50	997.83	0.76	
14517.00	89.190	359.140	7475.04	6672.55	6605.50	997.39	1.58	
14612.00	92.000	358.660	7474.06	6766.84	6700.46	995.56	3.00	
14707.00	92.400	357.950	7470.41	6860.96	6795.35	992.75	0.86	
14802.00	91.070	0.590	7467.53	6955.29	6890.29	991.55	3.11	
14897.00	91.750	359.740	7465.20	7049.79	6985.26	991.82	1.15	
14991.00	89.780	0.780	7463.94	7143.34	7079.24	992.25	2.37	
15086.00	90.360	0.810	7463.83	7237.97	7174.23	993.56	0.61	
15181.00	90.150	0.730	7463.40	7332.61	7269.22	994.84	0.24	
15275.00	89.960	0.980	7463.31	7426.25	7363.21	996.24	0.33	
15370.00	89.960	0.490	7463.38	7520.88	7458.20	997.46	0.52	
15465.00	90.700	359.870	7462.83	7615.42	7553.20	997.76	1.02	
15560.00	89.900	1.290	7462.33	7710.02	7648.19	998.72	1.72	



Actual Wellpath Report

TROUDT #1 AWP

Page 7 of 9



REFERENCE WELLPATH IDENTIFICATION

Operator	EXTRACTION OIL & GAS	Slot	SLOT#01 TROUDT #1 (537'FSL & 951'FEL, SEC.32)
Area	COLORADO	Well	TROUDT #1
Field	WELD COUNTY (NAD83/TRUE NORTH)	Wellbore	TROUDT #1 AWP
Facility	SEC.32-T02N-R67W		

WELLPATH DATA (174 stations)

MD [ft]	Inclination [°]	Azimuth [°]	TVD [ft]	Vert Sect [ft]	North [ft]	East [ft]	DLS [°/100ft]	Comments
15655.00	89.160	0.650	7463.11	7804.67	7743.17	1000.33	1.03	
15750.00	89.350	0.290	7464.35	7899.25	7838.16	1001.11	0.43	
15845.00	88.980	359.190	7465.73	7993.71	7933.15	1000.68	1.22	
15939.00	89.070	359.170	7467.33	8087.07	8027.13	999.33	0.10	
16033.00	89.230	357.750	7468.73	8180.28	8121.08	996.81	1.52	
16128.00	90.000	359.510	7469.37	8274.53	8216.05	994.54	2.02	
16223.00	89.660	359.820	7469.65	8368.98	8311.04	993.98	0.48	
16317.00	89.560	0.010	7470.29	8462.48	8405.04	993.84	0.23	
16412.00	89.530	0.290	7471.04	8557.01	8500.04	994.09	0.30	
16507.00	91.040	359.820	7470.57	8651.53	8595.03	994.18	1.66	
16602.00	89.750	357.900	7469.91	8745.82	8690.01	992.29	2.43	
16697.00	92.060	359.880	7468.41	8840.11	8784.97	990.45	3.20	
16791.00	92.090	359.910	7465.01	8933.54	8878.90	990.28	0.05	
16887.00	91.940	359.190	7461.63	9028.91	8974.84	989.53	0.77	
16980.00	92.400	358.900	7458.11	9121.20	9067.76	987.98	0.58	
17075.00	91.070	1.520	7455.24	9215.69	9162.71	988.33	3.09	
17171.00	88.360	2.460	7455.71	9311.47	9258.64	991.66	2.99	
17266.00	88.150	2.050	7458.61	9406.24	9353.52	995.39	0.48	
17360.00	90.030	0.980	7460.10	9499.96	9447.47	997.88	2.30	
17455.00	89.630	0.650	7460.38	9594.59	9542.46	999.23	0.55	
17549.00	89.350	0.480	7461.22	9688.20	9636.45	1000.16	0.35	
17641.00	88.080	0.730	7463.28	9779.79	9728.42	1001.13	1.41	
17802.00	89.590	359.610	7466.55	9939.97	9889.38	1001.61	1.17	LAST BHI MWD SURVEY (99'FNL & 15'FEL, SEC.29)
17860.00	89.590	359.610	7466.97	9997.63	9947.38	1001.21	0.00	PROJECTION TO BIT (41'FNL & 16'FEL, SEC.29)



Actual Wellpath Report

TROUDT #1 AWP

Page 8 of 9



REFERENCE WELLPATH IDENTIFICATION

Operator	EXTRACTION OIL & GAS	Slot	SLOT#01 TROUDT #1 (537'FSL & 951'FEL, SEC.32)
Area	COLORADO	Well	TROUDT #1
Field	WELD COUNTY (NAD83/TRUE NORTH)	Wellbore	TROUDT #1 AWB
Facility	SEC.32-T02N-R67W		

HOLE & CASING SECTIONS - Ref Wellbore: TROUDT #1 AWB Ref Wellpath: TROUDT #1 AWP

String/Diameter	Start MD [ft]	End MD [ft]	Interval [ft]	Start TVD [ft]	End TVD [ft]	Start N/S [ft]	Start E/W [ft]	End N/S [ft]	End E/W [ft]
9.625in Casing Surface	20.00	1552.00	1532.00	20.00	1551.30	0.00	0.00	30.29	27.64
7.875in Open Hole	1552.00	17865.00	16313.00	1551.30	N/A	30.29	27.64	N/A	N/A
5.5in Casing Production	20.00	17865.00	17845.00	20.00	N/A	0.00	0.00	N/A	N/A

TARGETS

Name	TVD [ft]	North [ft]	East [ft]	Grid East [US ft]	Grid North [US ft]	Latitude	Longitude	Shape
SEC.29-T02N-R67W	5.00	0.00	0.00	3165433.05	1275842.19	40°05'20.630"N	104°54'31.374"W	polygon
SEC.32-T02N-R67W	5.00	0.00	0.00	3165433.05	1275842.19	40°05'20.630"N	104°54'31.374"W	polygon
TROUDT #1 BHL ON PLAT (0'FNL & 0'FEL, SEC.29)	7467.00	9988.62	1047.43	3166413.81	1285837.15	40°06'59.339"N	104°54'17.892"W	point
TROUDT #1 BHL REV-1 (0'FNL & 30'FEL, SEC.29)	7467.00	9988.64	1017.00	3166383.39	1285836.97	40°06'59.339"N	104°54'18.284"W	point
TROUDT #1 EP ON PLAT (460'FSL & 0'FEL, SEC.32)	7467.00	-80.09	949.64	3166383.17	1275768.44	40°05'19.838"N	104°54'19.156"W	point
TROUDT #1 EP REV-1 (460'FSL & 30'FEL, SEC.32)	7467.00	-80.13	919.00	3166352.53	1275768.19	40°05'19.838"N	104°54'19.550"W	point
SEC.29/32-T02N-R67W HARDLINES (460'FNL/FSL)	7715.00	0.00	0.00	3165433.05	1275842.19	40°05'20.630"N	104°54'31.374"W	polygon
EMERSON #2-29 J TARGET (500'RADIUS)	8206.00	8433.79	-318.01	3165058.83	1284273.32	40°06'43.974"N	104°54'35.467"W	circle
GUMESON #1 TARGET (500'RADIUS)	8230.00	3760.31	-82.22	3165325.77	1279601.71	40°05'57.790"N	104°54'32.432"W	circle
EMERSON #3-29 J TARGET (500'RADIUS)	8253.00	6076.10	-319.20	3165073.36	1281915.78	40°06'20.675"N	104°54'35.482"W	circle
HELLEN RUSSELL PERRIN G.U. TRUE#1 TARGET (500'RADIUS)	8261.00	8730.86	-2955.04	3162419.99	1284552.79	40°06'46.908"N	104°55'09.408"W	circle
HELEN RUSSEL PERRIN GU #1 TARGET (500'RADIUS)	8268.00	5648.90	-2619.72	3162775.83	1281473.27	40°06'16.452"N	104°55'05.088"W	circle

TARGETS

Name	TVD [ft]	North [ft]	East [ft]	Grid East [US ft]	Grid North [US ft]	Latitude	Longitude	Shape
HALEY-GUMESON #2 TARGET (500'RADIUS)	8352.00	759.25	-304.43	3165123.58	1276599.36	40°05'28.133"N	104°54'35.291"W	circle

WELLPATH COMPOSITION - Ref Wellbore: TROUDT #1 AWB Ref Wellpath: TROUDT #1 AWP

Start MD [ft]	End MD [ft]	Positional Uncertainty Model	Log Name/Comment	Wellbore
---------------	-------------	------------------------------	------------------	----------

20.00	1501.00	ISCWSA MWD, Rev. 3 (Standard)	ENSECO DIRECTIONAL SURVEYS <158-1501>	TROUDT #1 AWB
1501.00	17802.00	NaviTrak (MagCorr)	BHI MWD/NAVITRAK (MAGCORR) 7.785" HOLE <1613-17802>	TROUDT #1 AWB
17802.00	17860.00	Blind Drilling (std)	Projection to bit	TROUDT #1 AWB



Actual Wellpath Report

TROUDT #1 AWP

Page 9 of 9



REFERENCE WELLPATH IDENTIFICATION

Operator	EXTRACTION OIL & GAS	Slot	SLOT#01 TROUDT #1 (537'FSL & 951'FEL, SEC.32)
Area	COLORADO	Well	TROUDT #1
Field	WELD COUNTY (NAD83/TRUE NORTH)	Wellbore	TROUDT #1 AWP
Facility	SEC.32-T02N-R67W		

WELLPATH COMMENTS

MD [ft]	Inclination [°]	Azimuth [°]	TVD [ft]	Comment
1501.00	1.500	58.000	1500.32	TIED ONTO ENSECO SURVEYS
1613.00	1.440	51.280	1612.28	FIRST BHI MWD SURVEY
7814.00	76.410	358.113	7416.68	CROSEED 460' SETBACK (463'FSL & 18'FEL, SEC.32)
8240.00	87.990	359.880	7515.30	LANDING POINT (874'FSL & 25'FEL, SEC.32)
17802.00	89.590	359.610	7466.55	LAST BHI MWD SURVEY (99'FNL & 15'FEL, SEC.29)
17860.00	89.590	359.610	7466.97	PROJECTION TO BIT (41'FNL & 16'FEL, SEC.29)