

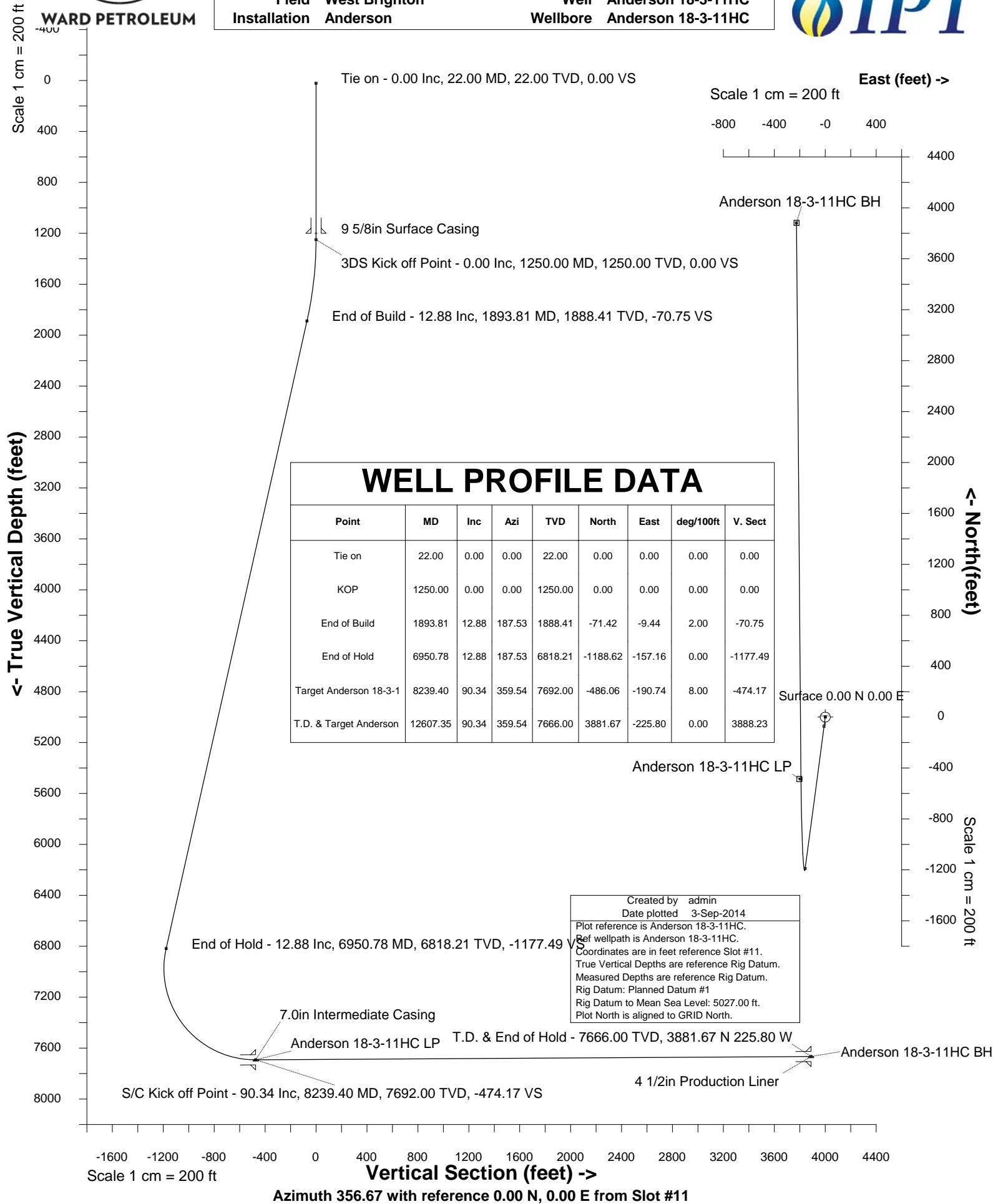

WARD PETROLEUM

# WARD PETROLEUM

Location	ADAMS COUNTY, CO	Slot	Slot #11
Field	West Brighton	Well	Anderson 18-3-11HC
Installation	Anderson	Wellbore	Anderson 18-3-11HC





**WARD PETROLEUM**

INTEGRATED PETROLEUM TECHNOLOGIES, INC  
SYSDRILL  
Well Design Combined Report  
Wellbore: Anderson 18-3-11HC



Wellhead Details							
Name	Northing	Easting	Latitude	Longitude	North	East	Elevation Above Inst.
Slot #11	1229147.7104	3189514.3575	39.96041000	-104.82392000	11.44S	67.19W	-0.00

Declination			
Date	Source	Time	
28-Aug-2014	IGRF Model [1900.0-2015.0]	10:16	

Site Details				
Name	Northing	Easting	Coord System Name	North Alignment
Anderson	1229159.1513	3189581.5481	CO83-NF on NORTH AMERICAN DATUM 1983 datum	Grid

Summary Wellpath									
MD[ft]	Inc[deg]	Azi[deg]	TVD[ft]	North[ft]	East[ft]	Dogleg [deg/100ft]	Vertical Section[ft]	Northing	Easting
22.00	0.00	0.000	22.00	0.00N	0.00E		0.00	1229147.71	3189514.36
1250.00	0.00	0.000	1250.00	0.00N	0.00E	==>	0.00	1229147.71	3189514.36
1893.81	12.88	187.530	1888.41	71.42S	9.44W	2.00	-70.75	1229076.30	3189504.91
6950.78	12.88	187.530	6818.21	1188.62S	157.16W	==>	-1177.49	1227959.13	3189357.20
8239.40	90.34	359.540	7692.00	486.06S	190.74W	8.00	-474.17	1228661.66	3189323.62
12607.35	90.34	359.540	7666.00	3881.67N	225.80W	==>	3888.23	1233029.25	3189288.57

Interpolated Wellpath									
MD[ft]	Inc[deg]	Azi[deg]	TVD[ft]	North[ft]	East[ft]	Dogleg [deg/100ft]	Vertical Section[ft]	Northing	Easting
0.00	0.00	0.000	0.00	0.00N	0.00E		0.00	1229147.71	3189514.36
22.00	0.00	0.000	22.00	0.00N	0.00E	==>	0.00	1229147.71	3189514.36
100.00	0.00	0.000	100.00	0.00N	0.00E	==>	0.00	1229147.71	3189514.36
200.00	0.00	0.000	200.00	0.00N	0.00E	==>	0.00	1229147.71	3189514.36
300.00	0.00	0.000	300.00	0.00N	0.00E	==>	0.00	1229147.71	3189514.36
400.00	0.00	0.000	400.00	0.00N	0.00E	==>	0.00	1229147.71	3189514.36
500.00	0.00	0.000	500.00	0.00N	0.00E	==>	0.00	1229147.71	3189514.36
600.00	0.00	0.000	600.00	0.00N	0.00E	==>	0.00	1229147.71	3189514.36
700.00	0.00	0.000	700.00	0.00N	0.00E	==>	0.00	1229147.71	3189514.36
800.00	0.00	0.000	800.00	0.00N	0.00E	==>	0.00	1229147.71	3189514.36
900.00	0.00	0.000	900.00	0.00N	0.00E	==>	0.00	1229147.71	3189514.36
1000.00	0.00	0.000	1000.00	0.00N	0.00E	==>	0.00	1229147.71	3189514.36
1100.00	0.00	0.000	1100.00	0.00N	0.00E	==>	0.00	1229147.71	3189514.36
1200.00	0.00	0.000	1200.00	0.00N	0.00E	==>	0.00	1229147.71	3189514.36
1228.00	0.00	0.000	1228.00	0.00N	0.00E	==>	0.00	1229147.71	3189514.36
1250.00	0.00	0.000	1250.00	0.00N	0.00E	==>	0.00	1229147.71	3189514.36
1328.00	1.56	187.530	1327.99	1.05S	0.14W	2.00	-1.04	1229146.66	3189514.22
1428.00	3.56	187.530	1427.89	5.48S	0.72W	2.00	-5.43	1229142.23	3189513.63
1528.00	5.56	187.530	1527.56	13.36S	1.77W	2.00	-13.24	1229134.35	3189512.59
1628.00	7.56	187.530	1626.90	24.69S	3.26W	2.00	-24.46	1229123.02	3189511.09
1728.00	9.56	187.530	1725.79	39.44S	5.22W	2.00	-39.07	1229108.27	3189509.14
1828.00	11.56	187.530	1824.09	57.61S	7.62W	2.00	-57.07	1229090.10	3189506.74
1893.81	12.88	187.530	1888.41	71.42S	9.44W	2.00	-70.75	1229076.30	3189504.91
1900.00	12.88	187.530	1894.44	72.78S	9.62W	==>	-72.10	1229074.93	3189504.73
2000.00	12.88	187.530	1991.92	94.88S	12.54W	==>	-93.99	1229052.84	3189501.81
2100.00	12.88	187.530	2089.41	116.97S	15.47W	==>	-115.87	1229030.75	3189498.89
2200.00	12.88	187.530	2186.89	139.06S	18.39W	==>	-137.76	1229008.65	3189495.97
2300.00	12.88	187.530	2284.38	161.15S	21.31W	==>	-159.64	1228986.56	3189493.05
2400.00	12.88	187.530	2381.87	183.25S	24.23W	==>	-181.53	1228964.47	3189490.13
2500.00	12.88	187.530	2479.35	205.34S	27.15W	==>	-203.42	1228942.38	3189487.21
2600.00	12.88	187.530	2576.84	227.43S	30.07W	==>	-225.30	1228920.29	3189484.29
2700.00	12.88	187.530	2674.32	249.52S	32.99W	==>	-247.19	1228898.20	3189481.37
2800.00	12.88	187.530	2771.81	271.62S	35.91W	==>	-269.07	1228876.10	3189478.44
2900.00	12.88	187.530	2869.29	293.71S	38.84W	==>	-290.96	1228854.01	3189475.52
3000.00	12.88	187.530	2966.78	315.80S	41.76W	==>	-312.84	1228831.92	3189472.60
3100.00	12.88	187.530	3064.26	337.89S	44.68W	==>	-334.73	1228809.83	3189469.68

All data is in Feet unless otherwise stated  
Coordinates are from Slot MD's are from Rig and TVD's are from Rig ( Planned Datum #1 5027.0ft above Mean Sea Level )  
Vertical Section is from 0.00N 0.00E on azimuth 356.670 degrees  
Bottom hole distance is 3888.23 Feet on azimuth 356.67 degrees from Wellhead  
Calculation method uses Minimum Curvature method  
Prepared by Integrated Petroleum Technologies, Inc.  
Date Printed: 3-Sep-2014



INTEGRATED PETROLEUM TECHNOLOGIES, INC  
SYSDRILL

Well Design Combined Report  
Wellbore: Anderson 18-3-11HC



WARD PETROLEUM

Interpolated Wellpath									
MD[ft]	Inc[deg]	Azi[deg]	TVD[ft]	North[ft]	East[ft]	Dogleg [deg/100ft]	Vertical Section[ft]	Northing	Easting
3200.00	12.88	187.530	3161.75	359.98S	47.60W	==>	-356.61	1228787.74	3189466.76
3300.00	12.88	187.530	3259.23	382.08S	50.52W	==>	-378.50	1228765.65	3189463.84
3400.00	12.88	187.530	3356.72	404.17S	53.44W	==>	-400.38	1228743.55	3189460.92
3500.00	12.88	187.530	3454.20	426.26S	56.36W	==>	-422.27	1228721.46	3189458.00
3600.00	12.88	187.530	3551.69	448.35S	59.28W	==>	-444.15	1228699.37	3189455.08
3700.00	12.88	187.530	3649.18	470.45S	62.20W	==>	-466.04	1228677.28	3189452.16
3800.00	12.88	187.530	3746.66	492.54S	65.13W	==>	-487.93	1228655.19	3189449.23
3900.00	12.88	187.530	3844.15	514.63S	68.05W	==>	-509.81	1228633.10	3189446.31
4000.00	12.88	187.530	3941.63	536.72S	70.97W	==>	-531.70	1228611.00	3189443.39
4100.00	12.88	187.530	4039.12	558.82S	73.89W	==>	-553.58	1228588.91	3189440.47
4200.00	12.88	187.530	4136.60	580.91S	76.81W	==>	-575.47	1228566.82	3189437.55
4300.00	12.88	187.530	4234.09	603.00S	79.73W	==>	-597.35	1228544.73	3189434.63
4400.00	12.88	187.530	4331.57	625.09S	82.65W	==>	-619.24	1228522.64	3189431.71
4500.00	12.88	187.530	4429.06	647.18S	85.57W	==>	-641.12	1228500.55	3189428.79
4600.00	12.88	187.530	4526.54	669.28S	88.49W	==>	-663.01	1228478.46	3189425.87
4700.00	12.88	187.530	4624.03	691.37S	91.42W	==>	-684.89	1228456.36	3189422.95
4800.00	12.88	187.530	4721.51	713.46S	94.34W	==>	-706.78	1228434.27	3189420.02
4900.00	12.88	187.530	4819.00	735.55S	97.26W	==>	-728.66	1228412.18	3189417.10
5000.00	12.88	187.530	4916.49	757.65S	100.18W	==>	-750.55	1228390.09	3189414.18
5100.00	12.88	187.530	5013.97	779.74S	103.10W	==>	-772.44	1228368.00	3189411.26
5200.00	12.88	187.530	5111.46	801.83S	106.02W	==>	-794.32	1228345.91	3189408.34
5300.00	12.88	187.530	5208.94	823.92S	108.94W	==>	-816.21	1228323.81	3189405.42
5400.00	12.88	187.530	5306.43	846.02S	111.86W	==>	-838.09	1228301.72	3189402.50
5500.00	12.88	187.530	5403.91	868.11S	114.78W	==>	-859.98	1228279.63	3189399.58
5600.00	12.88	187.530	5501.40	890.20S	117.71W	==>	-881.86	1228257.54	3189396.66
5700.00	12.88	187.530	5598.88	912.29S	120.63W	==>	-903.75	1228235.45	3189393.73
5800.00	12.88	187.530	5696.37	934.38S	123.55W	==>	-925.63	1228213.36	3189390.81
5900.00	12.88	187.530	5793.85	956.48S	126.47W	==>	-947.52	1228191.26	3189387.89
6000.00	12.88	187.530	5891.34	978.57S	129.39W	==>	-969.40	1228169.17	3189384.97
6100.00	12.88	187.530	5988.82	1000.66S	132.31W	==>	-991.29	1228147.08	3189382.05
6200.00	12.88	187.530	6086.31	1022.75S	135.23W	==>	-1013.17	1228124.99	3189379.13
6300.00	12.88	187.530	6183.79	1044.85S	138.15W	==>	-1035.06	1228102.90	3189376.21
6400.00	12.88	187.530	6281.28	1066.94S	141.07W	==>	-1056.95	1228080.81	3189373.29
6500.00	12.88	187.530	6378.77	1089.03S	144.00W	==>	-1078.83	1228058.71	3189370.37
6600.00	12.88	187.530	6476.25	1111.12S	146.92W	==>	-1100.72	1228036.62	3189367.45
6700.00	12.88	187.530	6573.74	1133.22S	149.84W	==>	-1122.60	1228014.53	3189364.52
6800.00	12.88	187.530	6671.22	1155.31S	152.76W	==>	-1144.49	1227992.44	3189361.60
6900.00	12.88	187.530	6768.71	1177.40S	155.68W	==>	-1166.37	1227970.35	3189358.68
6950.78	12.88	187.530	6818.21	1188.62S	157.16W	==>	-1177.49	1227959.13	3189357.20
7000.00	9.00	191.130	6866.53	1197.84S	158.63W	8.00	-1186.60	1227949.91	3189355.74
7100.00	2.00	245.540	6966.04	1206.24S	161.72W	8.00	-1194.81	1227941.51	3189352.64
7200.00	7.42	345.370	7065.76	1200.71S	164.94W	8.00	-1189.10	1227947.04	3189349.42
7300.00	15.30	352.850	7163.73	1181.35S	168.22W	8.00	-1169.58	1227966.40	3189346.14
7400.00	23.26	355.280	7258.05	1148.53S	171.49W	8.00	-1136.63	1227999.22	3189342.87
7500.00	31.24	356.520	7346.88	1102.90S	174.69W	8.00	-1090.89	1228044.85	3189339.67
7600.00	39.22	357.290	7428.50	1045.34S	177.76W	8.00	-1033.26	1228102.40	3189336.60
7700.00	47.22	357.840	7501.31	976.98S	180.64W	8.00	-964.84	1228170.76	3189333.72
7800.00	55.21	358.260	7563.91	899.14S	183.27W	8.00	-886.98	1228248.60	3189331.09
7900.00	63.20	358.610	7615.06	813.34S	185.61W	8.00	-801.19	1228334.40	3189328.76
8000.00	71.20	358.910	7653.78	721.25S	187.60W	8.00	-709.14	1228426.48	3189326.77
8100.00	79.19	359.180	7679.31	624.66S	189.20W	8.00	-612.62	1228523.07	3189325.16
8200.00	87.19	359.440	7691.15	525.45S	190.39W	8.00	-513.51	1228622.27	3189323.97
8239.40	90.34	359.540	7692.00	486.06S	190.74W	8.00	-474.17	1228661.66	3189323.62
8300.00	90.34	359.540	7691.64	425.47S	191.23W	==>	-413.65	1228722.25	3189323.13
8400.00	90.34	359.540	7691.04	325.48S	192.03W	==>	-313.78	1228822.24	3189322.33
8500.00	90.34	359.540	7690.45	225.48S	192.84W	==>	-213.90	1228922.24	3189321.53
8600.00	90.34	359.540	7689.85	125.49S	193.64W	==>	-114.03	1229022.23	3189320.73
8700.00	90.34	359.540	7689.26	25.49S	194.44W	==>	-14.16	1229122.22	3189319.92
8800.00	90.34	359.540	7688.66	74.50N	195.24W	==>	85.71	1229222.21	3189319.12
8900.00	90.34	359.540	7688.07	174.50N	196.05W	==>	185.59	1229322.20	3189318.32

All data is in Feet unless otherwise stated  
Coordinates are from Slot MD's are from Rig and TVD's are from Rig ( Planned Datum #1 5027.0ft above Mean Sea Level )  
Vertical Section is from 0.00N 0.00E on azimuth 356.670 degrees  
Bottom hole distance is 3888.23 Feet on azimuth 356.67 degrees from Wellhead  
Calculation method uses Minimum Curvature method  
Prepared by Integrated Petroleum Technologies, Inc.  
Date Printed: 3-Sep-2014



## WARD PETROLEUM

### INTEGRATED PETROLEUM TECHNOLOGIES, INC SYSDRILL

Well Design Combined Report  
Wellbore: Anderson 18-3-11HC



Interpolated Wellpath									
MD[ft]	Inc[deg]	Azi[deg]	TVD[ft]	North[ft]	East[ft]	Dogleg [deg/100ft]	Vertical Section[ft]	Northing	Easting
9000.00	90.34	359.540	7687.47	274.49N	196.85W	==>	285.46	1229422.19	3189317.52
9100.00	90.34	359.540	7686.88	374.49N	197.65W	==>	385.33	1229522.19	3189316.71
9200.00	90.34	359.540	7686.28	474.48N	198.45W	==>	485.21	1229622.18	3189315.91
9300.00	90.34	359.540	7685.69	574.48N	199.26W	==>	585.08	1229722.17	3189315.11
9400.00	90.34	359.540	7685.09	674.47N	200.06W	==>	684.95	1229822.16	3189314.31
9500.00	90.34	359.540	7684.50	774.47N	200.86W	==>	784.82	1229922.15	3189313.50
9600.00	90.34	359.540	7683.90	874.46N	201.66W	==>	884.70	1230022.14	3189312.70
9700.00	90.34	359.540	7683.31	974.46N	202.47W	==>	984.57	1230122.14	3189311.90
9800.00	90.34	359.540	7682.71	1074.45N	203.27W	==>	1084.44	1230222.13	3189311.10
9900.00	90.34	359.540	7682.12	1174.45N	204.07W	==>	1184.32	1230322.12	3189310.29
10000.00	90.34	359.540	7681.52	1274.44N	204.87W	==>	1284.19	1230422.11	3189309.49
10100.00	90.34	359.540	7680.92	1374.44N	205.68W	==>	1384.06	1230522.10	3189308.69
10200.00	90.34	359.540	7680.33	1474.43N	206.48W	==>	1483.93	1230622.10	3189307.89
10300.00	90.34	359.540	7679.73	1574.43N	207.28W	==>	1583.81	1230722.09	3189307.08
10400.00	90.34	359.540	7679.14	1674.42N	208.08W	==>	1683.68	1230822.08	3189306.28
10500.00	90.34	359.540	7678.54	1774.42N	208.89W	==>	1783.55	1230922.07	3189305.48
10600.00	90.34	359.540	7677.95	1874.41N	209.69W	==>	1883.43	1231022.06	3189304.68
10700.00	90.34	359.540	7677.35	1974.41N	210.49W	==>	1983.30	1231122.05	3189303.87
10800.00	90.34	359.540	7676.76	2074.40N	211.29W	==>	2083.17	1231222.05	3189303.07
10900.00	90.34	359.540	7676.16	2174.40N	212.10W	==>	2183.04	1231322.04	3189302.27
11000.00	90.34	359.540	7675.57	2274.39N	212.90W	==>	2282.92	1231422.03	3189301.47
11100.00	90.34	359.540	7674.97	2374.39N	213.70W	==>	2382.79	1231522.02	3189300.66
11200.00	90.34	359.540	7674.38	2474.38N	214.50W	==>	2482.66	1231622.01	3189299.86
11300.00	90.34	359.540	7673.78	2574.38N	215.31W	==>	2582.54	1231722.00	3189299.06
11400.00	90.34	359.540	7673.19	2674.37N	216.11W	==>	2682.41	1231822.00	3189298.26
11500.00	90.34	359.540	7672.59	2774.37N	216.91W	==>	2782.28	1231921.99	3189297.45
11600.00	90.34	359.540	7672.00	2874.36N	217.71W	==>	2882.15	1232021.98	3189296.65
11700.00	90.34	359.540	7671.40	2974.36N	218.52W	==>	2982.03	1232121.97	3189295.85
11800.00	90.34	359.540	7670.81	3074.35N	219.32W	==>	3081.90	1232221.96	3189295.05
11900.00	90.34	359.540	7670.21	3174.35N	220.12W	==>	3181.77	1232321.96	3189294.24
12000.00	90.34	359.540	7669.62	3274.34N	220.92W	==>	3281.65	1232421.95	3189293.44
12100.00	90.34	359.540	7669.02	3374.34N	221.73W	==>	3381.52	1232521.94	3189292.64
12200.00	90.34	359.540	7668.42	3474.33N	222.53W	==>	3481.39	1232621.93	3189291.84
12300.00	90.34	359.540	7667.83	3574.33N	223.33W	==>	3581.26	1232721.92	3189291.03
12400.00	90.34	359.540	7667.23	3674.32N	224.13W	==>	3681.14	1232821.91	3189290.23
12500.00	90.34	359.540	7666.64	3774.32N	224.94W	==>	3781.01	1232921.91	3189289.43
12600.00	90.34	359.540	7666.04	3874.31N	225.74W	==>	3880.88	1233021.90	3189288.63
12607.35	90.34	359.540	7666.00	3881.67N	225.80W	==>	3888.23	1233029.25	3189288.57

All data is in Feet unless otherwise stated  
Coordinates are from Slot MD's are from Rig and TVD's are from Rig ( Planned Datum #1 5027.0ft above Mean Sea Level )  
Vertical Section is from 0.00N 0.00E on azimuth 356.670 degrees  
Bottom hole distance is 3888.23 Feet on azimuth 356.67 degrees from Wellhead  
Calculation method uses Minimum Curvature method  
Prepared by Integrated Petroleum Technologies, Inc.  
Date Printed: 3-Sep-2014



**WARD PETROLEUM**

INTEGRATED PETROLEUM TECHNOLOGIES, INC

SYSDRILL

Well Design Combined Report

Wellbore: Anderson 18-3-11HC



### Hole Sections

Diameter [in]	Start MD[ft]	Start TVD[ft]	Start North[ft]	Start East[ft]	End MD[ft]	End TVD[ft]	End North[ft]	End East[ft]
13 1/2	22.00	22.00	0.00N	0.00E	1200.00	1200.00	0.00N	0.00E
8 3/4	1200.00	1200.00	0.00N	0.00E	8239.00	7692.00	486.47S	190.74W
6 1/8	8239.00	7692.00	486.47S	190.74W	12607.35	7666.00	3881.67N	225.80W

### Casings

Name	Top MD[ft]	Top TVD[ft]	Top North[ft]	Top East[ft]	Shoe MD[ft]	Shoe TVD[ft]	Shoe North[ft]	Shoe East[ft]
9 5/8in Surface Casing	22.00	22.00	0.00N	0.00E	1200.00	1200.00	0.00N	0.00E
7.0in Intermediate Casing	22.00	22.00	0.00N	0.00E	8239.00	7692.00	486.47S	190.74W
4 1/2in Production Liner	8039.00	7665.34	684.01S	188.27W	12607.35	7666.00	3881.67N	225.80W

### Targets

Name	North[ft]	East[ft]	TVD[ft]	Latitude	Longitude	Northing	Easting	Last Revised
Anderson 18-3-11HC BH	3881.67N	225.80W	7666.00	39.97107000	-104.82462000	1233029.25	3189288.57	28-Aug-2014
Anderson 18-3-11HC LP	486.06S	203.74W	7692.00	39.95908000	-104.82466000	1228661.66	3189310.62	28-Aug-2014

### Survey Tool Program

Reference	Survey Name	MD[ft]	TVD[ft]	Survey Tool	Error Model
299655	Planned	12607.35	7666.00	WdW Rate Gyro	Standard

### Notes

All data is in Feet unless otherwise stated  
Coordinates are from Slot MD's are from Rig and TVD's are from Rig ( Planned Datum #1 5027.0ft above Mean Sea Level )  
Vertical Section is from 0.00N 0.00E on azimuth 356.670 degrees  
Bottom hole distance is 3888.23 Feet on azimuth 356.67 degrees from Wellhead  
Calculation method uses Minimum Curvature method  
Prepared by Integrated Petroleum Technologies, Inc.  
Date Printed: 3-Sep-2014



SYSDRILL  
Closest Approach + Clearance Factor Summary Report  
Wellbore: Anderson 18-3-11HC



Ellipse separations are reported ONLY if BOTH wells have uncertainty data  
Only Depth and Magnetic Reference Field error terms are correlated across tie points  
Proximities beyond 2000.00ft with expansion rate of 0.00ft/1000ft are not reported  
Scan limit is calculated on CENTRE to CENTRE distance

Summary data uses Closest Approach clearance calculation for all minima  
Hole size/Casings ARE included  
Hole size/Casings are NOT subtracted from Centre-Centre distance  
Confidence limit of 95.00% / 2.80 SD.

Wellbore		
Name	Created	Last Revised
Anderson 18-3-11HC	28-Aug-2014	3-Sep-2014

Well		
Name	Government ID	Last Revised
Anderson 18-3-11HC		29-Aug-2014

Slot						
Name	Grid Northing	Grid Easting	Latitude	Longitude	North	East
Slot #11	1229147.7104	3189514.3575	39.96041000	-104.82392000	11.44S	67.19W

Installation				
Name	Easting	Northing	Coord System Name	North Alignment
Anderson	3189581.5481	1229159.1513	CO83-NF on NORTH AMERICAN DATUM 1983 datum	Grid

Field				
Name	Easting	Northing	Coord System Name	North Alignment
West Brighton	3178196.4983	1231661.3262	CO83-NF on NORTH AMERICAN DATUM 1983 datum	Grid

Clearance Summary								
Offset Wellbore	Offset Structure	Separation [ft]	MD[ft]	Diverging From[ft]	Ellipse Separation [ft]	Ellipse MD[ft]	Clearance Factor	Clearance MD[ft]
Anderson 19-1-11HN	Anderson	12.28	1252.31	7569.05	9.44	1186.70	1.53	7567.93
Anderson 19-1-12HC	Anderson	13.79	1252.31	7755.83	10.95	1186.70	4.85	1186.70
Anderson 18-3-10HN	Anderson	14.02	1252.31	1252.31	11.18	1186.70	4.93	1186.70
Anderson 18-3-12HN	Anderson	16.82	1200.00	12607.35	13.96	1200.00	5.88	1200.00
Anderson 19-1-10HC	Anderson	24.95	1252.31	7728.56	22.11	1186.70	8.78	1186.70
Anderson 18-3-9HC	Anderson	28.03	1252.31	1252.31	25.19	1186.70	9.87	1186.70
Anderson 19-1-9HN	Anderson	38.05	1252.31	7541.84	35.21	1186.70	13.39	1186.70
Anderson 18-3-8HN	Anderson	44.85	1252.31	1252.31	42.01	1186.70	15.79	1186.70
Anderson 19-1-8HC	Anderson	51.63	1252.31	7704.45	48.79	1186.70	18.18	1186.70
Anderson 18-3-7HC	Anderson	58.87	1250.00	1250.00	56.03	1186.70	20.73	1186.70
Anderson 19-1-7HN	Anderson	68.16	1252.31	1252.31	65.32	1186.70	24.00	1186.70
Schaefer 24-3-1HC (PWB)	Schaefer	1011.57	7617.14	7617.14	969.89	7600.74	23.73	7502.31



**WARD PETROLEUM**

SYS DRILL  
Closest Approach + Clearance Factor Summary Report  
Wellbore: Anderson 18-3-11HC



Offset Wellbore	Offset Structure	Separation [ft]	MD[ft]	Diverging From[ft]	Ellipse Separation [ft]	Ellipse MD[ft]	Clearance Factor	Clearance MD[ft]
Schaefer 24-3-2HN (PWB)	Schaefer	1386.95	7518.72	7518.72	1339.17	7502.31	28.67	7403.89
Schaefer 24-3-3HC (PWB)	Schaefer	1840.13	7627.04	7627.04	1791.87	7617.14	37.62	7469.51