

LEGEND:

 PROPOSED LOCATION

GRMR OIL & GAS

STOVER FEDERAL #9-12 1D & #9-12 1H
NW 1/4 SW 1/4, SECTION 9, T4N, R90W, 6th P.M.
MOFFAT COUNTY, COLORADO

DRAWN BY: R.C.

DATE DRAWN: 04-07-15

SCALE: 1:100,000

REVISED: 06-11-15 D.L.S.

ACCESS ROAD MAP

TOPO A



UELS, LLC
Corporate Office * 85 South 200 East
Vernal, UT 84078 * (435) 789-1017



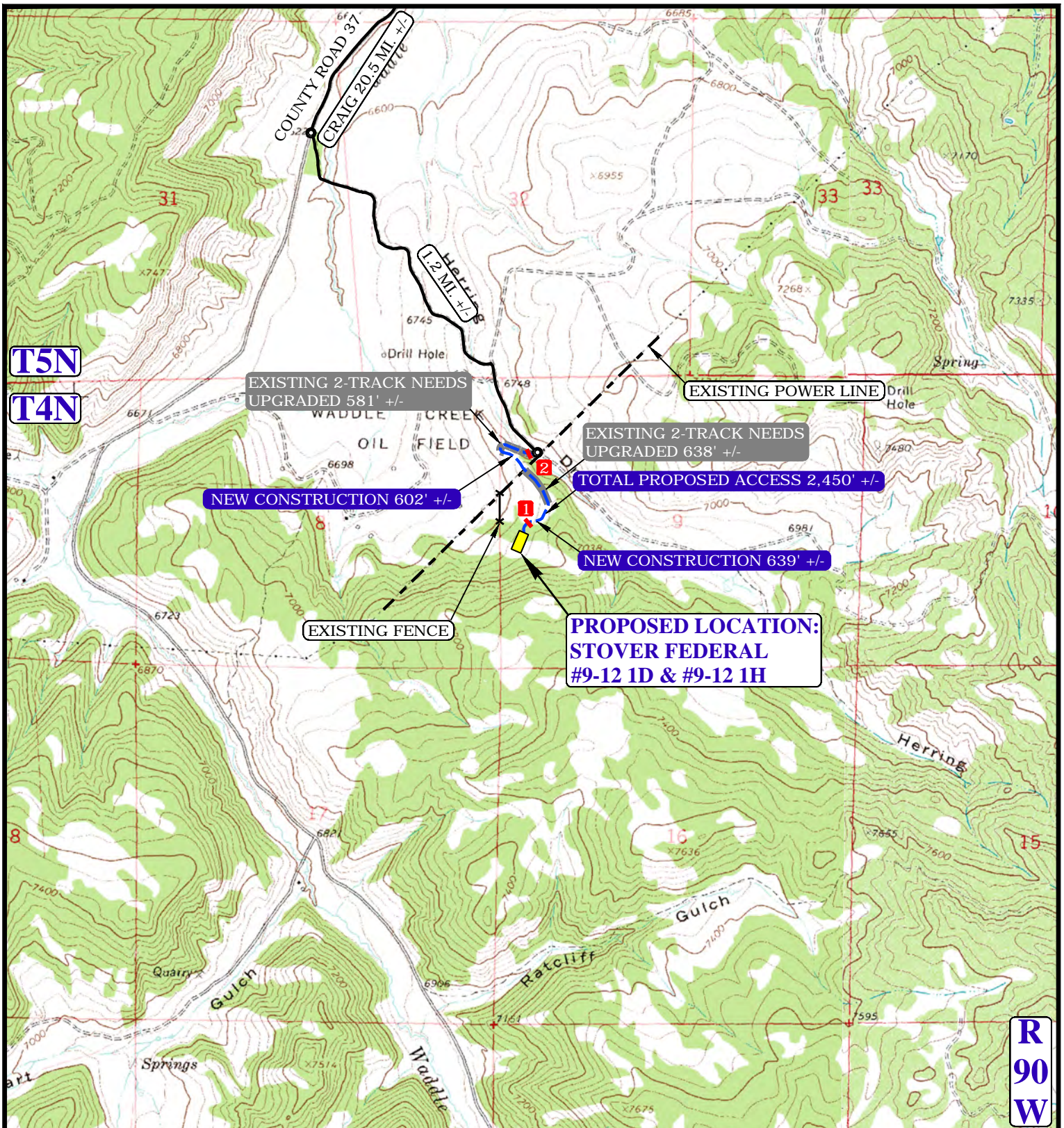

NOTE: PARCEL DATA SHOWN HAS BEEN OBTAINED FROM VARIOUS SOURCES AND SHOULD BE USED FOR MAPPING, GRAPHIC AND PLANNING PURPOSES ONLY. NO WARRANTY IS MADE BY UINTAH ENGINEERING AND LAND SURVEYING (UELS) FOR ACCURACY OF THE PARCEL DATA.

LEGEND:

	EXISTING ROAD		18" CULVERT REQUIRED
	PROPOSED ROAD		60" CULVERT REQUIRED
	EXISTING FENCE		
	EXISTING POWER LINE		
	EXISTING 2-TRACK		



GRMR OIL & GAS

STOVER FEDERAL #9-12 1D & #9-12 1H
 NW 1/4 SW 1/4, SECTION 9, T4N, R90W, 6th P.M.
 MOFFAT COUNTY, COLORADO

DRAWN BY: R.C.

DATE DRAWN: 04-07-15

SCALE: 1" = 2000'

REVISED: 06-11-15 D.L.S.

ACCESS ROAD MAP

TOPO B



UELS, LLC
 Corporate Office * 85 South 200 East
 Vernal, UT 84078 * (435) 789-1017