

# ALBRIGHTON L-10HN WELL LOCATION CERTIFICATE

NW COR. SEC. 10  
3/4" ALUM. CAP  
PLS 7242, 1997

N 89°06'10" E 2618.78'

N 89°06'20" E 2618.84'

NE COR. SEC. 10  
3/4" ALUM. CAP  
ILLEGIBLE

BHL- 470' FNL  
2530' FWL

N 1/4 COR. SEC. 10  
3/4" ALUM. CAP  
ILLEGIBLE

**SURFACE LOCATION**  
GROUND ELEVATION= 4807'  
NAD83  
LATITUDE= 40.496613°  
LONGITUDE= 104.541205°

**LANDING POINT LOCATION**  
NAD83  
LATITUDE= 40.494976°  
LONGITUDE= 104.536656°

**BOTTOM HOLE LOCATION**  
NAD83  
LATITUDE= 40.506677°  
LONGITUDE= 104.536468°

**NOTES:**  
BH LOCATION PROVIDED BY CLIENT.  
LAND SURFACE USE-IMPROVED PASTURE  
EXISTING WELL ALBRIGHTON 1-10 IS 15' E  
AT 1170' FSL & 1272' FWL  
EXISTING WELL ALBRIGHTON 2-10 IS 37' E  
AT 1170' FSL & 1294' FWL  
EXISTING WELL ALBRIGHTON 3-10 IS 58' E  
AT 1169' FSL & 1316' FWL  
SEE ATTACHED MAP FOR ADDITIONAL  
IMPROVEMENTS WITHIN 500'.  
PDOP= 1.9  
GPS OPERATOR: ALAN HNIZDO

10

W 1/4 COR. SEC. 10  
3/4" ALUM. CAP  
PLS 7242, 1997

N 89°08'55" E 2628.80'

N 89°11'07" E 2629.02'

E 1/4 COR. SEC. 10  
3/4" ALUM. CAP  
PLS 7242, 1997

S 1/8 COR. SEC. 9/10  
3/4" ALUM. CAP  
PLS 7242, 1997

ALBRIGHTON  
L-10HN

EX. ALBRIGHTON 1-10  
EX. ALBRIGHTON 2-10  
EX. ALBRIGHTON 3-10

C-S 1/8 COR. SEC. 10  
3/4" ALUM. CAP  
PLS 7242, 1997

SW COR. SEC. 10  
2 1/2" ALUM. CAP  
ILLEGIBLE

S 89°12'54" W 2639.34'

S 89°14'31" W 2638.77'

SE COR. SEC. 10  
3/4" ALUM. CAP  
PLS 34995, 2010

## LEGEND

- ⊕ = EXISTING MONUMENT
- = CALCULATED POSITION
- = PROPOSED WELL
- ◆ = EXISTING WELL
- ⬤ = BOTTOM HOLE
- ▲ = LANDING POINT
- LP = LANDING POINT
- BHL = BOTTOM HOLE

**WELL ALBRIGHTON L-10HN TO BE  
LOCATED 1170' FSL AND 1257' FWL**

## NOTES:

- THIS FIELD SURVEY CONFORMS TO THE MINIMUM STANDARDS SET BY THE C.O.G.C.C., RULE NO. 215
- BEARINGS ARE BASED ON THE ASSUMPTION THAT THE EAST LINE OF THE SOUTHEAST QUARTER OF SECTION 10, BEARS S00°21'43"E BETWEEN THE MONUMENTS SHOWN HEREON.
- GRID DISTANCES ARE SHOWN, AS GPS MEASURED IN THE FIELD, WITH TIES TO WELLS MEASURED PERPENDICULAR TO SECTION LINES. TO GET GROUND DISTANCES MULTIPLY THE SHOWN DISTANCE BY 1.000257538.
- ELEVATIONS SHOWN ARE NAVD 88, AS DERIVED BY GPS OBSERVATIONS.
- FIELD VERIFICATION OF MONUMENTS COMPLETED WITHIN 1 YEAR OF SIGNATURE DATE.

NOTICE: ACCORDING TO COLORADO LAW YOU MUST COMMENCE ANY LEGAL ACTION BASED UPON ANY DEFECT IN THIS SURVEY WITHIN THREE YEARS AFTER YOU FIRST DISCOVER SUCH DEFECT. IN NO EVENT MAY ANY ACTION BASED UPON ANY DEFECT IN THIS SURVEY BE COMMENCED MORE THAN TEN YEARS FROM THIS SAID DATE OF THIS CERTIFICATION SHOWN HEREON.

I, JACOB S. FRISCH, A LICENSED PROFESSIONAL LAND SURVEYOR IN THE STATE OF COLORADO DO HEREBY CERTIFY TO **BAYSWATER EXPLORATION & PRODUCTION, LLC**, THAT THE SURVEY AND WELL LOCATION CERTIFICATE SHOWN HEREON WERE DONE BY ME OR UNDER MY DIRECT SUPERVISION AND THAT THE DRAWING SHOWN HEREON ACCURATELY DEPICTS THE PROPOSED LOCATION OF THE WELL. THIS CERTIFICATE DOES NOT REPRESENT A LAND SURVEY PLAT OR IMPROVEMENT SURVEY PLAT AS DEFINED BY C.R.S. 38-51-102 AND CANNOT BE RELIED UPON TO DETERMINE OWNERSHIP.

JACOB S. FRISCH, PLS 38149  
DATE: 09-09-15  
JOB NO: B14.BEP.0101  
FOR AND ON BEHALF OF B.F.S., LLC

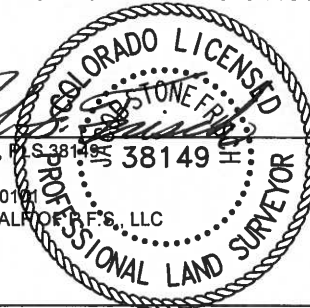

0 500 1000  
SCALE: 1"=1000'

SHEET 1 OF 1

PREPARED BY:



FIELD DATE:  
06-08-15

DRAWING DATE:  
09-08-15

BY:  
KAD

CHECKED BY:  
SNC

WELL NAME:

ALBRIGHTON L-10HN

SURFACE LOCATION:

SW 1/4 SW 1/4 SEC. 10, T6N, R64W, 6TH P.M.  
WELD COUNTY, COLORADO

PREPARED FOR:

