



August 26, 2015

Mr. Matt Lepore, Director  
Colorado Oil and Gas Conservation Commission  
1120 Lincoln Street, Suite 801  
Denver, Colorado 80203

7535 Hilltop Circle  
Denver, CO 80221  
[www.petro-fs.com](http://www.petro-fs.com)

**RE: COGCC Rule 318A.e.: Proposed Spacing Unit  
Albrighton A-10HN Well: SWSW Section 10, Township 6 North, Range 64 West  
Weld County, Colorado**

Dear Mr. Lepore:

Bayswater Exploration & Production, LLC (Bayswater) is planning to drill the above referenced well in accordance with the provisions set out in Colorado Oil and Gas Conservation Commission (COGCC) Rule 318A.e. Bayswater's Proposed Spacing Unit consists of:

E½E½ of Section 9, Township 6 North, Range 64 West  
W½W½ of Section 10, Township 6 North, Range 64 West  
Containing 320.00 acres, more or less

Bayswater is not the only owner within the Proposed Spacing Unit and has provided notice to the remaining owners, as required by COGCC Rule 318A.e.(6). Copies of the required notification letters are on file at Bayswater's office. The required thirty (30) day notice period has elapsed absent the receipt by Bayswater of any objection to their proposal by the owners within the Proposed Spacing Unit for the subject well.

Enclosed is the Proposed Spacing Unit Exhibit to assist in your review and approval of Bayswater's proposed Application for Permit to Drill for the Albrighton A-10HN Well. Many thanks for your attention to this matter.

Respectfully,



Jennifer Grosshans  
Regulatory Analyst  
Agent for Bayswater Exploration & Production, LLC

:jg

Enclosure: Proposed Spacing Unit Exhibit

*We are what we repeatedly do. Excellence, then, is not an act, but a habit.*

*-Aristotle*

**ALBRIGHTON 10-P PAD  
PROPOSED 318A.e. SPACING UNIT  
SEC. 9: E2E2  
SEC. 10: W2W2**

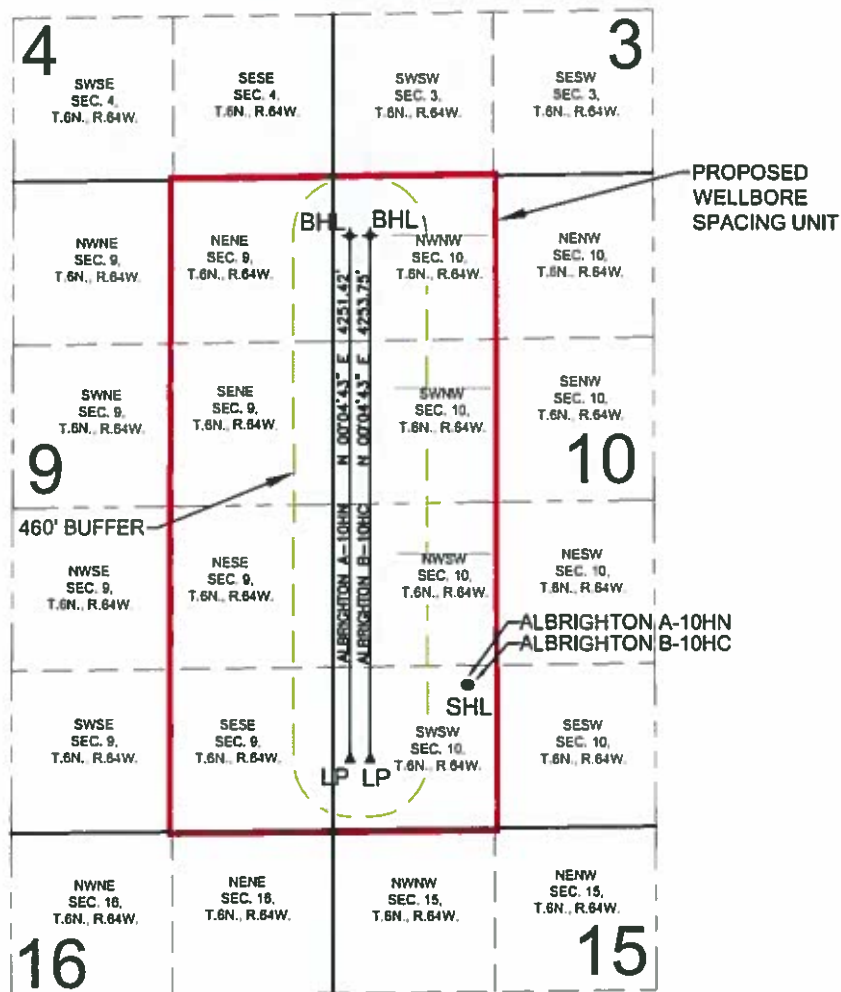

**WELL ALBRIGHTON A-10HN TO BE LOCATED 1170' FSL AND 1092' FWL, SEC. 10, T6N, R64W**  
**WELL ALBRIGHTON B-10HC TO BE LOCATED 1170' FSL AND 1107' FWL, SEC. 10, T6N, R64W**

**LEGEND**

- = PROPOSED WELL
- ▲ = LANDING POINT
- ⬆ = BOTTOM HOLE
- SHL = SURFACE HOLE
- LP = LANDING POINT
- BHL = BOTTOM HOLE

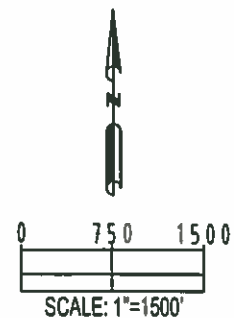

PREPARED BY:

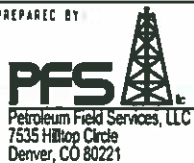

FIELD DATE:

06-08-15

DRAWING DATE:

09-08-15

BY:

KAD

CHECKED BY:

SNC

SITE NAME:

ALBRIGHTON 10-P PAD

SURFACE LOCATION:

SW 1/4 SW 1/4 SEC. 10, T6N, R64W, 6TH P.M.  
WELD COUNTY, COLORADO

PREPARED FOR:

