

# KERR-MCGEE OIL & GAS ONSHORE LP (WA)

Location: COLORADO Slot: SLOT#44 JESTER 41N-A14HZ (1350'FNL & 265'FWL, SEC.15)  
Field: WELD COUNTY (UTM/TRUE NORTH) Well: JESTER 41N-A14HZ  
Facility: SEC.15-T3N-R67W Wellbore: JESTER 41N-A14HZ PWB

Plot reference wellpath is JESTER 41N-A14HZ (REV-A.0) PWP

True vertical depths are referenced to PRECISION 460 (20'KB) (RKB)	Grid System: NAD83 / UTM Zone 13 North, US feet
Measured depths are referenced to PRECISION 460 (20'KB) (RKB)	North Reference: True north
PRECISION 460 (20'KB) (RKB) to Mean Sea Level: 4813 feet	Scale: True distance
Mean Sea Level to Mud line (At Slot: SLOT#44 JESTER 41N-A14HZ (1350'FNL & 265'FWL, SEC.15)): 0 feet	Depths are in feet
Coordinates are in feet referenced to Slot	Created by: amarc on 26/Jun/2015

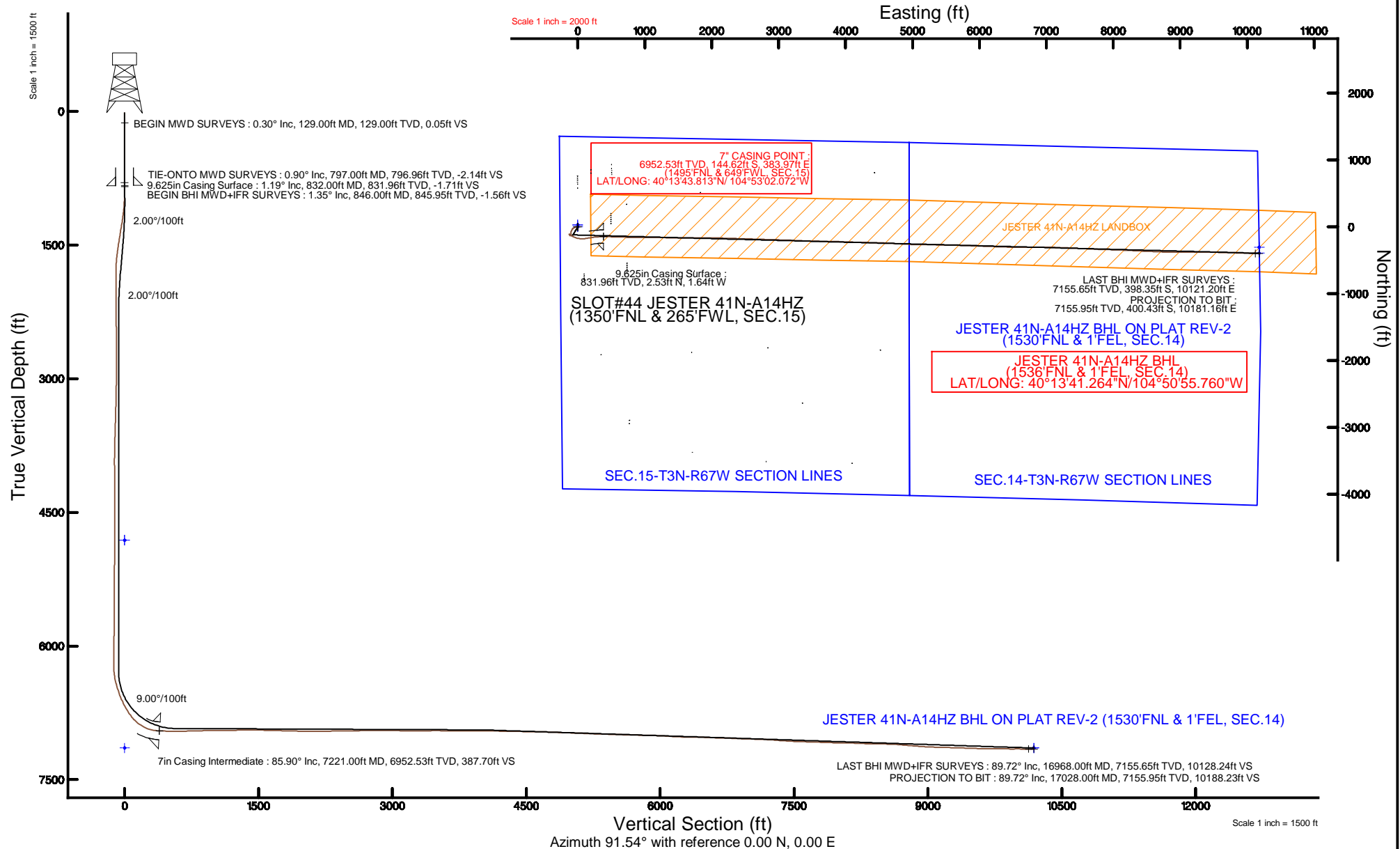

# Actual Wellpath Report

JESTER 41N-A14HZ AWP

Page 1 of 7

## REFERENCE WELLPATH IDENTIFICATION

Operator	KERR-MCGEE OIL & GAS ONSHORE LP (WA)	Slot	SLOT#44 JESTER 41N-A14HZ (1350'FNL & 265'FWL, SEC.15)
Area	COLORADO	Well	JESTER 41N-A14HZ
Field	WELD COUNTY (UTM/TRUE NORTH)	Wellbore	JESTER 41N-A14HZ AWB <17028>
Facility	SEC.15-T3N-R67W		

## REPORT SETUP INFORMATION

Projection System	NAD83 / UTM Zone 13 North, US feet	Software System	WellArchitect® 4.0.0
North Reference	True	User	Amarcar
Scale	0.999601	Report Generated	26/Jun/2015 at 10:31
Convergence at slot	0.07° East	Database/Source file	KERR MCGEE UTM/JESTER_41N-A14HZ_AWB__17028_.xml

## WELLPATH LOCATION

	Local coordinates		Grid coordinates		Geographic coordinates	
	North[ft]	East[ft]	Easting[US ft]	Northing[US ft]	Latitude	Longitude
Slot Location	663.80	-1740.34	1672435.34	14610229.16	40°13'45.242"N	104°53'07.022"W
Facility Reference Pt			1674175.89	14609568.00	40°13'38.683"N	104°52'44.584"W
Field Reference Pt			1698235.31	14552047.82	40°04'09.600"N	104°47'36.000"W

## WELLPATH DATUM

Calculation method	Minimum curvature	PRECISION 460 (20'KB) (RKB) to Facility Vertical Datum	4813.00ft
Horizontal Reference Pt	Slot	PRECISION 460 (20'KB) (RKB) to Mean Sea Level	4813.00ft
Vertical Reference Pt	PRECISION 460 (20'KB) (RKB)	PRECISION 460 (20'KB) (RKB) to Mud Line at Slot (SLOT#44 JESTER 41N-A14HZ (1350'FNL & 265'FWL, SEC.15))	4813.00ft
MD Reference Pt	PRECISION 460 (20'KB) (RKB)	Section Origin	N 0.00, E 0.00 ft
Field Vertical Reference	Mean Sea Level	Section Azimuth	91.54°

# Actual Wellpath Report

JESTER 41N-A14HZ AWP

Page 2 of 7

## REFERENCE WELLPATH IDENTIFICATION

Operator	KERR-MCGEE OIL & GAS ONSHORE LP (WA)	Slot	SLOT#44 JESTER 41N-A14HZ (1350'FNL & 265'FWL, SEC.15)
Area	COLORADO	Well	JESTER 41N-A14HZ
Field	WELD COUNTY (UTM/TRUE NORTH)	Wellbore	JESTER 41N-A14HZ AWB <17028>
Facility	SEC.15-T3N-R67W		

## WELLPATH DATA (168 stations) † = interpolated/extrapolated station

MD [ft]	Inclination [°]	Azimuth [°]	TVD [ft]	Vert Sect [ft]	North [ft]	East [ft]	Latitude	Longitude	DLS [°/100ft]	Comments
0.00†	0.000	172.200	0.00	0.00	0.00	0.00	40°13'45.242"N	104°53'07.022"W	0.00	
20.00	0.000	172.200	20.00	0.00	0.00	0.00	40°13'45.242"N	104°53'07.022"W	0.00	
129.00	0.300	172.200	129.00	0.05	-0.28	0.04	40°13'45.239"N	104°53'07.022"W	0.28	BEGIN MWD SURVEYS
190.00	0.300	307.300	190.00	-0.06	-0.34	-0.07	40°13'45.239"N	104°53'07.023"W	0.91	
252.00	0.300	330.000	252.00	-0.27	-0.11	-0.28	40°13'45.241"N	104°53'07.026"W	0.19	
314.00	0.200	161.700	314.00	-0.32	-0.07	-0.32	40°13'45.241"N	104°53'07.026"W	0.80	
376.00	0.500	234.300	376.00	-0.50	-0.33	-0.51	40°13'45.239"N	104°53'07.029"W	0.77	
461.00	0.300	303.500	461.00	-0.98	-0.42	-1.00	40°13'45.238"N	104°53'07.035"W	0.57	
544.00	1.100	249.000	543.99	-1.91	-0.59	-1.92	40°13'45.236"N	104°53'07.047"W	1.15	
629.00	0.700	350.900	628.98	-2.75	-0.37	-2.77	40°13'45.238"N	104°53'07.058"W	1.67	
713.00	1.100	7.100	712.97	-2.77	0.94	-2.75	40°13'45.251"N	104°53'07.057"W	0.56	
797.00	0.900	58.700	796.96	-2.14	2.08	-2.08	40°13'45.263"N	104°53'07.049"W	1.06	TIE-ONTO MWD SURVEYS
846.00	1.350	28.150	845.95	-1.56	2.79	-1.48	40°13'45.270"N	104°53'07.041"W	1.50	BEGIN BHI MWD+IFR SURVEYS
940.00	1.520	299.480	939.93	-2.16	4.38	-2.05	40°13'45.285"N	104°53'07.048"W	2.14	
1034.00	3.700	264.850	1033.83	-6.28	4.72	-6.15	40°13'45.289"N	104°53'07.101"W	2.76	
1128.00	6.210	260.680	1127.47	-14.28	3.63	-14.19	40°13'45.278"N	104°53'07.205"W	2.70	
1223.00	8.810	257.350	1221.65	-26.38	1.20	-26.36	40°13'45.254"N	104°53'07.362"W	2.77	
1317.00	10.480	246.160	1314.33	-41.09	-3.83	-41.21	40°13'45.204"N	104°53'07.553"W	2.66	
1411.00	11.260	237.010	1406.65	-56.38	-12.28	-56.73	40°13'45.121"N	104°53'07.753"W	2.01	
1505.00	12.670	226.760	1498.61	-71.26	-24.35	-71.94	40°13'45.001"N	104°53'07.949"W	2.71	
1600.00	13.010	213.400	1591.26	-84.30	-40.41	-85.42	40°13'44.843"N	104°53'08.123"W	3.14	
1689.00	11.530	205.970	1678.23	-93.27	-56.78	-94.83	40°13'44.681"N	104°53'08.245"W	2.43	
1779.00	11.480	187.710	1766.45	-97.96	-73.74	-99.97	40°13'44.513"N	104°53'08.311"W	4.03	
1869.00	9.520	174.760	1854.95	-98.04	-90.03	-100.49	40°13'44.352"N	104°53'08.318"W	3.40	
1958.00	8.130	182.370	1942.90	-97.26	-103.65	-100.08	40°13'44.218"N	104°53'08.312"W	2.04	
2048.00	5.690	186.180	2032.24	-97.72	-114.45	-100.82	40°13'44.111"N	104°53'08.322"W	2.76	
2138.00	3.330	186.570	2121.95	-98.31	-121.48	-101.60	40°13'44.042"N	104°53'08.332"W	2.62	
2228.00	2.250	149.980	2211.85	-97.61	-125.61	-101.02	40°13'44.001"N	104°53'08.324"W	2.25	
2318.00	0.990	126.570	2301.82	-96.05	-127.60	-99.51	40°13'43.981"N	104°53'08.305"W	1.55	
2407.00	0.770	120.440	2390.80	-94.90	-128.36	-98.37	40°13'43.974"N	104°53'08.290"W	0.27	
2587.00	0.670	117.260	2570.79	-92.89	-129.46	-96.40	40°13'43.963"N	104°53'08.265"W	0.06	
2767.00	0.510	115.720	2750.78	-91.21	-130.29	-94.74	40°13'43.955"N	104°53'08.243"W	0.09	
2946.00	1.120	291.910	2929.77	-92.13	-129.98	-95.64	40°13'43.958"N	104°53'08.255"W	0.91	
3126.00	1.160	297.200	3109.74	-95.42	-128.49	-98.90	40°13'43.972"N	104°53'08.297"W	0.06	
3485.00	1.750	269.470	3468.62	-104.17	-126.88	-107.61	40°13'43.988"N	104°53'08.409"W	0.25	
3664.00	1.700	261.600	3647.54	-109.52	-127.29	-112.97	40°13'43.984"N	104°53'08.479"W	0.14	
3844.00	1.390	229.450	3827.48	-113.77	-129.10	-117.27	40°13'43.966"N	104°53'08.534"W	0.50	
4023.00	0.600	102.030	4006.46	-114.46	-130.71	-118.00	40°13'43.950"N	104°53'08.543"W	1.02	
4203.00	0.460	37.150	4186.46	-113.11	-130.33	-116.65	40°13'43.954"N	104°53'08.526"W	0.32	
4472.00	0.620	20.320	4455.45	-112.01	-128.10	-115.49	40°13'43.976"N	104°53'08.511"W	0.08	
4831.00	0.640	327.730	4814.43	-112.50	-124.59	-115.88	40°13'44.011"N	104°53'08.516"W	0.16	
5190.00	0.700	299.100	5173.40	-115.56	-121.82	-118.87	40°13'44.038"N	104°53'08.555"W	0.09	
5549.00	0.870	347.450	5532.37	-118.17	-118.10	-121.38	40°13'44.075"N	104°53'08.587"W	0.18	
5908.00	0.700	338.690	5891.34	-119.69	-113.39	-122.77	40°13'44.121"N	104°53'08.605"W	0.06	
6088.00	0.760	297.730	6071.33	-121.18	-111.81	-124.22	40°13'44.137"N	104°53'08.624"W	0.29	

## REFERENCE WELLPATH IDENTIFICATION

Operator	KERR-MCGEE OIL & GAS ONSHORE LP (WA)	Slot	SLOT#44 JESTER 41N-A14HZ (1350'FNL & 265'FWL, SEC.15)
Area	COLORADO	Well	JESTER 41N-A14HZ
Field	WELD COUNTY (UTM/TRUE NORTH)	Wellbore	JESTER 41N-A14HZ AWB <17028>
Facility	SEC.15-T3N-R67W		

## WELLPATH DATA (168 stations) † = interpolated/extrapolated station

MD [ft]	Inclination [°]	Azimuth [°]	TVD [ft]	Vert Sect [ft]	North [ft]	East [ft]	Latitude	Longitude	DLS [°/100ft]	Comments
6178.00	1.110	255.100	6161.32	-122.55	-111.76	-125.60	40°13'44.138"N	104°53'08.641"W	0.84	
6268.00	1.880	142.880	6251.30	-122.47	-113.16	-125.55	40°13'44.124"N	104°53'08.641"W	2.80	
6357.00	11.030	119.710	6339.65	-114.03	-118.56	-117.25	40°13'44.070"N	104°53'08.534"W	10.48	
6447.00	16.780	116.610	6426.97	-94.66	-128.65	-98.14	40°13'43.971"N	104°53'08.287"W	6.44	
6543.00	20.970	124.270	6517.80	-67.64	-144.54	-71.54	40°13'43.814"N	104°53'07.944"W	5.06	
6633.00	25.700	108.610	6600.50	-35.39	-159.86	-39.69	40°13'43.662"N	104°53'07.534"W	8.63	
6722.00	28.460	102.930	6679.75	3.86	-170.77	-0.72	40°13'43.554"N	104°53'07.031"W	4.25	
6812.00	33.950	92.840	6756.75	50.07	-176.82	45.35	40°13'43.495"N	104°53'06.437"W	8.41	
6902.00	43.820	84.680	6826.77	106.31	-175.17	101.65	40°13'43.511"N	104°53'05.711"W	12.34	
6992.00	55.830	80.660	6884.74	174.07	-166.21	169.68	40°13'43.600"N	104°53'04.834"W	13.77	
7082.00	69.310	82.400	6926.10	252.56	-154.54	248.51	40°13'43.715"N	104°53'03.818"W	15.07	
7172.00	82.840	86.450	6947.72	339.04	-146.17	335.24	40°13'43.798"N	104°53'02.700"W	15.65	
7221.00†	85.896	89.902	6952.53	387.70	-144.62	383.97	40°13'43.813"N	104°53'02.072"W	9.38	7" CASING POINT
7260.00	88.340	92.630	6954.49	426.65	-145.48	422.90	40°13'43.804"N	104°53'01.570"W	9.38	
7350.00	89.140	91.730	6956.47	516.62	-148.90	512.81	40°13'43.770"N	104°53'00.410"W	1.34	
7395.00	89.690	92.020	6956.93	561.62	-150.38	557.78	40°13'43.756"N	104°52'59.831"W	1.38	
7485.00	90.990	91.670	6956.39	651.61	-153.27	647.73	40°13'43.727"N	104°52'58.671"W	1.50	
7575.00	91.940	91.270	6954.09	741.58	-155.58	737.67	40°13'43.704"N	104°52'57.511"W	1.15	
7664.00	91.420	90.500	6951.48	830.53	-156.96	826.62	40°13'43.691"N	104°52'56.365"W	1.04	
7754.00	90.950	90.080	6949.62	920.49	-157.41	916.60	40°13'43.686"N	104°52'55.204"W	0.70	
7844.00	90.860	89.750	6948.20	1010.45	-157.28	1006.59	40°13'43.688"N	104°52'54.044"W	0.38	
7934.00	90.990	90.960	6946.75	1100.41	-157.83	1096.58	40°13'43.682"N	104°52'52.884"W	1.35	
8023.00	90.130	90.940	6945.88	1189.40	-159.31	1185.56	40°13'43.667"N	104°52'51.737"W	0.97	
8113.00	90.930	91.020	6945.05	1279.40	-160.85	1275.54	40°13'43.652"N	104°52'50.577"W	0.89	
8203.00	90.040	91.830	6944.28	1369.39	-163.09	1365.51	40°13'43.630"N	104°52'49.417"W	1.34	
8293.00	90.350	91.680	6943.98	1459.39	-165.84	1455.47	40°13'43.603"N	104°52'48.257"W	0.38	
8382.00	88.370	89.030	6944.97	1548.35	-166.40	1544.45	40°13'43.597"N	104°52'47.110"W	3.72	
8472.00	88.710	89.130	6947.27	1638.24	-164.95	1634.41	40°13'43.611"N	104°52'45.950"W	0.39	
8562.00	88.620	89.390	6949.36	1728.14	-163.79	1724.37	40°13'43.623"N	104°52'44.790"W	0.31	
8652.00	88.430	91.000	6951.68	1818.09	-164.09	1814.34	40°13'43.620"N	104°52'43.630"W	1.80	
8741.00	88.030	90.500	6954.43	1907.04	-165.26	1903.29	40°13'43.608"N	104°52'42.483"W	0.72	
8831.00	88.800	90.610	6956.92	1996.99	-166.13	1993.25	40°13'43.600"N	104°52'41.323"W	0.86	
8921.00	89.450	90.510	6958.29	2086.96	-167.01	2083.24	40°13'43.591"N	104°52'40.163"W	0.73	
9011.00	90.610	91.330	6958.24	2176.96	-168.46	2173.22	40°13'43.576"N	104°52'39.003"W	1.58	
9100.00	91.390	91.850	6956.69	2265.94	-170.92	2262.17	40°13'43.552"N	104°52'37.856"W	1.05	
9190.00	91.840	92.390	6954.15	2355.90	-174.25	2352.07	40°13'43.519"N	104°52'36.697"W	0.78	
9280.00	90.390	91.560	6952.40	2445.88	-177.35	2442.00	40°13'43.488"N	104°52'35.538"W	1.86	
9370.00	90.980	91.150	6951.33	2535.87	-179.48	2531.97	40°13'43.467"N	104°52'34.378"W	0.80	
9460.00	90.360	92.250	6950.27	2625.86	-182.15	2621.92	40°13'43.441"N	104°52'33.218"W	1.40	
9549.00	91.040	92.240	6949.19	2714.85	-185.64	2710.85	40°13'43.406"N	104°52'32.072"W	0.76	
9639.00	89.220	91.560	6948.98	2804.84	-188.62	2800.79	40°13'43.376"N	104°52'30.912"W	2.16	
9729.00	89.430	91.270	6950.04	2894.83	-190.84	2890.76	40°13'43.354"N	104°52'29.752"W	0.40	
9819.00	90.730	92.360	6949.92	2984.83	-193.69	2980.71	40°13'43.326"N	104°52'28.592"W	1.88	
9908.00	89.010	92.050	6950.12	3073.82	-197.12	3069.64	40°13'43.292"N	104°52'27.446"W	1.96	
9998.00	89.340	91.970	6951.42	3163.81	-200.27	3159.57	40°13'43.261"N	104°52'26.286"W	0.38	

## REFERENCE WELLPATH IDENTIFICATION

Operator	KERR-MCGEE OIL & GAS ONSHORE LP (WA)	Slot	SLOT#44 JESTER 41N-A14HZ (1350'FNL & 265'FWL, SEC.15)
Area	COLORADO	Well	JESTER 41N-A14HZ
Field	WELD COUNTY (UTM/TRUE NORTH)	Wellbore	JESTER 41N-A14HZ AWB <17028>
Facility	SEC.15-T3N-R67W		

## WELLPATH DATA (168 stations)

MD [ft]	Inclination [°]	Azimuth [°]	TVD [ft]	Vert Sect [ft]	North [ft]	East [ft]	Latitude	Longitude	DLS [°/100ft]	Comments
10092.00	90.170	92.480	6951.82	3257.80	-203.92	3253.50	40°13'43.225"N	104°52'25.075"W	1.04	
10187.00	90.540	92.720	6951.23	3352.78	-208.23	3348.40	40°13'43.182"N	104°52'23.852"W	0.46	
10281.00	91.070	92.430	6949.91	3446.76	-212.46	3442.30	40°13'43.140"N	104°52'22.641"W	0.64	
10375.00	88.210	90.230	6950.50	3540.74	-214.64	3536.25	40°13'43.118"N	104°52'21.430"W	3.84	
10469.00	88.640	90.230	6953.08	3634.68	-215.01	3630.22	40°13'43.115"N	104°52'20.219"W	0.46	
10564.00	90.210	91.220	6954.04	3729.66	-216.22	3725.20	40°13'43.103"N	104°52'18.994"W	1.95	
10658.00	91.100	91.880	6952.96	3823.65	-218.76	3819.16	40°13'43.077"N	104°52'17.783"W	1.18	
10752.00	90.510	92.070	6951.64	3917.64	-222.00	3913.09	40°13'43.045"N	104°52'16.572"W	0.66	
10846.00	89.810	91.920	6951.38	4011.63	-225.27	4007.04	40°13'43.013"N	104°52'15.360"W	0.76	
10941.00	88.270	91.630	6952.97	4106.62	-228.21	4101.97	40°13'42.983"N	104°52'14.136"W	1.65	
11035.00	88.820	91.580	6955.36	4200.59	-230.84	4195.91	40°13'42.957"N	104°52'12.925"W	0.59	
11129.00	89.000	91.590	6957.14	4294.57	-233.44	4289.85	40°13'42.931"N	104°52'11.714"W	0.19	
11223.00	88.880	90.840	6958.88	4388.55	-235.44	4383.82	40°13'42.912"N	104°52'10.503"W	0.81	
11318.00	88.140	91.720	6961.35	4483.52	-237.56	4478.76	40°13'42.890"N	104°52'09.279"W	1.21	
11412.00	89.840	92.830	6963.01	4577.49	-241.29	4572.66	40°13'42.853"N	104°52'08.068"W	2.16	
11502.00	89.070	93.100	6963.87	4667.46	-245.94	4662.54	40°13'42.807"N	104°52'06.909"W	0.91	
11591.00	88.170	93.470	6966.01	4756.39	-251.04	4751.37	40°13'42.757"N	104°52'05.764"W	1.09	
11681.00	87.310	92.620	6969.56	4846.29	-255.82	4841.17	40°13'42.709"N	104°52'04.606"W	1.34	
11771.00	87.870	92.440	6973.34	4936.19	-259.79	4931.00	40°13'42.670"N	104°52'03.448"W	0.65	
11861.00	88.790	91.850	6975.97	5026.15	-263.16	5020.90	40°13'42.636"N	104°52'02.289"W	1.21	
11950.00	87.340	90.780	6978.97	5115.09	-265.20	5109.82	40°13'42.616"N	104°52'01.143"W	2.02	
12040.00	87.500	90.960	6983.02	5204.99	-266.56	5199.72	40°13'42.602"N	104°51'59.984"W	0.27	
12130.00	87.810	90.460	6986.71	5294.91	-267.68	5289.64	40°13'42.591"N	104°51'58.824"W	0.65	
12220.00	88.420	90.790	6989.67	5384.85	-268.66	5379.58	40°13'42.581"N	104°51'57.665"W	0.77	
12310.00	88.850	90.740	6991.81	5474.82	-269.86	5469.55	40°13'42.569"N	104°51'56.505"W	0.48	
12399.00	87.530	91.530	6994.62	5563.77	-271.62	5558.48	40°13'42.552"N	104°51'55.358"W	1.73	
12489.00	88.330	91.560	6997.87	5653.71	-274.05	5648.39	40°13'42.528"N	104°51'54.199"W	0.89	
12579.00	88.810	91.530	7000.12	5743.68	-276.47	5738.33	40°13'42.503"N	104°51'53.039"W	0.53	
12669.00	88.880	92.500	7001.93	5833.66	-279.64	5828.25	40°13'42.472"N	104°51'51.880"W	1.08	
12758.00	88.350	92.360	7004.08	5922.62	-283.41	5917.15	40°13'42.434"N	104°51'50.734"W	0.62	
12848.00	86.480	92.230	7008.14	6012.52	-287.01	6006.98	40°13'42.399"N	104°51'49.576"W	2.08	
12938.00	86.810	92.090	7013.41	6102.36	-290.39	6096.76	40°13'42.365"N	104°51'48.418"W	0.40	
13028.00	87.280	92.210	7018.05	6192.23	-293.77	6186.58	40°13'42.331"N	104°51'47.260"W	0.54	
13117.00	87.960	92.050	7021.74	6281.15	-297.07	6275.44	40°13'42.299"N	104°51'46.115"W	0.78	
13207.00	89.620	91.910	7023.65	6371.12	-300.18	6365.36	40°13'42.268"N	104°51'44.955"W	1.85	
13297.00	89.280	91.450	7024.51	6461.12	-302.82	6455.32	40°13'42.241"N	104°51'43.796"W	0.64	
13387.00	87.210	90.340	7027.27	6551.06	-304.22	6545.26	40°13'42.227"N	104°51'42.636"W	2.61	
13476.00	87.270	89.970	7031.55	6639.93	-304.46	6634.16	40°13'42.225"N	104°51'41.490"W	0.42	
13566.00	89.460	91.090	7034.12	6729.88	-305.30	6724.11	40°13'42.216"N	104°51'40.330"W	2.73	
13656.00	87.920	89.670	7036.18	6819.83	-305.89	6814.08	40°13'42.210"N	104°51'39.170"W	2.33	
13746.00	86.710	89.600	7040.39	6909.68	-305.32	6903.98	40°13'42.215"N	104°51'38.011"W	1.35	
13835.00	88.930	90.730	7043.78	6998.58	-305.58	6992.90	40°13'42.213"N	104°51'36.865"W	2.80	
13925.00	87.950	91.380	7046.23	7088.54	-307.24	7082.85	40°13'42.196"N	104°51'35.705"W	1.31	
14015.00	87.420	91.960	7049.86	7178.47	-309.86	7172.74	40°13'42.170"N	104°51'34.546"W	0.87	
14105.00	85.760	91.950	7055.22	7268.31	-312.92	7262.53	40°13'42.139"N	104°51'33.389"W	1.84	

## REFERENCE WELLPATH IDENTIFICATION

Operator	KERR-MCGEE OIL & GAS ONSHORE LP (WA)	Slot	SLOT#44 JESTER 41N-A14HZ (1350'FNL & 265'FWL, SEC.15)
Area	COLORADO	Well	JESTER 41N-A14HZ
Field	WELD COUNTY (UTM/TRUE NORTH)	Wellbore	JESTER 41N-A14HZ AWB <17028>
Facility	SEC.15-T3N-R67W		

## WELLPATH DATA (168 stations)

MD [ft]	Inclination [°]	Azimuth [°]	TVD [ft]	Vert Sect [ft]	North [ft]	East [ft]	Latitude	Longitude	DLS [°/100ft]	Comments
14194.00	86.190	92.640	7061.46	7357.08	-316.48	7351.24	40°13'42.104"N	104°51'32.245"W	0.91	
14284.00	86.500	92.470	7067.20	7446.88	-320.48	7440.96	40°13'42.064"N	104°51'31.088"W	0.39	
14374.00	87.450	92.610	7071.95	7536.74	-324.46	7530.75	40°13'42.024"N	104°51'29.930"W	1.07	
14464.00	88.650	92.600	7075.01	7626.67	-328.55	7620.60	40°13'41.984"N	104°51'28.772"W	1.33	
14554.00	88.320	92.740	7077.39	7716.62	-332.74	7710.47	40°13'41.942"N	104°51'27.613"W	0.40	
14643.00	87.570	91.550	7080.58	7805.56	-336.07	7799.35	40°13'41.909"N	104°51'26.468"W	1.58	
14733.00	87.850	91.820	7084.18	7895.48	-338.72	7889.24	40°13'41.882"N	104°51'25.309"W	0.43	
14823.00	88.350	92.110	7087.16	7985.43	-341.80	7979.14	40°13'41.852"N	104°51'24.150"W	0.64	
14913.00	89.550	92.270	7088.81	8075.41	-345.24	8069.05	40°13'41.817"N	104°51'22.990"W	1.35	
15002.00	88.650	92.610	7090.21	8164.39	-349.03	8157.96	40°13'41.780"N	104°51'21.844"W	1.08	
15092.00	87.290	92.610	7093.40	8254.31	-353.12	8247.81	40°13'41.739"N	104°51'20.686"W	1.51	
15182.00	88.000	92.780	7097.10	8344.22	-357.35	8337.63	40°13'41.697"N	104°51'19.528"W	0.81	
15272.00	89.330	93.180	7099.19	8434.16	-362.03	8427.49	40°13'41.650"N	104°51'18.369"W	1.54	
15362.00	89.390	91.900	7100.20	8524.14	-366.02	8517.39	40°13'41.611"N	104°51'17.210"W	1.42	
15451.00	86.590	92.490	7103.32	8613.07	-369.42	8606.26	40°13'41.577"N	104°51'16.064"W	3.22	
15541.00	85.810	93.110	7109.29	8702.85	-373.81	8695.95	40°13'41.533"N	104°51'14.908"W	1.11	
15631.00	84.930	92.010	7116.55	8792.54	-377.82	8785.57	40°13'41.493"N	104°51'13.753"W	1.56	
15721.00	85.090	90.050	7124.38	8882.19	-379.43	8875.21	40°13'41.477"N	104°51'12.597"W	2.18	
15810.00	86.850	89.260	7130.63	8970.92	-378.89	8963.98	40°13'41.482"N	104°51'11.453"W	2.17	
15900.00	87.530	88.370	7135.05	9060.71	-377.03	9053.85	40°13'41.500"N	104°51'10.294"W	1.24	
15990.00	89.040	89.710	7137.74	9150.58	-375.53	9143.80	40°13'41.514"N	104°51'09.134"W	2.24	
16080.00	88.340	90.030	7139.80	9240.51	-375.32	9233.77	40°13'41.516"N	104°51'07.974"W	0.86	
16170.00	87.960	90.100	7142.70	9330.44	-375.42	9323.72	40°13'41.515"N	104°51'06.814"W	0.43	
16260.00	88.250	91.440	7145.68	9420.38	-376.63	9413.67	40°13'41.502"N	104°51'05.655"W	1.52	
16350.00	87.640	92.160	7148.91	9510.32	-379.46	9503.56	40°13'41.474"N	104°51'04.496"W	1.05	
16440.00	88.720	91.460	7151.76	9600.27	-382.30	9593.47	40°13'41.446"N	104°51'03.337"W	1.43	
16529.00	89.120	91.480	7153.44	9689.25	-384.58	9682.42	40°13'41.423"N	104°51'02.190"W	0.45	
16619.00	89.430	91.520	7154.58	9779.25	-386.94	9772.39	40°13'41.399"N	104°51'01.030"W	0.35	
16709.00	89.740	92.050	7155.23	9869.24	-389.74	9862.34	40°13'41.371"N	104°50'59.870"W	0.68	
16799.00	90.070	91.930	7155.38	9959.24	-392.87	9952.29	40°13'41.340"N	104°50'58.711"W	0.39	
16889.00	89.910	91.760	7155.40	10049.24	-395.76	10042.24	40°13'41.311"N	104°50'57.551"W	0.26	
16968.00	89.720	91.990	7155.65	10128.24	-398.35	10121.20	40°13'41.285"N	104°50'56.533"W	0.38	LAST BHI MWD+IFR SURVEYS
17028.00	89.720	91.990	7155.95	10188.23	-400.43	10181.16	40°13'41.264"N	104°50'55.760"W	0.00	PROJECTION TO BIT

## HOLE & CASING SECTIONS - Ref Wellbore: JESTER 41N-A14HZ AWB <17028> Ref Wellpath: JESTER 41N-A14HZ AWP

String/Diameter	Start MD [ft]	End MD [ft]	Interval [ft]	Start TVD [ft]	End TVD [ft]	Start N/S [ft]	Start E/W [ft]	End N/S [ft]	End E/W [ft]
13.5in Open Hole	20.00	842.00	822.00	20.00	841.95	0.00	0.00	2.71	-1.53
9.625in Casing Surface	20.00	832.00	812.00	20.00	831.96	0.00	0.00	2.53	-1.64
8.75in Open Hole	842.00	7237.00	6395.00	841.95	6953.53	2.71	-1.53	-144.75	399.93
7in Casing Intermediate	20.00	7221.00	7201.00	20.00	6952.53	0.00	0.00	-144.62	383.97
6.125in Open Hole	7237.00	17028.00	9791.00	6953.53	7155.95	-144.75	399.93	-400.43	10181.16

# Actual Wellpath Report

JESTER 41N-A14HZ AWP

Page 6 of 7

## REFERENCE WELLPATH IDENTIFICATION

Operator	KERR-MCGEE OIL & GAS ONSHORE LP (WA)	Slot	SLOT#44 JESTER 41N-A14HZ (1350'FNL & 265'FWL, SEC.15)
Area	COLORADO	Well	JESTER 41N-A14HZ
Field	WELD COUNTY (UTM/TRUE NORTH)	Wellbore	JESTER 41N-A14HZ AWB <17028>
Facility	SEC.15-T3N-R67W		

## TARGETS

Name	TVD [ft]	North [ft]	East [ft]	Grid East [US ft]	Grid North [US ft]	Latitude	Longitude	Shape
SEC.14-T3N-R67W SECTION LINES	4813.00	29.95	-0.31	1672434.99	14610259.10	40°13'45.538"N	104°53'07.026"W	polygon
SEC.15-T3N-R67W SECTION LINES	4813.00	29.95	-0.31	1672434.99	14610259.10	40°13'45.538"N	104°53'07.026"W	polygon
JESTER 41N-A14HZ BHL ON PLAT REV-1 (1440'FNL & 1'FEL, SEC.14)	7145.00	-304.61	10181.18	1682612.83	14609937.83	40°13'42.211"N	104°50'55.759"W	point
JESTER 41N-A14HZ BHL ON PLAT REV-2 (1530'FNL & 1'FEL, SEC.14)	7145.00	-394.59	10181.22	1682612.98	14609847.88	40°13'41.322"N	104°50'55.759"W	point
JESTER 41N-A14HZ LANDBOX	7145.00	0.00	0.00	1672435.34	14610229.16	40°13'45.242"N	104°53'07.022"W	polygon

## WELLPATH COMPOSITION - Ref Wellbore: JESTER 41N-A14HZ AWB <17028> Ref Wellpath: JESTER 41N-A14HZ AWP

Start MD [ft]	End MD [ft]	Positional Uncertainty Model	Log Name/Comment	Wellbore
20.00	797.00	Custom APC_ISCWSA REV 2 MWD	CATHEDRAL MWD SURVEYS 13.5" <129-797>	JESTER 41N-A14HZ AWB <17028>
797.00	7172.00	Custom APC_ISCWSA REV 2 MWD+IFR1 (approximation)	BHI MWD+IFR+MSA SURVEYS 8.75" <846-7172>	JESTER 41N-A14HZ AWB <17028>
7172.00	16968.00	Custom APC_ISCWSA REV 2 MWD+IFR1+MSA (approximation)	BHI MWD+IFR+MSA SURVEYS 6.125" <7260-16968>	JESTER 41N-A14HZ AWB <17028>
16968.00	17028.00	Blind Drilling (std)	Projection to bit	JESTER 41N-A14HZ AWB <17028>



# Actual Wellpath Report

JESTER 41N-A14HZ AWP

Page 7 of 7



## REFERENCE WELLPATH IDENTIFICATION

Operator	KERR-MCGEE OIL & GAS ONSHORE LP (WA)	Slot	SLOT#44 JESTER 41N-A14HZ (1350'FNL & 265'FWL, SEC.15)
Area	COLORADO	Well	JESTER 41N-A14HZ
Field	WELD COUNTY (UTM/TRUE NORTH)	Wellbore	JESTER 41N-A14HZ AWB <17028>
Facility	SEC.15-T3N-R67W		

## WELLPATH COMMENTS

MD [ft]	Inclination [°]	Azimuth [°]	TVD [ft]	Comment
129.00	0.300	172.200	129.00	BEGIN MWD SURVEYS
797.00	0.900	58.700	796.96	TIE-ONTO MWD SURVEYS
846.00	1.350	28.150	845.95	BEGIN BHI MWD+IFR SURVEYS
7221.00	85.896	89.902	6952.53	7" CASING POINT
16968.00	89.720	91.990	7155.65	LAST BHI MWD+IFR SURVEYS
17028.00	89.720	91.990	7155.95	PROJECTION TO BIT