

KERR-MCGEE OIL & GAS ONSHORE LP (WA)

Location: COLORADO Slot: SLOT#47 JESTER 40N-14HZ (1410'FNL & 265'FWL, SEC.15)
 Field: WELD COUNTY (UTM/TRUE NORTH) Well: JESTER 40N-14HZ
 Facility: SEC.15-T3N-R67W Wellbore: JESTER 40N-14HZ PWB

Plot reference wellpath is JESTER 40N-14HZ (REV-B.0) PWB

True vertical depths are referenced to PRECISION 460 (20'KB) (RKB)	Grid System: NAD83 / UTM Zone 13 North, US feet
Measured depths are referenced to PRECISION 460 (20'KB) (RKB)	North Reference: True north
PRECISION 460 (20'KB) (RKB) to Mean Sea Level: 4813 feet	Scale: True distance
Mean Sea Level to Mud line (At Slot: SLOT#47 JESTER 40N-14HZ (1410'FNL & 265'FWL, SEC.15)): 0 feet	Depths are in feet
Coordinates are in feet referenced to Slot	Created by: amarc on 28/Jul/2015

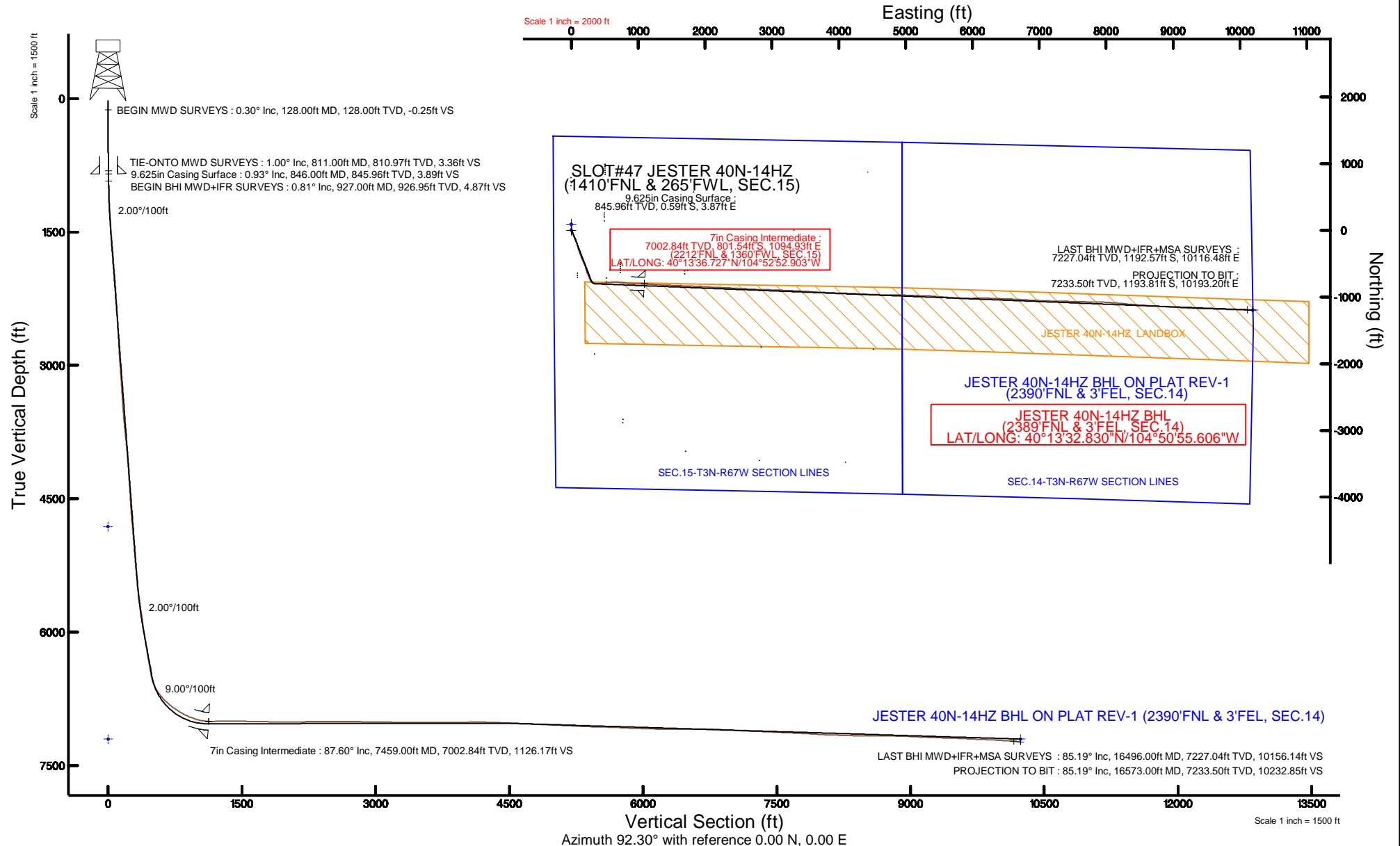



Actual Wellpath Report

JESTER 40N-14HZ AWP

Page 1 of 7



REFERENCE WELLPATH IDENTIFICATION

Operator	KERR-MCGEE OIL & GAS ONSHORE LP (WA)	Slot	SLOT#47 JESTER 40N-14HZ (1410'FNL & 265'FWL, SEC.15)
Area	COLORADO	Well	JESTER 40N-14HZ
Field	WELD COUNTY (UTM/TRUE NORTH)	Wellbore	JESTER 40N-14HZ AWP <16573>
Facility	SEC.15-T3N-R67W		

REPORT SETUP INFORMATION

Projection System	NAD83 / UTM Zone 13 North, US feet	Software System	WellArchitect® 4.0.0
North Reference	True	User	Amarcar
Scale	0.999601	Report Generated	28/Jul/2015 at 15:31
Convergence at slot	0.07° East	Database/Source file	KERR MCGEE UTM/JESTER_40N-14HZ_AWP__16573_.xml

WELLPATH LOCATION

	Local coordinates		Grid coordinates		Geographic coordinates	
	North[ft]	East[ft]	Easting[US ft]	Northing[US ft]	Latitude	Longitude
Slot Location	603.69	-1740.12	1672435.65	14610169.07	40°13'44.648"N	104°53'07.019"W
Facility Reference Pt			1674175.89	14609568.00	40°13'38.683"N	104°52'44.584"W
Field Reference Pt			1698235.31	14552047.82	40°04'09.600"N	104°47'36.000"W

WELLPATH DATUM

Calculation method	Minimum curvature	PRECISION 460 (20'KB) (RKB) to Facility Vertical Datum	4813.00ft
Horizontal Reference Pt	Slot	PRECISION 460 (20'KB) (RKB) to Mean Sea Level	4813.00ft
Vertical Reference Pt	PRECISION 460 (20'KB) (RKB)	PRECISION 460 (20'KB) (RKB) to Mud Line at Slot (SLOT#47 JESTER 40N-14HZ (1410'FNL & 265'FWL, SEC.15))	4813.00ft
MD Reference Pt	PRECISION 460 (20'KB) (RKB)	Section Origin	N 0.00, E 0.00 ft
Field Vertical Reference	Mean Sea Level	Section Azimuth	92.30°

Actual Wellpath Report

JESTER 40N-14HZ AWP

Page 2 of 7

REFERENCE WELLPATH IDENTIFICATION

Operator	KERR-MCGEE OIL & GAS ONSHORE LP (WA)	Slot	SLOT#47 JESTER 40N-14HZ (1410°FNL & 265°FWL, SEC.15)
Area	COLORADO	Well	JESTER 40N-14HZ
Field	WELD COUNTY (UTM/TRUE NORTH)	Wellbore	JESTER 40N-14HZ AWP <16573>
Facility	SEC.15-T3N-R67W		

WELLPATH DATA (185 stations) † = interpolated/extrapolated station

MD [ft]	Inclination [°]	Azimuth [°]	TVD [ft]	Vert Sect [ft]	North [ft]	East [ft]	Latitude	Longitude	DLS [°/100ft]	Comments
0.00†	0.000	245.100	0.00	0.00	0.00	0.00	40°13'44.648"N	104°53'07.019"W	0.00	
20.00	0.000	245.100	20.00	0.00	0.00	0.00	40°13'44.648"N	104°53'07.019"W	0.00	
128.00	0.300	245.100	128.00	-0.25	-0.12	-0.26	40°13'44.647"N	104°53'07.022"W	0.28	BEGIN MWD SURVEYS
189.00	0.200	311.900	189.00	-0.48	-0.12	-0.48	40°13'44.647"N	104°53'07.025"W	0.47	
251.00	0.400	142.900	251.00	-0.42	-0.22	-0.43	40°13'44.646"N	104°53'07.025"W	0.96	
313.00	0.200	169.100	313.00	-0.26	-0.49	-0.28	40°13'44.643"N	104°53'07.023"W	0.38	
376.00	0.600	340.500	376.00	-0.36	-0.29	-0.37	40°13'44.645"N	104°53'07.024"W	1.27	
461.00	0.200	193.700	461.00	-0.55	-0.02	-0.55	40°13'44.648"N	104°53'07.026"W	0.91	
543.00	0.700	68.900	542.99	-0.12	0.03	-0.12	40°13'44.648"N	104°53'07.021"W	1.01	
628.00	1.200	112.700	627.98	1.19	-0.13	1.19	40°13'44.647"N	104°53'07.004"W	1.00	
713.00	0.500	46.200	712.97	2.28	-0.22	2.28	40°13'44.646"N	104°53'06.990"W	1.29	
811.00	1.000	116.400	810.97	3.36	-0.30	3.35	40°13'44.645"N	104°53'06.976"W	0.97	TIE-ONTO MWD SURVEYS
927.00	0.810	137.040	926.95	4.87	-1.35	4.82	40°13'44.635"N	104°53'06.957"W	0.32	BEGIN BHI MWD+IFR SURVEYS
1022.00	2.500	160.850	1021.91	6.10	-3.80	5.95	40°13'44.610"N	104°53'06.942"W	1.88	
1116.00	4.890	156.570	1115.71	8.59	-9.41	8.22	40°13'44.555"N	104°53'06.913"W	2.56	
1210.00	7.300	152.200	1209.17	13.32	-18.38	12.60	40°13'44.466"N	104°53'06.857"W	2.61	
1304.00	8.410	156.860	1302.29	19.27	-29.98	18.08	40°13'44.352"N	104°53'06.786"W	1.36	
1399.00	9.890	162.270	1396.08	25.05	-44.14	23.30	40°13'44.212"N	104°53'06.719"W	1.80	
1493.00	11.600	160.030	1488.43	31.40	-60.71	28.99	40°13'44.048"N	104°53'06.645"W	1.87	
1587.00	10.790	157.770	1580.64	38.63	-77.74	35.54	40°13'43.880"N	104°53'06.561"W	0.98	
1678.00	10.180	155.160	1670.12	45.83	-92.92	42.14	40°13'43.730"N	104°53'06.476"W	0.85	
1768.00	8.840	150.010	1758.88	53.15	-106.13	48.94	40°13'43.599"N	104°53'06.388"W	1.76	
1857.00	10.240	154.890	1846.65	60.45	-119.22	55.72	40°13'43.470"N	104°53'06.301"W	1.82	
1947.00	11.040	157.770	1935.10	67.71	-134.44	62.37	40°13'43.319"N	104°53'06.215"W	1.07	
2037.00	10.200	156.520	2023.56	74.75	-149.72	68.81	40°13'43.168"N	104°53'06.132"W	0.97	
2126.00	9.710	162.300	2111.22	80.75	-164.10	74.23	40°13'43.026"N	104°53'06.062"W	1.25	
2216.00	9.790	160.880	2199.92	86.13	-178.56	79.04	40°13'42.883"N	104°53'06.000"W	0.28	
2306.00	10.530	157.730	2288.51	92.35	-193.40	84.67	40°13'42.737"N	104°53'05.927"W	1.03	
2396.00	11.540	166.450	2376.85	98.23	-209.77	89.89	40°13'42.575"N	104°53'05.860"W	2.16	
2486.00	11.410	166.260	2465.05	103.14	-227.17	94.12	40°13'42.403"N	104°53'05.806"W	0.15	
2576.00	11.000	166.320	2553.34	107.97	-244.16	98.26	40°13'42.235"N	104°53'05.752"W	0.46	
2665.00	10.040	166.360	2640.84	112.43	-259.95	102.10	40°13'42.079"N	104°53'05.703"W	1.08	
2755.00	9.260	166.860	2729.57	116.51	-274.62	105.60	40°13'41.934"N	104°53'05.658"W	0.87	
2845.00	9.910	160.880	2818.31	121.27	-288.99	109.78	40°13'41.792"N	104°53'05.604"W	1.32	
2935.00	10.470	158.650	2906.89	127.38	-303.93	115.29	40°13'41.645"N	104°53'05.533"W	0.76	
3024.00	8.970	157.150	2994.61	133.57	-317.85	120.93	40°13'41.507"N	104°53'05.460"W	1.71	
3114.00	9.800	157.350	3083.41	139.78	-331.39	126.61	40°13'41.373"N	104°53'05.387"W	0.92	
3204.00	10.830	160.820	3171.95	146.11	-346.44	132.33	40°13'41.224"N	104°53'05.313"W	1.34	
3294.00	9.690	161.530	3260.51	151.89	-361.61	137.51	40°13'41.075"N	104°53'05.246"W	1.27	
3383.00	10.730	159.150	3348.10	157.80	-376.46	142.83	40°13'40.928"N	104°53'05.178"W	1.26	
3473.00	9.810	162.180	3436.66	163.73	-391.59	148.16	40°13'40.778"N	104°53'05.109"W	1.19	
3563.00	11.100	161.750	3525.16	169.41	-407.12	153.22	40°13'40.625"N	104°53'05.044"W	1.44	
3653.00	11.390	155.420	3613.44	176.47	-423.43	159.63	40°13'40.464"N	104°53'04.961"W	1.41	
3742.00	12.000	154.530	3700.59	184.75	-439.77	167.26	40°13'40.302"N	104°53'04.863"W	0.71	
3832.00	13.440	154.580	3788.38	193.98	-457.67	175.78	40°13'40.125"N	104°53'04.753"W	1.60	

Actual Wellpath Report

JESTER 40N-14HZ AWP
Page 3 of 7

REFERENCE WELLPATH IDENTIFICATION

Operator	KERR-MCGEE OIL & GAS ONSHORE LP (WA)	Slot	SLOT#47 JESTER 40N-14HZ (1410'FNL & 265'FWL, SEC.15)
Area	COLORADO	Well	JESTER 40N-14HZ
Field	WELD COUNTY (UTM/TRUE NORTH)	Wellbore	JESTER 40N-14HZ AWP <16573>
Facility	SEC.15-T3N-R67W		

WELLPATH DATA (185 stations) † = interpolated/extrapolated station

MD [ft]	Inclination [°]	Azimuth [°]	TVD [ft]	Vert Sect [ft]	North [ft]	East [ft]	Latitude	Longitude	DLS [°/100ft]	Comments
3922.00	12.380	155.250	3876.10	203.23	-475.87	184.31	40°13'39.945"N	104°53'04.643"W	1.19	
4012.00	10.670	154.120	3964.29	211.55	-492.13	191.98	40°13'39.785"N	104°53'04.544"W	1.92	
4101.00	9.780	156.020	4051.87	218.79	-506.45	198.65	40°13'39.643"N	104°53'04.458"W	1.07	
4191.00	9.670	159.320	4140.58	225.12	-520.51	204.43	40°13'39.504"N	104°53'04.383"W	0.63	
4281.00	11.740	162.610	4229.01	231.16	-536.32	209.84	40°13'39.348"N	104°53'04.314"W	2.40	
4371.00	13.410	165.410	4316.85	237.27	-555.16	215.20	40°13'39.162"N	104°53'04.245"W	1.97	
4461.00	12.430	165.230	4404.57	243.15	-574.63	220.30	40°13'38.970"N	104°53'04.179"W	1.09	
4550.00	11.420	165.530	4491.65	248.50	-592.42	224.94	40°13'38.794"N	104°53'04.119"W	1.14	
4640.00	10.480	163.610	4580.01	253.69	-608.90	229.48	40°13'38.631"N	104°53'04.060"W	1.12	
4730.00	11.060	159.280	4668.42	259.69	-624.83	234.84	40°13'38.473"N	104°53'03.991"W	1.11	
4820.00	12.350	157.400	4756.55	267.12	-641.79	241.60	40°13'38.306"N	104°53'03.904"W	1.49	
4909.00	10.800	156.060	4843.74	274.81	-658.20	248.64	40°13'38.144"N	104°53'03.813"W	1.77	
4999.00	11.140	156.700	4932.09	282.30	-673.89	255.50	40°13'37.989"N	104°53'03.725"W	0.40	
5089.00	10.110	155.420	5020.55	289.62	-689.06	262.22	40°13'37.839"N	104°53'03.638"W	1.17	
5179.00	11.410	157.820	5108.96	296.88	-704.49	268.87	40°13'37.686"N	104°53'03.553"W	1.53	
5268.00	10.460	157.580	5196.35	303.91	-720.11	275.28	40°13'37.532"N	104°53'03.470"W	1.07	
5358.00	11.430	152.280	5284.71	311.79	-735.55	282.54	40°13'37.379"N	104°53'03.376"W	1.55	
5448.00	10.020	148.860	5373.14	320.56	-750.15	290.74	40°13'37.235"N	104°53'03.271"W	1.72	
5538.00	9.880	147.910	5461.78	329.24	-763.39	298.89	40°13'37.104"N	104°53'03.166"W	0.24	
5627.00	10.150	138.590	5549.43	338.97	-775.74	308.13	40°13'36.982"N	104°53'03.046"W	1.84	
5717.00	9.970	128.610	5638.06	350.73	-786.55	319.47	40°13'36.875"N	104°53'02.900"W	1.94	
5807.00	8.510	114.750	5726.90	363.16	-794.21	331.60	40°13'36.800"N	104°53'02.744"W	2.95	
5897.00	8.260	111.290	5815.94	375.43	-799.34	343.68	40°13'36.749"N	104°53'02.588"W	0.63	
5987.00	7.760	103.490	5905.06	387.50	-803.11	355.61	40°13'36.712"N	104°53'02.434"W	1.33	
6076.00	8.750	92.870	5993.14	400.17	-804.85	368.21	40°13'36.695"N	104°53'02.272"W	2.04	
6166.00	9.650	83.680	6081.99	414.47	-804.36	382.55	40°13'36.699"N	104°53'02.087"W	1.91	
6256.00	8.910	81.410	6170.81	428.77	-802.49	396.94	40°13'36.718"N	104°53'01.902"W	0.92	
6346.00	9.540	90.200	6259.65	443.07	-801.47	411.29	40°13'36.728"N	104°53'01.717"W	1.71	
6436.00	9.720	80.900	6348.39	457.97	-800.30	426.25	40°13'36.739"N	104°53'01.524"W	1.74	
6525.00	10.650	80.380	6435.98	473.39	-797.73	441.78	40°13'36.765"N	104°53'01.323"W	1.05	
6615.00	12.630	83.500	6524.13	491.25	-795.23	459.75	40°13'36.790"N	104°53'01.092"W	2.31	
6705.00	25.210	85.450	6609.10	520.12	-792.58	488.75	40°13'36.816"N	104°53'00.718"W	13.99	
6795.00	36.680	80.420	6686.17	565.61	-786.57	534.53	40°13'36.875"N	104°53'00.128"W	13.05	
6885.00	44.660	83.230	6754.38	623.25	-778.35	592.54	40°13'36.956"N	104°52'59.380"W	9.10	
6974.00	49.540	91.020	6815.00	688.08	-775.26	657.55	40°13'36.987"N	104°52'58.542"W	8.43	
7064.00	57.250	94.900	6868.64	760.25	-779.11	729.62	40°13'36.949"N	104°52'57.612"W	9.24	
7154.00	60.230	97.330	6915.34	836.99	-787.33	806.09	40°13'36.868"N	104°52'56.627"W	4.04	
7244.00	68.070	94.840	6954.56	917.74	-795.85	886.56	40°13'36.783"N	104°52'55.589"W	9.06	
7334.00	75.170	89.850	6982.93	1003.06	-799.27	971.82	40°13'36.750"N	104°52'54.490"W	9.48	
7405.00	81.100	90.510	6997.53	1072.47	-799.49	1041.27	40°13'36.747"N	104°52'53.595"W	8.40	
7459.00†	87.604	93.856	7002.84	1126.17	-801.54	1094.93	40°13'36.727"N	104°52'52.903"W	13.53	7" CASING POINT
7485.00	90.740	95.450	7003.22	1152.14	-803.65	1120.84	40°13'36.706"N	104°52'52.569"W	13.53	
7575.00	90.590	94.220	7002.17	1242.04	-811.24	1210.51	40°13'36.631"N	104°52'51.413"W	1.38	
7665.00	90.490	93.070	7001.32	1332.01	-816.96	1300.32	40°13'36.575"N	104°52'50.255"W	1.28	
7755.00	89.750	92.260	7001.13	1422.01	-821.14	1390.22	40°13'36.533"N	104°52'49.096"W	1.22	

Actual Wellpath Report

JESTER 40N-14HZ AWP

Page 4 of 7

REFERENCE WELLPATH IDENTIFICATION

Operator	KERR-MCGEE OIL & GAS ONSHORE LP (WA)	Slot	SLOT#47 JESTER 40N-14HZ (1410'FNL & 265'FWL, SEC.15)
Area	COLORADO	Well	JESTER 40N-14HZ
Field	WELD COUNTY (UTM/TRUE NORTH)	Wellbore	JESTER 40N-14HZ AWP <16573>
Facility	SEC.15-T3N-R67W		

WELLPATH DATA (185 stations)

MD [ft]	Inclination [°]	Azimuth [°]	TVD [ft]	Vert Sect [ft]	North [ft]	East [ft]	Latitude	Longitude	DLS [°/100ft]	Comments
7844.00	89.290	92.150	7001.88	1511.01	-824.57	1479.15	40°13'36.499"N	104°52'47.949"W	0.53	
7934.00	88.650	92.590	7003.50	1600.99	-828.29	1569.06	40°13'36.462"N	104°52'46.790"W	0.86	
8024.00	88.800	92.400	7005.50	1690.97	-832.21	1658.95	40°13'36.424"N	104°52'45.631"W	0.27	
8114.00	88.580	92.110	7007.56	1780.94	-835.75	1748.86	40°13'36.389"N	104°52'44.472"W	0.40	
8203.00	89.090	92.270	7009.37	1869.93	-839.15	1837.78	40°13'36.355"N	104°52'43.326"W	0.60	
8293.00	90.260	92.710	7009.88	1959.92	-843.06	1927.69	40°13'36.316"N	104°52'42.166"W	1.39	
8383.00	90.440	93.250	7009.33	2049.91	-847.73	2017.57	40°13'36.270"N	104°52'41.008"W	0.63	
8473.00	90.560	92.910	7008.54	2139.90	-852.57	2107.43	40°13'36.222"N	104°52'39.849"W	0.40	
8562.00	90.530	92.540	7007.70	2228.89	-856.80	2196.33	40°13'36.180"N	104°52'38.703"W	0.42	
8652.00	90.720	92.590	7006.71	2318.89	-860.83	2286.23	40°13'36.140"N	104°52'37.544"W	0.22	
8832.00	89.540	93.160	7006.31	2498.87	-869.86	2466.00	40°13'36.051"N	104°52'35.226"W	0.73	
8922.00	89.700	93.220	7006.90	2588.86	-874.87	2555.86	40°13'36.001"N	104°52'34.068"W	0.19	
9101.00	89.850	92.480	7007.61	2767.85	-883.77	2734.64	40°13'35.913"N	104°52'31.763"W	0.42	
9191.00	89.940	91.890	7007.77	2857.85	-887.20	2824.57	40°13'35.879"N	104°52'30.604"W	0.66	
9281.00	90.040	91.600	7007.79	2947.85	-889.94	2914.53	40°13'35.852"N	104°52'29.444"W	0.34	
9370.00	88.830	91.760	7008.66	3036.83	-892.55	3003.48	40°13'35.826"N	104°52'28.297"W	1.37	
9460.00	88.180	92.270	7011.01	3126.80	-895.71	3093.40	40°13'35.795"N	104°52'27.138"W	0.92	
9550.00	88.000	92.000	7014.01	3216.75	-899.06	3183.28	40°13'35.762"N	104°52'25.979"W	0.36	
9640.00	88.650	92.440	7016.64	3306.71	-902.55	3273.18	40°13'35.727"N	104°52'24.820"W	0.87	
9734.00	90.070	93.590	7017.69	3400.70	-907.49	3367.04	40°13'35.678"N	104°52'23.610"W	1.94	
9828.00	90.340	93.330	7017.36	3494.67	-913.16	3460.87	40°13'35.622"N	104°52'22.400"W	0.40	
9923.00	90.410	92.970	7016.73	3589.66	-918.38	3555.72	40°13'35.570"N	104°52'21.177"W	0.39	
10017.00	90.470	93.490	7016.01	3683.65	-923.68	3649.57	40°13'35.518"N	104°52'19.968"W	0.56	
10111.00	90.430	92.920	7015.27	3777.63	-928.93	3743.42	40°13'35.466"N	104°52'18.758"W	0.61	
10205.00	90.530	92.850	7014.49	3871.62	-933.66	3837.29	40°13'35.419"N	104°52'17.547"W	0.13	
10300.00	90.560	92.270	7013.58	3966.62	-937.91	3932.19	40°13'35.377"N	104°52'16.324"W	0.61	
10394.00	90.930	91.860	7012.36	4060.61	-941.29	4026.13	40°13'35.343"N	104°52'15.113"W	0.59	
10488.00	89.910	92.700	7011.67	4154.60	-945.03	4120.05	40°13'35.306"N	104°52'13.902"W	1.41	
10582.00	88.620	92.560	7012.88	4248.59	-949.35	4213.94	40°13'35.263"N	104°52'12.692"W	1.38	
10677.00	87.730	92.880	7015.90	4343.54	-953.85	4308.78	40°13'35.218"N	104°52'11.469"W	1.00	
10771.00	87.580	92.590	7019.75	4437.46	-958.33	4402.60	40°13'35.174"N	104°52'10.259"W	0.35	
10865.00	87.640	91.830	7023.67	4531.38	-961.96	4496.44	40°13'35.138"N	104°52'09.049"W	0.81	
10959.00	87.270	91.260	7027.84	4625.28	-964.49	4590.32	40°13'35.113"N	104°52'07.839"W	0.72	
11054.00	87.480	90.570	7032.19	4720.15	-966.00	4685.20	40°13'35.098"N	104°52'06.616"W	0.76	
11143.00	87.540	90.250	7036.06	4809.01	-966.64	4774.12	40°13'35.091"N	104°52'05.470"W	0.37	
11233.00	87.910	91.270	7039.63	4898.91	-967.83	4864.04	40°13'35.079"N	104°52'04.310"W	1.20	
11323.00	87.520	91.900	7043.22	4988.83	-970.32	4953.93	40°13'35.054"N	104°52'03.151"W	0.82	
11412.00	87.480	91.890	7047.10	5077.74	-973.26	5042.80	40°13'35.025"N	104°52'02.006"W	0.05	
11502.00	87.360	91.840	7051.15	5167.65	-976.19	5132.66	40°13'34.996"N	104°52'00.847"W	0.14	
11592.00	86.810	91.640	7055.73	5257.53	-978.92	5222.50	40°13'34.969"N	104°51'59.689"W	0.65	
11682.00	87.670	92.390	7060.07	5347.42	-982.08	5312.34	40°13'34.938"N	104°51'58.531"W	1.27	
11772.00	88.410	94.000	7063.14	5437.36	-987.09	5402.14	40°13'34.888"N	104°51'57.373"W	1.97	
11861.00	88.590	94.540	7065.47	5526.27	-993.71	5490.86	40°13'34.822"N	104°51'56.229"W	0.64	
12041.00	87.330	94.400	7071.88	5706.02	-1007.73	5670.20	40°13'34.683"N	104°51'53.917"W	0.70	
12131.00	87.480	94.240	7075.96	5795.88	-1014.51	5759.85	40°13'34.616"N	104°51'52.761"W	0.24	

Actual Wellpath Report

JESTER 40N-14HZ AWP

Page 5 of 7

REFERENCE WELLPATH IDENTIFICATION

Operator	KERR-MCGEE OIL & GAS ONSHORE LP (WA)	Slot	SLOT#47 JESTER 40N-14HZ (1410°FNL & 265°FWL, SEC.15)
Area	COLORADO	Well	JESTER 40N-14HZ
Field	WELD COUNTY (UTM/TRUE NORTH)	Wellbore	JESTER 40N-14HZ AWP <16573>
Facility	SEC.15-T3N-R67W		

WELLPATH DATA (185 stations)

MD [ft]	Inclination [°]	Azimuth [°]	TVD [ft]	Vert Sect [ft]	North [ft]	East [ft]	Latitude	Longitude	DLS [°/100ft]	Comments
12220.00	88.100	90.980	7079.39	5884.80	-1018.55	5848.68	40°13'34.576"N	104°51'51.616"W	3.73	
12311.00	87.870	89.790	7082.59	5975.69	-1019.17	5939.62	40°13'34.570"N	104°51'50.444"W	1.33	
12401.00	87.930	88.920	7085.89	6065.51	-1018.15	6029.55	40°13'34.579"N	104°51'49.284"W	0.97	
12490.00	88.730	89.510	7088.48	6154.34	-1016.93	6118.51	40°13'34.591"N	104°51'48.137"W	1.12	
12580.00	90.610	90.780	7089.00	6244.27	-1017.16	6208.50	40°13'34.589"N	104°51'46.977"W	2.52	
12670.00	89.660	92.780	7088.79	6334.26	-1019.96	6298.45	40°13'34.561"N	104°51'45.818"W	2.46	
12760.00	89.900	92.170	7089.13	6424.26	-1023.84	6388.36	40°13'34.522"N	104°51'44.658"W	0.73	
12850.00	90.310	91.790	7088.97	6514.26	-1026.95	6478.31	40°13'34.491"N	104°51'43.499"W	0.62	
12939.00	90.190	92.860	7088.58	6603.25	-1030.56	6567.23	40°13'34.455"N	104°51'42.352"W	1.21	
13029.00	88.370	93.240	7089.71	6693.24	-1035.35	6657.10	40°13'34.408"N	104°51'41.194"W	2.07	
13119.00	87.730	93.480	7092.77	6783.17	-1040.62	6746.89	40°13'34.356"N	104°51'40.036"W	0.76	
13209.00	87.510	92.630	7096.51	6873.08	-1045.42	6836.68	40°13'34.308"N	104°51'38.879"W	0.97	
13298.00	87.200	92.220	7100.62	6961.99	-1049.18	6925.51	40°13'34.271"N	104°51'37.733"W	0.58	
13388.00	86.870	92.280	7105.27	7051.86	-1052.71	7015.32	40°13'34.235"N	104°51'36.576"W	0.37	
13478.00	87.570	92.270	7109.64	7141.76	-1056.28	7105.14	40°13'34.200"N	104°51'35.418"W	0.78	
13568.00	87.640	91.980	7113.40	7231.68	-1059.61	7195.00	40°13'34.167"N	104°51'34.259"W	0.33	
13657.00	87.730	91.440	7116.99	7320.60	-1062.26	7283.89	40°13'34.140"N	104°51'33.113"W	0.61	
13747.00	87.260	90.870	7120.93	7410.50	-1064.08	7373.78	40°13'34.122"N	104°51'31.954"W	0.82	
13837.00	87.360	91.380	7125.15	7500.38	-1065.84	7463.67	40°13'34.104"N	104°51'30.795"W	0.58	
13927.00	87.570	91.250	7129.13	7590.28	-1067.90	7553.55	40°13'34.084"N	104°51'29.637"W	0.27	
14017.00	87.450	91.810	7133.04	7680.18	-1070.30	7643.44	40°13'34.060"N	104°51'28.478"W	0.64	
14106.00	86.980	91.740	7137.37	7769.07	-1073.06	7732.29	40°13'34.032"N	104°51'27.332"W	0.53	
14196.00	86.490	90.400	7142.49	7858.91	-1074.74	7822.12	40°13'34.015"N	104°51'26.174"W	1.58	
14286.00	86.830	91.450	7147.74	7948.73	-1076.19	7911.96	40°13'34.001"N	104°51'25.016"W	1.22	
14376.00	86.950	93.220	7152.62	8038.59	-1079.85	8001.75	40°13'33.964"N	104°51'23.858"W	1.97	
14466.00	88.370	94.340	7156.29	8128.48	-1085.78	8091.47	40°13'33.905"N	104°51'22.702"W	2.01	
14555.00	88.680	94.670	7158.58	8217.38	-1092.77	8180.17	40°13'33.836"N	104°51'21.558"W	0.51	
14645.00	88.060	95.550	7161.14	8307.24	-1100.78	8269.77	40°13'33.757"N	104°51'20.403"W	1.20	
14735.00	88.210	94.780	7164.07	8397.08	-1108.88	8359.36	40°13'33.676"N	104°51'19.248"W	0.87	
14825.00	89.350	94.440	7165.99	8486.98	-1116.11	8449.05	40°13'33.604"N	104°51'18.092"W	1.32	
14914.00	90.150	94.050	7166.38	8575.93	-1122.70	8537.80	40°13'33.539"N	104°51'16.948"W	1.00	
15004.00	90.060	93.760	7166.21	8665.89	-1128.82	8627.59	40°13'33.478"N	104°51'15.790"W	0.34	
15094.00	89.260	93.360	7166.75	8755.87	-1134.41	8717.42	40°13'33.423"N	104°51'14.632"W	0.99	
15184.00	88.770	93.510	7168.29	8845.84	-1139.80	8807.24	40°13'33.369"N	104°51'13.474"W	0.57	
15274.00	88.180	94.080	7170.69	8935.77	-1145.76	8897.01	40°13'33.310"N	104°51'12.317"W	0.91	
15363.00	87.290	92.650	7174.21	9024.69	-1150.98	8985.78	40°13'33.258"N	104°51'11.172"W	1.89	
15453.00	86.580	93.620	7179.02	9114.55	-1155.89	9075.52	40°13'33.209"N	104°51'10.015"W	1.33	
15543.00	87.630	94.290	7183.56	9204.39	-1162.09	9165.19	40°13'33.148"N	104°51'08.859"W	1.38	
15633.00	88.610	93.560	7186.52	9294.31	-1168.25	9254.93	40°13'33.086"N	104°51'07.703"W	1.36	
15723.00	88.550	91.010	7188.75	9384.27	-1171.84	9344.82	40°13'33.051"N	104°51'06.544"W	2.83	
15812.00	88.340	91.120	7191.16	9473.22	-1173.49	9433.77	40°13'33.034"N	104°51'05.397"W	0.27	
15902.00	87.570	91.690	7194.37	9563.15	-1175.70	9523.69	40°13'33.012"N	104°51'04.238"W	1.06	
15992.00	87.040	92.360	7198.61	9653.05	-1178.87	9613.53	40°13'32.980"N	104°51'03.079"W	0.95	
16082.00	87.290	92.100	7203.06	9742.94	-1182.37	9703.35	40°13'32.945"N	104°51'01.921"W	0.40	
16171.00	87.750	91.590	7206.91	9831.85	-1185.23	9792.22	40°13'32.916"N	104°51'00.776"W	0.77	

Actual Wellpath Report

JESTER 40N-14HZ AWP

Page 6 of 7

REFERENCE WELLPATH IDENTIFICATION

Operator	KERR-MCGEE OIL & GAS ONSHORE LP (WA)	Slot	SLOT#47 JESTER 40N-14HZ (1410'FNL & 265'FWL, SEC.15)
Area	COLORADO	Well	JESTER 40N-14HZ
Field	WELD COUNTY (UTM/TRUE NORTH)	Wellbore	JESTER 40N-14HZ AWB <16573>
Facility	SEC.15-T3N-R67W		

WELLPATH DATA (185 stations)

MD [ft]	Inclination [°]	Azimuth [°]	TVD [ft]	Vert Sect [ft]	North [ft]	East [ft]	Latitude	Longitude	DLS [°/100ft]	Comments
16261.00	86.980	91.500	7211.05	9921.75	-1187.66	9882.09	40°13'32.892"N	104°50'59.617"W	0.86	
16351.00	86.390	91.470	7216.25	10011.59	-1189.99	9971.91	40°13'32.869"N	104°50'58.459"W	0.66	
16441.00	85.530	90.790	7222.59	10101.34	-1191.76	10061.67	40°13'32.851"N	104°50'57.302"W	1.22	
16496.00	85.190	90.920	7227.04	10156.14	-1192.57	10116.48	40°13'32.843"N	104°50'56.595"W	0.66	LAST BHI MWD+IFR+MSA SURVEYS
16573.00	85.190	90.920	7233.50	10232.85	-1193.81	10193.20	40°13'32.830"N	104°50'55.606"W	0.00	PROJECTION TO BIT

HOLE & CASING SECTIONS - Ref Wellbore: JESTER 40N-14HZ AWB <16573> Ref Wellpath: JESTER 40N-14HZ AWP

String/Diameter	Start MD [ft]	End MD [ft]	Interval [ft]	Start TVD [ft]	End TVD [ft]	Start N/S [ft]	Start E/W [ft]	End N/S [ft]	End E/W [ft]
13.5in Open Hole	20.00	856.00	836.00	20.00	855.96	0.00	0.00	-0.67	4.00
9.625in Casing Surface	20.00	846.00	826.00	20.00	845.96	0.00	0.00	-0.59	3.87
8.75in Open Hole	856.00	7470.00	6614.00	855.96	7003.17	-0.67	4.00	-802.35	1105.90
7in Casing Intermediate	20.00	7459.00	7439.00	20.00	7002.84	0.00	0.00	-801.54	1094.93
6.125in Open Hole	7470.00	16573.00	9103.00	7003.17	7233.50	-802.35	1105.90	-1193.81	10193.20

TARGETS

Name	TVD [ft]	North [ft]	East [ft]	Grid East [US ft]	Grid North [US ft]	Latitude	Longitude	Shape
SEC.14-T3N-R67W SECTION LINES	4813.00	90.06	-0.54	1672434.99	14610259.10	40°13'45.538"N	104°53'07.026"W	polygon
SEC.15-T3N-R67W SECTION LINES	4813.00	90.06	-0.54	1672434.99	14610259.10	40°13'45.538"N	104°53'07.026"W	polygon
JESTER 40N-14HZ LANDBOX	7202.00	0.00	0.00	1672435.65	14610169.07	40°13'44.648"N	104°53'07.019"W	polygon
JESTER 40N-14HZ BHL ON PLAT REV-1 (2390'FNL & 3'FEL, SEC.14)	7202.00	-1195.34	10193.38	1682626.48	14608987.38	40°13'32.815"N	104°50'55.604"W	point

WELLPATH COMPOSITION - Ref Wellbore: JESTER 40N-14HZ AWB <16573> Ref Wellpath: JESTER 40N-14HZ AWP

Start MD [ft]	End MD [ft]	Positional Uncertainty Model	Log Name/Comment	Wellbore
20.00	811.00	Custom APC_ISCWSA REV 2 MWD	CATHEDRAL MWD SURVEYS 13.5" <128-811>	JESTER 40N-14HZ AWB <16573>
811.00	7405.00	Custom APC_ISCWSA REV 2 MWD+IFR1 (approximation)	BHI MWD+IFR SURVEYS 8.75" <927-7405>	JESTER 40N-14HZ AWB <16573>
7405.00	16496.00	Custom APC_ISCWSA REV 2 MWD+IFR1+MSA (approximation)	BHI MWD+IFR+MSA SURVEYS 8.75" <7485-16496>	JESTER 40N-14HZ AWB <16573>
16496.00	16573.00	Blind Drilling (std)	Projection to bit	JESTER 40N-14HZ AWB <16573>



Actual Wellpath Report

JESTER 40N-14HZ AWP
Page 7 of 7



REFERENCE WELLPATH IDENTIFICATION			
Operator	KERR-MCGEE OIL & GAS ONSHORE LP (WA)	Slot	SLOT#47 JESTER 40N-14HZ (1410'FNL & 265'FWL, SEC.15)
Area	COLORADO	Well	JESTER 40N-14HZ
Field	WELD COUNTY (UTM/TRUE NORTH)	Wellbore	JESTER 40N-14HZ AWB <16573>
Facility	SEC.15-T3N-R67W		

WELLPATH COMMENTS				
MD [ft]	Inclination [°]	Azimuth [°]	TVD [ft]	Comment
128.00	0.300	245.100	128.00	BEGIN MWD SURVEYS
811.00	1.000	116.400	810.97	TIE-ONTO MWD SURVEYS
927.00	0.810	137.040	926.95	BEGIN BHI MWD+IFR SURVEYS
7459.00	87.604	93.856	7002.84	7" CASING POINT
16496.00	85.190	90.920	7227.04	LAST BHI MWD+IFR+MSA SURVEYS
16573.00	85.190	90.920	7233.50	PROJECTION TO BIT