

MEADER 5-N PAD LOCATION DRAWING

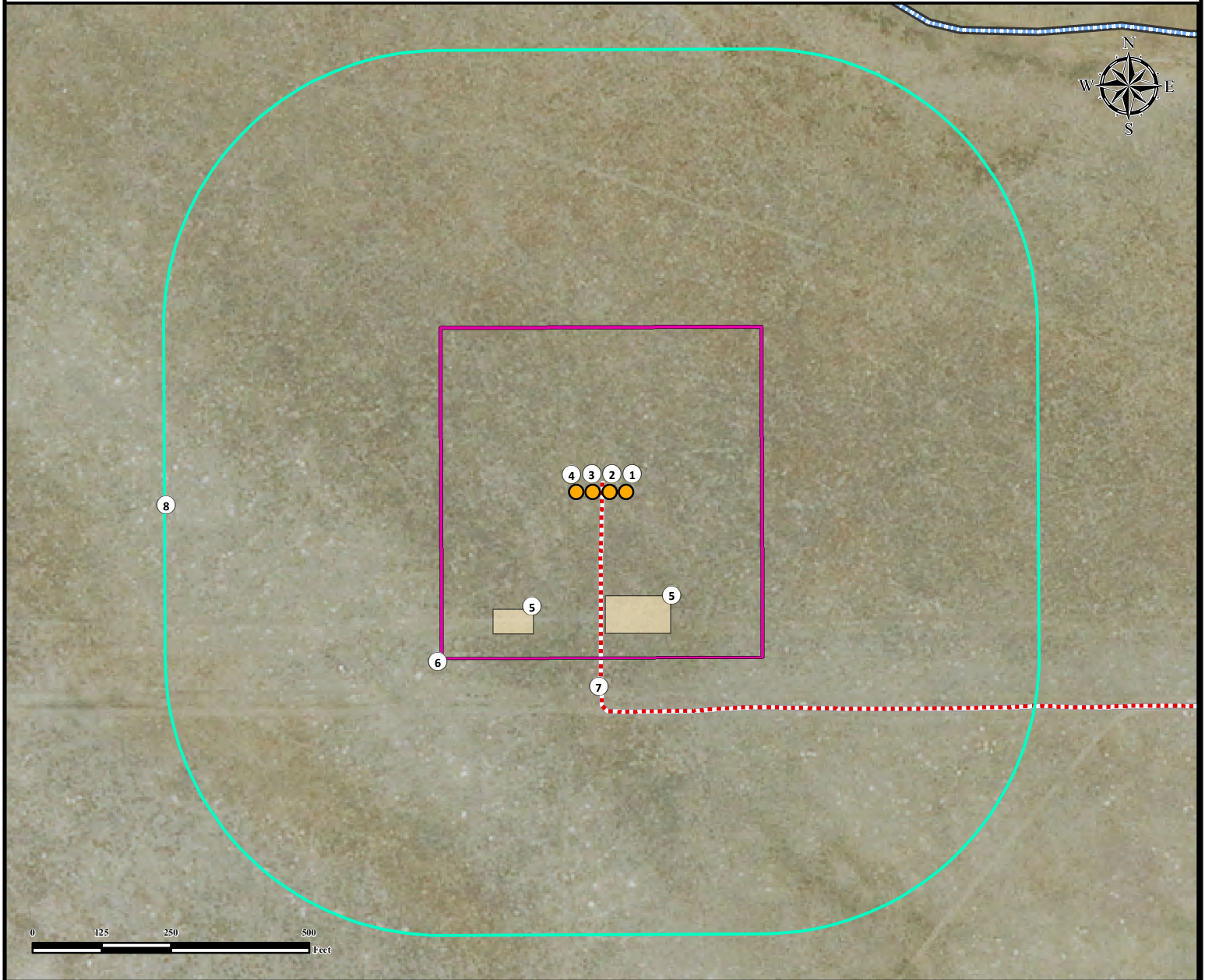

1. Proposed Well MEADER 1.
2. Proposed Well MEADER 2.
3. Proposed Well MEADER 3.
4. Proposed Well MEADER 4.
5. Proposed Facilities.
6. Operational Disturbance Area.
7. Access Road.
8. 500' Buffer.

Legend

- Proposed Well
- Disturbance Area
- 500' Radius
- Proposed Facilities
- Proposed Access Road
- Stream

Measured from Nearest Well or Facility

Building -	>5280' E
Building Unit -	>5280' E
Surface Water (Stream) -	±1040' NE
Public Road - (Co Rd 7)	±2676' E
Prop. Line (MEADER RANCH INC)	±350' S
Utility (Power Line) -	±2592' E
Railroad -	±5280' E

Measured from Nearest Well

Water Well (Field Verified) -	±1643' S
Water Well - ±4025' NE	SWL = 49'
Permit: 22575	Receipt: 9062931

Reference Location

**** MEADER 3 ****
 Lat: 40.945030° Long:-104.456916°
 (NAD83)
 Elevation: 5337 Feet
 350 FSL & 2604 FWL
 PDOP: 2.1
 Operator: Alan Hnizdo

Disturbance Acreage:

7.98 Acres Drilling Operations
 3.99 Acres Interim Reclaim

Current Surface Use: Rangeland
 Future Surface Use: Rangeland



FIELD DATE:

06-24-15

DRAWING DATE:

08-10-15

BY:

FMB

CHECKED BY:

JMJ

SITE NAME:

MEADER 5-N PAD

SURFACE LOCATION:

SE1/4 SW1/4 SEC. 5, T11N, R63W, 6TH P.M.

WELD COUNTY, COLORADO

PREPARED FOR:

