

JOHNSON TRUST 13-I PAD PAD LAYOUT

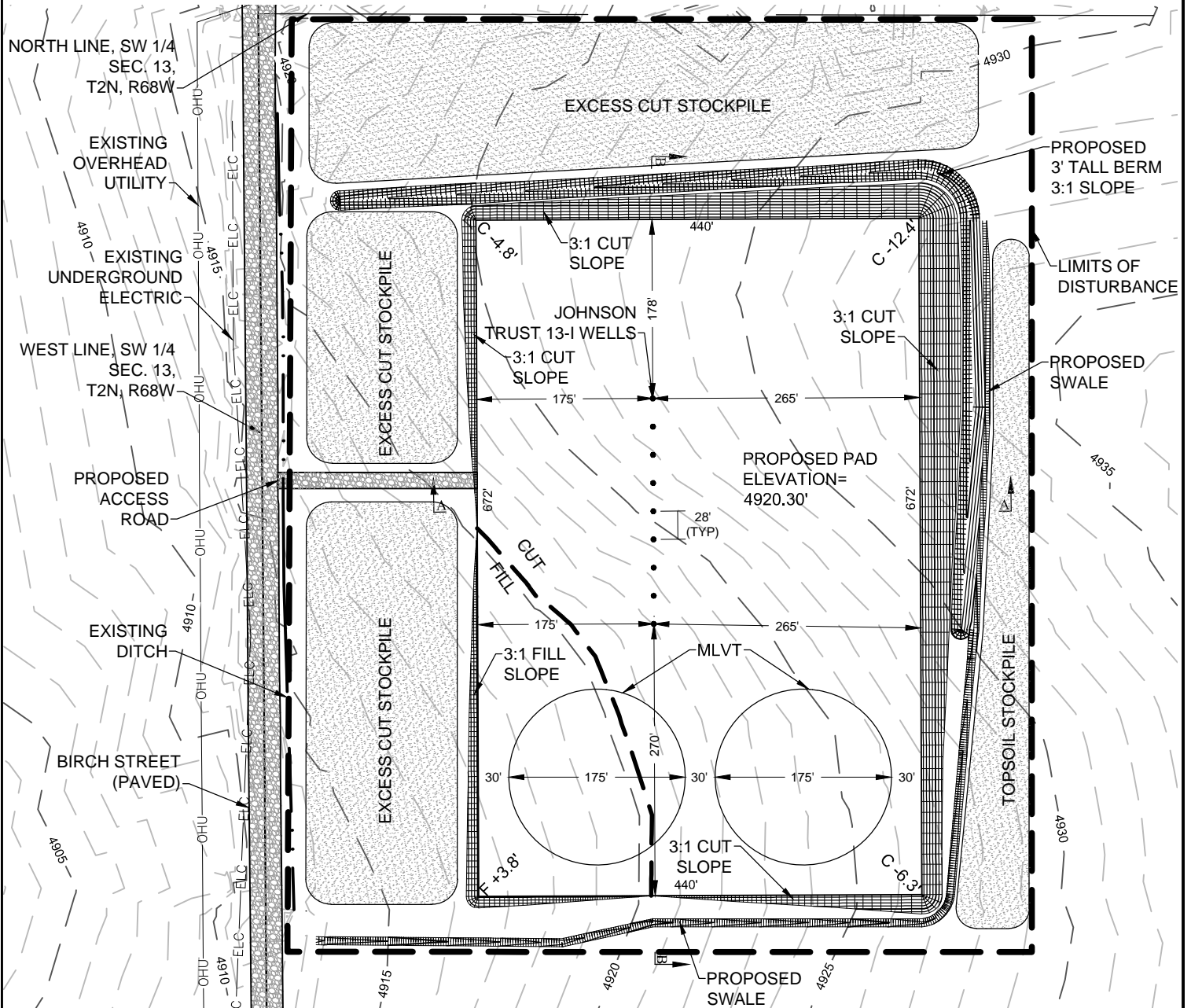

NOTES:

1. A COMPLETE UTILITIES LOCATION IS RECOMMENDED BEFORE CONSTRUCTION.
2. GEOGRAPHIC POSITIONS/COORDINATES SHOWN HEREON ARE IN NAD83 DATUM.
3. EARTHWORK QUANTITIES ARE APPROXIMATE & FOR INFORMATION ONLY. 6" OF TOPSOIL HAS BEEN SUBTRACTED FROM EXISTING SURFACE PRIOR TO PERFORMING EARTHWORK CALCULATIONS.
4. STOCKPILES ARE ASSUMED TO BE 10' IN HEIGHT WITH 2:1 SIDE SLOPES.

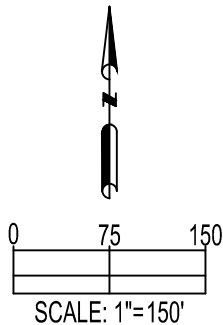

SITE QUANTITIES

FINISHED GRADE ELEVATION	4920.30'
TOTAL CUT FOR WELL PAD	58,805 CY
FILL FOR WELL PAD	5,270 CY
10% FILL FACTOR	527 CY
TOTAL FILL	5,797 CY
NET EXCESS MATERIAL	53,008 CY
MATERIAL TO BE EXPORTED	10,700 CY
TOPSOIL FROM GRADED AREA	6,275 CY
TOTAL DISTURBANCE AREA	15.7 ACRES

PREPARED BY:



FIELD DATE:

03-18-15

DRAWING DATE:

07-28-15

BY:

KAD

CHECKED BY:

WDW

SITE NAME:

JOHNSON TRUST 13-I PAD

SURFACE LOCATION:

NW 1/4 SW 1/4, SEC. 13, T2N, R68W, 6TH P.M.
WELD COUNTY, COLORADO

PREPARED FOR:



JOHNSON TRUST 13-I PAD CROSS SECTIONS

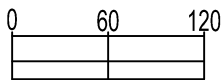
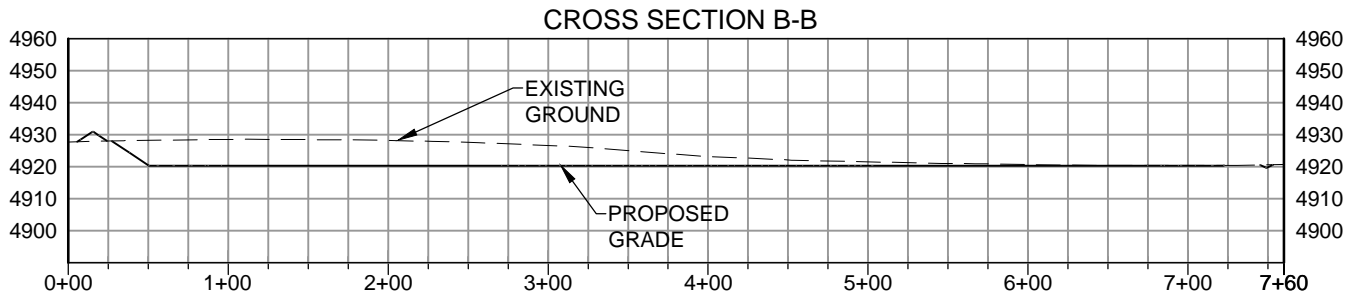
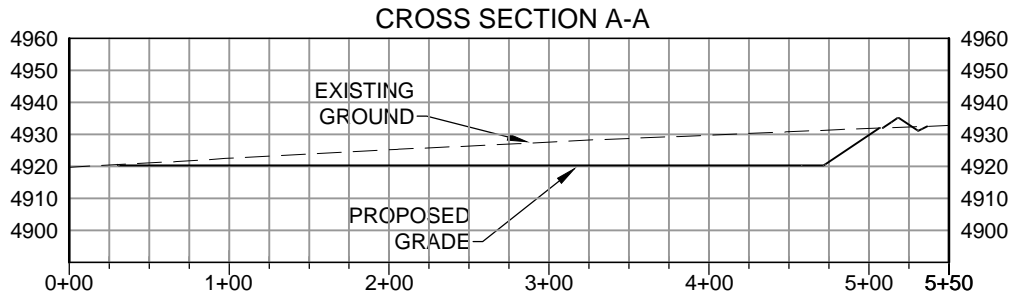

SCALE: 1"=120'
VERT SCALE: 1"=60'

NOTE:

1. A COMPLETE UTILITIES LOCATION IS RECOMMENDED BEFORE CONSTRUCTION.
2. GEOGRAPHIC POSITIONS/COORDINATES SHOWN HEREON ARE IN NAD83 DATUM.

PREPARED BY:



FIELD DATE:

03-18-15

SITE NAME:

JOHNSON TRUST 13-I PAD

DRAWING DATE:

07-28-15

SURFACE LOCATION:

NW 1/4 SW 1/4, SEC. 13, T2N, R68W, 6TH P.M.
WELD COUNTY, COLORADO

BY:

KAD

CHECKED BY:

WDW

PREPARED FOR:



JOHNSON TRUST 13-I PAD PRODUCTION LAYOUT

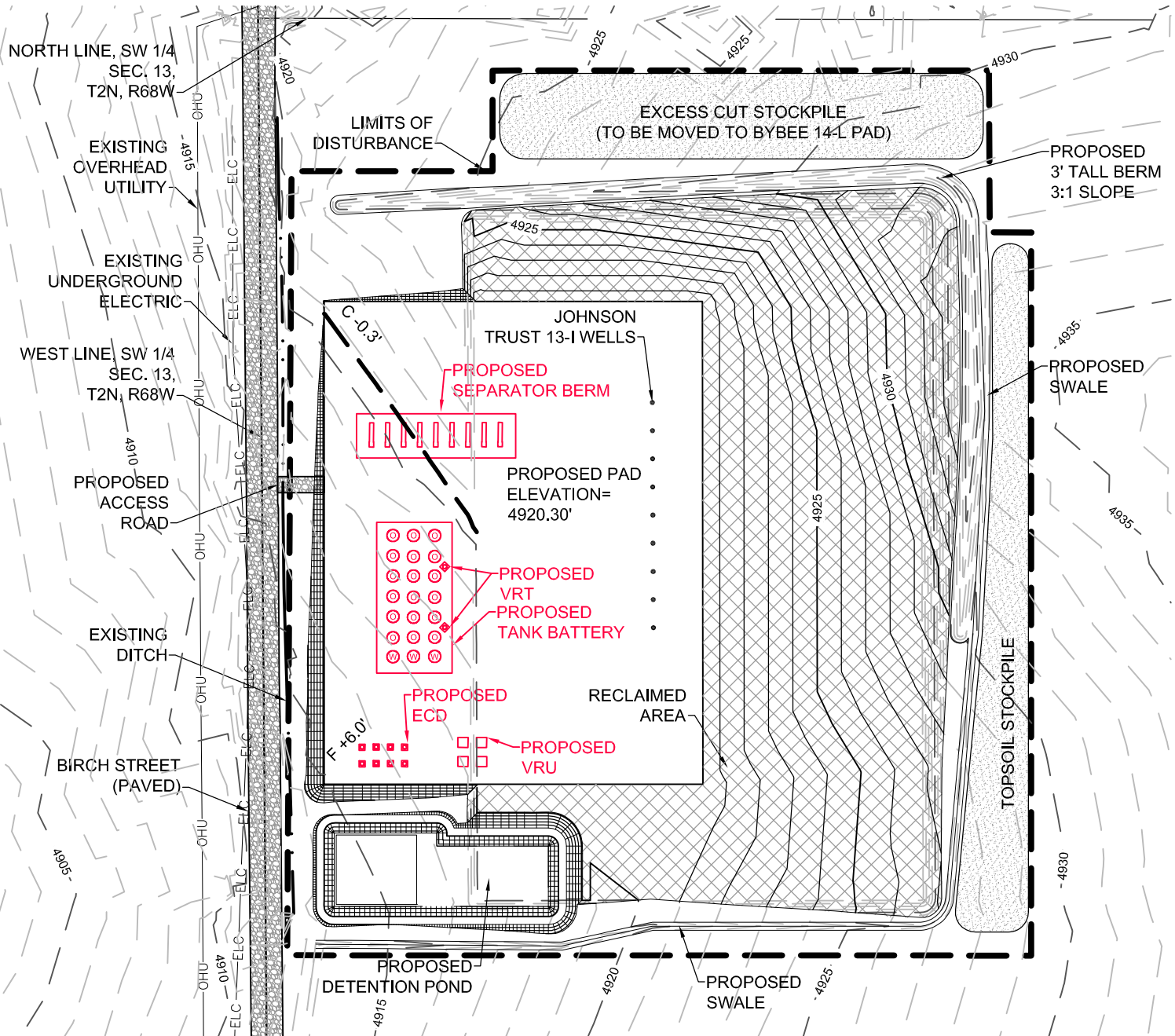

NOTES:

1. A COMPLETE UTILITIES LOCATION IS RECOMMENDED BEFORE CONSTRUCTION.
2. GEOGRAPHIC POSITIONS/COORDINATES SHOWN HEREON ARE IN NAD83 DATUM.
3. EARTHWORK QUANTITIES ARE APPROXIMATE & FOR INFORMATION ONLY. 6" OF TOPSOIL HAS BEEN SUBTRACTED FROM EXISTING SURFACE PRIOR TO PERFORMING EARTHWORK CALCULATIONS.
4. STOCKPILES ARE ASSUMED TO BE 10' IN HEIGHT WITH 2:1 SIDE SLOPES.

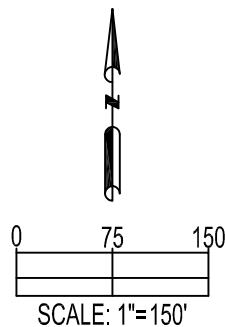

SITE QUANTITIES

FINISHED GRADE ELEVATION	4920.30'
TOTAL CUT FOR PRODUCTION PAD	1,134 CY
FILL FOR PRODUCTION PAD	39,470 CY
10% FILL FACTOR	3,949 CY
TOTAL FILL	43,419 CY
NET FILL MATERIAL	42,285 CY
EXCESS CUT FROM DRILL PAD	53,008 CY
MATERIAL TO BE EXPORTED	10,700 CY
NET STOCKPILED CUT MATERIAL	0 CY
TOPSOIL FROM GRADED AREA	1,527 CY
TOTAL DISTURBANCE AREA	14.3 ACRES

PREPARED BY:



FIELD DATE:

03-18-15

DRAWING DATE:

07-28-15

BY:

KAD

CHECKED BY:

WDW

SITE NAME:

JOHNSON TRUST 13-I PAD

SURFACE LOCATION:

NW 1/4 SW 1/4, SEC. 13, T2N, R68W, 6TH P.M.
WELD COUNTY, COLORADO

PREPARED FOR:

