

**Fox Creek 536-2524H**  
 Sec.25-T12N-R63W  
 Weld County, Colorado

Surface Location			
NAD 1927 (NADCON CONUS) Colorado North 501			
Ground Elevation: 5407.0 RKB @ 5432.0usft (KB GL+25')			
Northing	Easting	Latitude	Longitude
600050.67	2308478.09	40° 58' 30.694 N	104° 22' 58.518 W

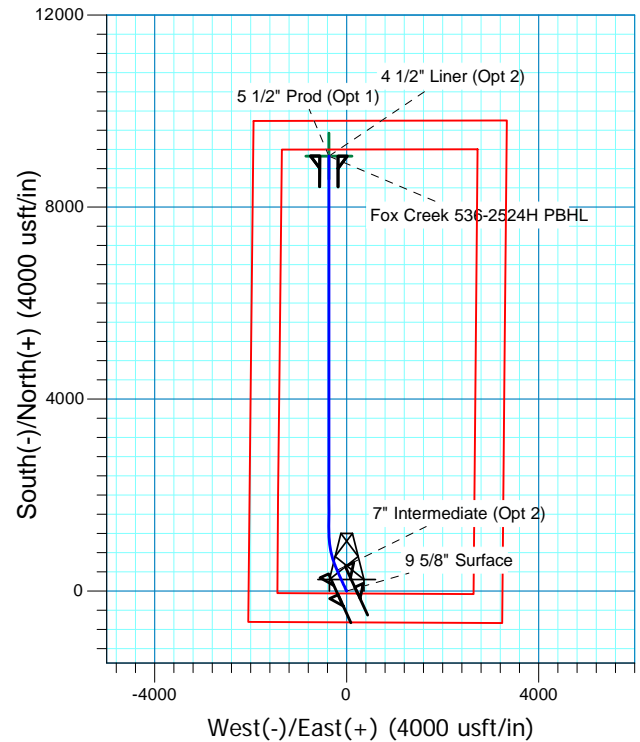
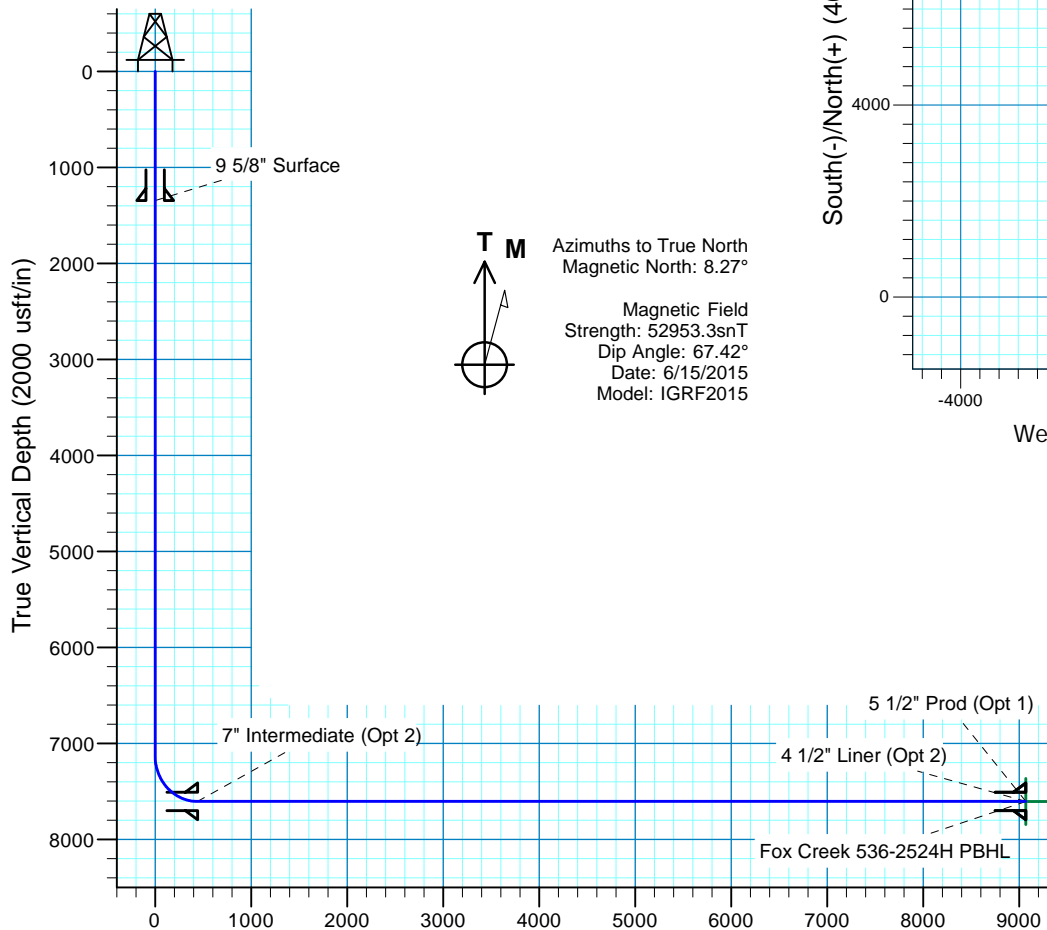

Project: DJ - Hereford Ranch  
 Site: Fox Creek F25 SESW Pad  
 Well: Fox Creek 536-2524H  
 Plan: APD Plan (Plat Cert 5/12/15)

Vertical Section at 357.68° (2000 usft/in)

SECTION DETAILS										
Sec	MD	Inc	Azi	TVD	+N/-S	+E/-W	Dleg	TFace	VSect	Target
1	0.0	0.00	0.00	0.0	0.0	0.0	0.00	0.00	0.0	
2	7128.5	0.00	0.00	7128.5	0.0	0.0	0.00	0.00	0.0	
3	7878.5	90.00	335.60	7606.0	434.8	-197.2	12.00	335.60	442.5	
4	8691.8	90.00	0.00	7606.0	1223.8	-367.8	3.00	90.00	1237.7	Fox Creek 536-2524H PBHL
5	16529.4	90.00	0.00	7606.0	9061.4	-367.8	0.00	0.00	9068.8	Fox Creek 536-2524H PBHL
TARGET DETAILS										
Name	TVD	+N/-S	+E/-W	Northing	Easting	Latitude	Longitude	Shape		
Fox Creek 536-2524H PBHL	7606.0	9061.4	-367.8	609106.69	2307996.19	41° 0' 0.224 N	104° 23' 3.315 W	Point		

# **Denver Division- Colorado**

**DJ - Hereford Ranch  
Fox Creek F25 SESW Pad  
Fox Creek 536-2524H**

**OH**

**Plan: APD Plan (Plat Cert 5/12/15)**

## **Standard Planning Report**

**16 June, 2015**

# EOG Resources, Inc.

## Planning Report

<b>Database:</b>	EDM_DENVER	<b>Local Co-ordinate Reference:</b>	Well Fox Creek 536-2524H
<b>Company:</b>	Denver Division- Colorado	<b>TVD Reference:</b>	RKB @ 5432.0usft (KB GL+25')
<b>Project:</b>	DJ - Hereford Ranch	<b>MD Reference:</b>	RKB @ 5432.0usft (KB GL+25')
<b>Site:</b>	Fox Creek F25 SESW Pad	<b>North Reference:</b>	True
<b>Well:</b>	Fox Creek 536-2524H	<b>Survey Calculation Method:</b>	Minimum Curvature
<b>Wellbore:</b>	OH		
<b>Design:</b>	APD Plan (Plat Cert 5/12/15)		

<b>Project</b>	DJ - Hereford Ranch, Weld County		
<b>Map System:</b>	US State Plane 1927 (Exact solution)	<b>System Datum:</b>	Mean Sea Level
<b>Geo Datum:</b>	NAD 1927 (NADCON CONUS)		
<b>Map Zone:</b>	Colorado North 501		

<b>Site</b>	Fox Creek F25 SESW Pad		
<b>Site Position:</b>		<b>Northing:</b>	600,100.00 usft
<b>From:</b>	Map	<b>Easting:</b>	2,308,450.00 usft
<b>Position Uncertainty:</b>	0.0 usft	<b>Slot Radius:</b>	13-3/16 "
		<b>Latitude:</b>	40° 58' 31.185 N
		<b>Longitude:</b>	104° 22' 58.877 W
		<b>Grid Convergence:</b>	0.72 °

<b>Well</b>	Fox Creek 536-2524H		
<b>Well Position</b>	<b>+N/-S</b>	-49.7 usft	<b>Northing:</b>
	<b>+E/-W</b>	27.5 usft	<b>Easting:</b>
<b>Position Uncertainty</b>	0.0 usft	<b>Wellhead Elevation:</b>	0.0 usft
		<b>Latitude:</b>	40° 58' 30.694 N
		<b>Longitude:</b>	104° 22' 58.518 W
		<b>Ground Level:</b>	5,407.0 usft

<b>Wellbore</b>	OH				
<b>Magnetics</b>	<b>Model Name</b>	<b>Sample Date</b>	<b>Declination (°)</b>	<b>Dip Angle (°)</b>	<b>Field Strength (nT)</b>
	IGRF2015	6/15/2015	8.26	67.42	52,953

<b>Design</b>	APD Plan (Plat Cert 5/12/15)			
<b>Audit Notes:</b>				
<b>Version:</b>	<b>Phase:</b>	PROTOTYPE	<b>Tie On Depth:</b>	0.0
<b>Vertical Section:</b>	<b>Depth From (TVD) (usft)</b>	<b>+N/-S (usft)</b>	<b>+E/-W (usft)</b>	<b>Direction (°)</b>
	0.0	0.0	0.0	357.68

<b>Plan Sections</b>										
<b>Measured Depth (usft)</b>	<b>Inclination (°)</b>	<b>Azimuth (°)</b>	<b>Vertical Depth (usft)</b>	<b>+N/-S (usft)</b>	<b>+E/-W (usft)</b>	<b>Dogleg Rate (°/100usft)</b>	<b>Build Rate (°/100usft)</b>	<b>Turn Rate (°/100usft)</b>	<b>TFO (°)</b>	<b>Target</b>
0.0	0.00	0.00	0.0	0.0	0.0	0.00	0.00	0.00	0.00	
7,128.5	0.00	0.00	7,128.5	0.0	0.0	0.00	0.00	0.00	0.00	
7,878.5	90.00	335.60	7,606.0	434.8	-197.2	12.00	12.00	0.00	335.60	
8,691.8	90.00	0.00	7,606.0	1,223.8	-367.8	3.00	0.00	3.00	90.00	Fox Creek 536-2524H
16,529.4	90.00	0.00	7,606.0	9,061.4	-367.8	0.00	0.00	0.00	0.00	Fox Creek 536-2524H

# EOG Resources, Inc.

## Planning Report

<b>Database:</b>	EDM_DENVER	<b>Local Co-ordinate Reference:</b>	Well Fox Creek 536-2524H
<b>Company:</b>	Denver Division- Colorado	<b>TVD Reference:</b>	RKB @ 5432.0usft (KB GL+25')
<b>Project:</b>	DJ - Hereford Ranch	<b>MD Reference:</b>	RKB @ 5432.0usft (KB GL+25')
<b>Site:</b>	Fox Creek F25 SESW Pad	<b>North Reference:</b>	True
<b>Well:</b>	Fox Creek 536-2524H	<b>Survey Calculation Method:</b>	Minimum Curvature
<b>Wellbore:</b>	OH		
<b>Design:</b>	APD Plan (Plat Cert 5/12/15)		

Planned Survey									
Measured Depth (usft)	Inclination (°)	Azimuth (°)	Vertical Depth (usft)	+N/-S (usft)	+E/-W (usft)	Vertical Section (usft)	Dogleg Rate (°/100usft)	Build Rate (°/100usft)	Turn Rate (°/100usft)
0.0	0.00	0.00	0.0	0.0	0.0	0.0	0.00	0.00	0.00
100.0	0.00	0.00	100.0	0.0	0.0	0.0	0.00	0.00	0.00
200.0	0.00	0.00	200.0	0.0	0.0	0.0	0.00	0.00	0.00
300.0	0.00	0.00	300.0	0.0	0.0	0.0	0.00	0.00	0.00
400.0	0.00	0.00	400.0	0.0	0.0	0.0	0.00	0.00	0.00
500.0	0.00	0.00	500.0	0.0	0.0	0.0	0.00	0.00	0.00
600.0	0.00	0.00	600.0	0.0	0.0	0.0	0.00	0.00	0.00
700.0	0.00	0.00	700.0	0.0	0.0	0.0	0.00	0.00	0.00
800.0	0.00	0.00	800.0	0.0	0.0	0.0	0.00	0.00	0.00
900.0	0.00	0.00	900.0	0.0	0.0	0.0	0.00	0.00	0.00
1,000.0	0.00	0.00	1,000.0	0.0	0.0	0.0	0.00	0.00	0.00
1,100.0	0.00	0.00	1,100.0	0.0	0.0	0.0	0.00	0.00	0.00
1,200.0	0.00	0.00	1,200.0	0.0	0.0	0.0	0.00	0.00	0.00
1,300.0	0.00	0.00	1,300.0	0.0	0.0	0.0	0.00	0.00	0.00
1,346.0	0.00	0.00	1,346.0	0.0	0.0	0.0	0.00	0.00	0.00
9 5/8" Surface									
1,400.0	0.00	0.00	1,400.0	0.0	0.0	0.0	0.00	0.00	0.00
1,500.0	0.00	0.00	1,500.0	0.0	0.0	0.0	0.00	0.00	0.00
1,600.0	0.00	0.00	1,600.0	0.0	0.0	0.0	0.00	0.00	0.00
1,700.0	0.00	0.00	1,700.0	0.0	0.0	0.0	0.00	0.00	0.00
1,800.0	0.00	0.00	1,800.0	0.0	0.0	0.0	0.00	0.00	0.00
1,900.0	0.00	0.00	1,900.0	0.0	0.0	0.0	0.00	0.00	0.00
2,000.0	0.00	0.00	2,000.0	0.0	0.0	0.0	0.00	0.00	0.00
2,100.0	0.00	0.00	2,100.0	0.0	0.0	0.0	0.00	0.00	0.00
2,200.0	0.00	0.00	2,200.0	0.0	0.0	0.0	0.00	0.00	0.00
2,300.0	0.00	0.00	2,300.0	0.0	0.0	0.0	0.00	0.00	0.00
2,400.0	0.00	0.00	2,400.0	0.0	0.0	0.0	0.00	0.00	0.00
2,500.0	0.00	0.00	2,500.0	0.0	0.0	0.0	0.00	0.00	0.00
2,600.0	0.00	0.00	2,600.0	0.0	0.0	0.0	0.00	0.00	0.00
2,700.0	0.00	0.00	2,700.0	0.0	0.0	0.0	0.00	0.00	0.00
2,800.0	0.00	0.00	2,800.0	0.0	0.0	0.0	0.00	0.00	0.00
2,900.0	0.00	0.00	2,900.0	0.0	0.0	0.0	0.00	0.00	0.00
3,000.0	0.00	0.00	3,000.0	0.0	0.0	0.0	0.00	0.00	0.00
3,100.0	0.00	0.00	3,100.0	0.0	0.0	0.0	0.00	0.00	0.00
3,200.0	0.00	0.00	3,200.0	0.0	0.0	0.0	0.00	0.00	0.00
3,300.0	0.00	0.00	3,300.0	0.0	0.0	0.0	0.00	0.00	0.00
3,400.0	0.00	0.00	3,400.0	0.0	0.0	0.0	0.00	0.00	0.00
3,500.0	0.00	0.00	3,500.0	0.0	0.0	0.0	0.00	0.00	0.00
3,600.0	0.00	0.00	3,600.0	0.0	0.0	0.0	0.00	0.00	0.00
3,700.0	0.00	0.00	3,700.0	0.0	0.0	0.0	0.00	0.00	0.00
3,800.0	0.00	0.00	3,800.0	0.0	0.0	0.0	0.00	0.00	0.00
3,900.0	0.00	0.00	3,900.0	0.0	0.0	0.0	0.00	0.00	0.00
4,000.0	0.00	0.00	4,000.0	0.0	0.0	0.0	0.00	0.00	0.00
4,100.0	0.00	0.00	4,100.0	0.0	0.0	0.0	0.00	0.00	0.00
4,200.0	0.00	0.00	4,200.0	0.0	0.0	0.0	0.00	0.00	0.00
4,300.0	0.00	0.00	4,300.0	0.0	0.0	0.0	0.00	0.00	0.00
4,400.0	0.00	0.00	4,400.0	0.0	0.0	0.0	0.00	0.00	0.00
4,500.0	0.00	0.00	4,500.0	0.0	0.0	0.0	0.00	0.00	0.00
4,600.0	0.00	0.00	4,600.0	0.0	0.0	0.0	0.00	0.00	0.00
4,700.0	0.00	0.00	4,700.0	0.0	0.0	0.0	0.00	0.00	0.00
4,800.0	0.00	0.00	4,800.0	0.0	0.0	0.0	0.00	0.00	0.00
4,900.0	0.00	0.00	4,900.0	0.0	0.0	0.0	0.00	0.00	0.00
5,000.0	0.00	0.00	5,000.0	0.0	0.0	0.0	0.00	0.00	0.00
5,100.0	0.00	0.00	5,100.0	0.0	0.0	0.0	0.00	0.00	0.00

# EOG Resources, Inc.

## Planning Report

<b>Database:</b>	EDM_DENVER	<b>Local Co-ordinate Reference:</b>	Well Fox Creek 536-2524H
<b>Company:</b>	Denver Division- Colorado	<b>TVD Reference:</b>	RKB @ 5432.0usft (KB GL+25')
<b>Project:</b>	DJ - Hereford Ranch	<b>MD Reference:</b>	RKB @ 5432.0usft (KB GL+25')
<b>Site:</b>	Fox Creek F25 SESW Pad	<b>North Reference:</b>	True
<b>Well:</b>	Fox Creek 536-2524H	<b>Survey Calculation Method:</b>	Minimum Curvature
<b>Wellbore:</b>	OH		
<b>Design:</b>	APD Plan (Plat Cert 5/12/15)		

Planned Survey									
Measured Depth (usft)	Inclination (°)	Azimuth (°)	Vertical Depth (usft)	+N/-S (usft)	+E/-W (usft)	Vertical Section (usft)	Dogleg Rate (°/100usft)	Build Rate (°/100usft)	Turn Rate (°/100usft)
5,200.0	0.00	0.00	5,200.0	0.0	0.0	0.0	0.00	0.00	0.00
5,300.0	0.00	0.00	5,300.0	0.0	0.0	0.0	0.00	0.00	0.00
5,400.0	0.00	0.00	5,400.0	0.0	0.0	0.0	0.00	0.00	0.00
5,500.0	0.00	0.00	5,500.0	0.0	0.0	0.0	0.00	0.00	0.00
5,600.0	0.00	0.00	5,600.0	0.0	0.0	0.0	0.00	0.00	0.00
5,700.0	0.00	0.00	5,700.0	0.0	0.0	0.0	0.00	0.00	0.00
5,800.0	0.00	0.00	5,800.0	0.0	0.0	0.0	0.00	0.00	0.00
5,900.0	0.00	0.00	5,900.0	0.0	0.0	0.0	0.00	0.00	0.00
6,000.0	0.00	0.00	6,000.0	0.0	0.0	0.0	0.00	0.00	0.00
6,100.0	0.00	0.00	6,100.0	0.0	0.0	0.0	0.00	0.00	0.00
6,200.0	0.00	0.00	6,200.0	0.0	0.0	0.0	0.00	0.00	0.00
6,300.0	0.00	0.00	6,300.0	0.0	0.0	0.0	0.00	0.00	0.00
6,400.0	0.00	0.00	6,400.0	0.0	0.0	0.0	0.00	0.00	0.00
6,500.0	0.00	0.00	6,500.0	0.0	0.0	0.0	0.00	0.00	0.00
6,600.0	0.00	0.00	6,600.0	0.0	0.0	0.0	0.00	0.00	0.00
6,700.0	0.00	0.00	6,700.0	0.0	0.0	0.0	0.00	0.00	0.00
6,800.0	0.00	0.00	6,800.0	0.0	0.0	0.0	0.00	0.00	0.00
6,900.0	0.00	0.00	6,900.0	0.0	0.0	0.0	0.00	0.00	0.00
7,000.0	0.00	0.00	7,000.0	0.0	0.0	0.0	0.00	0.00	0.00
7,100.0	0.00	0.00	7,100.0	0.0	0.0	0.0	0.00	0.00	0.00
7,128.5	0.00	0.00	7,128.5	0.0	0.0	0.0	0.00	0.00	0.00
7,200.0	8.58	335.60	7,199.7	4.9	-2.2	5.0	12.00	12.00	0.00
7,300.0	20.58	335.60	7,296.3	27.7	-12.6	28.2	12.00	12.00	0.00
7,400.0	32.58	335.60	7,385.6	68.4	-31.0	69.6	12.00	12.00	0.00
7,500.0	44.58	335.60	7,463.6	125.1	-56.8	127.3	12.00	12.00	0.00
7,600.0	56.58	335.60	7,527.0	195.3	-88.6	198.8	12.00	12.00	0.00
7,700.0	68.58	335.60	7,573.0	276.0	-125.2	280.9	12.00	12.00	0.00
7,800.0	80.58	335.60	7,599.5	363.7	-165.0	370.0	12.00	12.00	0.00
7,878.5	90.00	335.60	7,606.0	434.8	-197.2	442.5	12.00	12.00	0.00
7,879.0	90.00	335.62	7,606.0	435.3	-197.4	442.9	3.00	0.00	3.00
7" Intermediate (Opt 2)									
7,900.0	90.00	336.25	7,606.0	454.4	-206.0	462.4	3.00	0.00	3.00
8,000.0	90.00	339.25	7,606.0	547.0	-243.9	556.4	3.00	0.00	3.00
8,100.0	90.00	342.25	7,606.0	641.4	-276.9	652.1	3.00	0.00	3.00
8,200.0	90.00	345.25	7,606.0	737.4	-304.8	749.1	3.00	0.00	3.00
8,300.0	90.00	348.25	7,606.0	834.7	-327.8	847.3	3.00	0.00	3.00
8,400.0	90.00	351.25	7,606.0	933.1	-345.6	946.3	3.00	0.00	3.00
8,500.0	90.00	354.25	7,606.0	1,032.3	-358.2	1,046.0	3.00	0.00	3.00
8,600.0	90.00	357.25	7,606.0	1,132.0	-365.6	1,145.9	3.00	0.00	3.00
8,691.8	90.00	0.00	7,606.0	1,223.8	-367.8	1,237.7	3.00	0.00	3.00
8,700.0	90.00	0.00	7,606.0	1,232.0	-367.8	1,245.9	0.00	0.00	0.00
8,800.0	90.00	0.00	7,606.0	1,332.0	-367.8	1,345.8	0.00	0.00	0.00
8,900.0	90.00	0.00	7,606.0	1,432.0	-367.8	1,445.7	0.00	0.00	0.00
9,000.0	90.00	0.00	7,606.0	1,532.0	-367.8	1,545.6	0.00	0.00	0.00
9,100.0	90.00	0.00	7,606.0	1,632.0	-367.8	1,645.5	0.00	0.00	0.00
9,200.0	90.00	0.00	7,606.0	1,732.0	-367.8	1,745.4	0.00	0.00	0.00
9,300.0	90.00	0.00	7,606.0	1,832.0	-367.8	1,845.4	0.00	0.00	0.00
9,400.0	90.00	0.00	7,606.0	1,932.0	-367.8	1,945.3	0.00	0.00	0.00
9,500.0	90.00	0.00	7,606.0	2,032.0	-367.8	2,045.2	0.00	0.00	0.00
9,600.0	90.00	0.00	7,606.0	2,132.0	-367.8	2,145.1	0.00	0.00	0.00
9,700.0	90.00	0.00	7,606.0	2,232.0	-367.8	2,245.0	0.00	0.00	0.00
9,800.0	90.00	0.00	7,606.0	2,332.0	-367.8	2,345.0	0.00	0.00	0.00
9,900.0	90.00	0.00	7,606.0	2,432.0	-367.8	2,444.9	0.00	0.00	0.00

# EOG Resources, Inc.

## Planning Report

<b>Database:</b>	EDM_DENVER	<b>Local Co-ordinate Reference:</b>	Well Fox Creek 536-2524H
<b>Company:</b>	Denver Division- Colorado	<b>TVD Reference:</b>	RKB @ 5432.0usft (KB GL+25')
<b>Project:</b>	DJ - Hereford Ranch	<b>MD Reference:</b>	RKB @ 5432.0usft (KB GL+25')
<b>Site:</b>	Fox Creek F25 SESW Pad	<b>North Reference:</b>	True
<b>Well:</b>	Fox Creek 536-2524H	<b>Survey Calculation Method:</b>	Minimum Curvature
<b>Wellbore:</b>	OH		
<b>Design:</b>	APD Plan (Plat Cert 5/12/15)		

Planned Survey									
Measured Depth (usft)	Inclination (°)	Azimuth (°)	Vertical Depth (usft)	+N/-S (usft)	+E/-W (usft)	Vertical Section (usft)	Dogleg Rate (°/100usft)	Build Rate (°/100usft)	Turn Rate (°/100usft)
10,000.0	90.00	0.00	7,606.0	2,532.0	-367.8	2,544.8	0.00	0.00	0.00
10,100.0	90.00	0.00	7,606.0	2,632.0	-367.8	2,644.7	0.00	0.00	0.00
10,200.0	90.00	0.00	7,606.0	2,732.0	-367.8	2,744.6	0.00	0.00	0.00
10,300.0	90.00	0.00	7,606.0	2,832.0	-367.8	2,844.5	0.00	0.00	0.00
10,400.0	90.00	0.00	7,606.0	2,932.0	-367.8	2,944.5	0.00	0.00	0.00
10,500.0	90.00	0.00	7,606.0	3,032.0	-367.8	3,044.4	0.00	0.00	0.00
10,600.0	90.00	0.00	7,606.0	3,132.0	-367.8	3,144.3	0.00	0.00	0.00
10,700.0	90.00	0.00	7,606.0	3,232.0	-367.8	3,244.2	0.00	0.00	0.00
10,800.0	90.00	0.00	7,606.0	3,332.0	-367.8	3,344.1	0.00	0.00	0.00
10,900.0	90.00	0.00	7,606.0	3,432.0	-367.8	3,444.1	0.00	0.00	0.00
11,000.0	90.00	0.00	7,606.0	3,532.0	-367.8	3,544.0	0.00	0.00	0.00
11,100.0	90.00	0.00	7,606.0	3,632.0	-367.8	3,643.9	0.00	0.00	0.00
11,200.0	90.00	0.00	7,606.0	3,732.0	-367.8	3,743.8	0.00	0.00	0.00
11,300.0	90.00	0.00	7,606.0	3,832.0	-367.8	3,843.7	0.00	0.00	0.00
11,400.0	90.00	0.00	7,606.0	3,932.0	-367.8	3,943.6	0.00	0.00	0.00
11,500.0	90.00	0.00	7,606.0	4,032.0	-367.8	4,043.6	0.00	0.00	0.00
11,600.0	90.00	0.00	7,606.0	4,132.0	-367.8	4,143.5	0.00	0.00	0.00
11,700.0	90.00	0.00	7,606.0	4,232.0	-367.8	4,243.4	0.00	0.00	0.00
11,800.0	90.00	0.00	7,606.0	4,332.0	-367.8	4,343.3	0.00	0.00	0.00
11,900.0	90.00	0.00	7,606.0	4,432.0	-367.8	4,443.2	0.00	0.00	0.00
12,000.0	90.00	0.00	7,606.0	4,532.0	-367.8	4,543.1	0.00	0.00	0.00
12,100.0	90.00	0.00	7,606.0	4,632.0	-367.8	4,643.1	0.00	0.00	0.00
12,200.0	90.00	0.00	7,606.0	4,732.0	-367.8	4,743.0	0.00	0.00	0.00
12,300.0	90.00	0.00	7,606.0	4,832.0	-367.8	4,842.9	0.00	0.00	0.00
12,400.0	90.00	0.00	7,606.0	4,932.0	-367.8	4,942.8	0.00	0.00	0.00
12,500.0	90.00	0.00	7,606.0	5,032.0	-367.8	5,042.7	0.00	0.00	0.00
12,600.0	90.00	0.00	7,606.0	5,132.0	-367.8	5,142.7	0.00	0.00	0.00
12,700.0	90.00	0.00	7,606.0	5,232.0	-367.8	5,242.6	0.00	0.00	0.00
12,800.0	90.00	0.00	7,606.0	5,332.0	-367.8	5,342.5	0.00	0.00	0.00
12,900.0	90.00	0.00	7,606.0	5,432.0	-367.8	5,442.4	0.00	0.00	0.00
13,000.0	90.00	0.00	7,606.0	5,532.0	-367.8	5,542.3	0.00	0.00	0.00
13,100.0	90.00	0.00	7,606.0	5,632.0	-367.8	5,642.2	0.00	0.00	0.00
13,200.0	90.00	0.00	7,606.0	5,732.0	-367.8	5,742.2	0.00	0.00	0.00
13,300.0	90.00	0.00	7,606.0	5,832.0	-367.8	5,842.1	0.00	0.00	0.00
13,400.0	90.00	0.00	7,606.0	5,932.0	-367.8	5,942.0	0.00	0.00	0.00
13,500.0	90.00	0.00	7,606.0	6,032.0	-367.8	6,041.9	0.00	0.00	0.00
13,600.0	90.00	0.00	7,606.0	6,132.0	-367.8	6,141.8	0.00	0.00	0.00
13,700.0	90.00	0.00	7,606.0	6,232.0	-367.8	6,241.7	0.00	0.00	0.00
13,800.0	90.00	0.00	7,606.0	6,332.0	-367.8	6,341.7	0.00	0.00	0.00
13,900.0	90.00	0.00	7,606.0	6,432.0	-367.8	6,441.6	0.00	0.00	0.00
14,000.0	90.00	0.00	7,606.0	6,532.0	-367.8	6,541.5	0.00	0.00	0.00
14,100.0	90.00	0.00	7,606.0	6,632.0	-367.8	6,641.4	0.00	0.00	0.00
14,200.0	90.00	0.00	7,606.0	6,732.0	-367.8	6,741.3	0.00	0.00	0.00
14,300.0	90.00	0.00	7,606.0	6,832.0	-367.8	6,841.3	0.00	0.00	0.00
14,400.0	90.00	0.00	7,606.0	6,932.0	-367.8	6,941.2	0.00	0.00	0.00
14,500.0	90.00	0.00	7,606.0	7,032.0	-367.8	7,041.1	0.00	0.00	0.00
14,600.0	90.00	0.00	7,606.0	7,132.0	-367.8	7,141.0	0.00	0.00	0.00
14,700.0	90.00	0.00	7,606.0	7,232.0	-367.8	7,240.9	0.00	0.00	0.00
14,800.0	90.00	0.00	7,606.0	7,332.0	-367.8	7,340.8	0.00	0.00	0.00
14,900.0	90.00	0.00	7,606.0	7,432.0	-367.8	7,440.8	0.00	0.00	0.00
15,000.0	90.00	0.00	7,606.0	7,532.0	-367.8	7,540.7	0.00	0.00	0.00
15,100.0	90.00	0.00	7,606.0	7,632.0	-367.8	7,640.6	0.00	0.00	0.00
15,200.0	90.00	0.00	7,606.0	7,732.0	-367.8	7,740.5	0.00	0.00	0.00
15,300.0	90.00	0.00	7,606.0	7,832.0	-367.8	7,840.4	0.00	0.00	0.00

# EOG Resources, Inc.

## Planning Report

<b>Database:</b>	EDM_DENVER	<b>Local Co-ordinate Reference:</b>	Well Fox Creek 536-2524H
<b>Company:</b>	Denver Division- Colorado	<b>TVD Reference:</b>	RKB @ 5432.0usft (KB GL+25')
<b>Project:</b>	DJ - Hereford Ranch	<b>MD Reference:</b>	RKB @ 5432.0usft (KB GL+25')
<b>Site:</b>	Fox Creek F25 SESW Pad	<b>North Reference:</b>	True
<b>Well:</b>	Fox Creek 536-2524H	<b>Survey Calculation Method:</b>	Minimum Curvature
<b>Wellbore:</b>	OH		
<b>Design:</b>	APD Plan (Plat Cert 5/12/15)		

Planned Survey										
Measured Depth (usft)	Inclination (°)	Azimuth (°)	Vertical Depth (usft)	+N/-S (usft)	+E/-W (usft)	Vertical Section (usft)	Dogleg Rate (°/100usft)	Build Rate (°/100usft)	Turn Rate (°/100usft)	
15,400.0	90.00	0.00	7,606.0	7,932.0	-367.8	7,940.3	0.00	0.00	0.00	
15,500.0	90.00	0.00	7,606.0	8,032.0	-367.8	8,040.3	0.00	0.00	0.00	
15,600.0	90.00	0.00	7,606.0	8,132.0	-367.8	8,140.2	0.00	0.00	0.00	
15,700.0	90.00	0.00	7,606.0	8,232.0	-367.8	8,240.1	0.00	0.00	0.00	
15,800.0	90.00	0.00	7,606.0	8,332.0	-367.8	8,340.0	0.00	0.00	0.00	
15,900.0	90.00	0.00	7,606.0	8,432.0	-367.8	8,439.9	0.00	0.00	0.00	
16,000.0	90.00	0.00	7,606.0	8,532.0	-367.8	8,539.9	0.00	0.00	0.00	
16,100.0	90.00	0.00	7,606.0	8,632.0	-367.8	8,639.8	0.00	0.00	0.00	
16,200.0	90.00	0.00	7,606.0	8,732.0	-367.8	8,739.7	0.00	0.00	0.00	
16,300.0	90.00	0.00	7,606.0	8,832.0	-367.8	8,839.6	0.00	0.00	0.00	
16,400.0	90.00	0.00	7,606.0	8,932.0	-367.8	8,939.5	0.00	0.00	0.00	
16,500.0	90.00	0.00	7,606.0	9,032.0	-367.8	9,039.4	0.00	0.00	0.00	
16,529.0	90.00	0.00	7,606.0	9,061.0	-367.8	9,068.4	0.00	0.00	0.00	
5 1/2" Prod (Opt 1) - 4 1/2" Liner (Opt 2)										
16,529.4	90.00	0.00	7,606.0	9,061.4	-367.8	9,068.8	0.00	0.00	0.00	

Design Targets										
Target Name	Dip Angle (°)	Dip Dir. (°)	TVD (usft)	+N/-S (usft)	+E/-W (usft)	Northing (usft)	Easting (usft)	Latitude		Longitude
- hit/miss target										
- Shape										
Fox Creek 536-2524H P	0.00	0.00	7,606.0	9,061.4	-367.8	609,106.69	2,307,996.19	41° 0' 0.224 N		104° 23' 3.315 W
- plan hits target center										
- Point										

Casing Points						
Measured Depth (usft)	Vertical Depth (usft)	Name			Casing Diameter (")	Hole Diameter (")
1,346.0	1,346.0	9 5/8" Surface			9-5/8	13-1/2
7,879.0	7,606.0	7" Intermediate (Opt 2)			7	8-3/4
16,529.0	7,606.0	5 1/2" Prod (Opt 1)			5-1/2	7-7/8
16,529.0	7,606.0	4 1/2" Liner (Opt 2)			4-1/2	6-1/8