

T11N

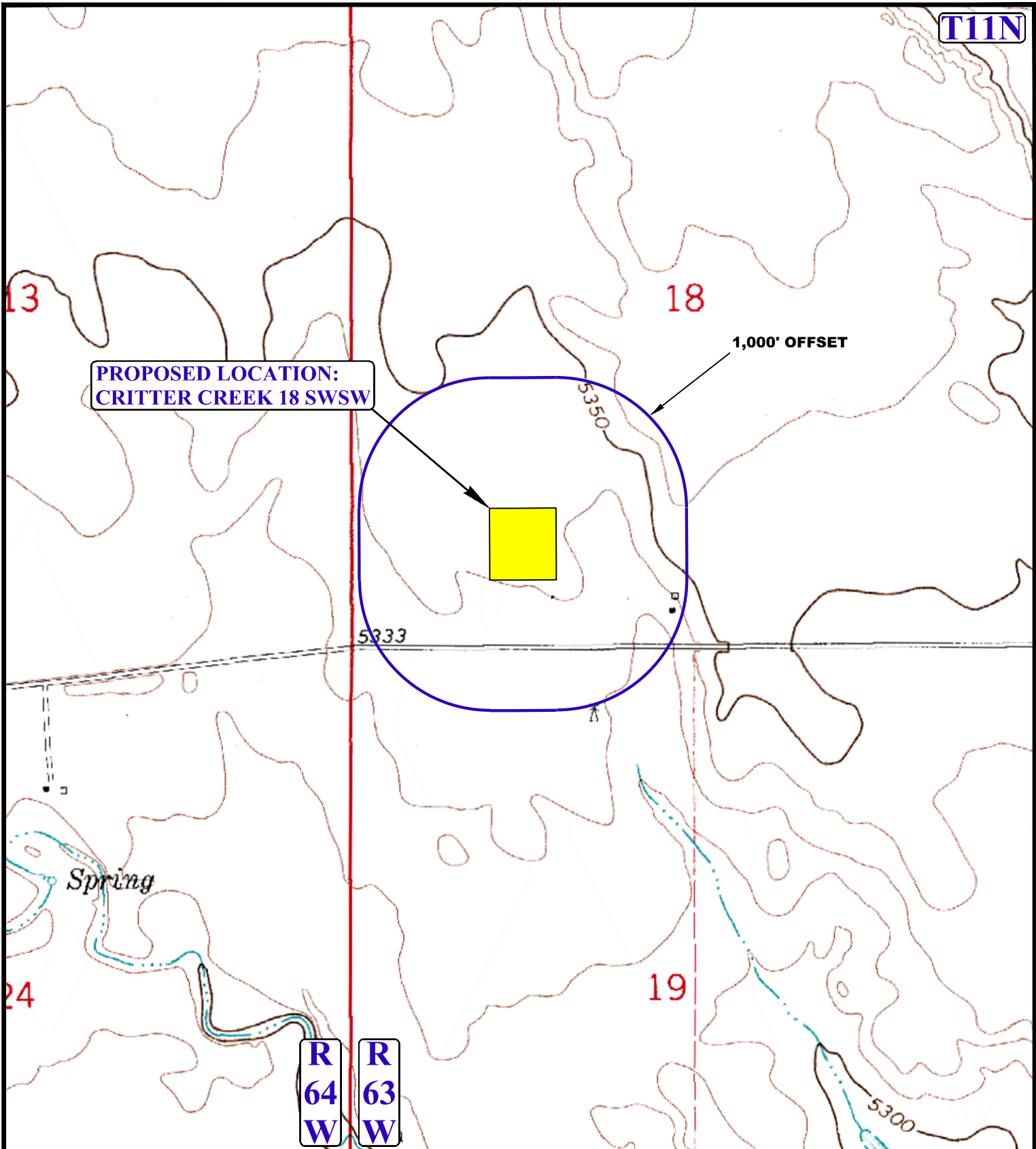

**PROPOSED LOCATION:
CRITTER CREEK 18 SWSW**

1,000' OFFSET

Spring

**R
64
W** **R
63
W**

LEGEND:

1000' OFFSET BOUNDARY



EOG RESOURCES, INC.

**CRITTER CREEK 18 SWSW
SECTION 18, T11N, R63W, 6th P.M.
SW 1/4
WELD COUNTY, COLORADO**

DRAWN BY: R.C.	DATE DRAWN: 04-01-15
SCALE: 1" = 1000'	REVISED: 04-23-15
HYDROLOGY MAP	TOPO W



UELS, LLC
Corporate Office * 85 South 200 East
Vernal, UT 84078 * (435) 789-1017