



Physical Address: 345 Comanche St.
Mail to: Box 384, Kiowa, CO 80117
Ph. 303-621-8672 - Fax 303-621-7749
www.highprairiesurvey.com

Job # 15249 Bout Time #1-24

Inv # 3983

High Prairie Surveying of Kiowa, Colorado, has in accordance with a request from **Grand Mesa Operating Company**, determined the location of **Bout Time #1-24** to be **223 feet FSL**, and **1588 feet FWL**, (90° off Section lines) of **SECTION 24**, Township **2s**, Range **51w** of the 6th Principal Meridian, **Washington County**, Colorado.

Date: Staked 06/22/15 drawn on 06/30/15.

Re: Staked by Elijah Frane
Drawn: Drawn by Dustin Cotter

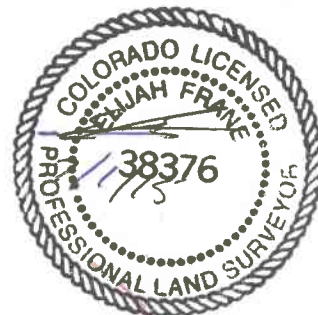

1000' Hydrology Map

There is indicated surface water approximately 866' Northeast of the proposed well pad at its closest point.

Grand Mesa Operating Company
SW1/4 SEC. 24-2s-51w
Bout Time #1-24
Washington County, Colorado

