

Location:	COLORADO	Slot:	SLOT#08 NORTH PLATTE FEDERAL F-J-22HNC (717'FNL & 1206'FWL, SEC.22)
Field:	WELD COUNTY	Well:	NORTH PLATTE FEDERAL F-J-22HNC
Facility:	SEC.22-T5N-R63W	Wellbore:	NORTH PLATTE FEDERAL F-J-22HNC PWB

True vertical depths are referenced to XTREME 22 (17Kb) (RKB)	Grid System: NAD83 / Lambert Colorado SP, Northern Zone (501), US feet
Measured depths are referenced to XTREME 22 (17Kb) (RKB)	North Reference: True north
XTREME 22 (17Kb) (RKB) to Mean Sea Level: 4679 feet	Scale: True distance
Mean Sea Level to Mud line (At Slot: SLOT#08 NORTH PLATTE FEDERAL F-J-22HNC (717FNL & 1206FWL, SEC.22)): 0 feet	Depths are in feet
Coordinates are in feet referenced to Slot	Created by: ingmjnm on 6/16/2015

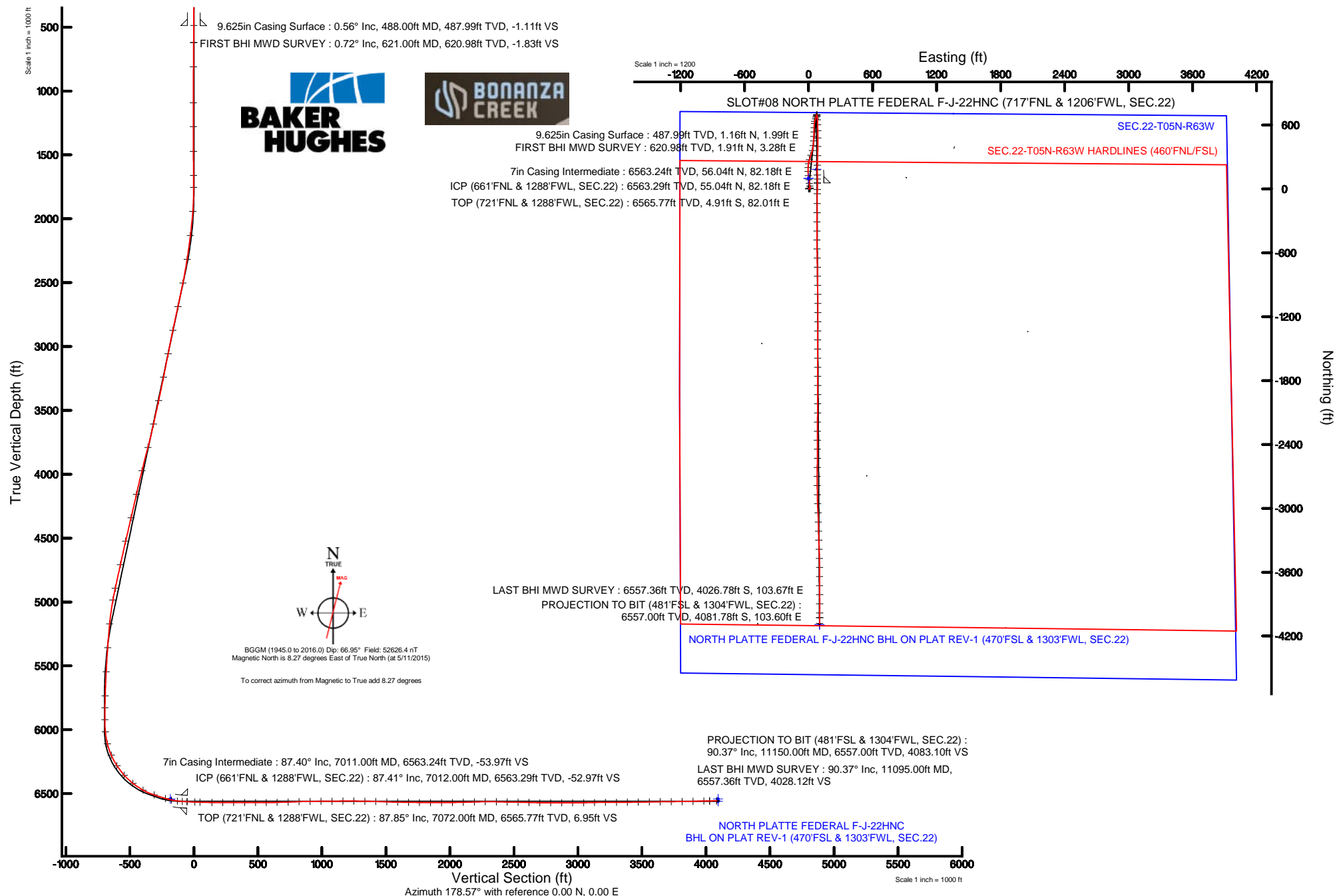



Actual Wellpath Report

NORTH PLATTE FEDERAL F-J-22HNC AWP

Page 1 of 7



REFERENCE WELLPATH IDENTIFICATION

Operator	BONANZA CREEK OIL COMPANY	Slot	SLOT#08 NORTH PLATTE FEDERAL F-J-22HNC (717'FNL & 1206'FWL, SEC.22)
Area	COLORADO	Well	NORTH PLATTE FEDERAL F-J-22HNC
Field	WELD COUNTY	Wellbore	NORTH PLATTE FEDERAL F-J-22HNC AWB
Facility	SEC.22-T5N-R63W		

REPORT SETUP INFORMATION

Projection System	NAD83 / Lambert Colorado SP, Northern Zone (501), US feet	Software System	WellArchitect® 4.1.1
North Reference	True	User	Ingmjmr
Scale	0.99996	Report Generated	6/16/2015 at 10:00:30 AM
Convergence at slot	0.69° East	Database/Source file	Denver/NORTH_PLATTE_FEDERAL_F-J-22HNC_AWB.xml

WELLPATH LOCATION

	Local coordinates		Grid coordinates		Geographic coordinates	
	North[ft]	East[ft]	Easting[US ft]	Northing[US ft]	Latitude	Longitude
Slot Location	-394.11	-1370.22	3298928.61	1386790.81	40°23'24.637"N	104°25'36.541"W
Facility Reference Pt			3300293.87	1387201.53	40°23'28.532"N	104°25'18.833"W
Field Reference Pt			3335925.10	1457282.25	40°34'56.460"N	104°17'26.016"W

WELLPATH DATUM

Calculation method	Minimum curvature	XTREME 22 (17'KB) (RKB) to Facility Vertical Datum	4679.00ft
Horizontal Reference Pt	Slot	XTREME 22 (17'KB) (RKB) to Mean Sea Level	4679.00ft
Vertical Reference Pt	XTREME 22 (17'KB) (RKB)	XTREME 22 (17'KB) (RKB) to Mud Line at Slot (SLOT#08 NORTH PLATTE FEDERAL F-J-22HNC (717'FNL & 1206'FWL, SEC.22))	4679.00ft
MD Reference Pt	XTREME 22 (17'KB) (RKB)	Section Origin	N 0.00, E 0.00 ft
Field Vertical Reference	Mean Sea Level	Section Azimuth	178.57°



Actual Wellpath Report

NORTH PLATTE FEDERAL F-J-22HNC AWP

Page 2 of 7



REFERENCE WELLPATH IDENTIFICATION

Operator	BONANZA CREEK OIL COMPANY	Slot	SLOT#08 NORTH PLATTE FEDERAL F-J-22HNC (717'FNL & 1206'FWL, SEC.22)
Area	COLORADO	Well	NORTH PLATTE FEDERAL F-J-22HNC
Field	WELD COUNTY	Wellbore	NORTH PLATTE FEDERAL F-J-22HNC AWB
Facility	SEC.22-T5N-R63W		

WELLPATH DATA (96 stations) † = interpolated/extrapolated station

MD [ft]	Inclination [°]	Azimuth [°]	TVD [ft]	Vert Sect [ft]	North [ft]	East [ft]	DLS [°/100ft]	Comments
0.00†	0.000	59.760	0.00	0.00	0.00	0.00	0.00	
17.00	0.000	59.760	17.00	0.00	0.00	0.00	0.00	
621.00	0.720	59.760	620.98	-1.83	1.91	3.28	0.12	FIRST BHI MWD SURVEY
810.00	0.780	50.060	809.97	-3.20	3.34	5.29	0.07	
1093.00	0.600	94.970	1092.95	-4.24	4.44	8.24	0.20	
1280.00	0.630	95.690	1279.94	-4.00	4.26	10.24	0.02	
1472.00	0.560	105.190	1471.93	-3.60	3.91	12.20	0.06	
1661.00	0.650	119.030	1660.92	-2.79	3.14	14.03	0.09	
1755.00	0.790	127.050	1754.91	-2.12	2.49	15.01	0.18	
1943.00	4.450	348.210	1942.74	-8.49	8.86	14.55	2.70	
2132.00	7.000	349.710	2130.78	-27.09	27.37	11.00	1.35	
2321.00	8.740	352.350	2318.00	-52.74	52.93	7.03	0.94	
2509.00	11.630	353.530	2503.01	-85.83	85.93	2.99	1.54	
2698.00	12.340	352.080	2687.89	-124.87	124.86	-1.94	0.41	
2887.00	11.760	359.380	2872.74	-164.20	164.12	-4.93	0.86	
3074.00	11.140	1.120	3056.02	-201.30	201.24	-4.78	0.38	
3261.00	11.220	8.940	3239.48	-237.24	237.28	-1.60	0.81	
3449.00	13.030	18.690	3423.30	-275.14	275.43	8.03	1.45	
3638.00	13.210	19.020	3607.36	-315.38	316.03	21.90	0.10	
3826.00	15.090	14.510	3789.66	-359.04	360.03	35.03	1.16	
4015.00	13.900	5.460	3972.66	-405.25	406.45	43.36	1.35	
4204.00	12.820	3.900	4156.54	-448.66	449.97	46.94	0.60	
4393.00	13.040	3.700	4340.75	-490.78	492.17	49.75	0.12	
4581.00	12.960	358.070	4523.94	-532.98	534.41	50.40	0.67	
4769.00	12.330	4.280	4707.39	-574.04	575.50	51.19	0.80	
4958.00	12.350	5.970	4892.02	-614.16	615.72	54.80	0.19	
5052.00	10.450	13.880	4984.17	-632.36	634.00	57.89	2.61	
5240.00	5.860	17.990	5170.22	-657.87	659.69	64.95	2.46	
5428.00	4.250	16.210	5357.48	-673.56	675.51	69.86	0.86	
5617.00	2.900	11.670	5546.11	-684.89	686.92	72.78	0.73	



Actual Wellpath Report

NORTH PLATTE FEDERAL F-J-22HNC AWP

Page 3 of 7



REFERENCE WELLPATH IDENTIFICATION

Operator	BONANZA CREEK OIL COMPANY	Slot	SLOT#08 NORTH PLATTE FEDERAL F-J-22HNC (717'FNL & 1206'FWL, SEC.22)
Area	COLORADO	Well	NORTH PLATTE FEDERAL F-J-22HNC
Field	WELD COUNTY	Wellbore	NORTH PLATTE FEDERAL F-J-22HNC AWB
Facility	SEC.22-T5N-R63W		

WELLPATH DATA (96 stations) † = interpolated/extrapolated station

MD [ft]	Inclination [°]	Azimuth [°]	TVD [ft]	Vert Sect [ft]	North [ft]	East [ft]	DLS [°/100ft]	Comments
5805.00	2.050	19.170	5733.93	-692.67	694.75	74.85	0.48	
5899.00	1.240	62.270	5827.90	-694.69	696.81	76.30	1.51	
5993.00	0.950	72.180	5921.88	-695.36	697.53	77.94	0.37	
6087.00	5.320	172.770	6015.75	-691.24	693.44	79.23	5.93	
6182.00	13.430	174.370	6109.40	-675.83	678.06	80.87	8.54	
6276.00	24.090	176.150	6198.28	-645.69	647.97	83.24	11.36	
6370.00	32.910	179.100	6280.81	-600.90	603.21	84.93	9.50	
6464.00	40.910	178.210	6355.91	-544.49	546.82	86.30	8.53	
6558.00	52.720	180.240	6420.13	-476.09	478.41	87.10	12.66	
6653.00	60.230	180.410	6472.56	-396.99	399.27	86.65	7.91	
6747.00	72.300	181.820	6510.33	-311.19	313.40	84.93	12.91	
6841.00	73.660	181.820	6537.84	-221.45	223.57	82.07	1.45	
6888.00	77.570	179.730	6549.52	-175.97	178.06	81.47	9.37	
6936.00	82.200	178.960	6557.94	-128.73	130.82	82.01	9.77	
6974.00	87.130	180.180	6561.48	-90.92	93.00	82.29	13.36	
7012.00†	87.408	180.169	6563.29	-52.97	55.04	82.18	0.73	ICP (661'FNL & 1288'FWL, SEC.22)
7072.00†	87.847	180.152	6565.77	6.95	-4.91	82.01	0.73	TOP (721'FNL & 1288'FWL, SEC.22)
7112.00	88.140	180.140	6567.17	46.91	-44.88	81.91	0.73	
7205.00	89.440	180.610	6569.13	139.84	-137.86	81.30	1.49	
7290.00	89.470	180.900	6569.94	224.78	-222.84	80.18	0.34	
7376.00	90.580	180.440	6569.91	310.72	-308.84	79.17	1.40	
7462.00	89.780	180.590	6569.64	396.67	-394.83	78.40	0.95	
7547.00	90.490	179.380	6569.43	481.64	-479.83	78.42	1.65	
7631.00	89.500	179.160	6569.44	565.63	-563.82	79.49	1.21	
7716.00	91.730	178.890	6568.53	650.62	-648.80	80.94	2.64	
7802.00	91.780	179.120	6565.90	736.58	-734.75	82.43	0.27	
7887.00	91.900	179.200	6563.17	821.53	-819.69	83.68	0.17	
7973.00	90.670	179.140	6561.24	907.50	-905.66	84.92	1.43	
8058.00	90.990	179.320	6560.01	992.48	-990.64	86.06	0.43	
8144.00	89.840	179.420	6559.38	1078.47	-1076.64	87.01	1.34	



Actual Wellpath Report

NORTH PLATTE FEDERAL F-J-22HNC AWP

Page 4 of 7



REFERENCE WELLPATH IDENTIFICATION

Operator	BONANZA CREEK OIL COMPANY	Slot	SLOT#08 NORTH PLATTE FEDERAL F-J-22HNC (717'FNL & 1206'FWL, SEC.22)
Area	COLORADO	Well	NORTH PLATTE FEDERAL F-J-22HNC
Field	WELD COUNTY	Wellbore	NORTH PLATTE FEDERAL F-J-22HNC AWB
Facility	SEC.22-T5N-R63W		

WELLPATH DATA (96 stations)

MD [ft]	Inclination [°]	Azimuth [°]	TVD [ft]	Vert Sect [ft]	North [ft]	East [ft]	DLS [°/100ft]	Comments
8230.00	91.070	180.550	6558.70	1164.44	-1162.63	87.03	1.94	
8315.00	89.190	180.330	6558.51	1249.39	-1247.62	86.38	2.23	
8401.00	88.950	180.290	6559.90	1335.34	-1333.61	85.91	0.28	
8486.00	88.570	180.110	6561.74	1420.29	-1418.59	85.62	0.49	
8572.00	88.060	180.750	6564.27	1506.20	-1504.55	84.97	0.95	
8657.00	88.660	179.650	6566.70	1591.13	-1589.51	84.68	1.47	
8743.00	89.590	180.040	6568.02	1677.10	-1675.50	84.91	1.17	
8828.00	88.470	179.460	6569.46	1762.07	-1760.49	85.28	1.48	
8914.00	90.240	179.820	6570.43	1848.04	-1846.48	85.82	2.10	
9000.00	89.600	180.310	6570.55	1934.01	-1932.47	85.72	0.94	
9085.00	91.480	180.570	6569.74	2018.96	-2017.46	85.07	2.23	
9171.00	91.540	180.440	6567.48	2104.88	-2103.43	84.31	0.17	
9257.00	91.500	180.800	6565.20	2190.80	-2189.40	83.38	0.42	
9343.00	90.860	180.650	6563.43	2276.72	-2275.37	82.29	0.76	
9428.00	88.580	179.480	6563.84	2361.68	-2360.36	82.20	3.01	
9513.00	88.940	179.470	6565.68	2446.65	-2445.34	82.97	0.42	
9598.00	89.130	180.480	6567.11	2531.61	-2530.33	83.01	1.21	
9684.00	88.360	181.260	6569.00	2617.52	-2616.29	81.71	1.27	
9769.00	89.010	179.790	6570.95	2702.44	-2701.26	80.93	1.89	
9854.00	90.520	179.380	6571.30	2787.43	-2786.26	81.54	1.84	
9940.00	89.040	179.190	6571.63	2873.42	-2872.25	82.62	1.74	
10025.00	90.460	178.000	6572.00	2958.41	-2957.22	84.70	2.18	
10111.00	91.010	177.240	6570.89	3044.39	-3043.14	88.27	1.09	
10196.00	91.170	178.590	6569.28	3129.37	-3128.06	91.36	1.60	
10282.00	90.030	178.500	6568.38	3215.36	-3214.03	93.55	1.33	
10367.00	90.490	178.500	6567.99	3300.36	-3299.00	95.77	0.54	
10453.00	90.150	177.640	6567.51	3386.36	-3384.95	98.67	1.08	
10538.00	90.950	178.880	6566.69	3471.35	-3469.90	101.25	1.74	
10624.00	91.040	179.150	6565.20	3557.33	-3555.88	102.73	0.33	
10709.00	90.730	179.990	6563.89	3642.31	-3640.86	103.37	1.05	



Actual Wellpath Report

NORTH PLATTE FEDERAL F-J-22HNC AWP

Page 5 of 7



REFERENCE WELLPATH IDENTIFICATION

Operator	BONANZA CREEK OIL COMPANY	Slot	SLOT#08 NORTH PLATTE FEDERAL F-J-22HNC (717'FNL & 1206'FWL, SEC.22)
Area	COLORADO	Well	NORTH PLATTE FEDERAL F-J-22HNC
Field	WELD COUNTY	Wellbore	NORTH PLATTE FEDERAL F-J-22HNC AWB
Facility	SEC.22-T5N-R63W		

WELLPATH DATA (96 stations)

MD [ft]	Inclination [°]	Azimuth [°]	TVD [ft]	Vert Sect [ft]	North [ft]	East [ft]	DLS [°/100ft]	Comments
10795.00	90.860	179.910	6562.69	3728.28	-3726.86	103.44	0.18	
10880.00	89.870	179.580	6562.15	3813.26	-3811.85	103.82	1.23	
10966.00	92.310	180.040	6560.52	3899.21	-3897.83	104.10	2.89	
11051.00	91.160	180.330	6557.94	3984.14	-3982.79	103.83	1.40	
11095.00	90.370	180.080	6557.36	4028.12	-4026.78	103.67	1.88	LAST BHI MWD SURVEY
11150.00	90.370	180.080	6557.00	4083.10	-4081.78	103.60	0.00	PROJECTION TO BIT (481'FSL & 1304'FWL, SEC.22)

HOLE & CASING SECTIONS -

Ref Wellbore: NORTH PLATTE FEDERAL F-J-22HNC AWB Ref Wellpath: NORTH PLATTE FEDERAL F-J-22HNC AWP

String/Diameter	Start MD [ft]	End MD [ft]	Interval [ft]	Start TVD [ft]	End TVD [ft]	Start N/S [ft]	Start E/W [ft]	End N/S [ft]	End E/W [ft]
9.625in Casing Surface	17.00	488.00	471.00	17.00	487.99	0.00	0.00	1.16	1.99
8.75in Open Hole	488.00	7022.00	6534.00	487.99	6563.73	1.16	1.99	45.05	82.15
7in Casing Intermediate	17.00	7011.00	6994.00	17.00	6563.24	0.00	0.00	56.04	82.18
6.125in Open Hole	7022.00	11150.00	4128.00	6563.73	6557.00	45.05	82.15	-4081.78	103.60



Actual Wellpath Report

NORTH PLATTE FEDERAL F-J-22HNC AWP

Page 6 of 7



REFERENCE WELLPATH IDENTIFICATION

Operator	BONANZA CREEK OIL COMPANY	Slot	SLOT#08 NORTH PLATTE FEDERAL F-J-22HNC (717'FNL & 1206'FWL, SEC.22)
Area	COLORADO	Well	NORTH PLATTE FEDERAL F-J-22HNC
Field	WELD COUNTY	Wellbore	NORTH PLATTE FEDERAL F-J-22HNC AWB
Facility	SEC.22-T5N-R63W		

TARGETS

Name	TVD [ft]	North [ft]	East [ft]	Grid East [US ft]	Grid North [US ft]	Latitude	Longitude	Shape
SEC.22-T05N-R63W	4.00	99.46	-0.85	3298926.55	1386890.25	40°23'25.620"N	104°25'36.552"W	polygon
NORTH PLATTE FEDERAL F-J-22HNC BHL ON PLAT (470'FSL & 1303'FWL, SEC.22)	6541.00	-4093.03	102.23	3299080.36	1382699.49	40°22'44.191"N	104°25'35.220"W	point
NORTH PLATTE FEDERAL F-J-22HNC ENTRY POINT (531'FNL & 1280'FWL, SEC.22)	6541.00	185.07	74.64	3299001.00	1386976.76	40°23'26.466"N	104°25'35.576"W	point
NORTH PLATTE FEDERAL F-J-22HNC BHL ON PLAT REV-1 (470'FSL & 1303'FWL, SEC.22)	6560.00	-4093.05	102.23	3299080.36	1382699.47	40°22'44.191"N	104°25'35.220"W	point
SEC.22-T05N-R63W HARDLINES (460'FNL/FSL)	6630.00	99.46	-0.85	3298926.55	1386890.25	40°23'25.620"N	104°25'36.552"W	polygon

WELLPATH COMPOSITION -

Ref Wellbore: NORTH PLATTE FEDERAL F-J-22HNC AWB			Ref Wellpath: NORTH PLATTE FEDERAL F-J-22HNC AWP		
Start MD [ft]	End MD [ft]	Positional Uncertainty Model	Log Name/Comment	Wellbore	
17.00	6936.00	NaviTrak (MagCorr)	BHI MWD/NAVITRAK (MAGCORR) 8.75" HOLE <621-6936>	NORTH PLATTE FEDERAL F-J-22HNC AWB	
6936.00	11095.00	NaviTrak (MagCorr)	BHI MWD/NAVITRAK (MAGCORR) 6.125" HOLE <6974-11095>	NORTH PLATTE FEDERAL F-J-22HNC AWB	
11095.00	11150.00	Blind Drilling (std)	Projection to bit	NORTH PLATTE FEDERAL F-J-22HNC AWB	



Actual Wellpath Report

NORTH PLATTE FEDERAL F-J-22HNC AWP

Page 7 of 7



REFERENCE WELLPATH IDENTIFICATION

Operator	BONANZA CREEK OIL COMPANY	Slot	SLOT#08 NORTH PLATTE FEDERAL F-J-22HNC (717'FNL & 1206'FWL, SEC.22)
Area	COLORADO	Well	NORTH PLATTE FEDERAL F-J-22HNC
Field	WELD COUNTY	Wellbore	NORTH PLATTE FEDERAL F-J-22HNC AWB
Facility	SEC.22-T5N-R63W		

WELLPATH COMMENTS

MD [ft]	Inclination [°]	Azimuth [°]	TVD [ft]	Comment
621.00	0.720	59.760	620.98	FIRST BHI MWD SURVEY
7012.00	87.408	180.169	6563.29	ICP (661'FNL & 1288'FWL, SEC.22)
7072.00	87.847	180.152	6565.77	TOP (721'FNL & 1288'FWL, SEC.22)
11095.00	90.370	180.080	6557.36	LAST BHI MWD SURVEY
11150.00	90.370	180.080	6557.00	PROJECTION TO BIT (481'FSL & 1304'FWL, SEC.22)