

EXTRACTION OIL & GAS

Location: COLORADO Slot: SLOT#11 VARRA #11(1485'FSL & 785'FWL,SEC.05)
Field: WELD COUNTY (NAD83/TRUE NORTH) Well: VARRA #11
Facility: SEC.05-T06N-R67W Wellbore: VARRA #11 PWB

Plot reference wellpath is VARRA #11 (REV-B.0) PWP

True vertical depths are referenced to SAVANNA 802 (RKB)	Grid System: NAD83 / Lambert Colorado SP, Northern Zone (501), US feet
Measured depths are referenced to SAVANNA 802 (RKB)	North Reference: True north
SAVANNA 802 (RKB) to Mean Sea Level: 4889 feet	Scale: True distance
Mean Sea Level to Mud line (At Slot: SLOT#11 VARRA #11(1485'FSL & 785'FWL,SEC.05)): 0 feet	Depths are in feet
Coordinates are in feet referenced to Slot	Created by: ingmjamm on 7/31/2015

Location Information

Facility Name			Grid East (US ft)	Grid North (US ft)	Latitude	Longitude
SEC.05-T06N-R67W			3160186.786	1430380.222	40°30'48.118"N	104°55'25.957"W
Slot	Local N (ft)	Local E (ft)	Grid East (US ft)	Grid North (US ft)	Latitude	Longitude
SLOT#11 VARRA #11(1485FSL & 785FWL,SEC.05)	-260.18	-1.70	3160186.778	1430120.041	40°30'45.547"N	104°55'25.979"W
SAVANNA 802 (RKB) to Mud line (At Slot: SLOT#11 VARRA #11(1485FSL & 785FWL,SEC.05))					4889ft	
Mean Sea Level to Mud line (At Slot: SLOT#11 VARRA #11(1485FSL & 785FWL,SEC.05))					0ft	
SAVANNA 802 (RKB) to Mean Sea Level					4889ft	

Targets

Name	MD (ft)	TVD (ft)	Local N (ft)	Local E (ft)	Grid East (US ft)	Grid North (US ft)	Latitude	Longitude
VARRA PAD SECTION 04		-9.00	260.14	1.68	3160186.77	1430380.18	40°30'48.118"N	104°55'25.957"W
VARRA PAD SECTION 05		-9.00	260.14	1.68	3160186.77	1430380.18	40°30'48.118"N	104°55'25.957"W
VARRA #11 BHL ON PLAT REV-1(490'FSL & 460'FEL,SEC.04)	17330.28	7267.00	-837.62	9289.67	3169481.37	1429342.82	40°30'37.253"N	104°53'25.710"W
VARRA #11 LANDING POINT	7730.84	7267.00	-816.05	-309.75	3159882.35	1429302.02	40°30'37.483"N	104°55'29.989"W
VARRA PAD SOUTH 1/4 HARDLINE(460'SETBACKS)		7411.00	260.14	1.68	3160186.77	1430380.18	40°30'48.118"N	104°55'25.957"W

Survey Program

Start MD (ft)	End MD (ft)	Tool	Model	Log Name/Comment	Wellbore
15.00	17330.28	NaviTrak	NaviTrak (Standard)		VARRA #11 PWB

Well Profile Data

Design Comment	MD (ft)	Inc (°)	Az (°)	TVD (ft)	Local N (ft)	Local E (ft)	DLS (°/100ft)	VS (ft)
Tie On	15.00	0.000	230.715	15.00	0.00	0.00	0.00	0.00
End of Tangent	1500.00	0.000	230.715	1500.00	0.00	0.00	0.00	0.00
End of Build	2166.10	13.322	230.715	2160.11	-48.81	-59.67	2.00	-55.04
End of Tangent	6728.30	13.322	230.715	6599.55	-714.44	-873.33	0.00	-805.64
End of 3D Arc	7730.84	90.000	90.129	7267.00	-816.05	-309.75	10.00	-235.22
End of Tangent	17330.28	90.000	90.129	7267.00	-837.62	9289.67	0.00	9327.35

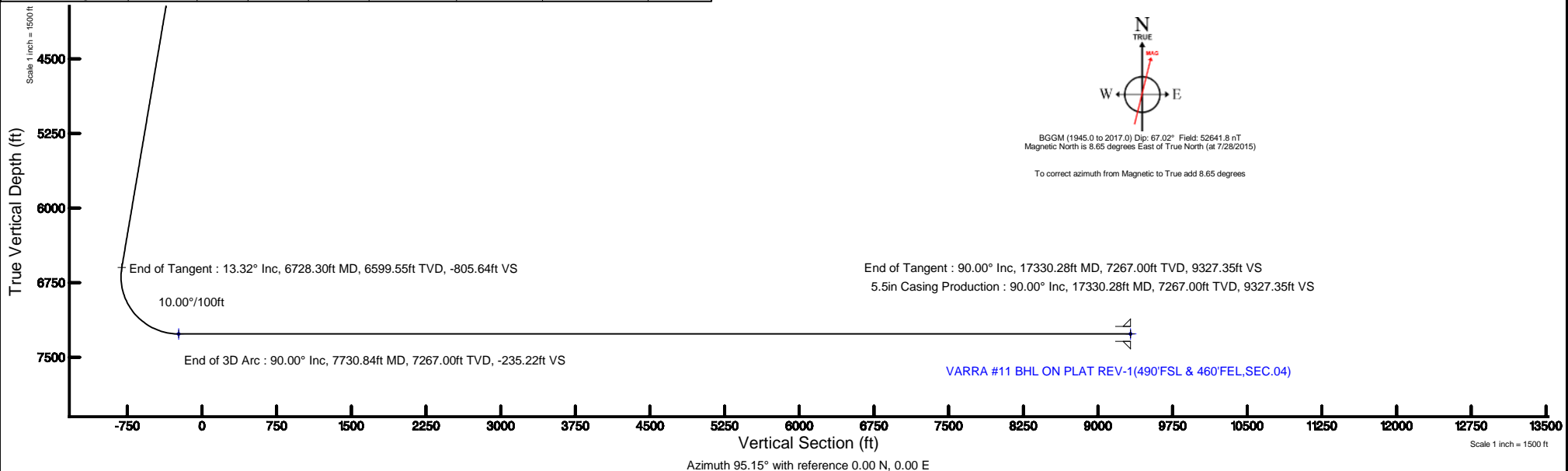



Planned Wellpath Report

VARRA #11 (REV-B.0) PWP

Page 1 of 8



REFERENCE WELLPATH IDENTIFICATION

Operator	EXTRACTION OIL & GAS	Slot	SLOT#11 VARRA #11(1485'FSL & 785'FWL,SEC.05)
Area	COLORADO	Well	VARRA #11
Field	WELD COUNTY (NAD83/TRUE NORTH)	Wellbore	VARRA #11 PWB
Facility	SEC.05-T06N-R67W		

REPORT SETUP INFORMATION

Projection System	NAD83 / Lambert Colorado SP, Northern Zone (501), US feet	Software System	WellArchitect® 4.1.1
North Reference	True	User	Ingmjmr
Scale	0.999967	Report Generated	7/31/2015 at 4:23:15 PM
Convergence at slot	0.37° East	Database/Source file	Denver/VARRA_#11_PWB.xml

WELLPATH LOCATION

	Local coordinates		Grid coordinates		Geographic coordinates	
	North[ft]	East[ft]	Easting[US ft]	Northing[US ft]	Latitude	Longitude
Slot Location	-260.18	-1.70	3160186.78	1430120.04	40°30'45.547"N	104°55'25.979"W
Facility Reference Pt			3160186.79	1430380.22	40°30'48.118"N	104°55'25.957"W
Field Reference Pt			3185481.27	1419166.81	40°28'55.560"N	104°49'59.556"W

WELLPATH DATUM

Calculation method	Minimum curvature	SAVANNA 802 (RKB) to Facility Vertical Datum	4889.00ft
Horizontal Reference Pt	Slot	SAVANNA 802 (RKB) to Mean Sea Level	4889.00ft
Vertical Reference Pt	SAVANNA 802 (RKB)	SAVANNA 802 (RKB) to Mud Line at Slot (SLOT#11 VARRA #11(1485'FSL & 785'FWL,SEC.05))	4889.00ft
MD Reference Pt	SAVANNA 802 (RKB)	Section Origin	N 0.00, E 0.00 ft
Field Vertical Reference	Mean Sea Level	Section Azimuth	95.15°



Planned Wellpath Report

VARRA #11 (REV-B.0) PWP

Page 2 of 8



REFERENCE WELLPATH IDENTIFICATION

Operator	EXTRACTION OIL & GAS	Slot	SLOT#11 VARRA #11(1485'FSL & 785'FWL,SEC.05)
Area	COLORADO	Well	VARRA #11
Field	WELD COUNTY (NAD83/TRUE NORTH)	Wellbore	VARRA #11 PWB
Facility	SEC.05-T06N-R67W		

WELLPATH DATA (180 stations) † = interpolated/extrapolated station

MD [ft]	Inclination [°]	Azimuth [°]	TVD [ft]	Vert Sect [ft]	North [ft]	East [ft]	DLS [°/100ft]	Comments
0.00†	0.000	230.715	0.00	0.00	0.00	0.00	0.00	
15.00	0.000	230.715	15.00	0.00	0.00	0.00	0.00	Tie On
115.00†	0.000	230.715	115.00	0.00	0.00	0.00	0.00	
215.00†	0.000	230.715	215.00	0.00	0.00	0.00	0.00	
315.00†	0.000	230.715	315.00	0.00	0.00	0.00	0.00	
415.00†	0.000	230.715	415.00	0.00	0.00	0.00	0.00	
515.00†	0.000	230.715	515.00	0.00	0.00	0.00	0.00	
615.00†	0.000	230.715	615.00	0.00	0.00	0.00	0.00	
715.00†	0.000	230.715	715.00	0.00	0.00	0.00	0.00	
815.00†	0.000	230.715	815.00	0.00	0.00	0.00	0.00	
915.00†	0.000	230.715	915.00	0.00	0.00	0.00	0.00	
1015.00†	0.000	230.715	1015.00	0.00	0.00	0.00	0.00	
1115.00†	0.000	230.715	1115.00	0.00	0.00	0.00	0.00	
1215.00†	0.000	230.715	1215.00	0.00	0.00	0.00	0.00	
1315.00†	0.000	230.715	1315.00	0.00	0.00	0.00	0.00	
1415.00†	0.000	230.715	1415.00	0.00	0.00	0.00	0.00	
1500.00	0.000	230.715	1500.00	0.00	0.00	0.00	0.00	End of Tangent
1515.00†	0.300	230.715	1515.00	-0.03	-0.02	-0.03	2.00	
1615.00†	2.300	230.715	1614.97	-1.65	-1.46	-1.79	2.00	
1715.00†	4.300	230.715	1714.80	-5.76	-5.11	-6.24	2.00	
1815.00†	6.300	230.715	1814.37	-12.35	-10.95	-13.39	2.00	
1915.00†	8.300	230.715	1913.55	-21.43	-19.00	-23.23	2.00	
2015.00†	10.300	230.715	2012.23	-32.96	-29.23	-35.73	2.00	
2115.00†	12.300	230.715	2110.29	-46.95	-41.64	-50.90	2.00	
2166.10	13.322	230.715	2160.11	-55.04	-48.81	-59.67	2.00	End of Build
2215.00†	13.322	230.715	2207.70	-63.09	-55.95	-68.39	0.00	
2315.00†	13.322	230.715	2305.01	-79.54	-70.54	-86.22	0.00	
2415.00†	13.322	230.715	2402.32	-95.99	-85.13	-104.06	0.00	
2515.00†	13.322	230.715	2499.63	-112.45	-99.72	-121.89	0.00	
2615.00†	13.322	230.715	2596.93	-128.90	-114.31	-139.73	0.00	



Planned Wellpath Report

VARRA #11 (REV-B.0) PWP

Page 3 of 8



REFERENCE WELLPATH IDENTIFICATION

Operator	EXTRACTION OIL & GAS	Slot	SLOT#11 VARRA #11(1485'FSL & 785'FWL,SEC.05)
Area	COLORADO	Well	VARRA #11
Field	WELD COUNTY (NAD83/TRUE NORTH)	Wellbore	VARRA #11 PWB
Facility	SEC.05-T06N-R67W		

WELLPATH DATA (180 stations) † = interpolated/extrapolated station

MD [ft]	Inclination [°]	Azimuth [°]	TVD [ft]	Vert Sect [ft]	North [ft]	East [ft]	DLS [°/100ft]	Comments
2715.00†	13.322	230.715	2694.24	-145.35	-128.90	-157.56	0.00	
2815.00†	13.322	230.715	2791.55	-161.80	-143.49	-175.40	0.00	
2915.00†	13.322	230.715	2888.86	-178.26	-158.08	-193.23	0.00	
3015.00†	13.322	230.715	2986.17	-194.71	-172.67	-211.07	0.00	
3115.00†	13.322	230.715	3083.48	-211.16	-187.26	-228.90	0.00	
3215.00†	13.322	230.715	3180.79	-227.61	-201.85	-246.74	0.00	
3315.00†	13.322	230.715	3278.10	-244.07	-216.44	-264.57	0.00	
3415.00†	13.322	230.715	3375.41	-260.52	-231.03	-282.41	0.00	
3515.00†	13.322	230.715	3472.72	-276.97	-245.62	-300.24	0.00	
3615.00†	13.322	230.715	3570.03	-293.42	-260.21	-318.08	0.00	
3715.00†	13.322	230.715	3667.33	-309.88	-274.80	-335.91	0.00	
3815.00†	13.322	230.715	3764.64	-326.33	-289.39	-353.75	0.00	
3915.00†	13.322	230.715	3861.95	-342.78	-303.98	-371.58	0.00	
4015.00†	13.322	230.715	3959.26	-359.24	-318.57	-389.42	0.00	
4115.00†	13.322	230.715	4056.57	-375.69	-333.16	-407.25	0.00	
4215.00†	13.322	230.715	4153.88	-392.14	-347.75	-425.09	0.00	
4315.00†	13.322	230.715	4251.19	-408.59	-362.34	-442.92	0.00	
4415.00†	13.322	230.715	4348.50	-425.05	-376.93	-460.76	0.00	
4515.00†	13.322	230.715	4445.81	-441.50	-391.52	-478.59	0.00	
4615.00†	13.322	230.715	4543.12	-457.95	-406.11	-496.43	0.00	
4715.00†	13.322	230.715	4640.42	-474.40	-420.70	-514.26	0.00	
4815.00†	13.322	230.715	4737.73	-490.86	-435.29	-532.10	0.00	
4915.00†	13.322	230.715	4835.04	-507.31	-449.88	-549.93	0.00	
5015.00†	13.322	230.715	4932.35	-523.76	-464.47	-567.77	0.00	
5115.00†	13.322	230.715	5029.66	-540.21	-479.06	-585.60	0.00	
5215.00†	13.322	230.715	5126.97	-556.67	-493.65	-603.43	0.00	
5315.00†	13.322	230.715	5224.28	-573.12	-508.24	-621.27	0.00	
5415.00†	13.322	230.715	5321.59	-589.57	-522.83	-639.10	0.00	
5515.00†	13.322	230.715	5418.90	-606.02	-537.42	-656.94	0.00	
5615.00†	13.322	230.715	5516.21	-622.48	-552.01	-674.77	0.00	



Planned Wellpath Report

VARRA #11 (REV-B.0) PWP

Page 4 of 8



REFERENCE WELLPATH IDENTIFICATION

Operator	EXTRACTION OIL & GAS	Slot	SLOT#11 VARRA #11(1485'FSL & 785'FWL,SEC.05)
Area	COLORADO	Well	VARRA #11
Field	WELD COUNTY (NAD83/TRUE NORTH)	Wellbore	VARRA #11 PWB
Facility	SEC.05-T06N-R67W		

WELLPATH DATA (180 stations) † = interpolated/extrapolated station

MD [ft]	Inclination [°]	Azimuth [°]	TVD [ft]	Vert Sect [ft]	North [ft]	East [ft]	DLS [°/100ft]	Comments
5715.00†	13.322	230.715	5613.51	-638.93	-566.60	-692.61	0.00	
5815.00†	13.322	230.715	5710.82	-655.38	-581.19	-710.44	0.00	
5915.00†	13.322	230.715	5808.13	-671.83	-595.78	-728.28	0.00	
6015.00†	13.322	230.715	5905.44	-688.29	-610.37	-746.11	0.00	
6115.00†	13.322	230.715	6002.75	-704.74	-624.96	-763.95	0.00	
6215.00†	13.322	230.715	6100.06	-721.19	-639.55	-781.78	0.00	
6315.00†	13.322	230.715	6197.37	-737.64	-654.14	-799.62	0.00	
6415.00†	13.322	230.715	6294.68	-754.10	-668.73	-817.45	0.00	
6515.00†	13.322	230.715	6391.99	-770.55	-683.32	-835.29	0.00	
6615.00†	13.322	230.715	6489.30	-787.00	-697.91	-853.12	0.00	
6715.00†	13.322	230.715	6586.61	-803.45	-712.50	-870.96	0.00	
6728.30	13.322	230.715	6599.55	-805.64	-714.44	-873.33	0.00	End of Tangent
6815.00†	8.695	190.667	6684.75	-813.42	-727.23	-882.29	10.00	
6915.00†	11.975	135.269	6783.33	-806.19	-742.06	-876.37	10.00	
7015.00†	20.241	114.191	6879.40	-781.85	-756.56	-853.23	10.00	
7115.00†	29.571	105.494	6970.03	-741.12	-770.27	-813.58	10.00	
7215.00†	39.212	100.747	7052.47	-685.24	-782.79	-758.60	10.00	
7315.00†	48.978	97.644	7124.21	-615.92	-793.73	-689.99	10.00	
7415.00†	58.806	95.352	7183.07	-535.26	-802.76	-609.81	10.00	
7515.00†	68.667	93.495	7227.27	-445.70	-809.61	-520.51	10.00	
7615.00†	78.546	91.874	7255.46	-349.98	-814.06	-424.80	10.00	
7715.00†	88.433	90.364	7266.78	-251.00	-815.98	-325.59	10.00	
7730.84	90.000	90.129	7267.00 ¹	-235.22	-816.05	-309.75	10.00	End of 3D Arc
7815.00†	90.000	90.129	7267.00	-151.38	-816.24	-225.59	0.00	
7915.00†	90.000	90.129	7267.00	-51.77	-816.47	-125.59	0.00	
8015.00†	90.000	90.129	7267.00	47.85	-816.69	-25.59	0.00	
8115.00†	90.000	90.129	7267.00	147.47	-816.92	74.41	0.00	
8215.00†	90.000	90.129	7267.00	247.08	-817.14	174.41	0.00	
8315.00†	90.000	90.129	7267.00	346.70	-817.37	274.41	0.00	
8415.00†	90.000	90.129	7267.00	446.31	-817.59	374.41	0.00	



Planned Wellpath Report

VARRA #11 (REV-B.0) PWP

Page 5 of 8



REFERENCE WELLPATH IDENTIFICATION

Operator	EXTRACTION OIL & GAS	Slot	SLOT#11 VARRA #11(1485'FSL & 785'FWL,SEC.05)
Area	COLORADO	Well	VARRA #11
Field	WELD COUNTY (NAD83/TRUE NORTH)	Wellbore	VARRA #11 PWB
Facility	SEC.05-T06N-R67W		

WELLPATH DATA (180 stations) † = interpolated/extrapolated station

MD [ft]	Inclination [°]	Azimuth [°]	TVD [ft]	Vert Sect [ft]	North [ft]	East [ft]	DLS [°/100ft]	Comments
8515.00†	90.000	90.129	7267.00	545.93	-817.81	474.40	0.00	
8615.00†	90.000	90.129	7267.00	645.55	-818.04	574.40	0.00	
8715.00†	90.000	90.129	7267.00	745.16	-818.26	674.40	0.00	
8815.00†	90.000	90.129	7267.00	844.78	-818.49	774.40	0.00	
8915.00†	90.000	90.129	7267.00	944.39	-818.71	874.40	0.00	
9015.00†	90.000	90.129	7267.00	1044.01	-818.94	974.40	0.00	
9115.00†	90.000	90.129	7267.00	1143.63	-819.16	1074.40	0.00	
9215.00†	90.000	90.129	7267.00	1243.24	-819.39	1174.40	0.00	
9315.00†	90.000	90.129	7267.00	1342.86	-819.61	1274.40	0.00	
9415.00†	90.000	90.129	7267.00	1442.47	-819.84	1374.40	0.00	
9515.00†	90.000	90.129	7267.00	1542.09	-820.06	1474.40	0.00	
9615.00†	90.000	90.129	7267.00	1641.70	-820.29	1574.40	0.00	
9715.00†	90.000	90.129	7267.00	1741.32	-820.51	1674.40	0.00	
9815.00†	90.000	90.129	7267.00	1840.94	-820.74	1774.40	0.00	
9915.00†	90.000	90.129	7267.00	1940.55	-820.96	1874.40	0.00	
10015.00†	90.000	90.129	7267.00	2040.17	-821.18	1974.40	0.00	
10115.00†	90.000	90.129	7267.00	2139.78	-821.41	2074.40	0.00	
10215.00†	90.000	90.129	7267.00	2239.40	-821.63	2174.40	0.00	
10315.00†	90.000	90.129	7267.00	2339.02	-821.86	2274.40	0.00	
10415.00†	90.000	90.129	7267.00	2438.63	-822.08	2374.40	0.00	
10515.00†	90.000	90.129	7267.00	2538.25	-822.31	2474.40	0.00	
10615.00†	90.000	90.129	7267.00	2637.86	-822.53	2574.40	0.00	
10715.00†	90.000	90.129	7267.00	2737.48	-822.76	2674.40	0.00	
10815.00†	90.000	90.129	7267.00	2837.10	-822.98	2774.40	0.00	
10915.00†	90.000	90.129	7267.00	2936.71	-823.21	2874.40	0.00	
11015.00†	90.000	90.129	7267.00	3036.33	-823.43	2974.40	0.00	
11115.00†	90.000	90.129	7267.00	3135.94	-823.66	3074.40	0.00	
11215.00†	90.000	90.129	7267.00	3235.56	-823.88	3174.40	0.00	
11315.00†	90.000	90.129	7267.00	3335.17	-824.11	3274.40	0.00	
11415.00†	90.000	90.129	7267.00	3434.79	-824.33	3374.40	0.00	



Planned Wellpath Report

VARRA #11 (REV-B.0) PWP

Page 6 of 8



REFERENCE WELLPATH IDENTIFICATION

Operator	EXTRACTION OIL & GAS	Slot	SLOT#11 VARRA #11(1485'FSL & 785'FWL,SEC.05)
Area	COLORADO	Well	VARRA #11
Field	WELD COUNTY (NAD83/TRUE NORTH)	Wellbore	VARRA #11 PWB
Facility	SEC.05-T06N-R67W		

WELLPATH DATA (180 stations) † = interpolated/extrapolated station

MD [ft]	Inclination [°]	Azimuth [°]	TVD [ft]	Vert Sect [ft]	North [ft]	East [ft]	DLS [°/100ft]	Comments
11515.00†	90.000	90.129	7267.00	3534.41	-824.56	3474.40	0.00	
11615.00†	90.000	90.129	7267.00	3634.02	-824.78	3574.40	0.00	
11715.00†	90.000	90.129	7267.00	3733.64	-825.00	3674.40	0.00	
11815.00†	90.000	90.129	7267.00	3833.25	-825.23	3774.40	0.00	
11915.00†	90.000	90.129	7267.00	3932.87	-825.45	3874.40	0.00	
12015.00†	90.000	90.129	7267.00	4032.49	-825.68	3974.40	0.00	
12115.00†	90.000	90.129	7267.00	4132.10	-825.90	4074.40	0.00	
12215.00†	90.000	90.129	7267.00	4231.72	-826.13	4174.40	0.00	
12315.00†	90.000	90.129	7267.00	4331.33	-826.35	4274.40	0.00	
12415.00†	90.000	90.129	7267.00	4430.95	-826.58	4374.40	0.00	
12515.00†	90.000	90.129	7267.00	4530.57	-826.80	4474.39	0.00	
12615.00†	90.000	90.129	7267.00	4630.18	-827.03	4574.39	0.00	
12715.00†	90.000	90.129	7267.00	4729.80	-827.25	4674.39	0.00	
12815.00†	90.000	90.129	7267.00	4829.41	-827.48	4774.39	0.00	
12915.00†	90.000	90.129	7267.00	4929.03	-827.70	4874.39	0.00	
13015.00†	90.000	90.129	7267.00	5028.64	-827.93	4974.39	0.00	
13115.00†	90.000	90.129	7267.00	5128.26	-828.15	5074.39	0.00	
13215.00†	90.000	90.129	7267.00	5227.88	-828.37	5174.39	0.00	
13315.00†	90.000	90.129	7267.00	5327.49	-828.60	5274.39	0.00	
13415.00†	90.000	90.129	7267.00	5427.11	-828.82	5374.39	0.00	
13515.00†	90.000	90.129	7267.00	5526.72	-829.05	5474.39	0.00	
13615.00†	90.000	90.129	7267.00	5626.34	-829.27	5574.39	0.00	
13715.00†	90.000	90.129	7267.00	5725.96	-829.50	5674.39	0.00	
13815.00†	90.000	90.129	7267.00	5825.57	-829.72	5774.39	0.00	
13915.00†	90.000	90.129	7267.00	5925.19	-829.95	5874.39	0.00	
14015.00†	90.000	90.129	7267.00	6024.80	-830.17	5974.39	0.00	
14115.00†	90.000	90.129	7267.00	6124.42	-830.40	6074.39	0.00	
14215.00†	90.000	90.129	7267.00	6224.04	-830.62	6174.39	0.00	
14315.00†	90.000	90.129	7267.00	6323.65	-830.85	6274.39	0.00	
14415.00†	90.000	90.129	7267.00	6423.27	-831.07	6374.39	0.00	



Planned Wellpath Report

VARRA #11 (REV-B.0) PWP

Page 7 of 8



REFERENCE WELLPATH IDENTIFICATION

Operator	EXTRACTION OIL & GAS	Slot	SLOT#11 VARRA #11(1485'FSL & 785'FWL,SEC.05)
Area	COLORADO	Well	VARRA #11
Field	WELD COUNTY (NAD83/TRUE NORTH)	Wellbore	VARRA #11 PWB
Facility	SEC.05-T06N-R67W		

WELLPATH DATA (180 stations) † = interpolated/extrapolated station

MD [ft]	Inclination [°]	Azimuth [°]	TVD [ft]	Vert Sect [ft]	North [ft]	East [ft]	DLS [°/100ft]	Comments
14515.00†	90.000	90.129	7267.00	6522.88	-831.30	6474.39	0.00	
14615.00†	90.000	90.129	7267.00	6622.50	-831.52	6574.39	0.00	
14715.00†	90.000	90.129	7267.00	6722.11	-831.74	6674.39	0.00	
14815.00†	90.000	90.129	7267.00	6821.73	-831.97	6774.39	0.00	
14915.00†	90.000	90.129	7267.00	6921.35	-832.19	6874.39	0.00	
15015.00†	90.000	90.129	7267.00	7020.96	-832.42	6974.39	0.00	
15115.00†	90.000	90.129	7267.00	7120.58	-832.64	7074.39	0.00	
15215.00†	90.000	90.129	7267.00	7220.19	-832.87	7174.39	0.00	
15315.00†	90.000	90.129	7267.00	7319.81	-833.09	7274.39	0.00	
15415.00†	90.000	90.129	7267.00	7419.43	-833.32	7374.39	0.00	
15515.00†	90.000	90.129	7267.00	7519.04	-833.54	7474.39	0.00	
15615.00†	90.000	90.129	7267.00	7618.66	-833.77	7574.39	0.00	
15715.00†	90.000	90.129	7267.00	7718.27	-833.99	7674.39	0.00	
15815.00†	90.000	90.129	7267.00	7817.89	-834.22	7774.39	0.00	
15915.00†	90.000	90.129	7267.00	7917.51	-834.44	7874.39	0.00	
16015.00†	90.000	90.129	7267.00	8017.12	-834.67	7974.39	0.00	
16115.00†	90.000	90.129	7267.00	8116.74	-834.89	8074.39	0.00	
16215.00†	90.000	90.129	7267.00	8216.35	-835.12	8174.39	0.00	
16315.00†	90.000	90.129	7267.00	8315.97	-835.34	8274.39	0.00	
16415.00†	90.000	90.129	7267.00	8415.58	-835.56	8374.38	0.00	
16515.00†	90.000	90.129	7267.00	8515.20	-835.79	8474.38	0.00	
16615.00†	90.000	90.129	7267.00	8614.82	-836.01	8574.38	0.00	
16715.00†	90.000	90.129	7267.00	8714.43	-836.24	8674.38	0.00	
16815.00†	90.000	90.129	7267.00	8814.05	-836.46	8774.38	0.00	
16915.00†	90.000	90.129	7267.00	8913.66	-836.69	8874.38	0.00	
17015.00†	90.000	90.129	7267.00	9013.28	-836.91	8974.38	0.00	
17115.00†	90.000	90.129	7267.00	9112.90	-837.14	9074.38	0.00	
17215.00†	90.000	90.129	7267.00	9212.51	-837.36	9174.38	0.00	
17315.00†	90.000	90.129	7267.00	9312.13	-837.59	9274.38	0.00	
17330.28	90.000	90.129	7267.00 ²	9327.35	-837.62	9289.67	0.00	End of Tangent

HOLE & CASING SECTIONS - Ref Wellbore: VARRA #11 PWB Ref Wellpath: VARRA #11 (REV-B.0) PWP

String/Diameter	Start MD [ft]	End MD [ft]	Interval [ft]	Start TVD [ft]	End TVD [ft]	Start N/S [ft]	Start E/W [ft]	End N/S [ft]	End E/W [ft]
7.875in Open Hole	1500.00	17330.28	15830.28	1500.00	7267.00	0.00	0.00	-837.62	9289.66
5.5in Casing Production	15.00	17330.28	17315.28	15.00	7267.00	0.00	0.00	-837.62	9289.66

TARGETS

Name	MD [ft]	TVD [ft]	North [ft]	East [ft]	Grid East [US ft]	Grid North [US ft]	Latitude	Longitude	Shape
VARRA PAD SECTION 04		-9.00	260.14	1.68	3160186.77	1430380.18	40°30'48.118"N	104°55'25.957"W	polygon
VARRA PAD SECTION 05		-9.00	260.14	1.68	3160186.77	1430380.18	40°30'48.118"N	104°55'25.957"W	polygon
2) VARRA #11 BHL ON PLAT	17330.28	7267.00	-837.62	9289.67	3169481.37	1429342.82	40°30'37.253"N	104°53'25.710"W	point

REV-1(490'FSL & 460'FEL,SEC.04)										
1) VARRA #11 LANDING POINT	7730.84	7267.00	-816.05	-309.75	3159882.35	1429302.02	40°30'37.483"N	104°55'29.989"W	point	
VARRA PAD SOUTH 1/4 HARDLINES(460'SETBACKS)		7411.00	260.14	1.68	3160186.77	1430380.18	40°30'48.118"N	104°55'25.957"W	polygon	

SURVEY PROGRAM - Ref Wellbore: VARRA #11 PWB					Ref Wellpath: VARRA #11 (REV-B.0) PWP				
Start MD [ft]	End MD [ft]	Positional Uncertainty Model			Log Name/Comment			Wellbore	
15.00	17330.28	NaviTrak (Standard)						VARRA #11 PWB	



Planned Wellpath Report

VARRA #11 (REV-B.0) PWP

Page 8 of 8



REFERENCE WELLPATH IDENTIFICATION

Operator	EXTRACTION OIL & GAS	Slot	SLOT#11 VARRA #11(1485'FSL & 785'FWL,SEC.05)
Area	COLORADO	Well	VARRA #11
Field	WELD COUNTY (NAD83/TRUE NORTH)	Wellbore	VARRA #11 PWB
Facility	SEC.05-T06N-R67W		

DESIGN COMMENTS

MD [ft]	Inclination [°]	Azimuth [°]	TVD [ft]	Comment
15.00	0.000	230.715	15.00	Tie On
1500.00	0.000	230.715	1500.00	End of Tangent
2166.10	13.322	230.715	2160.11	End of Build
6728.30	13.322	230.715	6599.55	End of Tangent
7730.84	90.000	90.129	7267.00	End of 3D Arc
17330.28	90.000	90.129	7267.00	End of Tangent