

# Garden Creek 502-1807H

## Surface Location

NAD 1927 (NADCON CONUS) Colorado North 501

Ground Elevation: 5235.0 WELL @ 5260.0usft (Original Well Elev)

Northing	Easting	Latitude	Longitude
579114.94	2314786.56	40° 55' 3.061 N	104° 21' 39.792 W

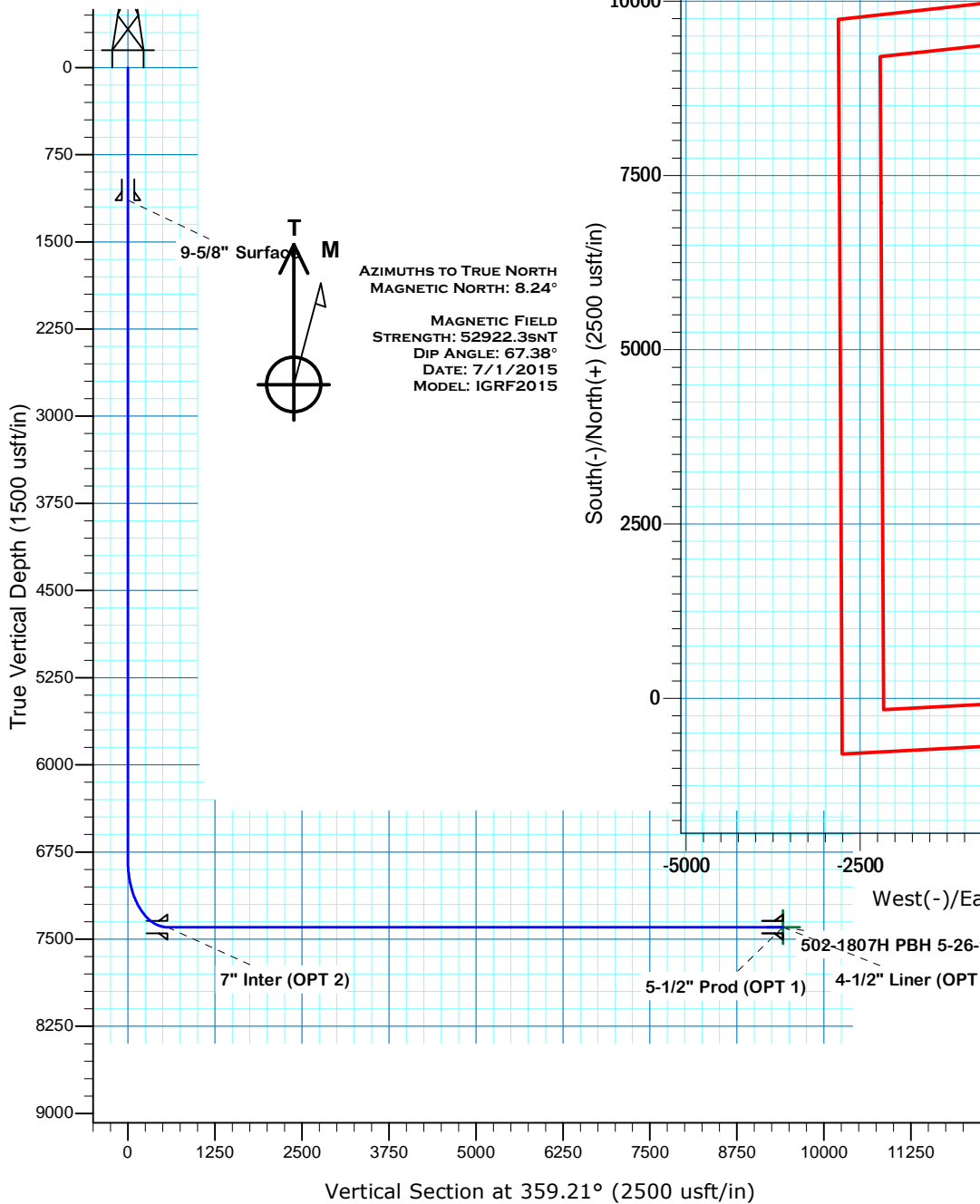

Project: DJ - Hereford Ranch  
 Site: Garden Creek GC18 SWSE Pad  
 Well: Garden Creek 502-1807H  
 Planner: M.Thompson  
 9:33, July 01 2015

## SECTION DETAILS

Sec	MD	Inc	Azi	TVD	+N/-S	+E/-W	Dleg	TFace	Vsect	Target
1	0.0	0.00	0.00	0.0	0.0	0.0	0.00	0.00	0.0	
2	6824.0	0.00	0.00	6824.0	0.0	0.0	0.00	0.00	0.0	
3	7724.0	90.00	351.00	7397.0	565.9	-89.6	10.00	351.00	567.1	
4	7829.0	90.00	351.00	7397.0	669.6	-106.1	0.00	0.00	671.0	
5	8129.1	90.00	0.00	7397.0	968.5	-129.6	3.00	90.00	970.2	502-1807H PBH 5-26-15
6	16573.2	90.00	0.00	7397.0	9412.5	-129.1	0.00	0.00	9413.4	502-1807H PBH 5-26-15

## TARGET DETAILS

Name	TVD	+N/-S	+E/-W	Northing	Easting	Latitude	Longitude	Shape
502-1807H PBH 5-26-15	7397.0	9412.5	-129.1	588525.05	2314536.61	40° 56' 36.063 N	104° 21' 41.474 W	Point

# **Denver Division- Colorado**

**DJ - Hereford Ranch**

**Garden Creek GC18 SWSE Pad**

**Garden Creek 502-1807H**

**Wellbore #1**

**Plan: APD Plan (Plat 5-26-15)**

## **Standard Planning Report**

**01 July, 2015**

# EOG Resources, Inc.

## Planning Report

<b>Database:</b>	EDM_DENVER	<b>Local Co-ordinate Reference:</b>	Well Garden Creek 502-1807H
<b>Company:</b>	Denver Division- Colorado	<b>TVD Reference:</b>	WELL @ 5260.0usft (Original Well Elev)
<b>Project:</b>	DJ - Hereford Ranch	<b>MD Reference:</b>	WELL @ 5260.0usft (Original Well Elev)
<b>Site:</b>	Garden Creek GC18 SWSE Pad	<b>North Reference:</b>	True
<b>Well:</b>	Garden Creek 502-1807H	<b>Survey Calculation Method:</b>	Minimum Curvature
<b>Wellbore:</b>	Wellbore #1		
<b>Design:</b>	APD Plan (Plat 5-26-15)		

<b>Project</b>	DJ - Hereford Ranch, Weld County		
<b>Map System:</b>	US State Plane 1927 (Exact solution)	<b>System Datum:</b>	Mean Sea Level
<b>Geo Datum:</b>	NAD 1927 (NADCON CONUS)		
<b>Map Zone:</b>	Colorado North 501		

<b>Site</b>	Garden Creek GC18 SWSE Pad		
<b>Site Position:</b>		<b>Northing:</b>	579,118.31 usft
<b>From:</b>	Map	<b>Easting:</b>	2,314,836.50 usft
<b>Position Uncertainty:</b>	0.0 usft	<b>Slot Radius:</b>	13-3/16 "
		<b>Latitude:</b>	40° 55' 3.088 N
		<b>Longitude:</b>	104° 21' 39.141 W
		<b>Grid Convergence:</b>	0.74 °

<b>Well</b>	Garden Creek 502-1807H		
<b>Well Position</b>	<b>+N/-S</b>	-2.7 usft	<b>Northing:</b>
	<b>+E/-W</b>	-50.0 usft	<b>Easting:</b>
<b>Position Uncertainty</b>	0.0 usft	<b>Wellhead Elevation:</b>	0.0 usft
		<b>Latitude:</b>	40° 55' 3.061 N
		<b>Longitude:</b>	104° 21' 39.792 W
		<b>Ground Level:</b>	5,235.0 usft

<b>Wellbore</b>	Wellbore #1				
<b>Magnetics</b>	<b>Model Name</b>	<b>Sample Date</b>	<b>Declination (°)</b>	<b>Dip Angle (°)</b>	<b>Field Strength (nT)</b>
	IGRF2015	7/1/2015	8.24	67.38	52,922

<b>Design</b>	APD Plan (Plat 5-26-15)			
<b>Audit Notes:</b>				
<b>Version:</b>	<b>Phase:</b>	PROTOTYPE	<b>Tie On Depth:</b>	0.0
<b>Vertical Section:</b>	<b>Depth From (TVD) (usft)</b>	<b>+N/-S (usft)</b>	<b>+E/-W (usft)</b>	<b>Direction (°)</b>
	0.0	0.0	0.0	359.21

<b>Plan Sections</b>										
Measured Depth (usft)	Inclination (°)	Azimuth (°)	Vertical Depth (usft)	+N/-S (usft)	+E/-W (usft)	Dogleg Rate (°/100usft)	Build Rate (°/100usft)	Turn Rate (°/100usft)	TFO (°)	Target
0.0	0.00	0.00	0.0	0.0	0.0	0.00	0.00	0.00	0.00	
6,824.0	0.00	0.00	6,824.0	0.0	0.0	0.00	0.00	0.00	0.00	
7,724.0	90.00	351.00	7,397.0	565.9	-89.6	10.00	10.00	0.00	351.00	
7,829.0	90.00	351.00	7,397.0	669.6	-106.1	0.00	0.00	0.00	0.00	
8,129.1	90.00	0.00	7,397.0	968.5	-129.6	3.00	0.00	3.00	90.00	502-1807H PBH 5-26
16,573.2	90.00	0.00	7,397.0	9,412.5	-129.1	0.00	0.00	0.00	0.00	502-1807H PBH 5-26

# EOG Resources, Inc.

## Planning Report

<b>Database:</b>	EDM_DENVER	<b>Local Co-ordinate Reference:</b>	Well Garden Creek 502-1807H
<b>Company:</b>	Denver Division- Colorado	<b>TVD Reference:</b>	WELL @ 5260.0usft (Original Well Elev)
<b>Project:</b>	DJ - Hereford Ranch	<b>MD Reference:</b>	WELL @ 5260.0usft (Original Well Elev)
<b>Site:</b>	Garden Creek GC18 SWSE Pad	<b>North Reference:</b>	True
<b>Well:</b>	Garden Creek 502-1807H	<b>Survey Calculation Method:</b>	Minimum Curvature
<b>Wellbore:</b>	Wellbore #1		
<b>Design:</b>	APD Plan (Plat 5-26-15)		

Planned Survey									
Measured Depth (usft)	Inclination (°)	Azimuth (°)	Vertical Depth (usft)	+N/-S (usft)	+E/-W (usft)	Vertical Section (usft)	Dogleg Rate (°/100usft)	Build Rate (°/100usft)	Turn Rate (°/100usft)
0.0	0.00	0.00	0.0	0.0	0.0	0.0	0.00	0.00	0.00
100.0	0.00	0.00	100.0	0.0	0.0	0.0	0.00	0.00	0.00
200.0	0.00	0.00	200.0	0.0	0.0	0.0	0.00	0.00	0.00
300.0	0.00	0.00	300.0	0.0	0.0	0.0	0.00	0.00	0.00
400.0	0.00	0.00	400.0	0.0	0.0	0.0	0.00	0.00	0.00
500.0	0.00	0.00	500.0	0.0	0.0	0.0	0.00	0.00	0.00
600.0	0.00	0.00	600.0	0.0	0.0	0.0	0.00	0.00	0.00
700.0	0.00	0.00	700.0	0.0	0.0	0.0	0.00	0.00	0.00
800.0	0.00	0.00	800.0	0.0	0.0	0.0	0.00	0.00	0.00
900.0	0.00	0.00	900.0	0.0	0.0	0.0	0.00	0.00	0.00
1,000.0	0.00	0.00	1,000.0	0.0	0.0	0.0	0.00	0.00	0.00
1,100.0	0.00	0.00	1,100.0	0.0	0.0	0.0	0.00	0.00	0.00
1,141.0	0.00	0.00	1,141.0	0.0	0.0	0.0	0.00	0.00	0.00
9-5/8" Surface									
1,200.0	0.00	0.00	1,200.0	0.0	0.0	0.0	0.00	0.00	0.00
1,300.0	0.00	0.00	1,300.0	0.0	0.0	0.0	0.00	0.00	0.00
1,400.0	0.00	0.00	1,400.0	0.0	0.0	0.0	0.00	0.00	0.00
1,500.0	0.00	0.00	1,500.0	0.0	0.0	0.0	0.00	0.00	0.00
1,600.0	0.00	0.00	1,600.0	0.0	0.0	0.0	0.00	0.00	0.00
1,700.0	0.00	0.00	1,700.0	0.0	0.0	0.0	0.00	0.00	0.00
1,800.0	0.00	0.00	1,800.0	0.0	0.0	0.0	0.00	0.00	0.00
1,900.0	0.00	0.00	1,900.0	0.0	0.0	0.0	0.00	0.00	0.00
2,000.0	0.00	0.00	2,000.0	0.0	0.0	0.0	0.00	0.00	0.00
2,100.0	0.00	0.00	2,100.0	0.0	0.0	0.0	0.00	0.00	0.00
2,200.0	0.00	0.00	2,200.0	0.0	0.0	0.0	0.00	0.00	0.00
2,300.0	0.00	0.00	2,300.0	0.0	0.0	0.0	0.00	0.00	0.00
2,400.0	0.00	0.00	2,400.0	0.0	0.0	0.0	0.00	0.00	0.00
2,500.0	0.00	0.00	2,500.0	0.0	0.0	0.0	0.00	0.00	0.00
2,600.0	0.00	0.00	2,600.0	0.0	0.0	0.0	0.00	0.00	0.00
2,700.0	0.00	0.00	2,700.0	0.0	0.0	0.0	0.00	0.00	0.00
2,800.0	0.00	0.00	2,800.0	0.0	0.0	0.0	0.00	0.00	0.00
2,900.0	0.00	0.00	2,900.0	0.0	0.0	0.0	0.00	0.00	0.00
3,000.0	0.00	0.00	3,000.0	0.0	0.0	0.0	0.00	0.00	0.00
3,100.0	0.00	0.00	3,100.0	0.0	0.0	0.0	0.00	0.00	0.00
3,200.0	0.00	0.00	3,200.0	0.0	0.0	0.0	0.00	0.00	0.00
3,300.0	0.00	0.00	3,300.0	0.0	0.0	0.0	0.00	0.00	0.00
3,400.0	0.00	0.00	3,400.0	0.0	0.0	0.0	0.00	0.00	0.00
3,500.0	0.00	0.00	3,500.0	0.0	0.0	0.0	0.00	0.00	0.00
3,600.0	0.00	0.00	3,600.0	0.0	0.0	0.0	0.00	0.00	0.00
3,700.0	0.00	0.00	3,700.0	0.0	0.0	0.0	0.00	0.00	0.00
3,800.0	0.00	0.00	3,800.0	0.0	0.0	0.0	0.00	0.00	0.00
3,900.0	0.00	0.00	3,900.0	0.0	0.0	0.0	0.00	0.00	0.00
4,000.0	0.00	0.00	4,000.0	0.0	0.0	0.0	0.00	0.00	0.00
4,100.0	0.00	0.00	4,100.0	0.0	0.0	0.0	0.00	0.00	0.00
4,200.0	0.00	0.00	4,200.0	0.0	0.0	0.0	0.00	0.00	0.00
4,300.0	0.00	0.00	4,300.0	0.0	0.0	0.0	0.00	0.00	0.00
4,400.0	0.00	0.00	4,400.0	0.0	0.0	0.0	0.00	0.00	0.00
4,500.0	0.00	0.00	4,500.0	0.0	0.0	0.0	0.00	0.00	0.00
4,600.0	0.00	0.00	4,600.0	0.0	0.0	0.0	0.00	0.00	0.00
4,700.0	0.00	0.00	4,700.0	0.0	0.0	0.0	0.00	0.00	0.00
4,800.0	0.00	0.00	4,800.0	0.0	0.0	0.0	0.00	0.00	0.00
4,900.0	0.00	0.00	4,900.0	0.0	0.0	0.0	0.00	0.00	0.00
5,000.0	0.00	0.00	5,000.0	0.0	0.0	0.0	0.00	0.00	0.00
5,100.0	0.00	0.00	5,100.0	0.0	0.0	0.0	0.00	0.00	0.00

# EOG Resources, Inc.

## Planning Report

<b>Database:</b>	EDM_DENVER	<b>Local Co-ordinate Reference:</b>	Well Garden Creek 502-1807H
<b>Company:</b>	Denver Division- Colorado	<b>TVD Reference:</b>	WELL @ 5260.0usft (Original Well Elev)
<b>Project:</b>	DJ - Hereford Ranch	<b>MD Reference:</b>	WELL @ 5260.0usft (Original Well Elev)
<b>Site:</b>	Garden Creek GC18 SWSE Pad	<b>North Reference:</b>	True
<b>Well:</b>	Garden Creek 502-1807H	<b>Survey Calculation Method:</b>	Minimum Curvature
<b>Wellbore:</b>	Wellbore #1		
<b>Design:</b>	APD Plan (Plat 5-26-15)		

Planned Survey									
Measured Depth (usft)	Inclination (°)	Azimuth (°)	Vertical Depth (usft)	+N/-S (usft)	+E/-W (usft)	Vertical Section (usft)	Dogleg Rate (°/100usft)	Build Rate (°/100usft)	Turn Rate (°/100usft)
5,200.0	0.00	0.00	5,200.0	0.0	0.0	0.0	0.00	0.00	0.00
5,300.0	0.00	0.00	5,300.0	0.0	0.0	0.0	0.00	0.00	0.00
5,400.0	0.00	0.00	5,400.0	0.0	0.0	0.0	0.00	0.00	0.00
5,500.0	0.00	0.00	5,500.0	0.0	0.0	0.0	0.00	0.00	0.00
5,600.0	0.00	0.00	5,600.0	0.0	0.0	0.0	0.00	0.00	0.00
5,700.0	0.00	0.00	5,700.0	0.0	0.0	0.0	0.00	0.00	0.00
5,800.0	0.00	0.00	5,800.0	0.0	0.0	0.0	0.00	0.00	0.00
5,900.0	0.00	0.00	5,900.0	0.0	0.0	0.0	0.00	0.00	0.00
6,000.0	0.00	0.00	6,000.0	0.0	0.0	0.0	0.00	0.00	0.00
6,100.0	0.00	0.00	6,100.0	0.0	0.0	0.0	0.00	0.00	0.00
6,200.0	0.00	0.00	6,200.0	0.0	0.0	0.0	0.00	0.00	0.00
6,300.0	0.00	0.00	6,300.0	0.0	0.0	0.0	0.00	0.00	0.00
6,400.0	0.00	0.00	6,400.0	0.0	0.0	0.0	0.00	0.00	0.00
6,500.0	0.00	0.00	6,500.0	0.0	0.0	0.0	0.00	0.00	0.00
6,600.0	0.00	0.00	6,600.0	0.0	0.0	0.0	0.00	0.00	0.00
6,700.0	0.00	0.00	6,700.0	0.0	0.0	0.0	0.00	0.00	0.00
6,800.0	0.00	0.00	6,800.0	0.0	0.0	0.0	0.00	0.00	0.00
6,824.0	0.00	0.00	6,824.0	0.0	0.0	0.0	0.00	0.00	0.00
6,900.0	7.60	351.00	6,899.8	5.0	-0.8	5.0	10.00	10.00	0.00
7,000.0	17.60	351.00	6,997.2	26.5	-4.2	26.5	10.00	10.00	0.00
7,100.0	27.60	351.00	7,089.4	64.4	-10.2	64.5	10.00	10.00	0.00
7,200.0	37.60	351.00	7,173.6	117.5	-18.6	117.8	10.00	10.00	0.00
7,300.0	47.60	351.00	7,247.1	184.3	-29.2	184.7	10.00	10.00	0.00
7,400.0	57.60	351.00	7,307.8	262.7	-41.6	263.2	10.00	10.00	0.00
7,500.0	67.60	351.00	7,353.7	350.3	-55.5	351.0	10.00	10.00	0.00
7,600.0	77.60	351.00	7,383.6	444.4	-70.4	445.3	10.00	10.00	0.00
7,700.0	87.60	351.00	7,396.5	542.2	-85.9	543.3	10.00	10.00	0.00
7,724.0	90.00	351.00	7,397.0	565.9	-89.6	567.1	10.00	10.00	0.00
7" Inter (OPT 2)									
7,800.0	90.00	351.00	7,397.0	641.0	-101.5	642.3	0.00	0.00	0.00
7,829.0	90.00	351.00	7,397.0	669.6	-106.1	671.0	0.00	0.00	0.00
7,900.0	90.00	353.13	7,397.0	739.9	-115.9	741.4	3.00	0.00	3.00
8,000.0	90.00	356.13	7,397.0	839.5	-125.2	841.1	3.00	0.00	3.00
8,100.0	90.00	359.13	7,397.0	939.4	-129.3	941.1	3.00	0.00	3.00
8,129.1	90.00	0.00	7,397.0	968.5	-129.6	970.2	3.00	0.00	3.00
8,200.0	90.00	0.00	7,397.0	1,039.4	-129.6	1,041.1	0.00	0.00	0.00
8,300.0	90.00	0.00	7,397.0	1,139.4	-129.6	1,141.0	0.00	0.00	0.00
8,400.0	90.00	0.00	7,397.0	1,239.4	-129.6	1,241.0	0.00	0.00	0.00
8,500.0	90.00	0.00	7,397.0	1,339.4	-129.5	1,341.0	0.00	0.00	0.00
8,600.0	90.00	0.00	7,397.0	1,439.4	-129.5	1,441.0	0.00	0.00	0.00
8,700.0	90.00	0.00	7,397.0	1,539.4	-129.5	1,541.0	0.00	0.00	0.00
8,800.0	90.00	0.00	7,397.0	1,639.4	-129.5	1,641.0	0.00	0.00	0.00
8,900.0	90.00	0.00	7,397.0	1,739.4	-129.5	1,741.0	0.00	0.00	0.00
9,000.0	90.00	0.00	7,397.0	1,839.4	-129.5	1,841.0	0.00	0.00	0.00
9,100.0	90.00	0.00	7,397.0	1,939.4	-129.5	1,941.0	0.00	0.00	0.00
9,200.0	90.00	0.00	7,397.0	2,039.4	-129.5	2,041.0	0.00	0.00	0.00
9,300.0	90.00	0.00	7,397.0	2,139.4	-129.5	2,141.0	0.00	0.00	0.00
9,400.0	90.00	0.00	7,397.0	2,239.4	-129.5	2,240.9	0.00	0.00	0.00
9,500.0	90.00	0.00	7,397.0	2,339.4	-129.5	2,340.9	0.00	0.00	0.00
9,600.0	90.00	0.00	7,397.0	2,439.4	-129.5	2,440.9	0.00	0.00	0.00
9,700.0	90.00	0.00	7,397.0	2,539.4	-129.5	2,540.9	0.00	0.00	0.00
9,800.0	90.00	0.00	7,397.0	2,639.4	-129.5	2,640.9	0.00	0.00	0.00
9,900.0	90.00	0.00	7,397.0	2,739.4	-129.5	2,740.9	0.00	0.00	0.00

# EOG Resources, Inc.

## Planning Report

<b>Database:</b>	EDM_DENVER	<b>Local Co-ordinate Reference:</b>	Well Garden Creek 502-1807H
<b>Company:</b>	Denver Division- Colorado	<b>TVD Reference:</b>	WELL @ 5260.0usft (Original Well Elev)
<b>Project:</b>	DJ - Hereford Ranch	<b>MD Reference:</b>	WELL @ 5260.0usft (Original Well Elev)
<b>Site:</b>	Garden Creek GC18 SWSE Pad	<b>North Reference:</b>	True
<b>Well:</b>	Garden Creek 502-1807H	<b>Survey Calculation Method:</b>	Minimum Curvature
<b>Wellbore:</b>	Wellbore #1		
<b>Design:</b>	APD Plan (Plat 5-26-15)		

Planned Survey									
Measured Depth (usft)	Inclination (°)	Azimuth (°)	Vertical Depth (usft)	+N/-S (usft)	+E/-W (usft)	Vertical Section (usft)	Dogleg Rate (°/100usft)	Build Rate (°/100usft)	Turn Rate (°/100usft)
10,000.0	90.00	0.00	7,397.0	2,839.4	-129.5	2,840.9	0.00	0.00	0.00
10,100.0	90.00	0.00	7,397.0	2,939.4	-129.5	2,940.9	0.00	0.00	0.00
10,200.0	90.00	0.00	7,397.0	3,039.4	-129.4	3,040.9	0.00	0.00	0.00
10,300.0	90.00	0.00	7,397.0	3,139.4	-129.4	3,140.9	0.00	0.00	0.00
10,400.0	90.00	0.00	7,397.0	3,239.4	-129.4	3,240.8	0.00	0.00	0.00
10,500.0	90.00	0.00	7,397.0	3,339.4	-129.4	3,340.8	0.00	0.00	0.00
10,600.0	90.00	0.00	7,397.0	3,439.4	-129.4	3,440.8	0.00	0.00	0.00
10,700.0	90.00	0.00	7,397.0	3,539.4	-129.4	3,540.8	0.00	0.00	0.00
10,800.0	90.00	0.00	7,397.0	3,639.4	-129.4	3,640.8	0.00	0.00	0.00
10,900.0	90.00	0.00	7,397.0	3,739.4	-129.4	3,740.8	0.00	0.00	0.00
11,000.0	90.00	0.00	7,397.0	3,839.4	-129.4	3,840.8	0.00	0.00	0.00
11,100.0	90.00	0.00	7,397.0	3,939.4	-129.4	3,940.8	0.00	0.00	0.00
11,200.0	90.00	0.00	7,397.0	4,039.4	-129.4	4,040.8	0.00	0.00	0.00
11,300.0	90.00	0.00	7,397.0	4,139.4	-129.4	4,140.8	0.00	0.00	0.00
11,400.0	90.00	0.00	7,397.0	4,239.4	-129.4	4,240.8	0.00	0.00	0.00
11,500.0	90.00	0.00	7,397.0	4,339.4	-129.4	4,340.7	0.00	0.00	0.00
11,600.0	90.00	0.00	7,397.0	4,439.4	-129.4	4,440.7	0.00	0.00	0.00
11,700.0	90.00	0.00	7,397.0	4,539.4	-129.4	4,540.7	0.00	0.00	0.00
11,800.0	90.00	0.00	7,397.0	4,639.4	-129.4	4,640.7	0.00	0.00	0.00
11,900.0	90.00	0.00	7,397.0	4,739.4	-129.3	4,740.7	0.00	0.00	0.00
12,000.0	90.00	0.00	7,397.0	4,839.4	-129.3	4,840.7	0.00	0.00	0.00
12,100.0	90.00	0.00	7,397.0	4,939.4	-129.3	4,940.7	0.00	0.00	0.00
12,200.0	90.00	0.00	7,397.0	5,039.4	-129.3	5,040.7	0.00	0.00	0.00
12,300.0	90.00	0.00	7,397.0	5,139.4	-129.3	5,140.7	0.00	0.00	0.00
12,400.0	90.00	0.00	7,397.0	5,239.4	-129.3	5,240.7	0.00	0.00	0.00
12,500.0	90.00	0.00	7,397.0	5,339.4	-129.3	5,340.6	0.00	0.00	0.00
12,600.0	90.00	0.00	7,397.0	5,439.4	-129.3	5,440.6	0.00	0.00	0.00
12,700.0	90.00	0.00	7,397.0	5,539.4	-129.3	5,540.6	0.00	0.00	0.00
12,800.0	90.00	0.00	7,397.0	5,639.4	-129.3	5,640.6	0.00	0.00	0.00
12,900.0	90.00	0.00	7,397.0	5,739.4	-129.3	5,740.6	0.00	0.00	0.00
13,000.0	90.00	0.00	7,397.0	5,839.4	-129.3	5,840.6	0.00	0.00	0.00
13,100.0	90.00	0.00	7,397.0	5,939.4	-129.3	5,940.6	0.00	0.00	0.00
13,200.0	90.00	0.00	7,397.0	6,039.4	-129.3	6,040.6	0.00	0.00	0.00
13,300.0	90.00	0.00	7,397.0	6,139.4	-129.3	6,140.6	0.00	0.00	0.00
13,400.0	90.00	0.00	7,397.0	6,239.4	-129.3	6,240.6	0.00	0.00	0.00
13,500.0	90.00	0.00	7,397.0	6,339.4	-129.3	6,340.6	0.00	0.00	0.00
13,600.0	90.00	0.00	7,397.0	6,439.4	-129.2	6,440.5	0.00	0.00	0.00
13,700.0	90.00	0.00	7,397.0	6,539.4	-129.2	6,540.5	0.00	0.00	0.00
13,800.0	90.00	0.00	7,397.0	6,639.4	-129.2	6,640.5	0.00	0.00	0.00
13,900.0	90.00	0.00	7,397.0	6,739.4	-129.2	6,740.5	0.00	0.00	0.00
14,000.0	90.00	0.00	7,397.0	6,839.4	-129.2	6,840.5	0.00	0.00	0.00
14,100.0	90.00	0.00	7,397.0	6,939.4	-129.2	6,940.5	0.00	0.00	0.00
14,200.0	90.00	0.00	7,397.0	7,039.4	-129.2	7,040.5	0.00	0.00	0.00
14,300.0	90.00	0.00	7,397.0	7,139.4	-129.2	7,140.5	0.00	0.00	0.00
14,400.0	90.00	0.00	7,397.0	7,239.4	-129.2	7,240.5	0.00	0.00	0.00
14,500.0	90.00	0.00	7,397.0	7,339.4	-129.2	7,340.5	0.00	0.00	0.00
14,600.0	90.00	0.00	7,397.0	7,439.4	-129.2	7,440.5	0.00	0.00	0.00
14,700.0	90.00	0.00	7,397.0	7,539.4	-129.2	7,540.4	0.00	0.00	0.00
14,800.0	90.00	0.00	7,397.0	7,639.4	-129.2	7,640.4	0.00	0.00	0.00
14,900.0	90.00	0.00	7,397.0	7,739.4	-129.2	7,740.4	0.00	0.00	0.00
15,000.0	90.00	0.00	7,397.0	7,839.4	-129.2	7,840.4	0.00	0.00	0.00
15,100.0	90.00	0.00	7,397.0	7,939.4	-129.2	7,940.4	0.00	0.00	0.00
15,200.0	90.00	0.00	7,397.0	8,039.4	-129.1	8,040.4	0.00	0.00	0.00
15,300.0	90.00	0.00	7,397.0	8,139.4	-129.1	8,140.4	0.00	0.00	0.00

# EOG Resources, Inc.

## Planning Report

<b>Database:</b>	EDM_DENVER	<b>Local Co-ordinate Reference:</b>	Well Garden Creek 502-1807H
<b>Company:</b>	Denver Division- Colorado	<b>TVD Reference:</b>	WELL @ 5260.0usft (Original Well Elev)
<b>Project:</b>	DJ - Hereford Ranch	<b>MD Reference:</b>	WELL @ 5260.0usft (Original Well Elev)
<b>Site:</b>	Garden Creek GC18 SWSE Pad	<b>North Reference:</b>	True
<b>Well:</b>	Garden Creek 502-1807H	<b>Survey Calculation Method:</b>	Minimum Curvature
<b>Wellbore:</b>	Wellbore #1		
<b>Design:</b>	APD Plan (Plat 5-26-15)		

Planned Survey										
Measured Depth (usft)	Inclination (°)	Azimuth (°)	Vertical Depth (usft)	+N/-S (usft)	+E/-W (usft)	Vertical Section (usft)	Dogleg Rate (°/100usft)	Build Rate (°/100usft)	Turn Rate (°/100usft)	
15,400.0	90.00	0.00	7,397.0	8,239.4	-129.1	8,240.4	0.00	0.00	0.00	
15,500.0	90.00	0.00	7,397.0	8,339.4	-129.1	8,340.4	0.00	0.00	0.00	
15,600.0	90.00	0.00	7,397.0	8,439.4	-129.1	8,440.4	0.00	0.00	0.00	
15,700.0	90.00	0.00	7,397.0	8,539.4	-129.1	8,540.3	0.00	0.00	0.00	
15,800.0	90.00	0.00	7,397.0	8,639.4	-129.1	8,640.3	0.00	0.00	0.00	
15,900.0	90.00	0.00	7,397.0	8,739.4	-129.1	8,740.3	0.00	0.00	0.00	
16,000.0	90.00	0.00	7,397.0	8,839.4	-129.1	8,840.3	0.00	0.00	0.00	
16,100.0	90.00	0.00	7,397.0	8,939.4	-129.1	8,940.3	0.00	0.00	0.00	
16,200.0	90.00	0.00	7,397.0	9,039.4	-129.1	9,040.3	0.00	0.00	0.00	
16,300.0	90.00	0.00	7,397.0	9,139.4	-129.1	9,140.3	0.00	0.00	0.00	
16,400.0	90.00	0.00	7,397.0	9,239.4	-129.1	9,240.3	0.00	0.00	0.00	
16,500.0	90.00	0.00	7,397.0	9,339.4	-129.1	9,340.3	0.00	0.00	0.00	
16,573.2	90.00	0.00	7,397.0	9,412.5	-129.1	9,413.4	0.00	0.00	0.00	

Design Targets										
Target Name	Dip Angle (°)	Dip Dir. (°)	TVD (usft)	+N/-S (usft)	+E/-W (usft)	Northing (usft)	Easting (usft)	Latitude	Longitude	
- hit/miss target										
- Shape										
502-1807H PBH 5-26-15	0.00	0.00	7,397.0	9,412.5	-129.1	588,525.05	2,314,536.61	40° 56' 36.063 N	104° 21' 41.474 W	
- plan hits target center										
- Point										

Casing Points						
Measured Depth (usft)	Vertical Depth (usft)	Name	Casing Diameter (")	Hole Diameter (")		
1,141.0	1,141.0	9-5/8" Surface	9-5/8	13-1/2		
7,724.0	7,397.0	7" Inter (OPT 2)	7	8-3/4		
16,573.2	7,397.0	5-1/2" Prod (OPT 1)	5-1/2	8-3/4		
16,573.2	7,397.0	4-1/2" Liner (OPT 2)	4-1/2	6		