

KERR-MCGEE OIL & GAS ONSHORE LP (LAMBERT STATE PLANE COORD)

Location: COLORADO Slot: SLOT#09 HUNZIKER 1C-28HZ (433'FSL & 1593'FEL, SEC.28)
 Field: WELD COUNTY (KERR MCGEE) Well: HUNZIKER 1C-28HZ
 Facility: SEC.28-T2N-R67W Wellbore: HUNZIKER 1C-28HZ PWB

Plot reference wellpath is HUNZIKER 1C-28HZ (REV-B.0) PWP

True vertical depths are referenced to PRECISION 460 (20'KB) (RKB)	Grid System: NAD83 / Lambert Colorado SP, Northern Zone (501), US feet
Measured depths are referenced to PRECISION 460 (20'KB) (RKB)	North Reference: True north
PRECISION 460 (20'KB) (RKB) to Mean Sea Level: 5069 feet	Scale: True distance
Mean Sea Level to Mud line (At Slot: SLOT#09 HUNZIKER 1C-28HZ (433'FSL & 1593'FEL, SEC.28)): 0 feet	Depths are in feet
Coordinates are in feet referenced to Slot	Created by: amarcar on 30/Mar/2015

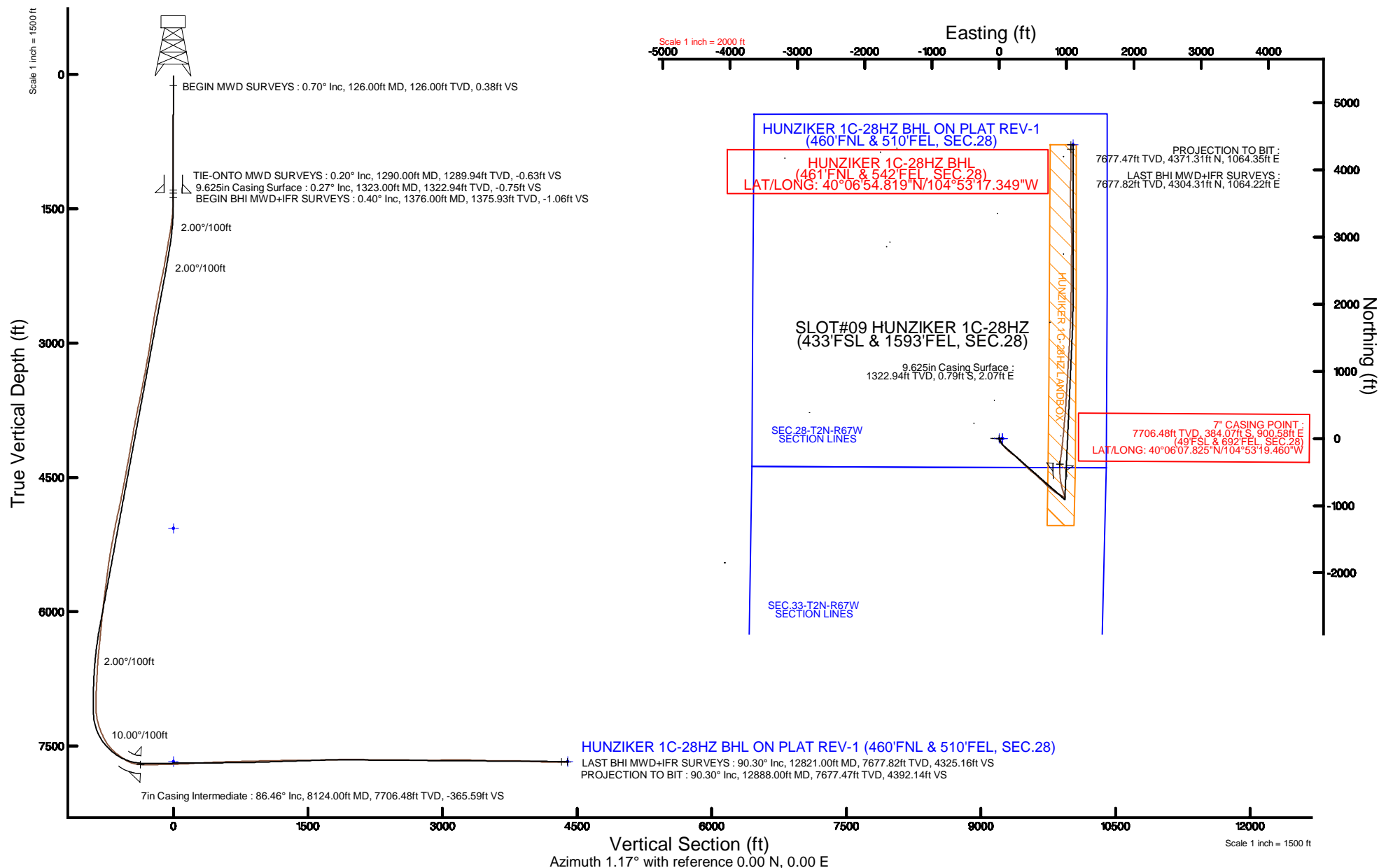

REFERENCE WELLPATH IDENTIFICATION

Operator	KERR-MCGEE OIL & GAS ONSHORE LP (LAMBERT STATE PLANE COORD)	Slot	SLOT#09 HUNZIKER 1C-28HZ (433'FSL & 1593'FEL, SEC.28)
Area	COLORADO	Well	HUNZIKER 1C-28HZ
Field	WELD COUNTY (KERR MCGEE)	Wellbore	HUNZIKER 1C-28HZ AWB <12888>
Facility	SEC.28-T2N-R67W		

REPORT SETUP INFORMATION

Projection System	NAD83 / Lambert Colorado SP, Northern Zone (501), US feet	Software System	WellArchitect® 4.1.1
North Reference	True	User	Amarcar
Scale	0.99996	Report Generated	30/Mar/2015 at 12:28
Convergence at slot	0.39° East	Database/Source file	WellArchitectDB/HUNZIKER_1C-28HZ_AWB_12888_.xml

WELLPATH LOCATION

	Local coordinates		Grid coordinates		Geographic coordinates	
	North[ft]	East[ft]	Easting[US ft]	Northing[US ft]	Latitude	Longitude
Slot Location	-4193.71	-944.98	3170085.95	1281033.46	40°06'11.621"N	104°53'31.049"W
Facility Reference Pt			3171001.96	1285233.41	40°06'53.064"N	104°53'18.888"W
Field Reference Pt			3197771.84	1268891.29	40°04'09.600"N	104°47'36.000"W

WELLPATH DATUM

Calculation method	Minimum curvature	PRECISION 460 (20'KB) (RKB) to Facility Vertical Datum	5069.00ft
Horizontal Reference Pt	Slot	PRECISION 460 (20'KB) (RKB) to Mean Sea Level	5069.00ft
Vertical Reference Pt	PRECISION 460 (20'KB) (RKB)	PRECISION 460 (20'KB) (RKB) to Mud Line at Slot (SLOT#09 HUNZIKER 1C-28HZ (433'FSL & 1593'FEL, SEC.28))	5069.00ft
MD Reference Pt	PRECISION 460 (20'KB) (RKB)	Section Origin	N 0.00, E 0.00 ft
Field Vertical Reference	Mean Sea Level	Section Azimuth	1.17°

REFERENCE WELLPATH IDENTIFICATION

Operator	KERR-MCGEE OIL & GAS ONSHORE LP (LAMBERT STATE PLANE COORD)	Slot	SLOT#09 HUNZIKER 1C-28HZ (433'FSL & 1593'FEL, SEC.28)
Area	COLORADO	Well	HUNZIKER 1C-28HZ
Field	WELD COUNTY (KERR MCGEE)	Wellbore	HUNZIKER 1C-28HZ AWP <12888>
Facility	SEC.28-T2N-R67W		

WELLPATH DATA (123 stations) † = interpolated/extrapolated station

MD [ft]	Inclination [°]	Azimuth [°]	TVD [ft]	Vert Sect [ft]	North [ft]	East [ft]	Latitude	Longitude	DLS [°/100ft]	Comments
0.00†	0.000	306.600	0.00	0.00	0.00	0.00	40°06'11.621"N	104°53'31.049"W	0.00	
20.00	0.000	306.600	20.00	0.00	0.00	0.00	40°06'11.621"N	104°53'31.049"W	0.00	
126.00	0.700	306.600	126.00	0.38	0.39	-0.52	40°06'11.625"N	104°53'31.056"W	0.66	BEGIN MWD SURVEYS
215.00	0.200	224.300	214.99	0.58	0.60	-1.06	40°06'11.627"N	104°53'31.063"W	0.79	
301.00	0.700	324.000	300.99	0.89	0.92	-1.48	40°06'11.630"N	104°53'31.068"W	0.88	
390.00	1.000	154.500	389.99	0.63	0.66	-1.46	40°06'11.627"N	104°53'31.068"W	1.90	
479.00	1.400	161.500	478.97	-1.09	-1.08	-0.78	40°06'11.610"N	104°53'31.059"W	0.48	
573.00	1.000	114.300	572.95	-2.50	-2.50	0.33	40°06'11.596"N	104°53'31.045"W	1.09	
666.00	0.500	33.300	665.94	-2.47	-2.50	1.29	40°06'11.596"N	104°53'31.032"W	1.12	
762.00	0.700	359.100	761.94	-1.53	-1.56	1.51	40°06'11.606"N	104°53'31.030"W	0.42	
858.00	0.200	26.300	857.94	-0.79	-0.82	1.58	40°06'11.613"N	104°53'31.029"W	0.55	
954.00	0.100	44.700	953.94	-0.58	-0.62	1.71	40°06'11.615"N	104°53'31.027"W	0.11	
1050.00	0.100	65.600	1049.94	-0.48	-0.52	1.84	40°06'11.616"N	104°53'31.025"W	0.04	
1146.00	0.100	91.400	1145.94	-0.45	-0.49	2.00	40°06'11.616"N	104°53'31.023"W	0.05	
1239.00	0.100	143.600	1238.94	-0.51	-0.56	2.13	40°06'11.616"N	104°53'31.022"W	0.09	
1290.00	0.200	210.000	1289.94	-0.63	-0.67	2.12	40°06'11.614"N	104°53'31.022"W	0.36	TIE-ONTO MWD SURVEYS
1376.00	0.400	176.690	1375.93	-1.06	-1.10	2.06	40°06'11.610"N	104°53'31.023"W	0.30	BEGIN BHI MWD+IFR SURVEYS
1470.00	3.410	150.620	1469.87	-3.79	-3.86	3.45	40°06'11.583"N	104°53'31.005"W	3.25	
1560.00	5.840	158.340	1559.57	-10.32	-10.45	6.45	40°06'11.518"N	104°53'30.966"W	2.78	
1650.00	7.450	155.030	1648.97	-19.78	-20.00	10.61	40°06'11.423"N	104°53'30.913"W	1.84	
1740.00	9.100	159.740	1738.03	-31.64	-31.96	15.53	40°06'11.305"N	104°53'30.849"W	1.98	
1829.00	11.130	159.500	1825.64	-46.18	-46.61	20.98	40°06'11.160"N	104°53'30.779"W	2.28	
1919.00	11.970	152.820	1913.82	-62.46	-63.05	28.29	40°06'10.998"N	104°53'30.685"W	1.75	
2009.00	12.260	139.500	2001.83	-77.82	-78.63	38.76	40°06'10.844"N	104°53'30.550"W	3.12	
2099.00	12.610	142.720	2089.72	-92.65	-93.71	50.91	40°06'10.695"N	104°53'30.394"W	0.86	
2189.00	14.560	140.300	2177.20	-108.90	-110.23	64.09	40°06'10.532"N	104°53'30.224"W	2.26	
2279.00	16.200	137.120	2263.98	-126.48	-128.14	79.86	40°06'10.355"N	104°53'30.021"W	2.05	
2458.00	16.090	135.040	2435.92	-161.62	-163.99	114.38	40°06'10.000"N	104°53'29.577"W	0.33	
2638.00	16.260	129.850	2608.80	-194.65	-197.79	151.35	40°06'09.666"N	104°53'29.101"W	0.81	
2817.00	15.330	127.600	2781.04	-224.37	-228.28	189.34	40°06'09.365"N	104°53'28.612"W	0.62	
2997.00	14.920	124.340	2954.81	-251.17	-255.87	227.33	40°06'09.092"N	104°53'28.124"W	0.52	
3176.00	15.020	132.870	3127.76	-279.21	-284.65	263.36	40°06'08.808"N	104°53'27.660"W	1.23	
3356.00	14.380	133.780	3301.86	-309.86	-315.99	296.59	40°06'08.498"N	104°53'27.232"W	0.38	
3446.00	15.520	137.470	3388.82	-326.13	-332.59	312.80	40°06'08.334"N	104°53'27.024"W	1.65	
3536.00	15.710	133.290	3475.50	-343.01	-349.82	329.81	40°06'08.164"N	104°53'26.805"W	1.27	
3715.00	17.170	135.680	3647.18	-377.79	-385.35	365.91	40°06'07.813"N	104°53'26.340"W	0.90	
3895.00	16.530	134.030	3819.45	-413.83	-422.15	402.88	40°06'07.449"N	104°53'25.864"W	0.44	
4075.00	14.450	130.400	3992.91	-445.46	-454.51	438.40	40°06'07.129"N	104°53'25.407"W	1.27	
4165.00	15.790	131.900	4079.79	-460.55	-469.97	456.07	40°06'06.977"N	104°53'25.180"W	1.55	
4254.00	15.770	127.780	4165.44	-475.66	-485.46	474.64	40°06'06.824"N	104°53'24.941"W	1.26	
4344.00	16.760	126.790	4251.84	-490.51	-500.73	494.70	40°06'06.673"N	104°53'24.683"W	1.14	
4434.00	17.490	130.070	4337.85	-506.56	-517.20	515.44	40°06'06.510"N	104°53'24.416"W	1.34	
4614.00	14.860	133.220	4510.71	-539.02	-550.43	552.97	40°06'06.182"N	104°53'23.933"W	1.54	
4704.00	15.040	137.430	4597.67	-555.18	-566.93	569.28	40°06'06.018"N	104°53'23.723"W	1.22	
4794.00	16.400	130.820	4684.30	-571.73	-583.84	586.79	40°06'05.851"N	104°53'23.498"W	2.50	

REFERENCE WELLPATH IDENTIFICATION

Operator	KERR-MCGEE OIL & GAS ONSHORE LP (LAMBERT STATE PLANE COORD)	Slot	SLOT#09 HUNZIKER 1C-28HZ (433'FSL & 1593'FEL, SEC.28)
Area	COLORADO	Well	HUNZIKER 1C-28HZ
Field	WELD COUNTY (KERR MCGEE)	Wellbore	HUNZIKER 1C-28HZ AWB <12888>
Facility	SEC.28-T2N-R67W		

WELLPATH DATA (123 stations) † = interpolated/extrapolated station

MD [ft]	Inclination [°]	Azimuth [°]	TVD [ft]	Vert Sect [ft]	North [ft]	East [ft]	Latitude	Longitude	DLS [°/100ft]	Comments
4883.00	17.520	132.020	4769.43	-588.51	-601.02	606.26	40°06'05.682"N	104°53'23.247"W	1.32	
5063.00	18.570	133.090	4940.58	-625.38	-638.74	647.32	40°06'05.309"N	104°53'22.719"W	0.61	
5242.00	14.920	134.520	5111.96	-660.25	-674.38	684.57	40°06'04.957"N	104°53'22.239"W	2.05	
5422.00	15.300	132.710	5285.74	-691.91	-706.73	718.55	40°06'04.637"N	104°53'21.802"W	0.34	
5602.00	14.180	126.860	5459.82	-720.52	-736.07	753.64	40°06'04.347"N	104°53'21.351"W	1.03	
5692.00	11.340	129.590	5547.59	-732.45	-748.32	769.28	40°06'04.226"N	104°53'21.149"W	3.23	
5872.00	11.500	128.610	5724.03	-754.36	-770.80	796.94	40°06'04.004"N	104°53'20.793"W	0.14	
6051.00	11.660	128.480	5899.38	-776.17	-793.19	825.04	40°06'03.782"N	104°53'20.432"W	0.09	
6141.00	10.810	125.020	5987.66	-786.38	-803.69	839.08	40°06'03.679"N	104°53'20.251"W	1.21	
6321.00	11.490	118.040	6164.27	-803.89	-821.81	868.72	40°06'03.500"N	104°53'19.870"W	0.84	
6411.00	13.320	117.490	6252.16	-812.54	-830.81	885.83	40°06'03.411"N	104°53'19.650"W	2.04	
6500.00	10.780	118.160	6339.19	-820.86	-839.47	902.27	40°06'03.325"N	104°53'19.438"W	2.86	
6590.00	12.110	122.620	6427.40	-829.61	-848.53	917.64	40°06'03.236"N	104°53'19.240"W	1.77	
6680.00	9.990	120.040	6515.73	-838.30	-857.53	932.35	40°06'03.147"N	104°53'19.051"W	2.42	
6770.00	7.870	116.240	6604.64	-844.68	-864.16	944.64	40°06'03.081"N	104°53'18.893"W	2.44	
6860.00	5.730	114.590	6694.00	-849.08	-868.76	954.25	40°06'03.036"N	104°53'18.769"W	2.39	
6949.00	6.400	124.930	6782.50	-853.60	-873.45	962.36	40°06'02.989"N	104°53'18.665"W	1.44	
7039.00	4.720	124.490	6872.07	-858.42	-878.41	969.53	40°06'02.940"N	104°53'18.573"W	1.87	
7129.00	3.300	119.710	6961.85	-861.69	-881.80	974.83	40°06'02.907"N	104°53'18.504"W	1.62	
7219.00	2.030	119.750	7051.75	-863.70	-883.87	978.46	40°06'02.886"N	104°53'18.458"W	1.41	
7308.00	7.590	346.540	7140.52	-858.75	-878.93	978.46	40°06'02.935"N	104°53'18.458"W	10.23	
7398.00	14.690	343.330	7228.77	-842.12	-862.19	973.80	40°06'03.101"N	104°53'18.518"W	7.92	
7488.00	21.740	339.010	7314.21	-815.78	-835.66	964.54	40°06'03.363"N	104°53'18.637"W	7.97	
7578.00	26.520	339.700	7396.32	-781.63	-801.24	951.59	40°06'03.703"N	104°53'18.803"W	5.32	
7668.00	35.320	345.100	7473.47	-737.83	-757.15	937.90	40°06'04.139"N	104°53'18.979"W	10.24	
7758.00	46.760	348.840	7541.25	-680.61	-699.65	924.82	40°06'04.707"N	104°53'19.148"W	13.00	
7848.00	52.870	351.590	7599.30	-613.14	-631.93	913.22	40°06'05.376"N	104°53'19.297"W	7.18	
7937.00	56.960	353.330	7650.45	-541.16	-559.74	903.69	40°06'06.089"N	104°53'19.420"W	4.87	
8027.00	71.910	357.270	7689.19	-460.63	-479.06	897.24	40°06'06.887"N	104°53'19.503"W	17.07	
8065.00	78.070	0.740	7699.03	-423.98	-442.39	896.61	40°06'07.249"N	104°53'19.511"W	18.45	
8085.00	81.880	3.470	7702.51	-404.29	-422.71	897.34	40°06'07.444"N	104°53'19.501"W	23.31	
8124.00†	86.457	6.102	7706.48	-365.59	-384.07	900.58	40°06'07.825"N	104°53'19.460"W	13.52	7" CASING POINT
8147.00	89.160	7.640	7707.36	-342.72	-361.25	903.33	40°06'08.051"N	104°53'19.424"W	13.52	
8237.00	90.300	7.930	7707.78	-253.32	-272.08	915.52	40°06'08.932"N	104°53'19.267"W	1.31	
8327.00	91.750	6.510	7706.17	-163.84	-182.82	926.83	40°06'09.814"N	104°53'19.122"W	2.25	
8507.00	90.890	5.440	7702.02	15.47	-3.84	945.56	40°06'11.583"N	104°53'18.881"W	0.76	
8687.00	93.820	5.260	7694.63	194.82	175.20	962.33	40°06'13.352"N	104°53'18.665"W	1.63	
8776.00	93.570	4.850	7688.89	283.44	263.67	970.15	40°06'14.226"N	104°53'18.564"W	0.54	
8911.00	92.210	4.990	7682.09	417.97	398.00	981.72	40°06'15.554"N	104°53'18.415"W	1.01	
9046.00	92.220	3.020	7676.87	552.70	532.56	991.14	40°06'16.884"N	104°53'18.294"W	1.46	
9136.00	91.880	3.200	7673.65	642.59	622.37	996.02	40°06'17.771"N	104°53'18.231"W	0.43	
9226.00	90.800	3.520	7671.54	732.50	712.19	1001.29	40°06'18.659"N	104°53'18.163"W	1.25	
9316.00	91.100	3.420	7670.05	822.41	802.01	1006.74	40°06'19.546"N	104°53'18.093"W	0.35	
9405.00	91.750	3.700	7667.84	911.31	890.81	1012.26	40°06'20.424"N	104°53'18.022"W	0.80	
9495.00	91.910	2.980	7664.96	1001.20	980.61	1017.50	40°06'21.311"N	104°53'17.954"W	0.82	

REFERENCE WELLPATH IDENTIFICATION

Operator	KERR-MCGEE OIL & GAS ONSHORE LP (LAMBERT STATE PLANE COORD)	Slot	SLOT#09 HUNZIKER 1C-28HZ (433'FSL & 1593'FEL, SEC.28)
Area	COLORADO	Well	HUNZIKER 1C-28HZ
Field	WELD COUNTY (KERR MCGEE)	Wellbore	HUNZIKER 1C-28HZ AWB <12888>
Facility	SEC.28-T2N-R67W		

WELLPATH DATA (123 stations)

MD [ft]	Inclination [°]	Azimuth [°]	TVD [ft]	Vert Sect [ft]	North [ft]	East [ft]	Latitude	Longitude	DLS [°/100ft]	Comments
9585.00	90.980	3.520	7662.69	1091.11	1070.44	1022.60	40°06'22.199"N	104°53'17.889"W	1.19	
9675.00	90.550	3.030	7661.49	1181.04	1160.28	1027.74	40°06'23.087"N	104°53'17.822"W	0.72	
9764.00	91.040	3.660	7660.26	1269.96	1249.12	1032.94	40°06'23.965"N	104°53'17.755"W	0.90	
9854.00	90.240	3.400	7659.25	1359.88	1338.95	1038.48	40°06'24.852"N	104°53'17.684"W	0.93	
9944.00	90.700	3.400	7658.51	1449.81	1428.78	1043.82	40°06'25.740"N	104°53'17.615"W	0.51	
10034.00	90.330	2.620	7657.70	1539.76	1518.65	1048.54	40°06'26.628"N	104°53'17.554"W	0.96	
10124.00	91.290	2.840	7656.43	1629.72	1608.54	1052.83	40°06'27.517"N	104°53'17.499"W	1.09	
10214.00	91.720	2.490	7654.07	1719.65	1698.41	1057.01	40°06'28.405"N	104°53'17.445"W	0.62	
10304.00	91.190	1.950	7651.78	1809.61	1788.32	1060.50	40°06'29.293"N	104°53'17.400"W	0.84	
10394.00	90.800	1.450	7650.22	1899.59	1878.26	1063.17	40°06'30.182"N	104°53'17.366"W	0.70	
10484.00	90.150	1.280	7649.47	1989.59	1968.23	1065.31	40°06'31.071"N	104°53'17.338"W	0.75	
10573.00	88.850	0.370	7650.25	2078.58	2057.22	1066.59	40°06'31.950"N	104°53'17.322"W	1.78	
10703.00	88.850	0.270	7652.86	2208.54	2187.19	1067.32	40°06'33.235"N	104°53'17.312"W	0.08	
10843.00	90.150	1.020	7654.08	2348.52	2327.17	1068.89	40°06'34.618"N	104°53'17.292"W	1.07	
10933.00	90.460	0.390	7653.60	2438.52	2417.16	1070.00	40°06'35.508"N	104°53'17.278"W	0.78	
11022.00	88.730	1.110	7654.23	2527.51	2506.15	1071.16	40°06'36.387"N	104°53'17.263"W	2.11	
11112.00	89.010	0.500	7656.01	2617.49	2596.12	1072.43	40°06'37.276"N	104°53'17.246"W	0.75	
11202.00	89.530	0.740	7657.15	2707.48	2686.11	1073.40	40°06'38.165"N	104°53'17.234"W	0.64	
11382.00	90.460	359.910	7657.17	2887.46	2866.10	1074.42	40°06'39.944"N	104°53'17.221"W	0.69	
11561.00	90.760	359.800	7655.26	3066.40	3045.09	1073.97	40°06'41.713"N	104°53'17.226"W	0.18	
11651.00	90.300	358.310	7654.43	3156.33	3135.07	1072.49	40°06'42.602"N	104°53'17.245"W	1.73	
11741.00	89.560	357.420	7654.54	3246.18	3225.01	1069.13	40°06'43.491"N	104°53'17.288"W	1.29	
11831.00	87.560	356.910	7656.80	3335.93	3314.87	1064.68	40°06'44.379"N	104°53'17.346"W	2.29	
12010.00	89.160	359.390	7661.93	3514.58	3493.68	1058.91	40°06'46.146"N	104°53'17.420"W	1.65	
12100.00	89.810	359.090	7662.73	3604.53	3583.67	1057.72	40°06'47.035"N	104°53'17.435"W	0.80	
12190.00	90.180	0.820	7662.74	3694.51	3673.66	1057.65	40°06'47.924"N	104°53'17.436"W	1.97	
12280.00	89.070	1.320	7663.33	3784.50	3763.64	1059.33	40°06'48.814"N	104°53'17.414"W	1.35	
12370.00	87.190	1.070	7666.27	3874.45	3853.57	1061.20	40°06'49.702"N	104°53'17.390"W	2.11	
12459.00	87.010	0.680	7670.77	3963.33	3942.45	1062.56	40°06'50.581"N	104°53'17.373"W	0.48	
12549.00	87.870	0.210	7674.79	4053.24	4032.35	1063.26	40°06'51.469"N	104°53'17.364"W	1.09	
12729.00	90.030	0.230	7678.09	4233.17	4212.31	1063.95	40°06'53.247"N	104°53'17.355"W	1.20	
12821.00	90.300	0.110	7677.82	4325.16	4304.31	1064.22	40°06'54.157"N	104°53'17.351"W	0.32	LAST BHI MWD+IFR SURVEYS
12888.00	90.300	0.110	7677.47	4392.14	4371.31	1064.35	40°06'54.819"N	104°53'17.349"W	0.00	PROJECTION TO BIT

HOLE & CASING SECTIONS - Ref Wellbore: HUNZIKER 1C-28HZ AWB <12888>

Ref Wellpath: HUNZIKER 1C-28HZ AWP

String/Diameter	Start MD [ft]	End MD [ft]	Interval [ft]	Start TVD [ft]	End TVD [ft]	Start N/S [ft]	Start E/W [ft]	End N/S [ft]	End E/W [ft]
13.5in Open Hole	20.00	1333.00	1313.00	20.00	1332.93	0.00	0.00	-0.84	2.06
9.625in Casing Surface	20.00	1323.00	1303.00	20.00	1322.94	0.00	0.00	-0.79	2.07
8.75in Open Hole	1333.00	8135.00	6802.00	1332.93	7707.03	-0.84	2.06	-373.15	901.82
7in Casing Intermediate	20.00	8124.00	8104.00	20.00	7706.48	0.00	0.00	-384.07	900.58
6.125in Open Hole	8135.00	12888.00	4753.00	7707.03	7677.47	-373.15	901.82	4371.31	1064.35

REFERENCE WELLPATH IDENTIFICATION			
Operator	KERR-MCGEE OIL & GAS ONSHORE LP (LAMBERT STATE PLANE COORD)	Slot	SLOT#09 HUNZIKER 1C-28HZ (433'FSL & 1593'FEL, SEC.28)
Area	COLORADO	Well	HUNZIKER 1C-28HZ
Field	WELD COUNTY (KERR MCGEE)	Wellbore	HUNZIKER 1C-28HZ AWB <12888>
Facility	SEC.28-T2N-R67W		

TARGETS								
Name	TVD [ft]	North [ft]	East [ft]	Grid East [US ft]	Grid North [US ft]	Latitude	Longitude	Shape
SEC.04-T1N-R67W SECTION LINES	5069.00	-0.38	45.05	3170131.01	1281033.39	40°06'11.617"N	104°53'30.469"W	polygon
SEC.28-T2N-R67W SECTION LINES	5069.00	-0.38	45.05	3170131.01	1281033.39	40°06'11.617"N	104°53'30.469"W	polygon
SEC.33-T2N-R67W SECTION LINES	5069.00	-0.38	45.05	3170131.01	1281033.39	40°06'11.617"N	104°53'30.469"W	polygon
HUNZIKER 1C-28HZ BHL ON PLAT REV-1 (460'FNL & 510'FEL, SEC.28)	7673.00	4372.66	1096.16	3171152.06	1285413.35	40°06'54.832"N	104°53'16.940"W	point
HUNZIKER 1C-28HZ LANDBOX	7673.00	-0.02	0.02	3170085.97	1281033.44	40°06'11.621"N	104°53'31.049"W	polygon

WELLPATH COMPOSITION - Ref Wellbore: HUNZIKER 1C-28HZ AWB <12888>				Ref Wellpath: HUNZIKER 1C-28HZ AWP		
Start MD [ft]	End MD [ft]	Positional Uncertainty Model		Log Name/Comment		Wellbore
20.00	1290.00	ISCWSA MWD, Rev. 2 (Standard)		CATHEDRAL MWD SURVEYS 13.5" <126-1290>		HUNZIKER 1C-28HZ AWB <12888>
1290.00	8085.00	ISCWSA MWD, Rev. 2, axial magnetic correction (Standard) (MagVAR IFR Wattenberg)		BHI MWD+IFR SURVEYS 8.75" <1376-8085>		HUNZIKER 1C-28HZ AWB <12888>
8085.00	12821.00	ISCWSA MWD, Rev. 2, axial magnetic correction (Standard) (MagVAR IFR Wattenberg)		BHI MWD+IFR SURVEYS 6.125" <8147-12821>		HUNZIKER 1C-28HZ AWB <12888>
12821.00	12888.00	Blind Drilling (std)		Projection to bit		HUNZIKER 1C-28HZ AWB <12888>

REFERENCE WELLPATH IDENTIFICATION			
Operator	KERR-MCGEE OIL & GAS ONSHORE LP (LAMBERT STATE PLANE COORD)	Slot	SLOT#09 HUNZIKER 1C-28HZ (433'FSL & 1593'FEL, SEC.28)
Area	COLORADO	Well	HUNZIKER 1C-28HZ
Field	WELD COUNTY (KERR MCGEE)	Wellbore	HUNZIKER 1C-28HZ AWB <12888>
Facility	SEC.28-T2N-R67W		

WELLPATH COMMENTS				
MD [ft]	Inclination [°]	Azimuth [°]	TVD [ft]	Comment
126.00	0.700	306.600	126.00	BEGIN MWD SURVEYS
1290.00	0.200	210.000	1289.94	TIE-ONTO MWD SURVEYS
1376.00	0.400	176.690	1375.93	BEGIN BHI MWD+IFR SURVEYS
8124.00	86.457	6.102	7706.48	7" CASING POINT
12821.00	90.300	0.110	7677.82	LAST BHI MWD+IFR SURVEYS
12888.00	90.300	0.110	7677.47	PROJECTION TO BIT