

# Calculated by HawkEye Software

<b>Job Number:</b>	<b>Elevation GL: 7133.00 ft</b>
<b>Company: SG Interests</b>	<b>RKB: 20.00 ft</b>
<b>Lease/Well: HL 11-89-19 #2</b>	<b>Projection System: US State Plane 1927 (Exact solution)</b>
<b>Location:</b>	<b>Projection Group: Colorado Central 502</b>
<b>Rig Name:</b>	<b>Projection Datum: CLARKE 1866</b>
<b>State/County: Colorado/ Gunnison</b>	<b>Magnetic Declination: 9.47°</b>
<b>Country:</b>	<b>Grid Convergence: -1.18498 W</b>
	<b>Date: Monday, June 15, 2015</b>

Measured Depth (Ft)	INC Deg	AZM Deg	TVD (Ft)	NS (Ft)	EW (Ft)	VS (Ft)	DLS °/100	Easting (US ft)	Northing (US ft)	Latitude Dec. Deg	Longitude Dec. Deg
.00	.00	.00	.00	.00	.00	.00	.00	1466737.49	462556.62	39.0882933	-107.3788618
1500.00	.00	30.00	1500.00	.00	.00	.00	.00	1466737.49	462556.62	39.0882933	-107.3788618
1530.00	.60	30.00	1530.00	.14	.08	.16	2.00	1466737.57	462556.76	39.0882937	-107.3788615
1560.00	1.20	30.00	1560.00	.54	.31	.63	2.00	1466737.81	462557.16	39.0882948	-107.3788607
1590.00	1.80	30.00	1589.99	1.22	.71	1.41	2.00	1466738.22	462557.83	39.0882967	-107.3788593
1620.00	2.40	30.00	1619.96	2.18	1.26	2.51	2.00	1466738.79	462558.77	39.0882993	-107.3788574
1650.00	3.00	30.00	1649.93	3.40	1.96	3.93	2.00	1466739.52	462559.98	39.0883026	-107.3788549
1680.00	3.60	30.00	1679.88	4.90	2.83	5.65	2.00	1466740.41	462561.46	39.0883067	-107.3788518
1710.00	4.20	30.00	1709.81	6.66	3.85	7.69	2.00	1466741.47	462563.21	39.0883116	-107.3788482
1740.00	4.80	30.00	1739.72	8.70	5.02	10.05	2.00	1466742.69	462565.22	39.0883172	-107.3788441
1770.00	5.40	30.00	1769.60	11.01	6.36	12.71	2.00	1466744.07	462567.50	39.0883235	-107.3788394
1800.00	6.00	30.00	1799.45	13.59	7.85	15.69	2.00	1466745.61	462570.05	39.0883306	-107.3788342
1830.00	6.60	30.00	1829.27	16.44	9.49	18.99	2.00	1466747.32	462572.87	39.0883384	-107.3788284
1860.00	7.20	30.00	1859.05	19.56	11.29	22.59	2.00	1466749.18	462575.95	39.0883470	-107.3788220
1890.00	7.80	30.00	1888.80	22.95	13.25	26.51	2.00	1466751.21	462579.30	39.0883563	-107.3788151
1920.00	8.40	30.00	1918.50	26.62	15.37	30.73	2.00	1466753.40	462582.92	39.0883664	-107.3788077
1950.00	9.00	30.00	1948.15	30.55	17.64	35.27	2.00	1466755.75	462586.80	39.0883772	-107.3787997
1980.00	9.60	30.00	1977.76	34.74	20.06	40.12	2.00	1466758.26	462590.95	39.0883887	-107.3787911
2010.00	10.20	30.00	2007.31	39.21	22.64	45.28	2.00	1466760.93	462595.36	39.0884010	-107.3787820
2040.00	10.80	30.00	2036.81	43.95	25.37	50.74	2.00	1466763.76	462600.04	39.0884140	-107.3787724
2070.00	11.40	30.00	2066.25	48.95	28.26	56.52	2.00	1466766.75	462604.98	39.0884277	-107.3787622
2100.00	12.00	30.00	2095.62	54.22	31.30	62.60	2.00	1466769.90	462610.18	39.0884422	-107.3787515
2130.00	12.60	30.00	2124.93	59.75	34.50	68.99	2.00	1466773.21	462615.65	39.0884574	-107.3787403
2160.00	13.20	30.00	2154.18	65.55	37.85	75.69	2.00	1466776.68	462621.38	39.0884733	-107.3787285
2190.00	13.80	30.00	2183.35	71.62	41.35	82.69	2.00	1466780.30	462627.37	39.0884899	-107.3787161
2220.00	14.40	30.00	2212.44	77.94	45.00	90.00	2.00	1466784.09	462633.62	39.0885073	-107.3787033
2250.00	15.00	30.00	2241.46	84.54	48.81	97.62	2.00	1466788.03	462640.14	39.0885254	-107.3786898
2280.00	15.60	30.00	2270.40	91.39	52.77	105.53	2.00	1466792.13	462646.91	39.0885442	-107.3786759
2310.00	16.20	30.00	2299.25	98.51	56.87	113.75	2.00	1466796.39	462653.94	39.0885638	-107.3786614
2340.00	16.80	30.00	2328.02	105.89	61.13	122.27	2.00	1466800.80	462661.23	39.0885840	-107.3786464
2370.00	17.40	30.00	2356.69	113.53	65.55	131.09	2.00	1466805.36	462668.77	39.0886050	-107.3786309
2400.00	18.00	30.00	2385.27	121.43	70.11	140.21	2.00	1466810.09	462676.58	39.0886267	-107.3786148
2430.00	18.60	30.00	2413.75	129.59	74.82	149.63	2.00	1466814.97	462684.64	39.0886491	-107.3785982
2460.00	19.20	30.00	2442.13	138.00	79.67	159.35	2.00	1466820.00	462692.95	39.0886722	-107.3785811
2490.00	19.80	30.00	2470.41	146.67	84.68	169.36	2.00	1466825.18	462701.52	39.0886960	-107.3785635
2495.42	19.91	30.00	2475.51	148.27	85.60	171.20	2.00	1466826.13	462703.09	39.0887004	-107.3785602
3939.19	19.91	30.00	3833.00	574.03	331.41	662.83	.00	1467080.70	463123.68	39.0898694	-107.3776942



Job Number:  
Company: SG Interests  
Lease/Well: HL 11-89-19 #2  
Location:  
Rig Name:  
State/Country: Colorado/ Gunnison  
Country:  
API Number:

Elevation (To MSL): 7133.00 ft  
RKB: 20.00 ft  
Projection System: US State Plane 1927 (Exact solution)  
Projection Group: Colorado Central 502  
Projection Datum: CLARKE 1866  
Magnetic Declination: 9.47  
Grid Convergence: -1.18498 W  
Date: Wednesday, June 17, 2015

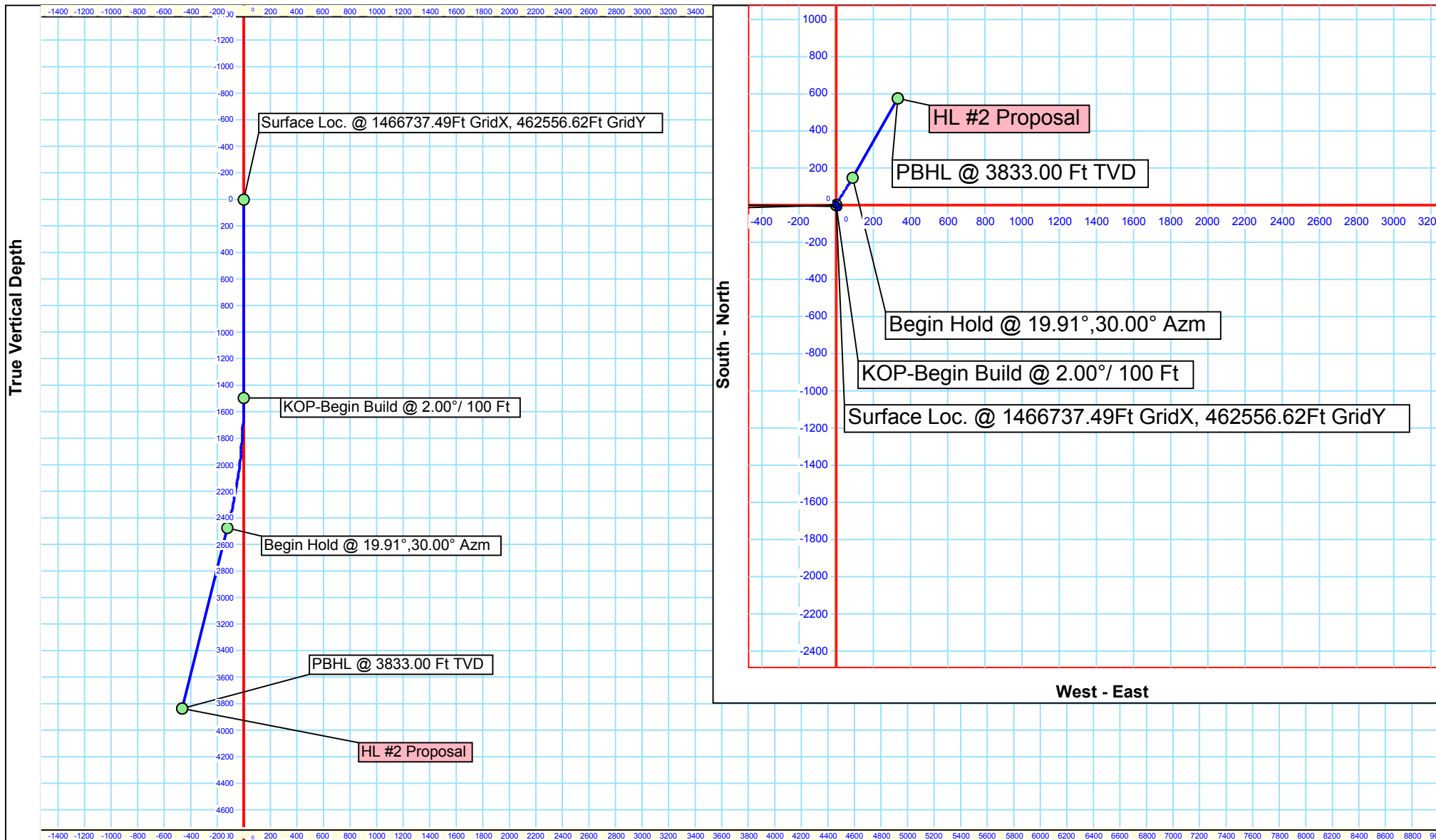
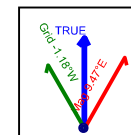

Vertical Section (200 Ft/Div) VSP: 164.76°