

Bayswater Exploration & Production, LLC

Well Name: **Carlson I-15-16HN**

Surface Location: Carlson 15-D Pad Sec.15-T5N-R65W
North American Datum 1983 , US State Plane 1983 , Colorado Northern Zone
Ground Elevation: 4621.0
+N/-S +E/-W Northing Easting Latitude Longitude Slot
0.0 0.0 1391065.23 3239157.05 40.403697 -104.641239
RKB - 22.5' WELL @ 4643.5ft (RKB - 22.5')

WELLBORE TARGET DETAILS

Name	TVD	+N/-S	+E/-W	Shape
SHL 1055'FNL, 354'FEL, SEC.15	1.0	0.0	0.0	Point
BHL 1900'FNL, 2338'FWL, SEC.16	6878.5	-888.7	-7877.3	Point

Carlson 15-D Pad Sec.15-T5N-R65W
Carlson I-15-16HN
Plan #2 (6-18-15)
12:10, June 18 2015

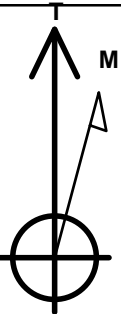

Azimuths to True North
Magnetic North: 8.26°
Magnetic Field
Strength: 52725.3nT
Dip Angle: 66.93°
Date: 6/18/2015
Model: IGRF2010

ANNOTATIONS

TVD	MD	Annotation
800.0	800.0	KOP - Start Build 1.50
999.9	1000.0	Start DLS 1.50 TFO -27.29
5444.7	5524.7	Start Drop -2.00
6162.3	6245.8	Start Build 8.00
6878.5	7370.8	Start 7465.2 hold at 7370.8 MD
6878.5	14836.0	TD at 14836.0

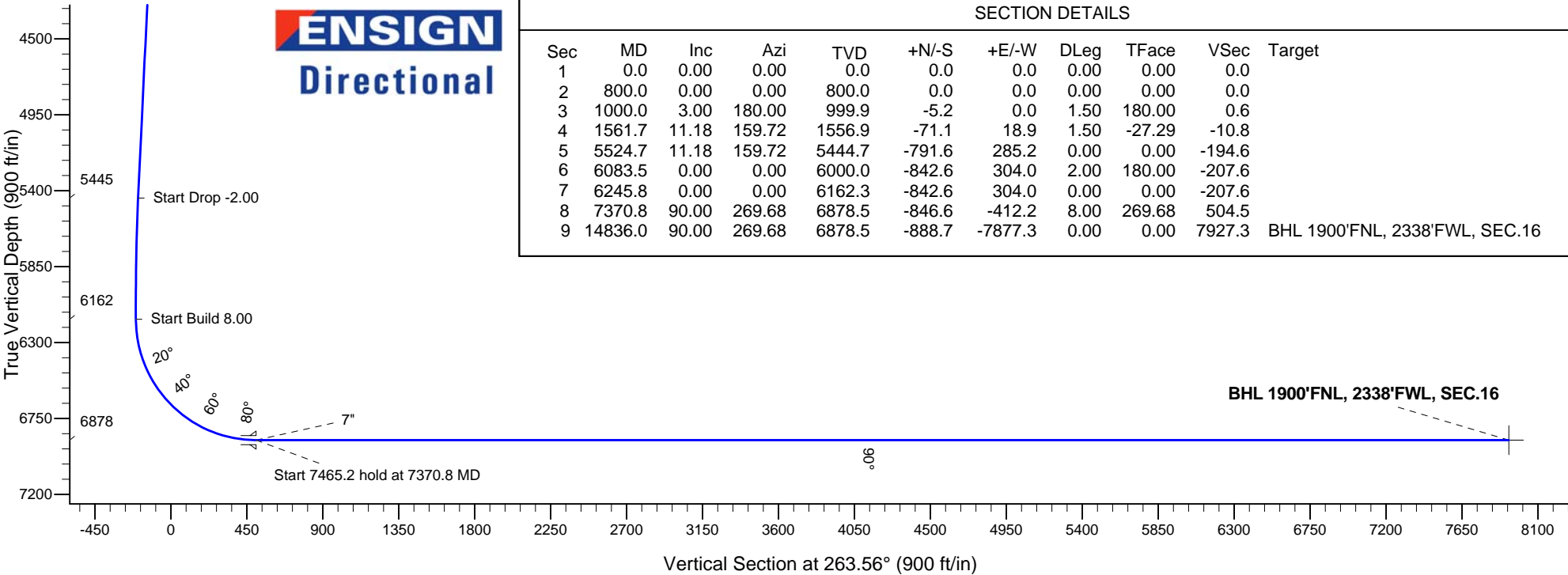
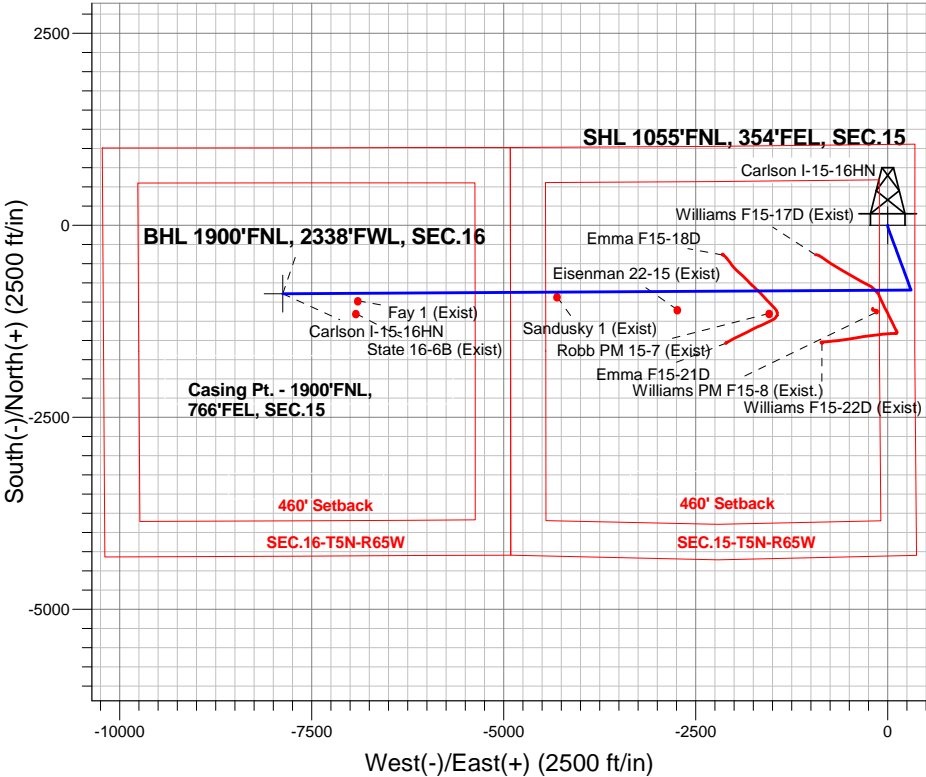



Bayswater Exploration & Production, LLC

SEC.15-T5N-R65W

Carlson 15-D Pad Sec.15-T5N-R65W

Carlson I-15-16HN

Wellbore #1

Plan: Plan #2 (6-18-15)

Standard Planning Report

18 June, 2015



BAYSWATER
EXPLORATION & PRODUCTION, LLC

Database:	EDMNEW	Local Co-ordinate Reference:	Well Carlson I-15-16HN
Company:	Bayswater Exploration & Production, LLC	TVD Reference:	WELL @ 4643.5ft (RKB - 22.5')
Project:	SEC.15-T5N-R65W	MD Reference:	WELL @ 4643.5ft (RKB - 22.5')
Site:	Carlson 15-D Pad Sec.15-T5N-R65W	North Reference:	True
Well:	Carlson I-15-16HN	Survey Calculation Method:	Minimum Curvature
Wellbore:	Wellbore #1		
Design:	Plan #2 (6-18-15)		

Project	SEC.15-T5N-R65W, Weld County, Colorado		
Map System:	US State Plane 1983	System Datum:	Mean Sea Level
Geo Datum:	North American Datum 1983		Using Well Reference Point
Map Zone:	Colorado Northern Zone		Using geodetic scale factor

Site		Carlson 15-D Pad Sec.15-T5N-R65W			
Site Position:		Northing:	1,391,065.32 ft	Latitude:	40.403694
From:	Lat/Long	Easting:	3,239,277.09 ft	Longitude:	-104.640808
Position Uncertainty:	0.0 ft	Slot Radius:	"	Grid Convergence:	0.56 °

Well		Carlson I-15-16HN				
Well Position	+N-S	1.1 ft	Northing:	1,391,065.23 ft	Latitude:	40.403697
	+E-W	-120.0 ft	Easting:	3,239,157.05 ft	Longitude:	-104.641239
Position Uncertainty		0.0 ft	Wellhead Elevation:	ft	Ground Level:	4,621.0 ft

Wellbore	Wellbore #1				
Magnetics	Model Name	Sample Date	Declination (°)	Dip Angle (°)	Field Strength (nT)
	IGRF2010	6/18/2015	8.26	66.93	52,725

Design	Plan #2 (6-18-15)			
Audit Notes:				
Version:	Phase:	PROTOTYPE	Tie On Depth:	0.0
Vertical Section:	Depth From (TVD) (ft)	+N/-S (ft)	+E/-W (ft)	Direction (°)
	0.0	0.0	0.0	263.56

Plan Sections										
Measured Depth (ft)	Inclination (°)	Azimuth (°)	Vertical Depth (ft)	+N/-S (ft)	+E/-W (ft)	Dogleg Rate (°/100ft)	Build Rate (°/100ft)	Turn Rate (°/100ft)	TFO (°)	Target
0.0	0.00	0.00	0.0	0.0	0.0	0.00	0.00	0.00	0.00	
800.0	0.00	0.00	800.0	0.0	0.0	0.00	0.00	0.00	0.00	
1,000.0	3.00	180.00	999.9	-5.2	0.0	1.50	1.50	0.00	180.00	
1,561.7	11.18	159.72	1,556.9	-71.1	18.9	1.50	1.46	-3.61	-27.29	
5,524.7	11.18	159.72	5,444.7	-791.6	285.2	0.00	0.00	0.00	0.00	
6,083.5	0.00	0.00	6,000.0	-842.6	304.0	2.00	-2.00	0.00	180.00	
6,245.8	0.00	0.00	6,162.3	-842.6	304.0	0.00	0.00	0.00	0.00	
7,370.8	90.00	269.68	6,878.5	-846.6	-412.2	8.00	8.00	0.00	269.68	
14,836.0	90.00	269.68	6,878.5	-888.7	-7,877.3	0.00	0.00	0.00	0.00	BHL 1900'FNL, 233

Database:	EDMNEW	Local Co-ordinate Reference:	Well Carlson I-15-16HN
Company:	Bayswater Exploration & Production, LLC	TVD Reference:	WELL @ 4643.5ft (RKB - 22.5')
Project:	SEC.15-T5N-R65W	MD Reference:	WELL @ 4643.5ft (RKB - 22.5')
Site:	Carlson 15-D Pad Sec.15-T5N-R65W	North Reference:	True
Well:	Carlson I-15-16HN	Survey Calculation Method:	Minimum Curvature
Wellbore:	Wellbore #1		
Design:	Plan #2 (6-18-15)		

Planned Survey									
Measured Depth (ft)	Inclination (°)	Azimuth (°)	Vertical Depth (ft)	+N/-S (ft)	+E/-W (ft)	Vertical Section (ft)	Dogleg Rate (°/100ft)	Build Rate (°/100ft)	Turn Rate (°/100ft)
0.0	0.00	0.00	0.0	0.0	0.0	0.0	0.00	0.00	0.00
100.0	0.00	0.00	100.0	0.0	0.0	0.0	0.00	0.00	0.00
200.0	0.00	0.00	200.0	0.0	0.0	0.0	0.00	0.00	0.00
300.0	0.00	0.00	300.0	0.0	0.0	0.0	0.00	0.00	0.00
400.0	0.00	0.00	400.0	0.0	0.0	0.0	0.00	0.00	0.00
500.0	0.00	0.00	500.0	0.0	0.0	0.0	0.00	0.00	0.00
600.0	0.00	0.00	600.0	0.0	0.0	0.0	0.00	0.00	0.00
700.0	0.00	0.00	700.0	0.0	0.0	0.0	0.00	0.00	0.00
800.0	0.00	0.00	800.0	0.0	0.0	0.0	0.00	0.00	0.00
KOP - Start Build 1.50									
900.0	1.50	180.00	900.0	-1.3	0.0	0.1	1.50	1.50	0.00
1,000.0	3.00	180.00	999.9	-5.2	0.0	0.6	1.50	1.50	0.00
Start DLS 1.50 TFO -27.29									
1,100.0	4.39	170.97	1,099.7	-11.6	0.6	0.7	1.50	1.39	-9.03
1,200.0	5.83	166.34	1,199.3	-20.3	2.4	-0.1	1.50	1.44	-4.64
1,300.0	7.30	163.55	1,298.6	-31.4	5.4	-1.8	1.50	1.47	-2.79
1,400.0	8.77	161.69	1,397.7	-44.7	9.6	-4.5	1.50	1.48	-1.86
1,500.0	10.26	160.36	1,496.3	-60.3	15.0	-8.1	1.50	1.48	-1.33
1,561.7	11.18	159.72	1,556.9	-71.1	18.9	-10.8	1.50	1.49	-1.04
1,600.0	11.18	159.72	1,594.5	-78.1	21.5	-12.6	0.00	0.00	0.00
1,700.0	11.18	159.72	1,692.6	-96.3	28.2	-17.2	0.00	0.00	0.00
1,800.0	11.18	159.72	1,790.7	-114.4	34.9	-21.9	0.00	0.00	0.00
1,900.0	11.18	159.72	1,888.8	-132.6	41.6	-26.5	0.00	0.00	0.00
2,000.0	11.18	159.72	1,986.9	-150.8	48.4	-31.1	0.00	0.00	0.00
2,100.0	11.18	159.72	2,085.0	-169.0	55.1	-35.8	0.00	0.00	0.00
2,200.0	11.18	159.72	2,183.1	-187.2	61.8	-40.4	0.00	0.00	0.00
2,300.0	11.18	159.72	2,281.2	-205.3	68.5	-45.1	0.00	0.00	0.00
2,400.0	11.18	159.72	2,379.3	-223.5	75.2	-49.7	0.00	0.00	0.00
2,500.0	11.18	159.72	2,477.4	-241.7	81.9	-54.3	0.00	0.00	0.00
2,600.0	11.18	159.72	2,575.5	-259.9	88.7	-59.0	0.00	0.00	0.00
2,700.0	11.18	159.72	2,673.6	-278.1	95.4	-63.6	0.00	0.00	0.00
2,800.0	11.18	159.72	2,771.7	-296.3	102.1	-68.2	0.00	0.00	0.00
2,900.0	11.18	159.72	2,869.8	-314.4	108.8	-72.9	0.00	0.00	0.00
3,000.0	11.18	159.72	2,967.9	-332.6	115.5	-77.5	0.00	0.00	0.00
3,100.0	11.18	159.72	3,066.0	-350.8	122.3	-82.2	0.00	0.00	0.00
3,200.0	11.18	159.72	3,164.1	-369.0	129.0	-86.8	0.00	0.00	0.00
3,300.0	11.18	159.72	3,262.2	-387.2	135.7	-91.4	0.00	0.00	0.00
3,400.0	11.18	159.72	3,360.3	-405.3	142.4	-96.1	0.00	0.00	0.00
3,500.0	11.18	159.72	3,458.4	-423.5	149.1	-100.7	0.00	0.00	0.00
3,600.0	11.18	159.72	3,556.5	-441.7	155.9	-105.3	0.00	0.00	0.00
3,700.0	11.18	159.72	3,654.6	-459.9	162.6	-110.0	0.00	0.00	0.00
3,800.0	11.18	159.72	3,752.8	-478.1	169.3	-114.6	0.00	0.00	0.00
3,900.0	11.18	159.72	3,850.9	-496.2	176.0	-119.3	0.00	0.00	0.00
4,000.0	11.18	159.72	3,949.0	-514.4	182.7	-123.9	0.00	0.00	0.00
4,100.0	11.18	159.72	4,047.1	-532.6	189.4	-128.5	0.00	0.00	0.00
4,200.0	11.18	159.72	4,145.2	-550.8	196.2	-133.2	0.00	0.00	0.00
4,300.0	11.18	159.72	4,243.3	-569.0	202.9	-137.8	0.00	0.00	0.00
4,400.0	11.18	159.72	4,341.4	-587.2	209.6	-142.5	0.00	0.00	0.00
4,500.0	11.18	159.72	4,439.5	-605.3	216.3	-147.1	0.00	0.00	0.00
4,600.0	11.18	159.72	4,537.6	-623.5	223.0	-151.7	0.00	0.00	0.00
4,700.0	11.18	159.72	4,635.7	-641.7	229.8	-156.4	0.00	0.00	0.00
4,800.0	11.18	159.72	4,733.8	-659.9	236.5	-161.0	0.00	0.00	0.00
4,900.0	11.18	159.72	4,831.9	-678.1	243.2	-165.6	0.00	0.00	0.00
5,000.0	11.18	159.72	4,930.0	-696.2	249.9	-170.3	0.00	0.00	0.00

Database:	EDMNEW	Local Co-ordinate Reference:	Well Carlson I-15-16HN
Company:	Bayswater Exploration & Production, LLC	TVD Reference:	WELL @ 4643.5ft (RKB - 22.5')
Project:	SEC.15-T5N-R65W	MD Reference:	WELL @ 4643.5ft (RKB - 22.5')
Site:	Carlson 15-D Pad Sec.15-T5N-R65W	North Reference:	True
Well:	Carlson I-15-16HN	Survey Calculation Method:	Minimum Curvature
Wellbore:	Wellbore #1		
Design:	Plan #2 (6-18-15)		

Planned Survey									
Measured Depth (ft)	Inclination (°)	Azimuth (°)	Vertical Depth (ft)	+N/-S (ft)	+E/-W (ft)	Vertical Section (ft)	Dogleg Rate (°/100ft)	Build Rate (°/100ft)	Turn Rate (°/100ft)
5,100.0	11.18	159.72	5,028.1	-714.4	256.6	-174.9	0.00	0.00	0.00
5,200.0	11.18	159.72	5,126.2	-732.6	263.4	-179.6	0.00	0.00	0.00
5,300.0	11.18	159.72	5,224.3	-750.8	270.1	-184.2	0.00	0.00	0.00
5,400.0	11.18	159.72	5,322.4	-769.0	276.8	-188.8	0.00	0.00	0.00
5,500.0	11.18	159.72	5,420.5	-787.2	283.5	-193.5	0.00	0.00	0.00
5,524.7	11.18	159.72	5,444.7	-791.6	285.2	-194.6	0.00	0.00	0.00
Start Drop -2.00									
5,600.0	9.67	159.72	5,518.8	-804.4	289.9	-197.9	2.00	-2.00	0.00
5,700.0	7.67	159.72	5,617.7	-818.6	295.1	-201.5	2.00	-2.00	0.00
5,800.0	5.67	159.72	5,717.0	-829.5	299.1	-204.3	2.00	-2.00	0.00
5,900.0	3.67	159.72	5,816.6	-837.1	302.0	-206.2	2.00	-2.00	0.00
6,000.0	1.67	159.72	5,916.5	-841.5	303.6	-207.3	2.00	-2.00	0.00
6,083.5	0.00	0.00	6,000.0	-842.6	304.0	-207.6	2.00	-2.00	0.00
6,100.0	0.00	0.00	6,016.5	-842.6	304.0	-207.6	0.00	0.00	0.00
6,200.0	0.00	0.00	6,116.5	-842.6	304.0	-207.6	0.00	0.00	0.00
6,245.8	0.00	0.00	6,162.3	-842.6	304.0	-207.6	0.00	0.00	0.00
Start Build 8.00									
6,300.0	4.34	269.68	6,216.5	-842.6	301.9	-205.6	8.00	8.00	0.00
6,400.0	12.34	269.68	6,315.3	-842.7	287.5	-191.2	8.00	8.00	0.00
6,500.0	20.34	269.68	6,411.2	-842.9	259.4	-163.2	8.00	8.00	0.00
6,600.0	28.34	269.68	6,502.2	-843.1	218.2	-122.3	8.00	8.00	0.00
6,700.0	36.34	269.68	6,586.7	-843.4	164.7	-69.1	8.00	8.00	0.00
6,800.0	44.34	269.68	6,662.8	-843.8	100.1	-4.8	8.00	8.00	0.00
6,900.0	52.34	269.68	6,729.3	-844.2	25.4	69.4	8.00	8.00	0.00
7,000.0	60.34	269.68	6,784.6	-844.6	-57.7	152.1	8.00	8.00	0.00
7,100.0	68.34	269.68	6,827.9	-845.1	-147.8	241.6	8.00	8.00	0.00
7,200.0	76.34	269.68	6,858.2	-845.7	-243.0	336.3	8.00	8.00	0.00
7,300.0	84.34	269.68	6,875.0	-846.2	-341.5	434.2	8.00	8.00	0.00
7,370.8	90.00	269.68	6,878.5	-846.6	-412.2	504.5	8.00	8.00	0.00
Start 7465.2 hold at 7370.8 MD - 7"									
7,400.0	90.00	269.68	6,878.5	-846.8	-441.4	533.5	0.00	0.00	0.00
7,500.0	90.00	269.68	6,878.5	-847.4	-541.4	633.0	0.00	0.00	0.00
7,600.0	90.00	269.68	6,878.5	-847.9	-641.4	732.4	0.00	0.00	0.00
7,700.0	90.00	269.68	6,878.5	-848.5	-741.4	831.8	0.00	0.00	0.00
7,800.0	90.00	269.68	6,878.5	-849.1	-841.4	931.3	0.00	0.00	0.00
7,900.0	90.00	269.68	6,878.5	-849.6	-941.4	1,030.7	0.00	0.00	0.00
8,000.0	90.00	269.68	6,878.5	-850.2	-1,041.4	1,130.1	0.00	0.00	0.00
8,100.0	90.00	269.68	6,878.5	-850.8	-1,141.4	1,229.6	0.00	0.00	0.00
8,200.0	90.00	269.68	6,878.5	-851.3	-1,241.4	1,329.0	0.00	0.00	0.00
8,300.0	90.00	269.68	6,878.5	-851.9	-1,341.4	1,428.4	0.00	0.00	0.00
8,400.0	90.00	269.68	6,878.5	-852.4	-1,441.4	1,527.9	0.00	0.00	0.00
8,500.0	90.00	269.68	6,878.5	-853.0	-1,541.4	1,627.3	0.00	0.00	0.00
8,600.0	90.00	269.68	6,878.5	-853.6	-1,641.4	1,726.7	0.00	0.00	0.00
8,700.0	90.00	269.68	6,878.5	-854.1	-1,741.4	1,826.1	0.00	0.00	0.00
8,800.0	90.00	269.68	6,878.5	-854.7	-1,841.4	1,925.6	0.00	0.00	0.00
8,900.0	90.00	269.68	6,878.5	-855.3	-1,941.4	2,025.0	0.00	0.00	0.00
9,000.0	90.00	269.68	6,878.5	-855.8	-2,041.4	2,124.4	0.00	0.00	0.00
9,100.0	90.00	269.68	6,878.5	-856.4	-2,141.4	2,223.9	0.00	0.00	0.00
9,200.0	90.00	269.68	6,878.5	-857.0	-2,241.4	2,323.3	0.00	0.00	0.00
9,300.0	90.00	269.68	6,878.5	-857.5	-2,341.4	2,422.7	0.00	0.00	0.00
9,400.0	90.00	269.68	6,878.5	-858.1	-2,441.4	2,522.2	0.00	0.00	0.00
9,500.0	90.00	269.68	6,878.5	-858.6	-2,541.4	2,621.6	0.00	0.00	0.00
9,600.0	90.00	269.68	6,878.5	-859.2	-2,641.4	2,721.0	0.00	0.00	0.00

Database:	EDMNEW	Local Co-ordinate Reference:	Well Carlson I-15-16HN
Company:	Bayswater Exploration & Production, LLC	TVD Reference:	WELL @ 4643.5ft (RKB - 22.5')
Project:	SEC.15-T5N-R65W	MD Reference:	WELL @ 4643.5ft (RKB - 22.5')
Site:	Carlson 15-D Pad Sec.15-T5N-R65W	North Reference:	True
Well:	Carlson I-15-16HN	Survey Calculation Method:	Minimum Curvature
Wellbore:	Wellbore #1		
Design:	Plan #2 (6-18-15)		

Planned Survey										
Measured Depth (ft)	Inclination (°)	Azimuth (°)	Vertical Depth (ft)	+N/-S (ft)	+E/-W (ft)	Vertical Section (ft)	Dogleg Rate (°/100ft)	Build Rate (°/100ft)	Turn Rate (°/100ft)	
9,700.0	90.00	269.68	6,878.5	-859.8	-2,741.4	2,820.5	0.00	0.00	0.00	
9,800.0	90.00	269.68	6,878.5	-860.3	-2,841.4	2,919.9	0.00	0.00	0.00	
9,900.0	90.00	269.68	6,878.5	-860.9	-2,941.3	3,019.3	0.00	0.00	0.00	
10,000.0	90.00	269.68	6,878.5	-861.5	-3,041.3	3,118.8	0.00	0.00	0.00	
10,100.0	90.00	269.68	6,878.5	-862.0	-3,141.3	3,218.2	0.00	0.00	0.00	
10,200.0	90.00	269.68	6,878.5	-862.6	-3,241.3	3,317.6	0.00	0.00	0.00	
10,300.0	90.00	269.68	6,878.5	-863.2	-3,341.3	3,417.0	0.00	0.00	0.00	
10,400.0	90.00	269.68	6,878.5	-863.7	-3,441.3	3,516.5	0.00	0.00	0.00	
10,500.0	90.00	269.68	6,878.5	-864.3	-3,541.3	3,615.9	0.00	0.00	0.00	
10,600.0	90.00	269.68	6,878.5	-864.8	-3,641.3	3,715.3	0.00	0.00	0.00	
10,700.0	90.00	269.68	6,878.5	-865.4	-3,741.3	3,814.8	0.00	0.00	0.00	
10,800.0	90.00	269.68	6,878.5	-866.0	-3,841.3	3,914.2	0.00	0.00	0.00	
10,900.0	90.00	269.68	6,878.5	-866.5	-3,941.3	4,013.6	0.00	0.00	0.00	
11,000.0	90.00	269.68	6,878.5	-867.1	-4,041.3	4,113.1	0.00	0.00	0.00	
11,100.0	90.00	269.68	6,878.5	-867.7	-4,141.3	4,212.5	0.00	0.00	0.00	
11,200.0	90.00	269.68	6,878.5	-868.2	-4,241.3	4,311.9	0.00	0.00	0.00	
11,300.0	90.00	269.68	6,878.5	-868.8	-4,341.3	4,411.4	0.00	0.00	0.00	
11,400.0	90.00	269.68	6,878.5	-869.4	-4,441.3	4,510.8	0.00	0.00	0.00	
11,500.0	90.00	269.68	6,878.5	-869.9	-4,541.3	4,610.2	0.00	0.00	0.00	
11,600.0	90.00	269.68	6,878.5	-870.5	-4,641.3	4,709.7	0.00	0.00	0.00	
11,700.0	90.00	269.68	6,878.5	-871.1	-4,741.3	4,809.1	0.00	0.00	0.00	
11,800.0	90.00	269.68	6,878.5	-871.6	-4,841.3	4,908.5	0.00	0.00	0.00	
11,900.0	90.00	269.68	6,878.5	-872.2	-4,941.3	5,007.9	0.00	0.00	0.00	
12,000.0	90.00	269.68	6,878.5	-872.7	-5,041.3	5,107.4	0.00	0.00	0.00	
12,100.0	90.00	269.68	6,878.5	-873.3	-5,141.3	5,206.8	0.00	0.00	0.00	
12,200.0	90.00	269.68	6,878.5	-873.9	-5,241.3	5,306.2	0.00	0.00	0.00	
12,300.0	90.00	269.68	6,878.5	-874.4	-5,341.3	5,405.7	0.00	0.00	0.00	
12,400.0	90.00	269.68	6,878.5	-875.0	-5,441.3	5,505.1	0.00	0.00	0.00	
12,500.0	90.00	269.68	6,878.5	-875.6	-5,541.3	5,604.5	0.00	0.00	0.00	
12,600.0	90.00	269.68	6,878.5	-876.1	-5,641.3	5,704.0	0.00	0.00	0.00	
12,700.0	90.00	269.68	6,878.5	-876.7	-5,741.3	5,803.4	0.00	0.00	0.00	
12,800.0	90.00	269.68	6,878.5	-877.3	-5,841.3	5,902.8	0.00	0.00	0.00	
12,900.0	90.00	269.68	6,878.5	-877.8	-5,941.3	6,002.3	0.00	0.00	0.00	
13,000.0	90.00	269.68	6,878.5	-878.4	-6,041.3	6,101.7	0.00	0.00	0.00	
13,100.0	90.00	269.68	6,878.5	-878.9	-6,141.3	6,201.1	0.00	0.00	0.00	
13,200.0	90.00	269.68	6,878.5	-879.5	-6,241.3	6,300.6	0.00	0.00	0.00	
13,300.0	90.00	269.68	6,878.5	-880.1	-6,341.3	6,400.0	0.00	0.00	0.00	
13,400.0	90.00	269.68	6,878.5	-880.6	-6,441.3	6,499.4	0.00	0.00	0.00	
13,500.0	90.00	269.68	6,878.5	-881.2	-6,541.3	6,598.8	0.00	0.00	0.00	
13,600.0	90.00	269.68	6,878.5	-881.8	-6,641.3	6,698.3	0.00	0.00	0.00	
13,700.0	90.00	269.68	6,878.5	-882.3	-6,741.3	6,797.7	0.00	0.00	0.00	
13,800.0	90.00	269.68	6,878.5	-882.9	-6,841.3	6,897.1	0.00	0.00	0.00	
13,900.0	90.00	269.68	6,878.5	-883.5	-6,941.3	6,996.6	0.00	0.00	0.00	
14,000.0	90.00	269.68	6,878.5	-884.0	-7,041.3	7,096.0	0.00	0.00	0.00	
14,100.0	90.00	269.68	6,878.5	-884.6	-7,141.3	7,195.4	0.00	0.00	0.00	
14,200.0	90.00	269.68	6,878.5	-885.2	-7,241.3	7,294.9	0.00	0.00	0.00	
14,300.0	90.00	269.68	6,878.5	-885.7	-7,341.3	7,394.3	0.00	0.00	0.00	
14,400.0	90.00	269.68	6,878.5	-886.3	-7,441.3	7,493.7	0.00	0.00	0.00	
14,500.0	90.00	269.68	6,878.5	-886.8	-7,541.3	7,593.2	0.00	0.00	0.00	
14,600.0	90.00	269.68	6,878.5	-887.4	-7,641.3	7,692.6	0.00	0.00	0.00	
14,700.0	90.00	269.68	6,878.5	-888.0	-7,741.3	7,792.0	0.00	0.00	0.00	
14,800.0	90.00	269.68	6,878.5	-888.5	-7,841.3	7,891.5	0.00	0.00	0.00	
14,836.0	90.00	269.68	6,878.5	-888.7	-7,877.3	7,927.2	0.00	0.00	0.00	
TD at 14836.0										

Database:	EDMNEW	Local Co-ordinate Reference:	Well Carlson I-15-16HN
Company:	Bayswater Exploration & Production, LLC	TVD Reference:	WELL @ 4643.5ft (RKB - 22.5')
Project:	SEC.15-T5N-R65W	MD Reference:	WELL @ 4643.5ft (RKB - 22.5')
Site:	Carlson 15-D Pad Sec.15-T5N-R65W	North Reference:	True
Well:	Carlson I-15-16HN	Survey Calculation Method:	Minimum Curvature
Wellbore:	Wellbore #1		
Design:	Plan #2 (6-18-15)		

Planned Survey									
Measured Depth (ft)	Inclination (°)	Azimuth (°)	Vertical Depth (ft)	+N/-S (ft)	+E/-W (ft)	Vertical Section (ft)	Dogleg Rate (°/100ft)	Build Rate (°/100ft)	Turn Rate (°/100ft)

Targets									
Target Name	Dip Angle (°)	Dip Dir. (°)	TVD (ft)	+N/-S (ft)	+E/-W (ft)	Northing (ft)	Easting (ft)	Latitude	Longitude
- hit/miss target									
- Shape									
SHL 1055'FNL, 354'FI	0.00	0.00	1.0	0.0	0.0	1,391,065.25	3,239,157.05	40.403697	-104.641239
- plan hits target center									
- Point									
BHL 1900'FNL, 2338'I	0.00	0.00	6,878.5	-888.7	-7,877.3	1,390,100.29	3,231,289.06	40.401254	-104.669522
- plan hits target center									
- Point									

Casing Points					
Measured Depth (ft)	Vertical Depth (ft)	Name	Casing Diameter (")	Hole Diameter (")	
7,370.8	6,878.5	7"	7	7-1/2	

Plan Annotations				
Measured Depth (ft)	Vertical Depth (ft)	Local Coordinates		Comment
		+N/-S (ft)	+E/-W (ft)	
800.0	800.0	0.0	0.0	KOP - Start Build 1.50
1,000.0	999.9	-5.2	0.0	Start DLS 1.50 TFO -27.29
5,524.7	5,444.7	-791.6	285.2	Start Drop -2.00
6,245.8	6,162.3	-842.6	304.0	Start Build 8.00
7,370.8	6,878.5	-846.6	-412.2	Start 7465.2 hold at 7370.8 MD
14,836.0	6,878.5	-888.7	-7,877.3	TD at 14836.0