

Hydrology Map

JOHNSON TRUST 13-I PAD

MULTI WELL PAD

NW1/4 SW1/4 SECTION 13, TOWNSHIP 2 NORTH, RANGE 68 WEST OF THE 6TH PRINCIPAL MERIDIAN

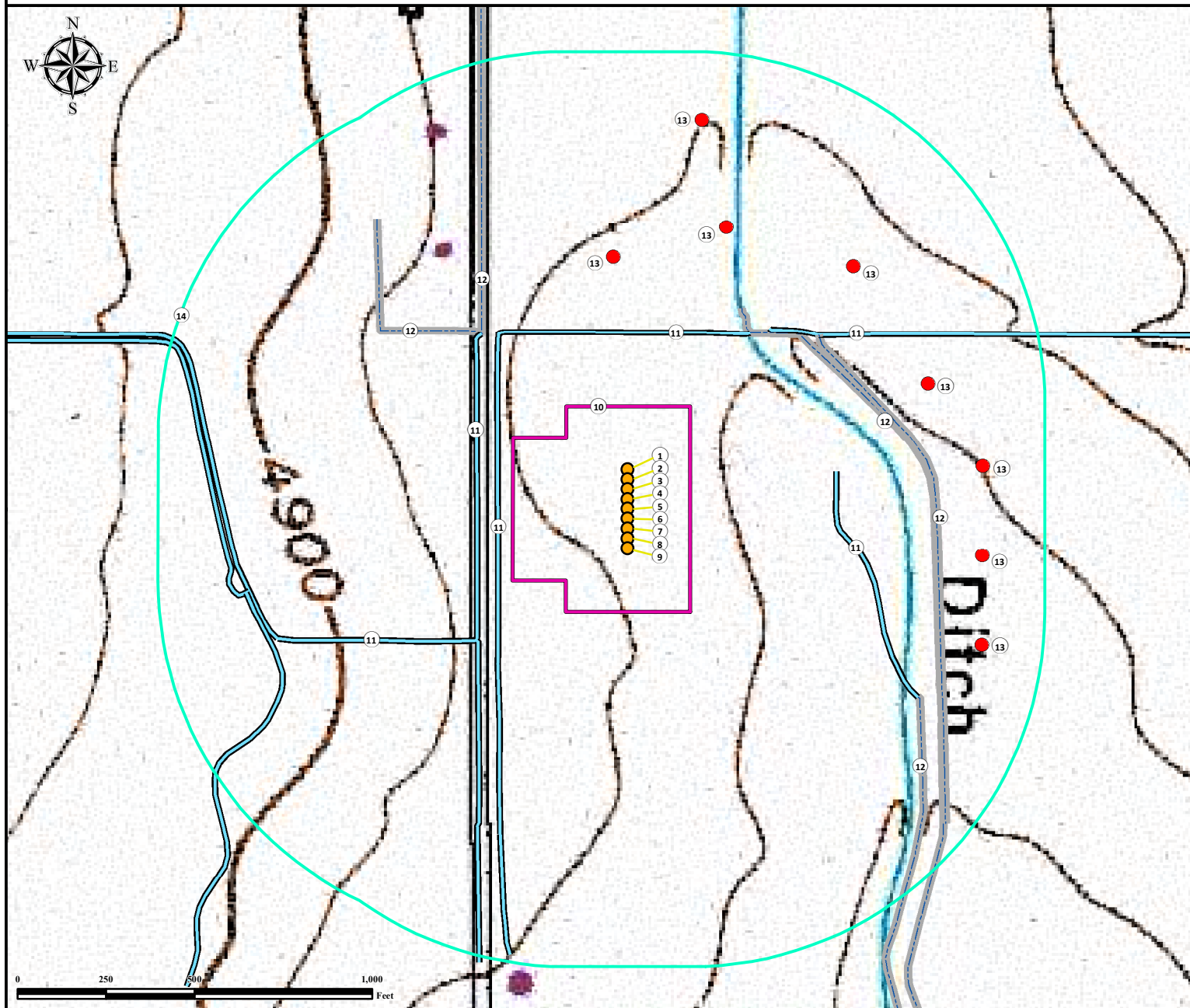

1. Proposed Well JOHNSON TRUST 1.
2. Proposed Well JOHNSON TRUST 2.
3. Proposed Well JOHNSON TRUST 3.
4. Proposed Well JOHNSON TRUST 4.
5. Proposed Well JOHNSON TRUST 5.
6. Proposed Well JOHNSON TRUST 6.
7. Proposed Well JOHNSON TRUST 7.
8. Proposed Well JOHNSON TRUST 8.
9. Proposed Well JOHNSON TRUST 9.
10. Operational Disturbance Area.
11. Ditches are $\pm 367'$ W, $\pm 426'$ W, $\pm 499'$ N, $\pm 564'$ SW, $\pm 584'$ E, and $\pm 647'$ NE.

12. Concrete Irrigation Ditches are $\pm 603'$ NE, $\pm 641'$ NW, $\pm 647'$ NW, $\pm 715'$ NE, and $\pm 971'$ SE.
13. Fire Hydrants are $\pm 712'$ N, $\pm 841'$ NE, $\pm 932'$ NE, $\pm 915'$ NE, $\pm 1005'$ NE, $\pm 1005'$ SE, $\pm 1066'$ SE, and $\pm 1115'$ NE.
14. 1000' Radius.

Legend

- | | | |
|---------------|----------------|------------------|
| Proposed Well | Ditch | Disturbance Area |
| Fire Hydrant | Concrete Ditch | 1000' Radius |

Reference Location

** JOHNSON TRUST 5 **

Lat: 40.137339° Long: -104.959620° (NAD83)
Elevation: 4925 Feet



Use our resources to find yours!
www.petro-fs.com
(303) 928-7128

Field Date: 7/12/2014
Drafting Date: 9/12/2014
Drafted By: CSG
Checked By: FMB
Revision:

Data Sources:

- Topo courtesy USGS
- Water features courtesy of NHD

Prepared for:

