



02469436

**GENERAL**

CATHODIC PROTECTION SERVICES

05-067-06880

LOC# 325707

RECEIVED

WELL TYPE GROUNDBED DATA I-22-TND-198/3

DATA SHEET NO. 1041

COLO. OIL & GAS CONS. COM.

COMPANY UNION Texas Petro. JOB No. 13019 DATE: 10-4-86WELL: Wte # 15 PIPING: 1125' FSL & 1950 FSL SWSELOCATION: SEC. 21 TWP. 32N RGE. 11W CO. La Plata STATE COLORADOELEV. 6296 FT: ROTARY _____ FT: CABLE TOOL _____ FT: CASING _____GROUNDBED: DEPTH 300' FT. DIA. 1 3/4 IN. GAS 3.000 LBS. ANODES 10-2"x1/2"-D

DEPTH, FT.	DRILLER'S LOG	EXPLORING ANODE TO STRUCTURE			NO COKE	WITH COKE	DEPTH TOP OF ANODES	
		E	I	R	R	R	NO.	FT.
90	FIRST WATER AT 110' TO 120'							
5	Sandy							
100			1.5					
5	SANDY SHALE		1.3					
10			1.2					
15			1.5					
20			1.4					
5			1.4					
30			1.4					
5			1.0					
40			1.2					
5			1.3					
50			1.4					
5			1.4					
100			1.5					
5			1.5					
70			1.6	✓	1.6	3.8	10.	170
5			1.5					
80			1.1					
5			1.2					
90			1.3					
5			1.3					
200			1.3	✓	1.3	3.2	9.	200
5			1.3					
10			1.3	✓	1.3	3.3	8.	210
15			1.3					
20			1.3	✓	1.3	3.4	7.	22
5			1.4					
30			1.5	✓	1.5	3.9	6.	230
5			1.5					
40			1.2	✓	1.2	3.2	5.	24
5			1.2					
50			1.5	✓	1.4	3.9	4.	250
5			1.3					
60			1.4	✓	1.3	3.1	3.	26
5			1.4					
70			1.4	✓	1.3	3.2	2.	270
5			1.2					
80			1.3	✓	1.3	3.2	1.	280
5			1.2					
90			1.3					
5			1.2					
300	TD 300'		1.2					

GROUNDBED RESISTANCE: (1) VOLTS 13.07 - AMPS 8.5 - 1.54 OHMS

RECEIVED

MAR 10 1989

OIL & GAS CORP.



UNION Texas Petroleum

Ute # 15

Job #13069

DES. DR. E.C.	CK. APP.	DATE 3/13/89	REV. 13069-18
------------------	-------------	-----------------	------------------

NO.	REVISION	DATE
-----	----------	------

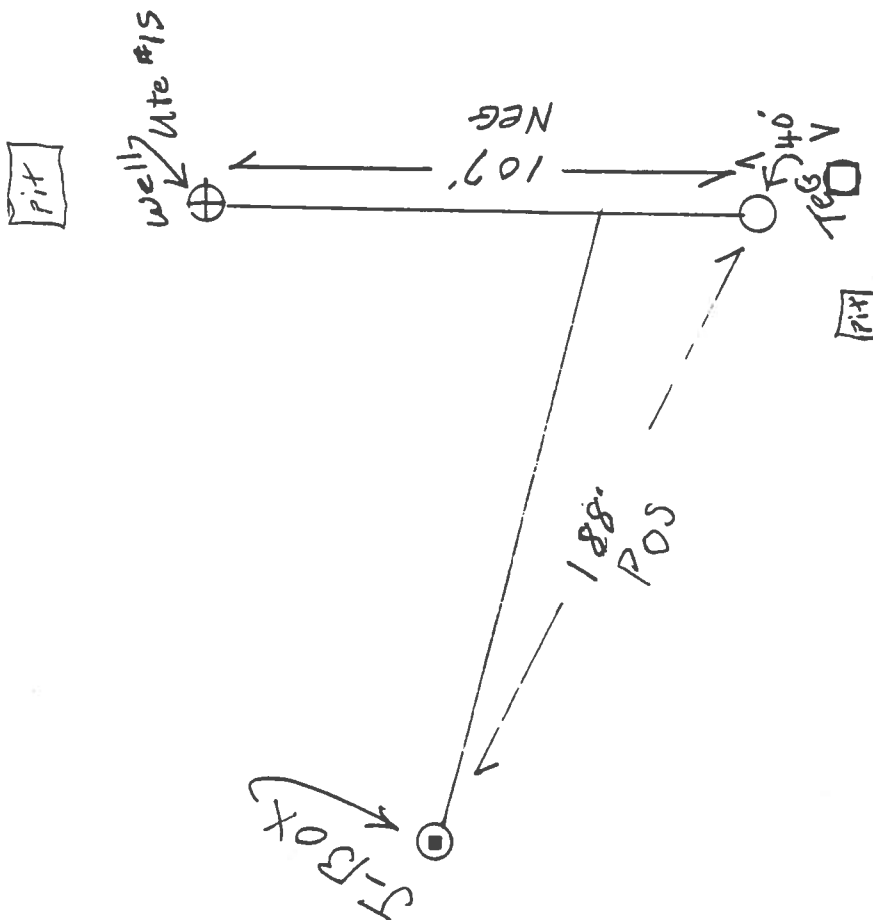

NEG. 107
POS. 188
PIPE 147'

RECEIVED

MAR 10 1989

COLO. OIL & GAS



UNION Texas Petroleum

Ute # 15

Job #13069

DES. DR. E.C.
SCALE N.T.S.

CK. APP. DATE

3/13/89

DWG. NO.

13069-18

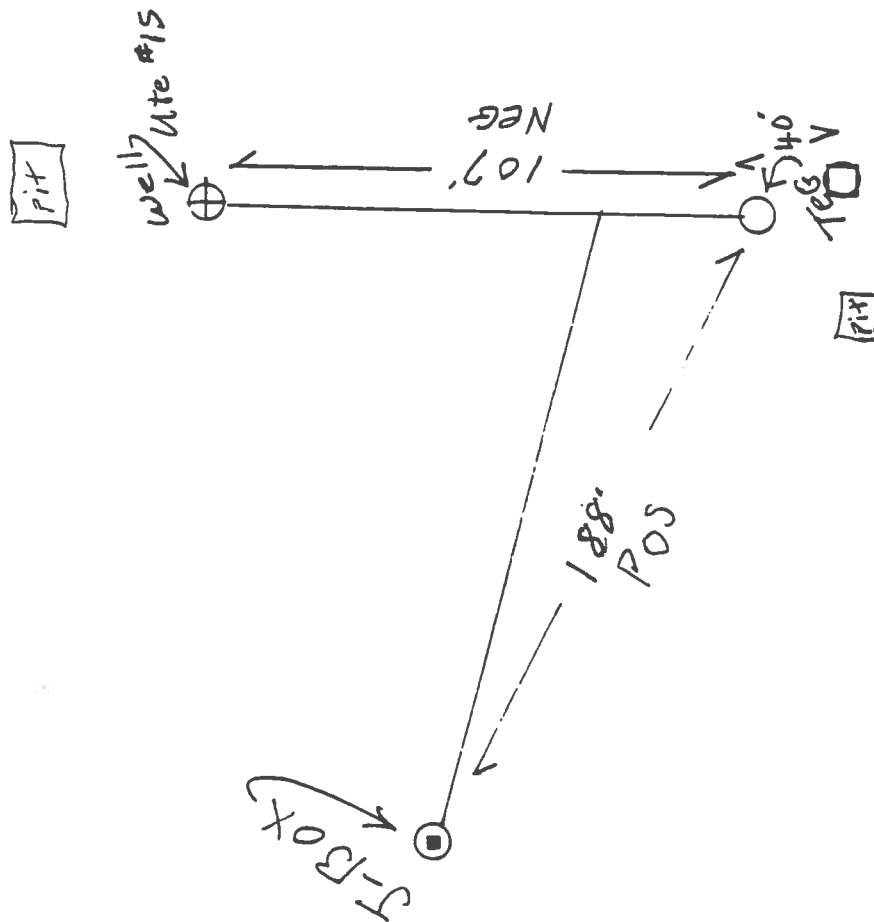

NEG. 107'
POS. 188'
PIPE 147'

DATE

REVISION

NO.