

**LEGEND:**

- = 90° SYMBOL  
 = PROPOSED WELLHEAD.  
 = TARGET BOTTOM HOLE.  
 = SECTION CORNERS LOCATED.

*T9S, R93W, 6th P.M.*

Set Marked Stone,  
E-W Fenceline  
Lat: 39.255381°  
Long: 107.783811°

N89°21'53"W - 5261.46' (Meas.)

2007 Alum. Cap,  
#17492, 0.8' High  
Lat: 39.255219°  
Long: 107.765239°

2011 Alum. Cap,  
Flush W/Ground  
Lat: 39.248153°  
Long: 107.783772°

N00°13'42"W - 2632.94' (Meas.)

N00°13'40"W - 2633.57' (Meas.)

1990 Alum. Cap,  
1.0' High, Stones,  
Fiberglass Marker  
Lat: 39.240925°  
Long: 107.783733°

S89°45'16"E - 2640.01' (Meas.)

1990 Alum. Cap,  
1.2' High  
Lat: 39.240894°  
Long: 107.774417°

28

PICEANCE FEDERAL 28-20E  
Elev. Ungraded Ground = 7685.3'

2489'

2001'

Target  
Bottom Hole

S49°18'22"E  
2527.74'

881'

363'

S89°40'55"E - 2641.84' (Meas.)

2013 Alum. Cap,  
0.9' High  
Lat: 39.248036°  
Long: 107.765164°

N00°27'22"W - 2617.17' (Meas.)

N00°26'46"W - 1308.47' (Meas.)

2013 Alum. Cap,  
0.6' High  
Lat: 39.244447°  
Long: 107.765131°

N00°27'50"W - 1308.64' (Meas.)

1990 Alum. Cap,  
0.6' High  
Lat: 39.240856°  
Long: 107.765092°

PDOP = 1.8

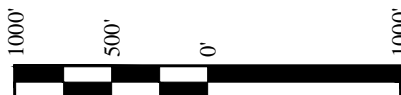

NAD 83 (TARGET BOTTOM HOLE)	NAD 83 (SURFACE LOCATION)
LATITUDE = 39°14'30.72" (39.241867)	LATITUDE = 39°14'47.00" (39.246389)
LONGITUDE = 107°46'05.56" (107.768211)	LONGITUDE = 107°46'29.91" (107.774975)
UTM NAD 83 / ZONE 13	UTM NAD 83 / ZONE 13
N: 14262667.21 E: 856609.75	N: 14264373.07 E: 854744.61

**CERTIFICATE**

THIS IS TO CERTIFY THAT THE ABOVE PLAT WAS PREPARED FROM FIELD NOTES OF ACTUAL SURVEYS MADE BY ME OR UNDER MY SUPERVISION AND THAT THE SAME ARE TRUE AND CORRECT TO THE BEST OF MY KNOWLEDGE AND BELIEF.

REGISTERED LAND SURVEYOR  
REGISTRATION NO. 38130  
STATE OF COLORADO

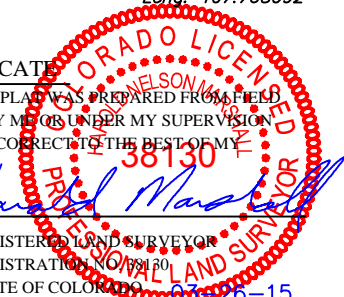

**BASIS OF BEARINGS**

BASIS OF BEARINGS IS A G.P.S. OBSERVATION

**BASIS OF ELEVATION**

BENCH MARK (19 RDS) LOCATED IN THE SE 1/4 OF SECTION 16, T9S, R93W, 6th P.M., TAKEN FROM THE SOUTH MAMM PEAK, QUADRANGLE, COLORADO, 7.5 MINUTE QUAD. (TOPOGRAPHIC MAP) PUBLISHED BY THE UNITED STATES DEPARTMENT OF THE INTERIOR, GEOLOGICAL SURVEY. SAID ELEVATION IS MARKED AS BEING 7252 FEET.



**PICEANCE ENERGY, LLC**

**PICEANCE FEDERAL 28-20E  
NE 1/4 SW 1/4, SECTION 28, T9S, R93W, 6th P.M.  
MESA COUNTY, COLORADO**

SURVEYED BY: BRIAN BAKER, B.B.	DATE: 03-04-15
DRAWN BY: M.D.	DATE DRAWN: 03-26-15
SCALE: 1" = 1000'	REVISED: 00-00-00

**WELL LOCATION PLAT**



**UELS, LLC**  
Corporate Office \* 85 South 200 East  
Vernal, UT 84078 \* (435) 789-1017