

PROPOSED PAD CONTOURS ANDERSON WELL PAD

SECTION 18, TOWNSHIP 1 SOUTH, RANGE 66 WEST OF THE 6TH P.M.

CONTOUR INTERVAL=1'

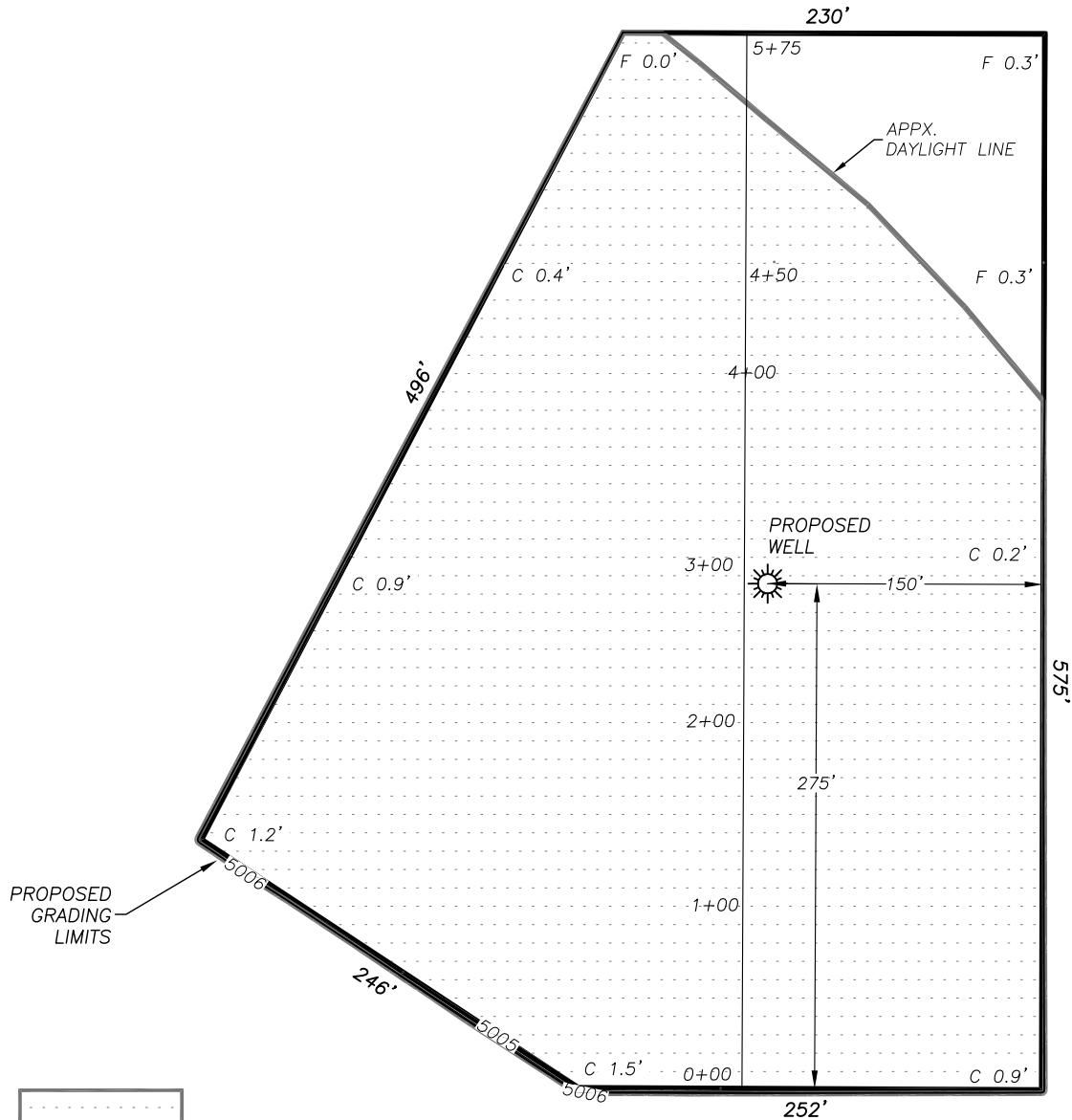

PROPOSED
GRADING
LIMITS

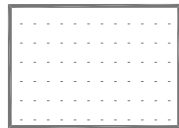

AREA OF
PROPOSED CUT

PROPOSED PAD

Top of pad elevation: 5004.8'
Cut slope ratio: 2.0
Fill slope ratio: 2.0
Cut Swell Factor: 1.00
Fill Shrink Factor: 1.00

PAD EARTHWORK VOLUMES

Total cut: 5082± C.Y.
Total fill: 82± C.Y.
Balance Export: 5000± C.Y.
(6" Topsoil)
Area: 4.6 Acres

EXISTING GROUND
ELEV AT WELL: 5005.4'
PROPOSED PAD
ELEV: 5004.8'

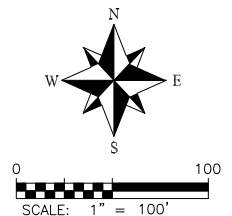

PROPOSED PAD CROSS SECTIONS ANDERSON WELL PAD

SECTION 18, TOWNSHIP 1 SOUTH, RANGE 66 WEST OF THE 6TH P.M.

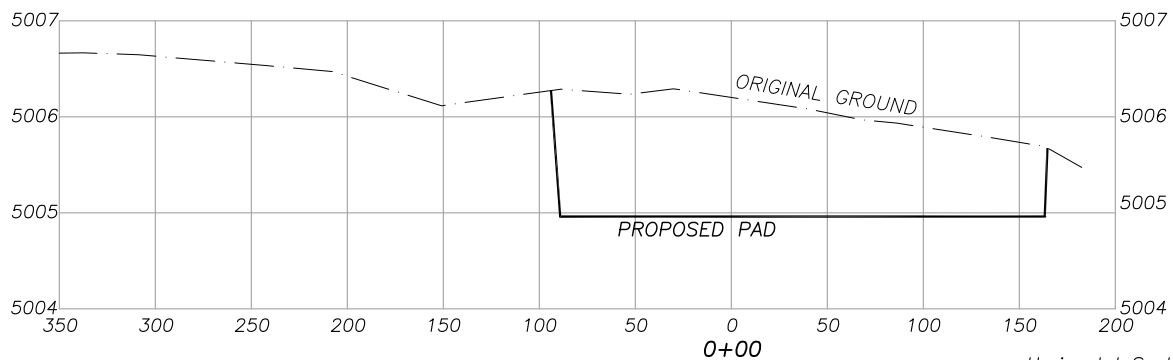
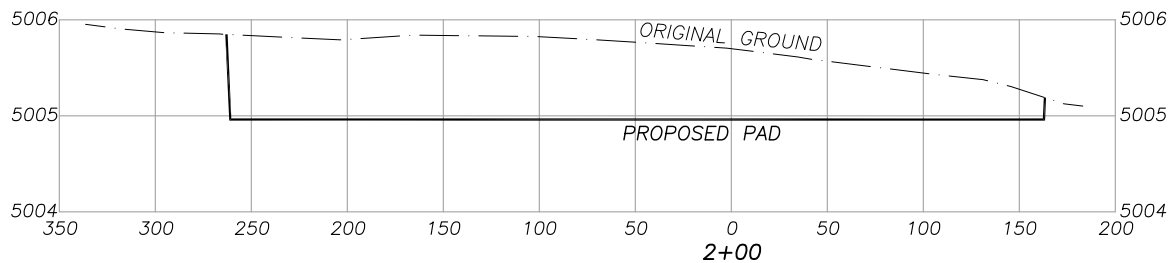
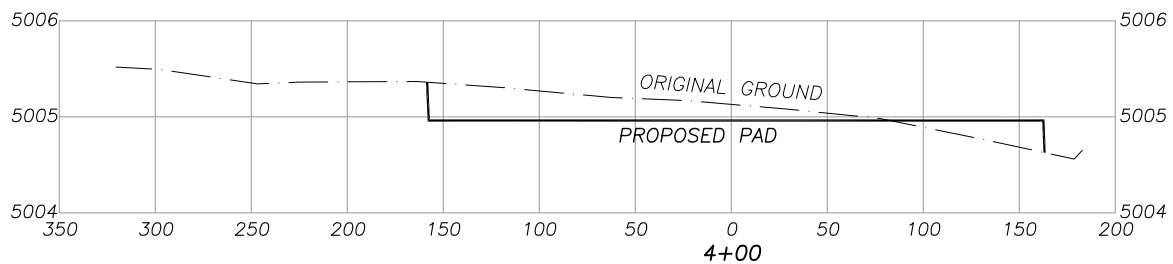
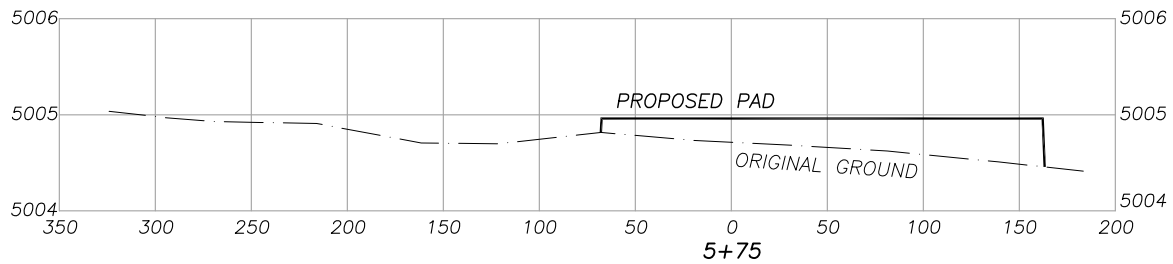

Horizontal Scale 50
Vertical Scale 1