

HYDROLOGY MAP

SONIC STAR 1-12-8-60 PAD

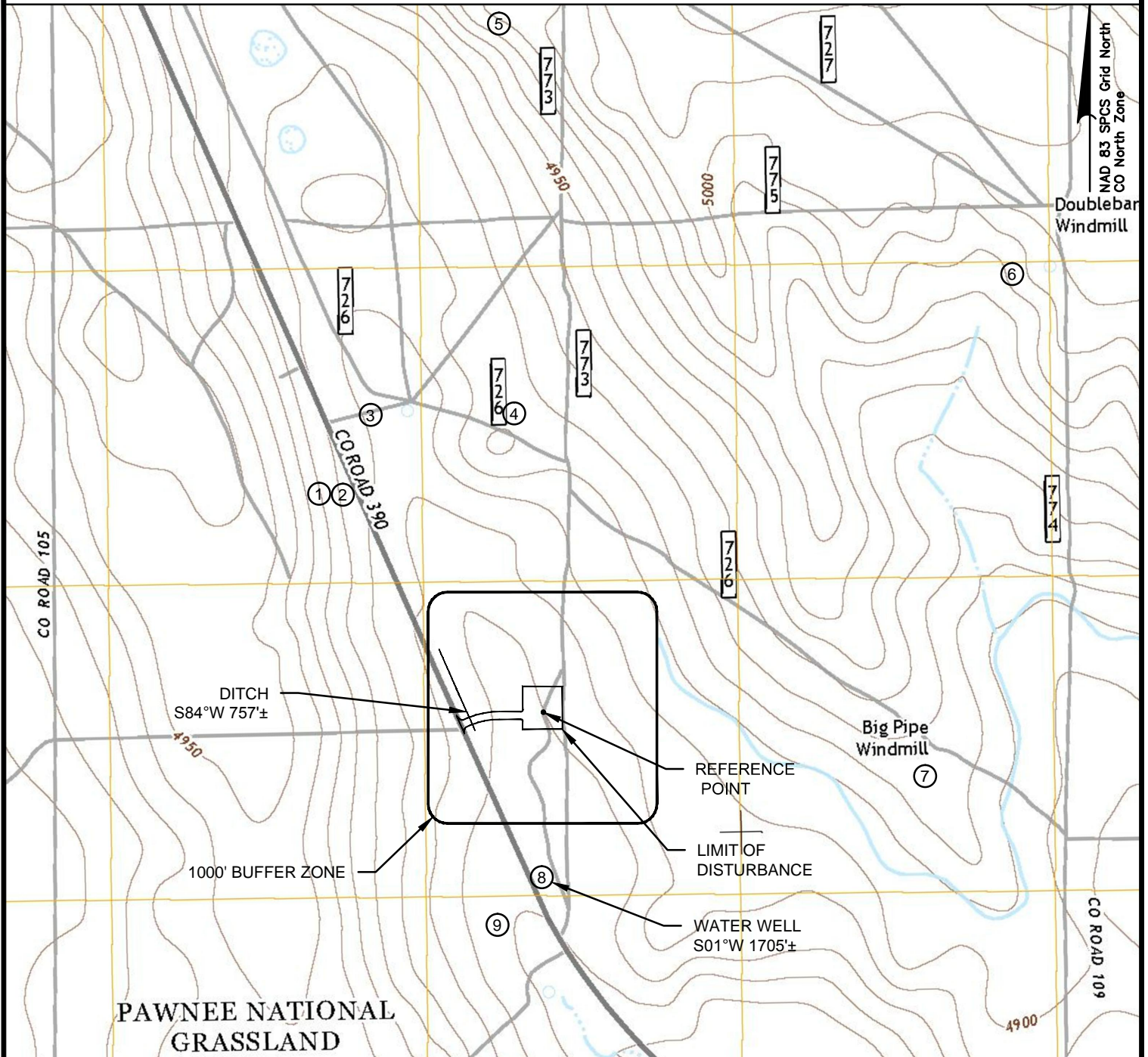

WATER WELLS

1. PERMIT NO.: 55944-F	STATIC WATER LEVEL: N/A
2. PERMIT NO.: 55943-F	STATIC WATER LEVEL: N/A
3. PERMIT NO.: 37090	STATIC WATER LEVEL: 30
4. PERMIT NO.: 42516-A	STATIC WATER LEVEL: 85
5. PERMIT NO.: 24349	STATIC WATER LEVEL: 114
6. PERMIT NO.: 38119	STATIC WATER LEVEL: 210
7. PERMIT NO.: 37091	STATIC WATER LEVEL: 73
8. PERMIT NO.: 13952-F	STATIC WATER LEVEL: N/A
9. PERMIT NO.: 43843	STATIC WATER LEVEL: N/A

DATA SOURCES

- TOPO MAP TAKEN FROM USGS.GOV

REFERENCE POINT:

HORIZONTAL DATUM: NAD 83

LAT: N40.670329°

LONG: W104.048989

VERTICAL DATUM: NAVD 88

ELEVATION: 4877.23 FEET (GROUND)

SONIC STAR
HYDROLOGY MAP
CARRIZO NIOBRARA LLC

RETTEW

RETTEW Associates, Inc.
1536 Cole Boulevard
Building 4, Suite 100
Lakewood, CO 80401
Phone (303) 800-4919



SCALE: 1"=1500'

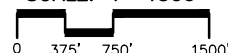

DRAWN BY: G.FLORES

CHECKED BY: J.AIKEN

DATE: 08/29/2014

REVISED:

PROJECT No: 083246002

SE 1/4 SE 1/4, SEC. 11, T8N, R60W, 6TH P.M.

WELD COUNTY, CO

Engineers/Panners/Surveyors/Landscape Architects
Environmental Consultants