

TROUDT 32-M PAD PAD LAYOUT

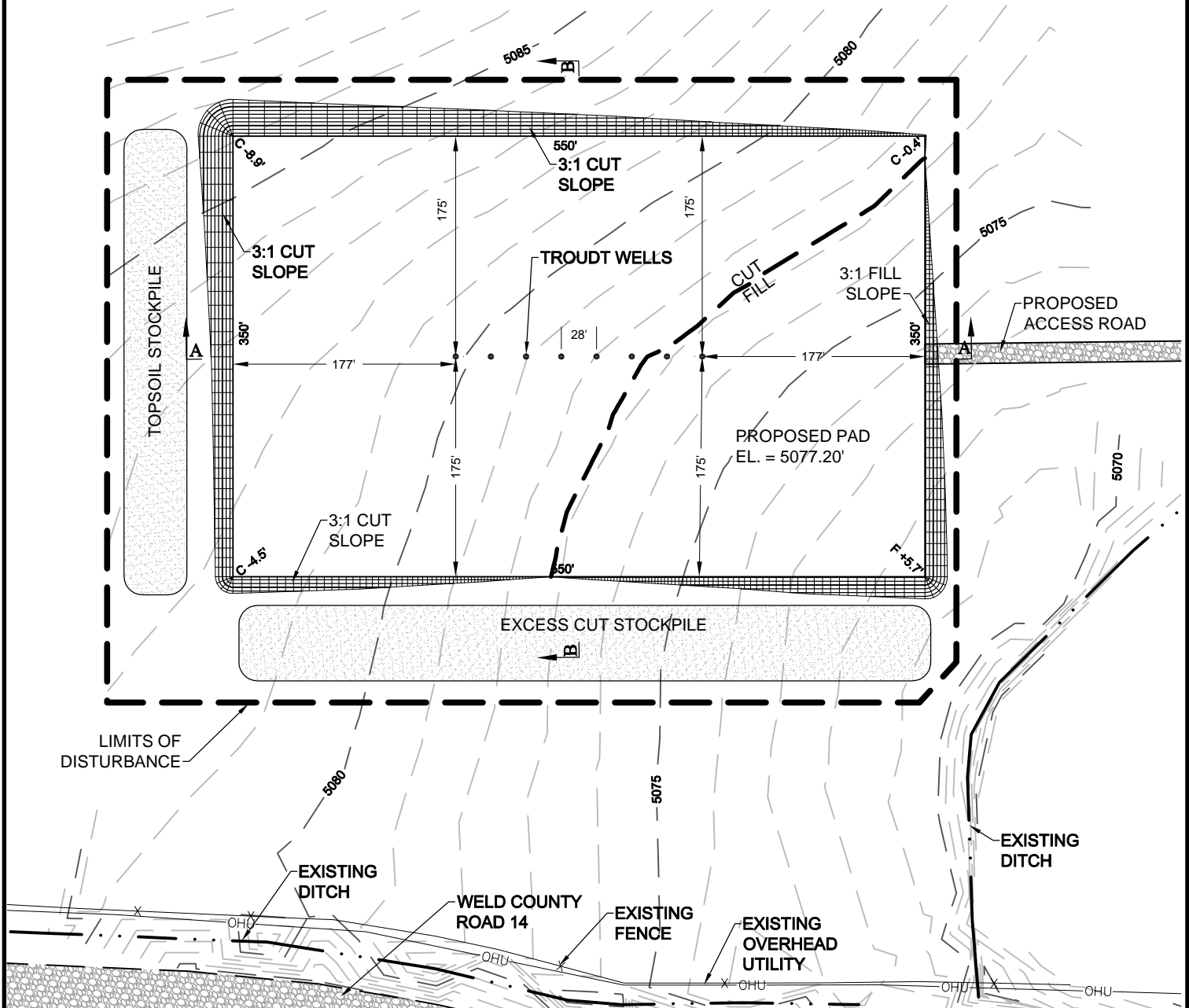

NOTES:

1. A COMPLETE UTILITIES LOCATION IS RECOMMENDED BEFORE CONSTRUCTION.
2. GEOGRAPHIC POSITIONS/COORDINATES SHOWN HEREON ARE IN NAD83 DATUM.
3. EARTHWORK QUANTITIES ARE APPROXIMATE & FOR INFORMATION ONLY. 6" OF TOPSOIL HAS BEEN SUBTRACTED FROM EXISTING SURFACE PRIOR TO PERFORMING EARTHWORK CALCULATIONS.
4. STOCKPILES ARE ASSUMED TO BE 10' IN HEIGHT WITH 2:1 SIDE SLOPES.

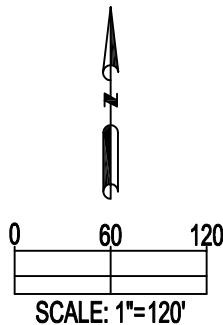

SITE QUANTITIES

FINISHED GRADE ELEVATION	5077.20'
TOTAL CUT FOR WELL PAD	16,013 CY
FILL FOR WELL PAD	6,905 CY
10% FILL FACTOR	691 CY
TOTAL FILL	7,596 CY
NET EXCESS MATERIAL	8,417 CY
TOPSOIL FROM GRADED AREA	4,023 CY
TOTAL DISTURBANCE AREA	7.7 ACRES

PREPARED BY:



FIELD DATE:

03-18-15

DRAWING DATE:

04-13-15

BY:

CHECKED BY:

SITE NAME:

TROUDT 32-M PAD

SURFACE LOCATION:

SE 1/4 SE 1/4, SEC. 32, T2N, R67W, 6TH P.M.
WELD COUNTY, COLORADO

PREPARED FOR:



TROUDT 32-M PAD CROSS SECTIONS

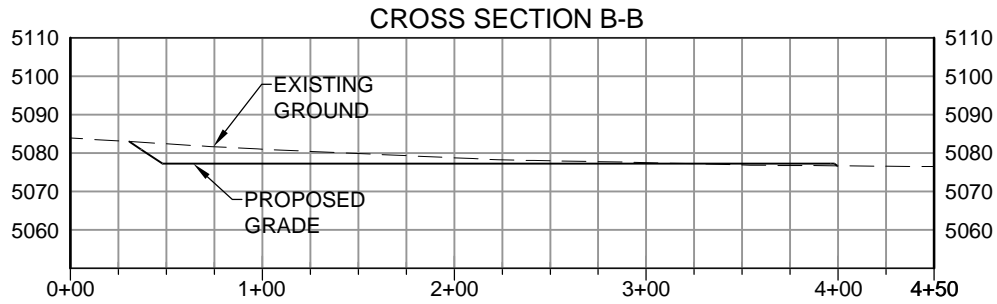
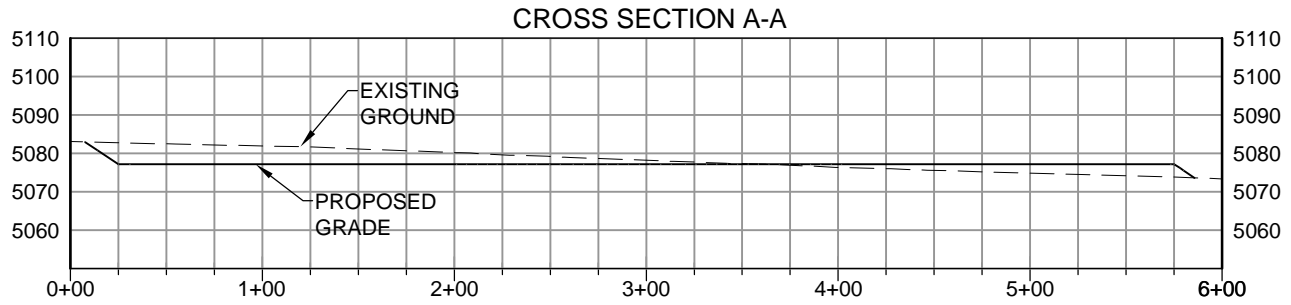

0 50 100
SCALE: 1"=100'
VERT SCALE: 1"=50'

NOTE:

1. A COMPLETE UTILITIES LOCATION IS RECOMMENDED BEFORE CONSTRUCTION.
2. GEOGRAPHIC POSITIONS/COORDINATES SHOWN HEREON ARE IN NAD83 DATUM.

PREPARED BY:



FIELD DATE:

03-18-15

SITE NAME:

TROUDT 32-M PAD

DRAWING DATE:

04-13-15

SURFACE LOCATION:

SE 1/4 SE 1/4, SEC. 32, T2N, R67W, 6TH P.M.
WELD COUNTY, COLORADO

BY:

CHECKED BY:

PREPARED FOR:



TROUTD 32-M PAD PRODUCTION LAYOUT

The diagram illustrates the production layout for the Troutd 32-M Pad. Key features include:

- Reclaimed Area:** Indicated by a dashed line and cross-hatching in the upper left.
- Topsoil Stockpile:** A rectangular area in the lower left.
- Proposed VRU (Variable Rate Unit):** A series of small squares in the upper center.
- Proposed ECD (Electrical Control Deck):** A series of small squares below the VRU.
- Proposed VRT (Variable Rate Tank):** A rectangular area containing a grid of circles, labeled with 'W' and 'V'.
- Proposed Tank Battery:** A series of small circles below the VRT.
- Proposed Separator Berm:** A dashed line in the lower left.
- Proposed Swale:** A narrow channel running along the right side of the main equipment area.
- Slopes:** Various slopes are indicated, including 3:1 CUT SLOPE, 3:1 FILL SLOPE, and 4:1 SLOPE.
- Elevations:** Key elevations include 5085, 5080, 5075, 5077.10 (TOP OF BER), and 5072.9 (BOTTOM OF POND).
- Disturbance Limits:** Indicated by a dashed line and cross-hatching in the lower left.

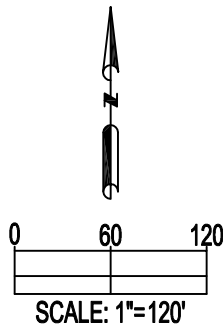

FINISHED GRADE ELEVATION	5077.20'
TOTAL CUT FOR PRODUCTION PAD	2,407 CY
FILL FOR PRODUCTION PAD	18,259 CY
10% FILL FACTOR	1,826 CY
TOTAL FILL	20,085 CY
EXCESS CUT FROM DRILL PAD	8,417 CY
NET FILL MATERIAL	9,261 CY
TOPSOIL FROM GRADED AREA	1,927 CY
TOTAL DISTURBANCE AREA	8.1 ACRES



FIELD DATE:
03-18-15

DRAWING DATE:
04-13-15

BY:

CHECKED BY:

SITE NAME:
TROUDT 32-M PAD

SURFACE LOCATION:

SE 1/4 SE 1/4, SEC. 32, T2N, R67W, 6TH P.M.
WELD COUNTY, COLORADO

PREPARED FOR:

